

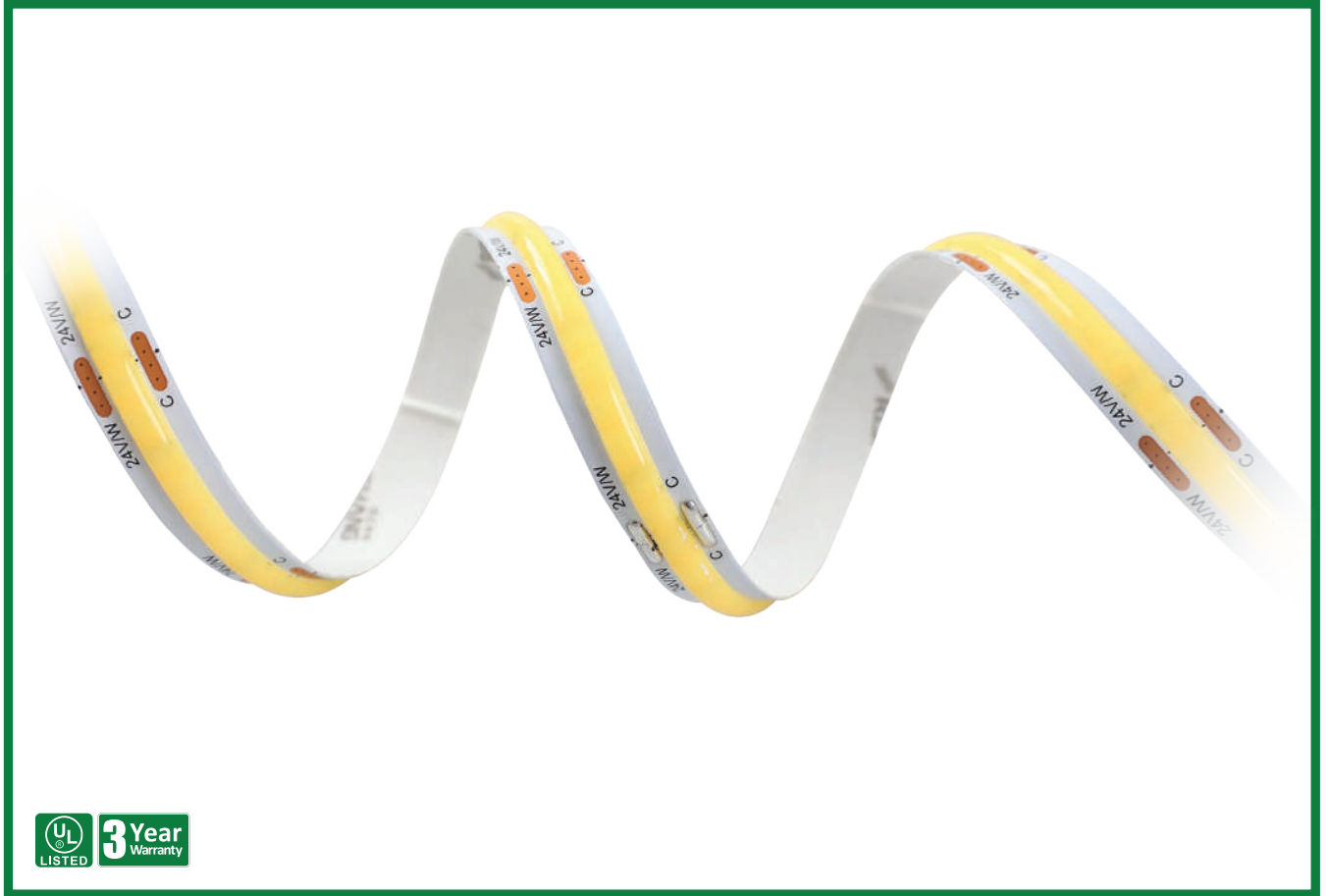

# VOLD™

## LED Tape Light



Beyond LED's VOLD Flexible Tape Light is an energy-efficient, reliable, compact, and long-lasting product with a max run of 32 Feet and emits up to 950 lumens per Meter by only utilizing about 10 watts per Meter of power. It is easy to install and operate, as its peel-and-stick adhesive backing simplifies its mounting and usage. It offers spotless soft light with an instant start eliminating shadows and humming. VOLD tape light offers an ideal solution for all indoor applications particularly offices, cabinets, displays, and decorative and creative projects for residential and commercial applications.

### Product Features

- Peel and Stick adhesive backing simplifies mounting
- 32FT of Total length per strip
- >90 CRI
- Beam Angle 135° Degree
- 8mm Strip Width
- Cuttable every 2 inches
- 10 Meters Driven by Single-End Power Supply
- Rated IP65
- Invisible LEDs
- No Hot spots
- 24V DC
- UL Listed
- 3 Year warranty

# VOLD™

## LED Tape Light



SKU #	Model #	Watt	CCT	Size	IP	Input Voltage	Beam Angle	Certifications
156824	RM08V0EC-A-L-2-965K30 NN-P01	100W	6500K	32FT	IP20	24V DC	120° Degree	UL

### Specifications

Parameter	Description	Value
General Performance	Model	RM08V0EC-A-L-2-965K30NN-P01
	Wattage	100W
	Lumen	9500Lm
	Lumen Efficacy	Up to 95LM/W
	Color Temperature	6500K
	CRI (Ra)	≥90
	Beam Angle	135° Degree
Electrical	Diffuser Type	
	Input Voltage	24V DC
	Frequency	50/60Hz
	Operating Temperature	-25°C to 60°C
Physical	Operating Humidity	N/A
	Storage Temperature	-25°C to 70°C
	Storage Humidity	N/A
	LED Brand	San'an
	LED Type	SMC2835
	LED Qty	2800 Pcs
	Housing Material	
Qualification	Housing Color	White
	IP Rating	IP65
	Warranty	2 Year



# VOLD™

## LED Tape Light

### Correlated Color Temperature (CCT)

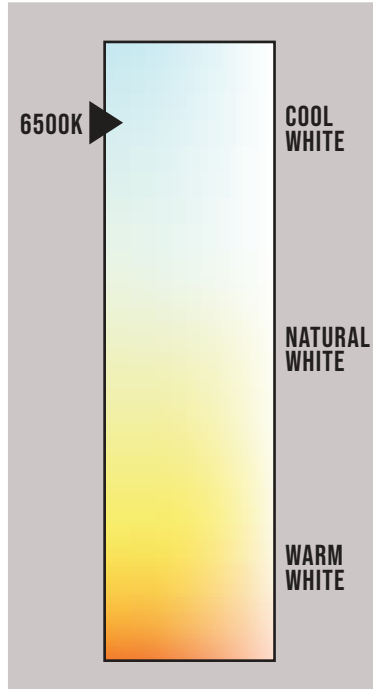

### Dimensions

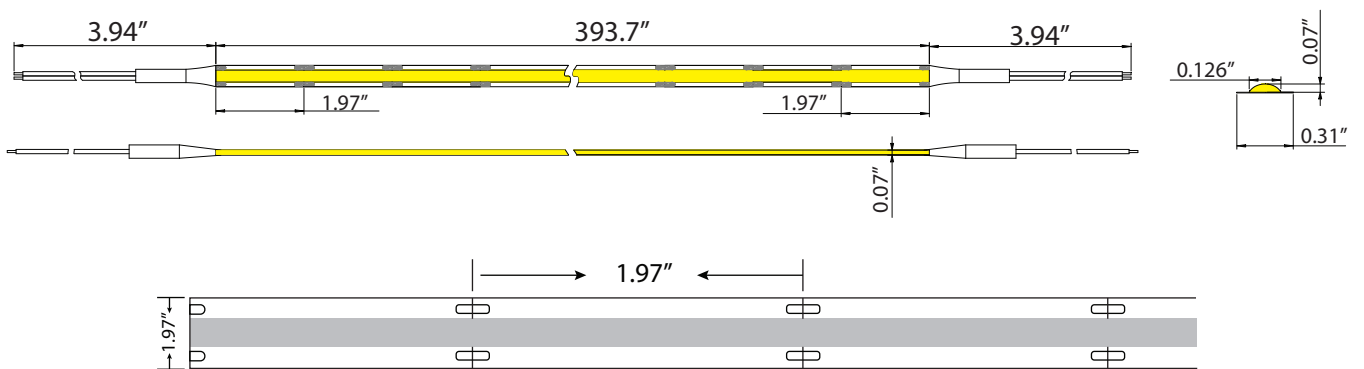

# VOLD™

## LED Tape Light



### Light Distribution

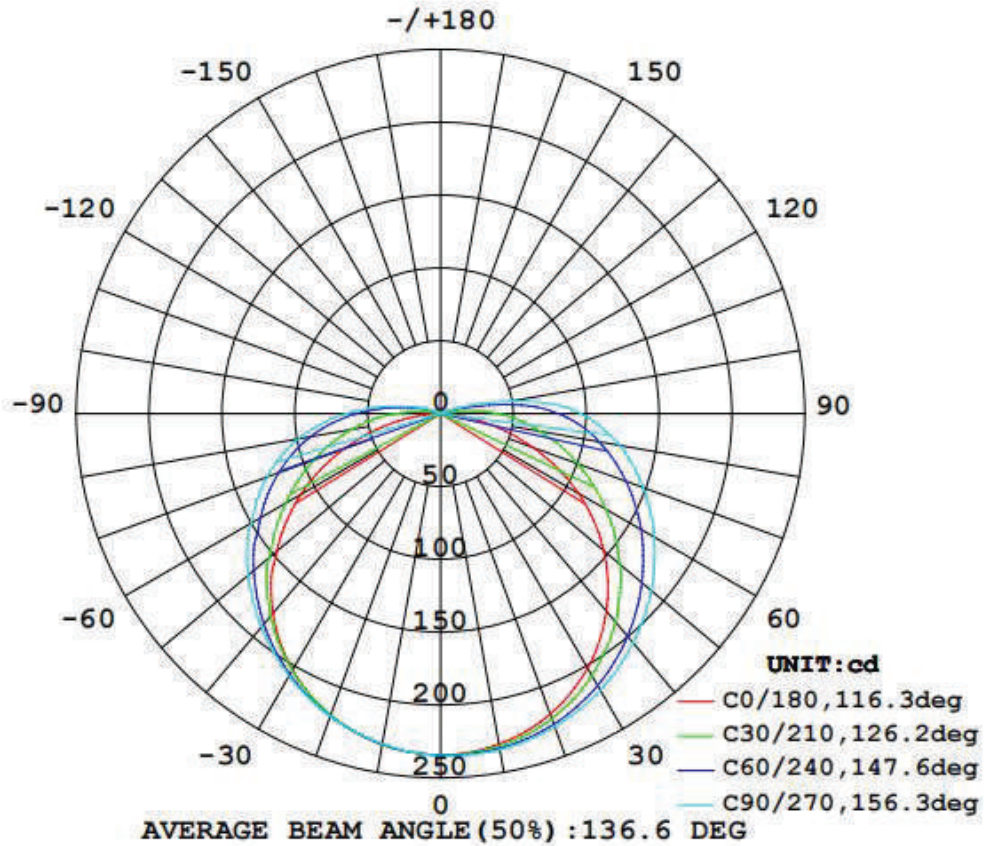

LED TAPE LIGHT



# VOLD™

## LED Tape Light

### Installation



Make sure the mounting surface is clean before installation.



Calculate the needed length and cut off the extra length along the cutting mark if necessary. If wires are needed, please weld them at the next location with a printed mark.

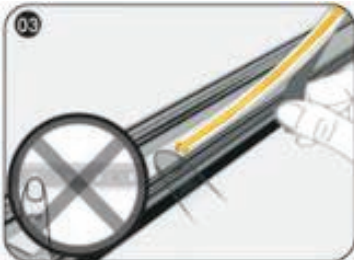

While sticking strips, peel off the release paper of the tape step by step. Don't peel off all at a time to avoid getting your strip in a mess.

Notes: No pressing the LED!

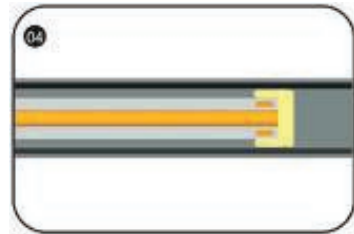

Stick Mylar tape to isolate the cutting position from the bottom of profile inner slot to avoid short-circuit.

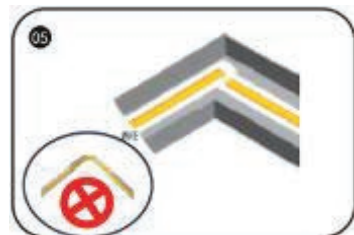

The installation at the corner is shown as the figure.

Notes: No bending it into right angle; No twisting it to stick on the mounting surface.



Connect strip wires to the output terminal of the power supply, and dispose with waterproof, insulation, short-circuit, and anticorrosion protection at wire joints and cut section of your strip (if any).

# VOLD™

## LED Tape Light



### Installation Attention

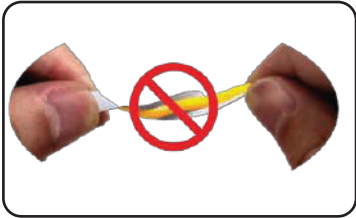

Do not twist the strip.

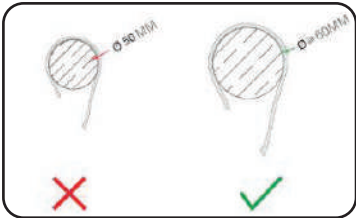

Do not wind the strip with a diameter <5cm.

### Troubleshooting

Malfunctions	Possible Causes	Solutions
All LEDs Stopped Working	The power supply did not connect to power grid.	Power on.
	Broken-circuit or Short-circuit.	Troubleshoot the problems and power on again.
	The wires of strips connect to the power supply terminal reversely.	Check the connection and ensure the polarity of the wires is connected correctly.
Part of LEDs Stopped Working	Part of power supplies have output failure.	Check the power supply system.
	Part of wires of strips have breakdown.	
	Reverse connection of polarity.	Correct connection.
LEDs Too Weak or Uneven	Overloaded power supply.	Replace it with a powerful one.
	Excessive power loss of the circuit or the power loss of each circuit differs a lot.	Ensure working voltage of strips is within $\pm 5\%V$ of rated voltage. 1. Shorten the length of wires between the first strip and power supply or replaced with wires with larger diameter. 2. Ensure the cascading qty of each circuit does not exceed the allowed range and is well distributed.
	Excessive cascading qty in series.	Adjust the cascading qty for strip to ensure the qty for each electrical circuit is within the maximum cascading qty.
LEDs Flickering	Exposed or loose joints of wires.	Find out and tackle malfunction immediately.
	Failures in power supply.	Replace it with a new one.



# VOLD™ LED Tape Light

## Declaration

If the external flexible cable is damaged, please replace it from its manufacturer, service agent, or qualified person to avoid a hazard.

- For the specific installation and cautions, please refer to the user manual.
- The given data in this specification is based on our standard product. There may exist slight difference compared with actual products.
- All Illustrations in this specification are for reference only.
- This product is subject to change or modification without prior notice.
- RISHANG OPTOELECTRONICS CO., LTD. Reserves the right of a final explanation for this specification.

## Packaging

SKU	Carton Size	Qty	Net Weight	Gross Weight
156824				

## Packaging Diagram

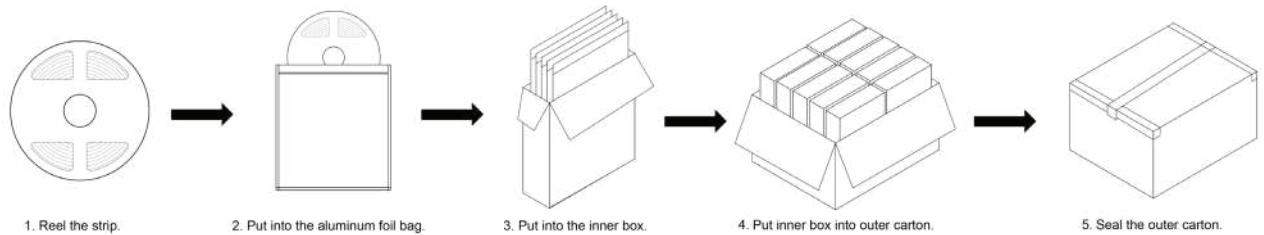



# VOLD™

LED Tape Light



## Declaration



LED TAPE LIGHT