

6 SERIES

EXHAUST DUCT INSTALLATION GUIDE

⚠ CAUTION

When ducting the unit, a dedicated duct system is recommended for each unit.
Recommended 25' max run of ducting.

Air can be distributed from the unit in two ways:

① USE RECTANGULAR DUCT.

RECTANGULAR DUCTING

- A. ATTACH ITEM 2 (DUCT ADAPTER) TO ITEM 1 (UNIT) USING 10 OF ITEM 4 (SCREWS)
- B. ATTACH RECTANGULAR DUCTING (NOT PROVIDED) DIRECTLY TO ITEM 2 (DUCT ADAPTER).

② USE 2-12" ROUND DUCTS.

**CAUTION - OPTION 2 CAN ONLY BE USED ON QUEST 506.*

2-12" ROUND DUCTS

- A. ATTACH ITEM 2 (DUCT ADAPTER) TO ITEM 1 (UNIT) USING 10 OF ITEM 4 (SCREWS)
- B. ATTACH ITEM 3 (12" COLLAR PLATE) TO ITEM 2 (DUCT ADAPTER) USING 12 OF ITEM 4 (SCREWS)
- C. ATTACH 12" DUCT (NOT PROVIDED) TO BOTH 12" DUCT COLLARS.

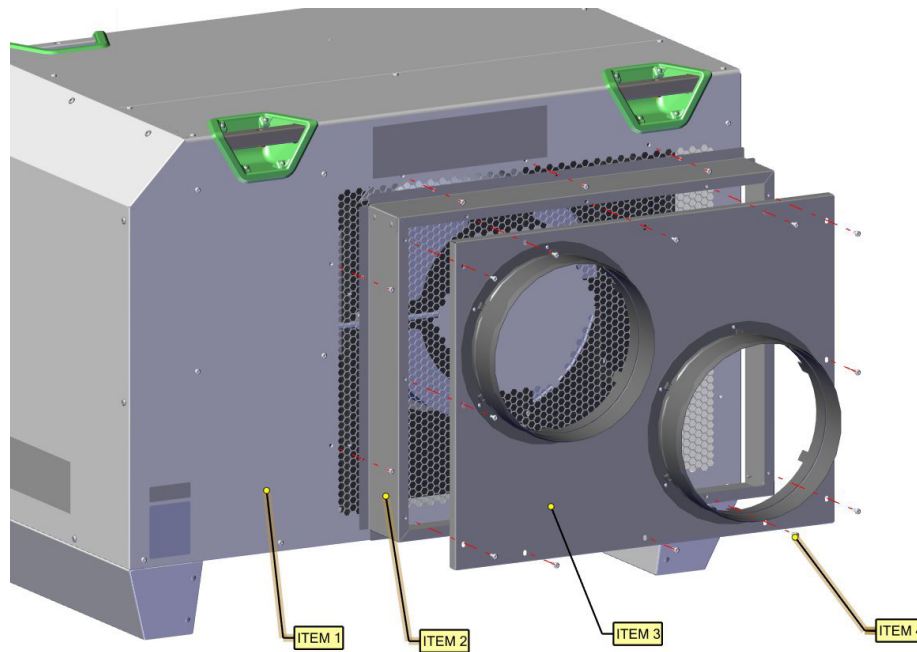

		QTY
ITEM 1	6 SERIES DEHUMIDIFIER	Not Provided
ITEM 2a	DUCT ADAPTER (506 ONLY)	1
ITEM 2b	DUCT ADAPTER	1
ITEM 3	12" COLLAR PLATE (506 ONLY)	1
ITEM 4	#10 SCREWS	22

6 SERIES

INTAKE DUCT INSTALLATION GUIDE

⚠ CAUTION

When ducting the unit, a dedicated duct system is recommended for each unit.
Recommended 25' max run of ducting.

Air can enter into the unit in two ways:

① USE RECTANGULAR DUCT.

RECTANGULAR DUCTING

- REMOVE BOTH FILTERS FROM UNIT TO USE IN THE INTAKE DUCTING PROVIDED.
- ATTACH ITEM 2 (DUCT ADAPTER) TO ITEM 1 (UNIT) USING 12 OF ITEM 4 (SCREWS).
 - USE ITEM 7 INSTEAD OF 4 IF UNIT INCLUDES HOLES.
- OPEN AND REMOVE ITEM 3 (FILTER DOOR).
- SLIDE FILTER INTO INTAKE DUCTING.
- INSTALL ITEM 3 (FILTER DOOR) BACK INTO POSITION.
- ATTACH RECTANGULAR DUCTING (NOT PROVIDED) DIRECTLY TO ITEM 2 (DUCT ADAPTER).

② USE 2-12" ROUND DUCTS.

**CAUTION - OPTION 2 CAN ONLY BE USED ON QUEST 506.*

2-12" ROUND DUCTS

- REMOVE BOTH FILTERS FROM UNIT TO USE IN INTAKE DUCTING PROVIDED.
- ATTACH ITEM 2 (DUCT ADAPTER) TO ITEM 1 (UNIT) USING 12 OF ITEM 4 (SCREWS).
 - USE ITEM 7 INSTEAD OF 4 IF UNIT INCLUDES HOLES.
- OPEN AND REMOVE ITEM 3 (FILTER DOOR).
- SLIDE FILTER INTO INTAKE DUCTING.
- INSTALL ITEM 3 (FILTER DOOR) BACK INTO POSITION.
- ATTACH ITEM 6 (12" COLLAR PLATE) TO ITEM 2 (DUCT ADAPTER) USING 12 OF ITEM 4 (SCREWS).
- ATTACH 12" DUCT (NOT PROVIDED) TO BOTH 12" DUCT COLLARS.

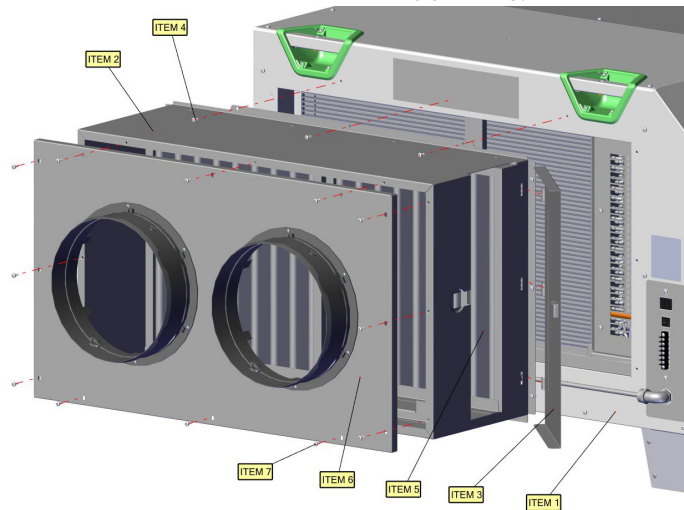

		QTY
ITEM 1	6 SERIES DEHUMIDIFIER	NOT PROVIDED
ITEM 2	DUCT ADAPTER (36.2" x 21.0" x 12.75")	1
ITEM 3	FILTER DOOR	1
ITEM 4	#10 SELF DRILLING SCREW	12
ITEM 5	FILTERS (FROM UNIT)	NOT PROVIDED
ITEM 6	12" COLLAR PLATE	1
ITEM 7	#10 SCREWS	24