

AC INFINITY

WINDOW DUCT KIT

UNIVERSAL VENT SYSTEM

USER MANUAL

WELCOME

Thank you for choosing AC Infinity. We are committed to product quality and friendly customer service. If you have any questions or suggestions, please don't hesitate to [contact](#) us. Visit www.acinfinity.com and click contact for our contact information.

EMAIL

support@acinfinity.com

WEB

www.acinfinity.com

LOCATION

Los Angeles, CA

MANUAL CODE WVK2211X1

PRODUCT

Window Duct Kit

MODEL

AC-WVK5

UPC-A

819137024021

MANUAL INDEX

Manual Index	Page 5
Product Warning	Page 6
Key Features	Page 7
Product Contents	Page 8
Installation	Page 9
Other AC Infinity Products	Page 12
Warranty	Page 13

PRODUCT WARNING



TO REDUCE THE RISK OF INJURY TO PERSONS OR DAMAGE TO PRODUCTS, OBSERVE THE FOLLOWING:

1. Read all instructions before installing and using this product.
2. If you are unfamiliar or have doubts about performing this product's installation, seek the services of a qualified, trained, and licensed professional. Inappropriate installation will void this product's warranty.
3. This product pairs with those that have rotating parts. Safety precautions should be exercised during the installation, operation, and maintenance of this product.

KEY FEATURES

VERSATILE FIT

Adjustable design features extendable sliding track to comfortably fit the length of most window spaces.

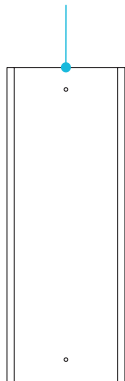
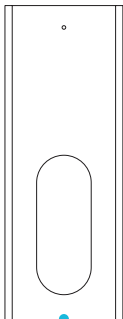
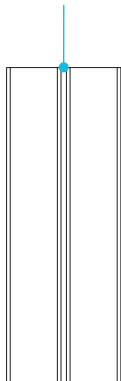

FLEXIBLE INSTALLATION

Adaptable track plates allow for effortless placement along window frames in both a vertical and horizontal orientation.

WEATHER-RESISTANT

Durable body blocks debris and withstands natural elements including hot and cold weather conditions.

SEAMLESS COUPLING

Dual duct adapters screw into place to tightly connect to 4" and 6" ducting and fans for use in HVAC and grow setups.

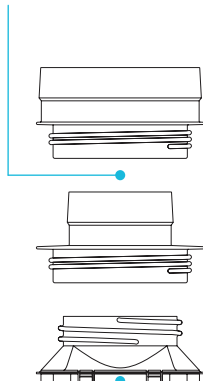

COMPLETE SEAL

Mounting hardware and included sealing tape securely lock tracks in place and block out remaining window gaps.

HIGHLY COMPATIBLE

Firm-fitting base coupler smoothly attaches to air conditioning hoses for effective ventilation.

PRODUCT CONTENTS

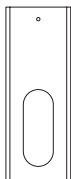

MAIN
PLATE
(x1)

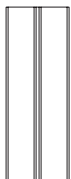

TRACK
PLATES
(x2)



EXTENSION
PLATE
(x1)



BASE
COUPLER
(X1)

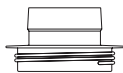

(4 IN) DUCT
ADAPTER
(x1)



(6 IN) DUCT
ADAPTER
(x1)



SEAL
TAPE
(x1)



BOLTS AND
WING NUTS
(x4)

INSTALLATION

STEP 1

Screw a flat head bolt into the main plate's mounting hole rail side up.

Keep the bolt head parallel to the rails.

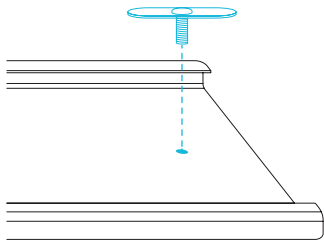

STEP 2

Apply a washer and wing nut onto the flat head bolt on the other side of the main plate.

Do not fully tighten the wing nut.

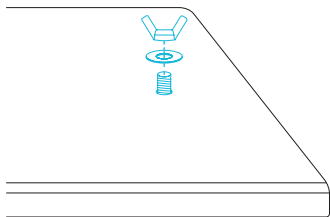

INSTALLATION

STEP 3

- A. Slide the track plate into the main plate, making sure the flat head bolt enters its channel.
- B. Adjust the assembly to fit the height or width of your window. Tighten the wing nut once you have your desired length.

You may apply the extension plate followed by the additional track plate to extend the window kit as needed.

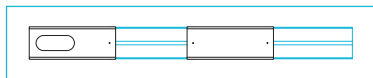
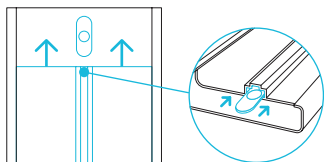

STEP 4

Snap the base coupler into the main plate's opening.

Screw the duct adapter of your choice into the base coupler.

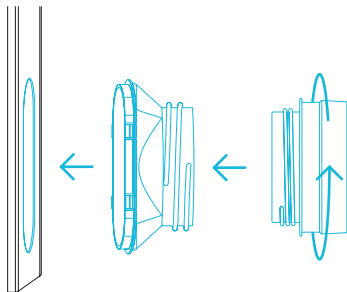

INSTALLATION

STEP 5

Place the assembly onto your window.

Close your window to hold the assembly in place.

The assembly can be installed horizontally or vertically, as shown.

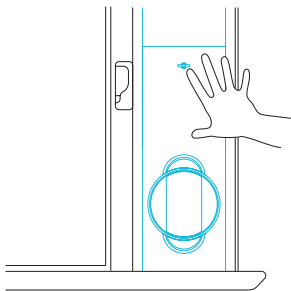

STEP 6

Apply the seal tape along the track plate to cover and close off its gaps as needed.

Connect your duct tube or vent hose (not included) onto the duct adapter.

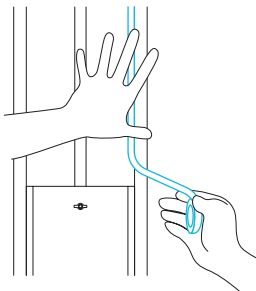

AC INFINITY PRODUCTS

Advance Grow Tents

The CLOUDLAB series is a line of grow tents designed to create ideal growing conditions and facilitate indoor plant cultivation year-round. Features 2000D thick oxford canvas lined with inner diamond patterned mylar that maximizes grow light luminosity, and a reinforced frame with 150 lb. weight capacity. Includes a mounting plate to install your AC Infinity controller onto.

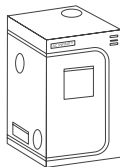

Inline Duct Fans

The CLOUDLINE series is a line of duct fans designed to quietly ventilate AV rooms and closets, as well as various DIY air circulation and exhaust projects. Features a thermal controller with intelligent programming that will automatically adjust duct fan speeds in response to changing temperatures.



Ducting Tubes

The four-layer ducting tube is used to direct airflow, designed for ventilation systems in applications like HVAC, dryers, and grow rooms. It is highly durable and flexible, and can be used anywhere from tight spaces to wide open areas.

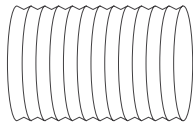

Discover the latest innovations in environmental controls at acinfinity.com

WARRANTY

This warranty program is our commitment to you, the product sold by AC Infinity will be free from defects in manufacturing for a period of two years from the date of purchase. If a product is found to have a defect in material or workmanship, we will take the appropriate actions defined in this warranty to resolve any issues.

The warranty program applies to any order, purchase, receipt, or use of any products sold by AC Infinity or our authorized dealerships. The program covers products that have become defective, malfunctioned, or expressively if the product becomes unusable. The warranty program goes into effect on the date of purchase. The program will expire two years from the date of purchase. If your product becomes defective during that period, AC Infinity will replace your product with a new one or issue you a full refund.

The warranty program does not cover abuse or misuse. This includes physical damage, submersion of the product in water, incorrect installation such as wrong voltage input, and misuse for any reason other than intended purposes. AC Infinity is not responsible for consequential loss or incidental damages of any nature caused by the product. We will not warrant damage from normal wear such as scratches and dings.

Contact our dealers department at dealers@acinfinity.com or (626) 838-4656 for more information about our dealers and distributors program. Contact our customer service department at support@acinfinity.com or 626-923-6399 for product and warranty assistance. Our business hours are Monday through Friday, 9:00 am to 5:00 pm PST.



If you have any issues with this product, contact us and we'll happily resolve your problem or issue a full refund!

COPYRIGHT © 2023 AC INFINITY INC. ALL RIGHTS RESERVED

No part of the materials including graphics or logos available in this booklet may be copied, photocopied, reproduced, translated or reduced to any electronic medium or machine readable form, in whole or in part, without specific permission from AC Infinity Inc.

www.acinfinity.com