

## PROSenM03 (on/off)



### FEATURES:

- 360° Detection angle
- 5m Detection area
- Compact dimensions
- Dual output
- Recessed mounted
- Optional 5m RJ45 cable (5m-EXT)

Ordering example: Product Name/Option (e.g. PROSenM03/5m-EXT)



Supply Voltage	Frequency	Brightness Measurement Range	Output	Time Delay Range	Frame Colour
230V	50Hz	5/∞ Lux	2000W - Incandescent 5A - Second output	1s - 30min	White

### OPTION:



5m RJ45 plug & cable (5m-EXT)

### DETECTION AREA:

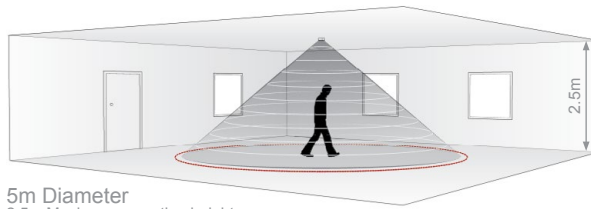

5m Diameter  
2.5m Maximum mounting height

### DIMENSIONS:

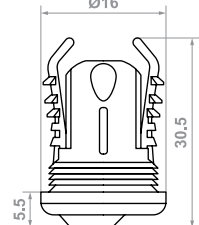

## PROSenM04 (on/off)



### FEATURES:

- Microwave sensor
- 5.8GHz CW radar
- 360° Detection angle
- 10m Detection area
- Recessed (R) & surface (S) mounting options

Ordering example: Product Name/Mounting (e.g. PROSenM04/R)



Supply Voltage	Frequency	Daylight Harvesting	Output	Time Delay Range	Frame Colour
220V - 240V	50Hz / 60Hz	10/500 Lux	2000W - Incandescent	10s - 30mins	White

### DETAIL:



### DETECTION AREA:

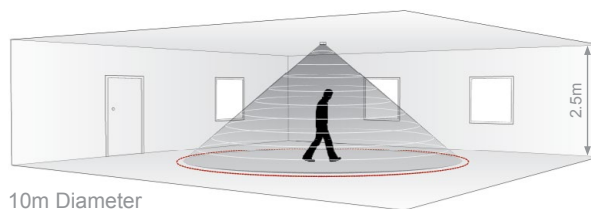

10m Diameter  
2.5m Maximum mounting height

### DIMENSIONS:

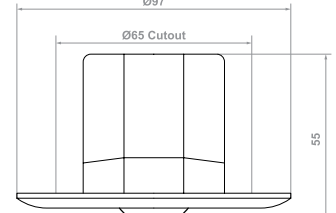

[Return to Contents Page](#)