

DE Montageanleitung**EN** Mounting instruction**ES** Instrucciones de instalación**FR** Instructions d'installation**IT** Istruzioni per l'installazione**NL** Montagehandleiding**CS** Návod k instalaci**PL** Instrukcja montażu**RU** Инструкция по монтажу

59556 010101	59556 020101
59556 070101	59556 030101
59556 170101	59556 040101
	59556 050101
	59556 120101
	59556 130101

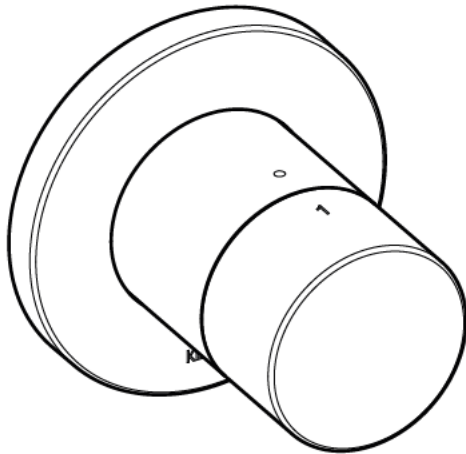

59556 010102	59556 020102
59556 070102	59556 030102
59556 170102	59556 040102
	59556 050102
	59556 120102
	59556 130102

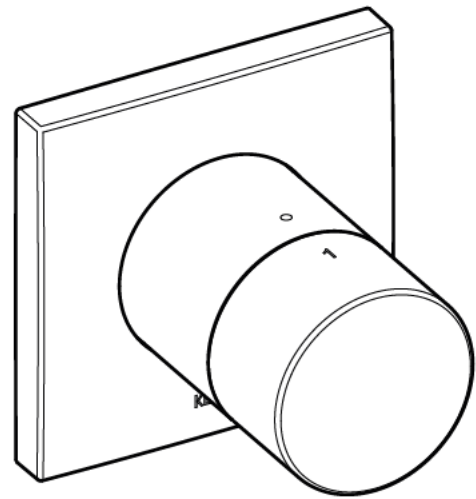
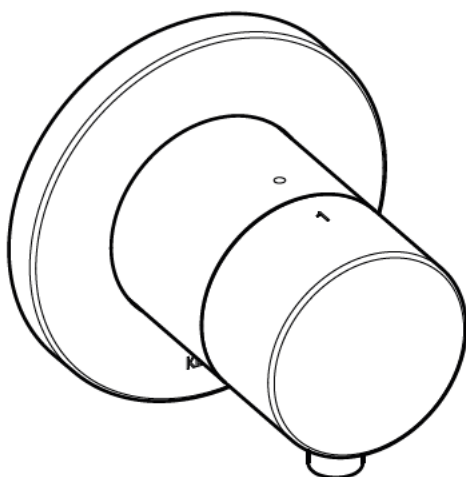

59556 011101	59556 021101
59556 071101	59556 031101
59556 171101	59556 041101
	59556 051101
	59556 121101
	59556 131101

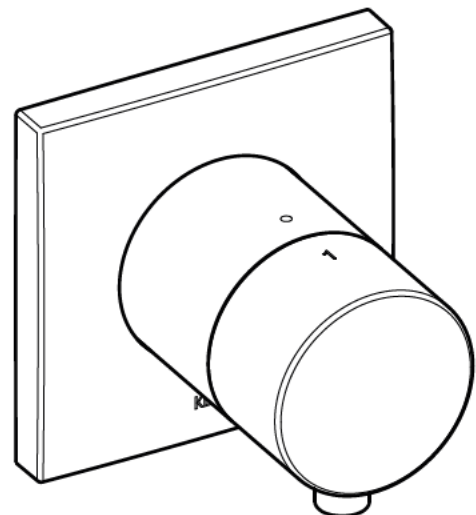

59556 011102	59556 021102
59556 071102	59556 031102
59556 171102	59556 041102
	59556 051102
	59556 121102
	59556 131102

DE Einbaumaße

FR Dimensions de montage

CS Montážní rozměry

EN Mounting dimensions

IT Dimensioni di montaggio

PL Wymiary montażowe

ES Dimensiones de montaje

NL Montageafmetingen



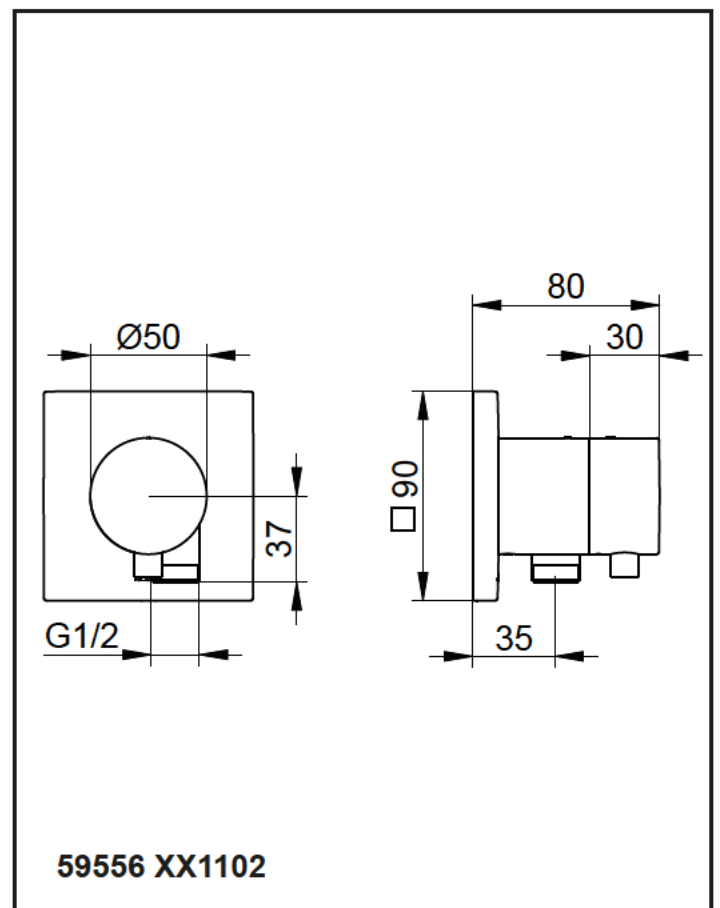
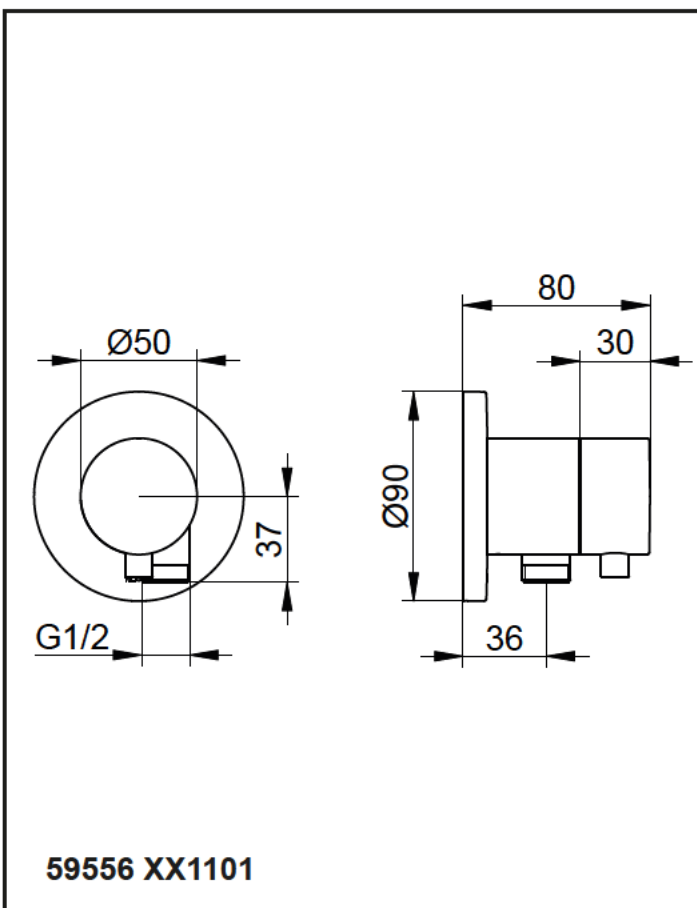
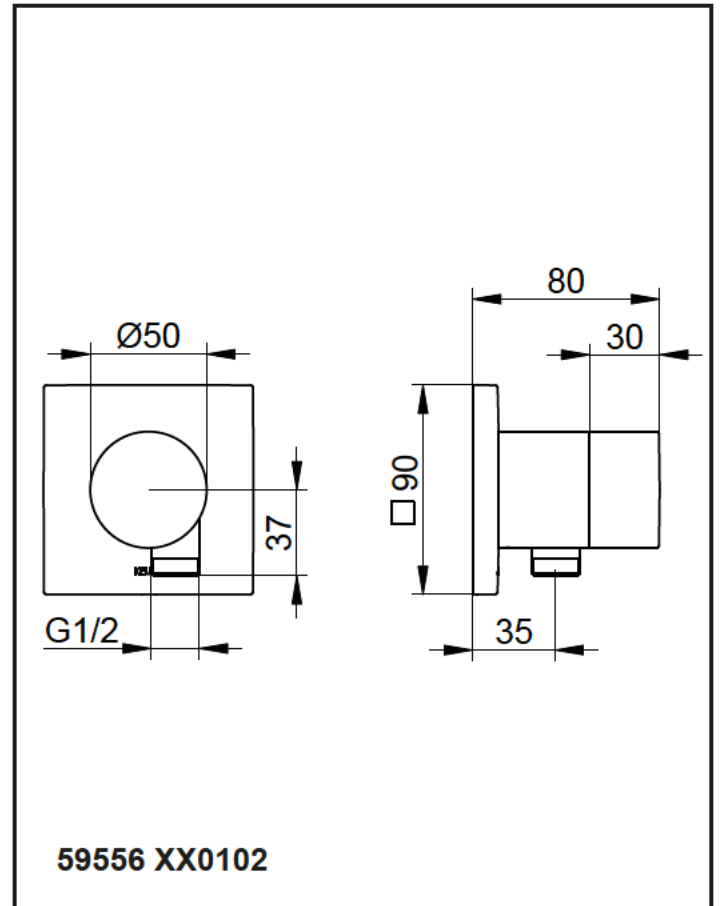
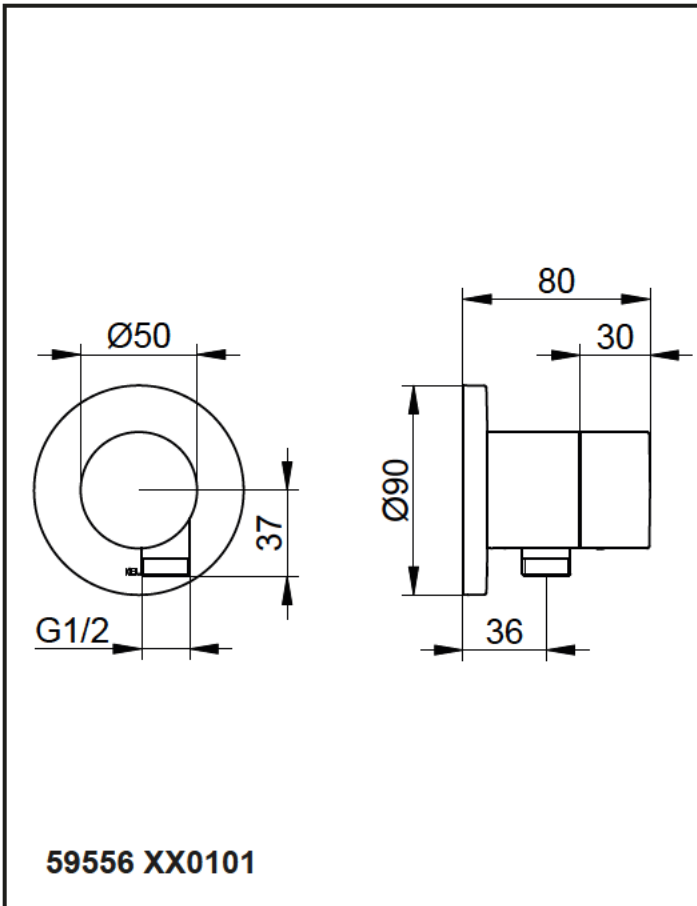







RU Установочные размеры













 Diese Anleitung ist für den Installateur zur Montage sowie für den Nutzer zur Bedienung und Wartung des Produktes. Bitte nach der Installation an den Nutzer zur Verwahrung weitergeben.

 These instructions are for both the installer for installation and the user for operation and maintenance of the product. After installation, please hand them over to the user to keep.

Symbole und Bedeutung

-  **Achtung!** Warnung vor Personen- oder Sachschaden.
-  Hinweis, Tipp oder Verweis
-  Korrekte Montage/Funktionsprüfung
-  Falsche Montage
-  Montagedetail beachten
-  Kaltwasser  Warmwasser
-  Wasserfluss  Kein Wasserfluss
-  Optional/Zubehör

Symbols and explanations

-  **Attention!** Warning against bodily injury or damage to property.
-  Note, tip or reference
-  Correct installation/test of functionality
-  Incorrect installation
-  Observe installation details
-  Cold water  Hot water
-  Water flow  No water flow
-  Optional/accessories

Technische Daten

- Durchfluss bei 3 bar Fließdruck
- Umstellventil: ca. 24 l/min
 - Schlauchanschluss: ca. 17 l/min

Technical specifications

- Flow at 3 bar pressure
- Diverter valve: approx. 24 l/min
 - Wall outlet for shower hose: approx. 17 l/min

Einbaumaße, siehe Seite 2

Installation dimensions, refer to page 2

Installation, siehe ab Bild 1 auf Seite 8

Installation, refer to picture 1 on page 8

 Nur neutral vernetzendes Silikon verwenden.

 Use only neutrally netting silicone.

Bedienung, siehe Bild 11 auf Seite 10

Operation, refer to picture 11 on page 10

Wartung, siehe Bild 12 auf Seite 10

Servicing, refer to picture 12 on page 10

- Montage in umgekehrter Reihenfolge.
- Anzugsmoment Kartuschenmutter: 20-30 Nm

- Assemble in reverse order.
- Cartridge nut torque: 20-30 Nm

Ersatzteile mit Bestellnummern, siehe Seite 11

For spare parts with order numbers, refer to page 11

 Hinweise zur Gewährleistung und Pflege sind dem beiliegendem **Pflege- und Garantiepäss** zu entnehmen.

 For warranty and care information please refer to the attached **warranty and care instructions**.

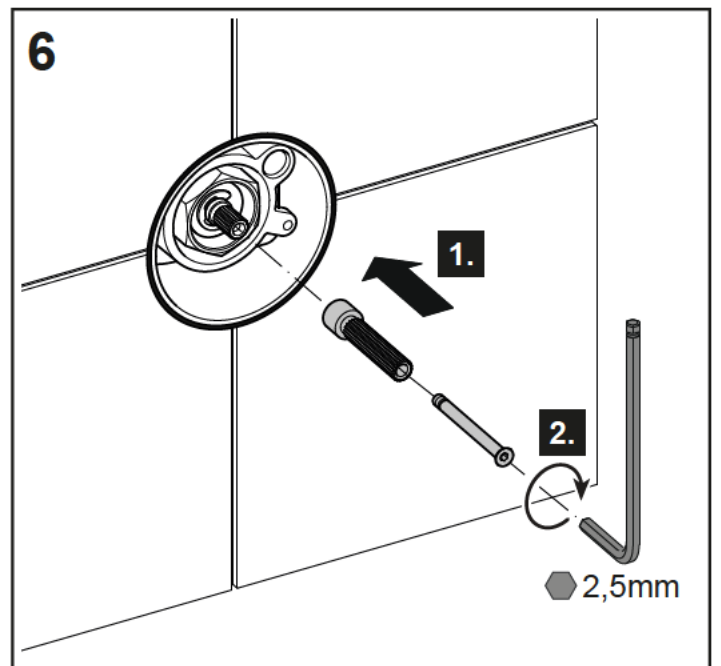
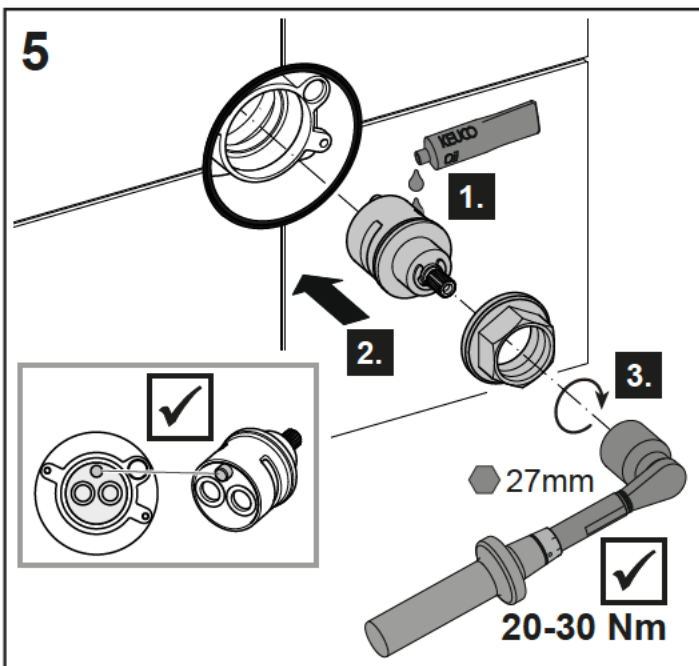
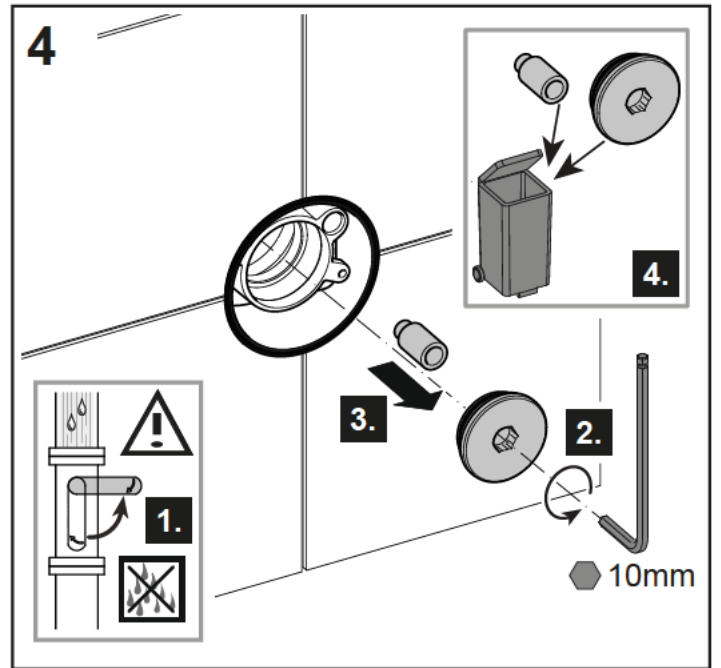
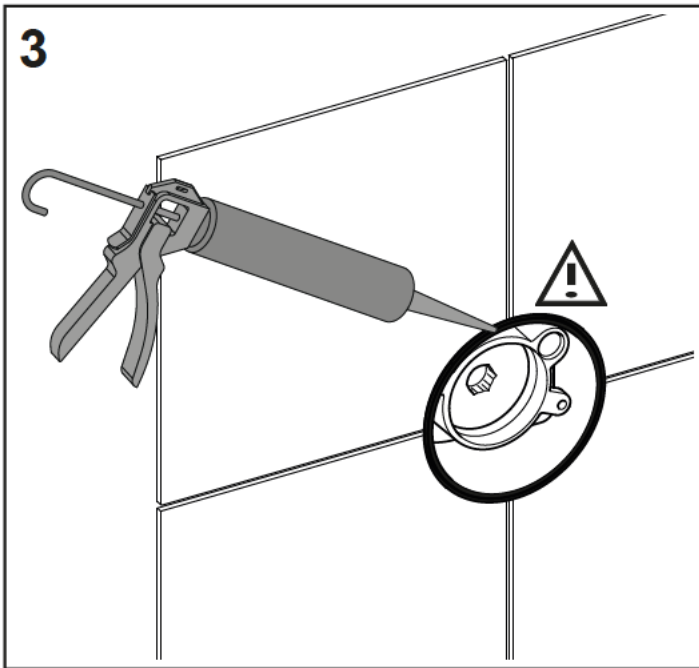
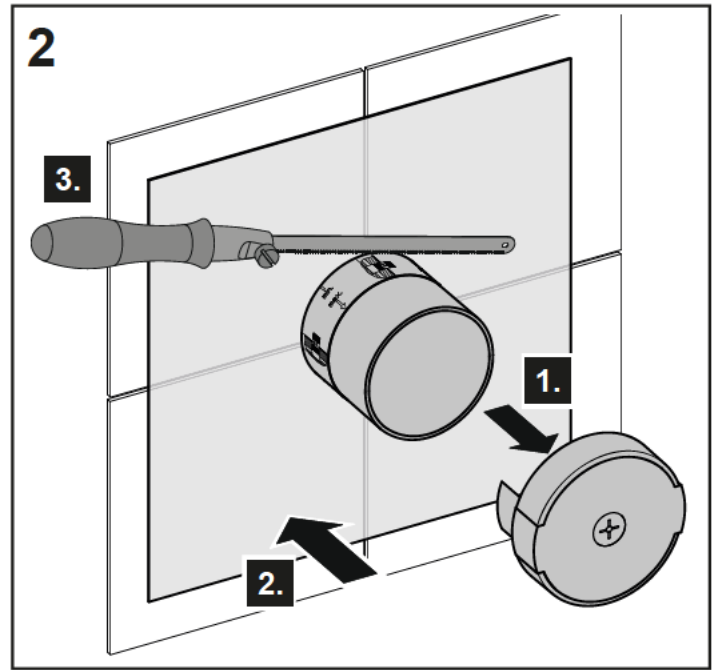
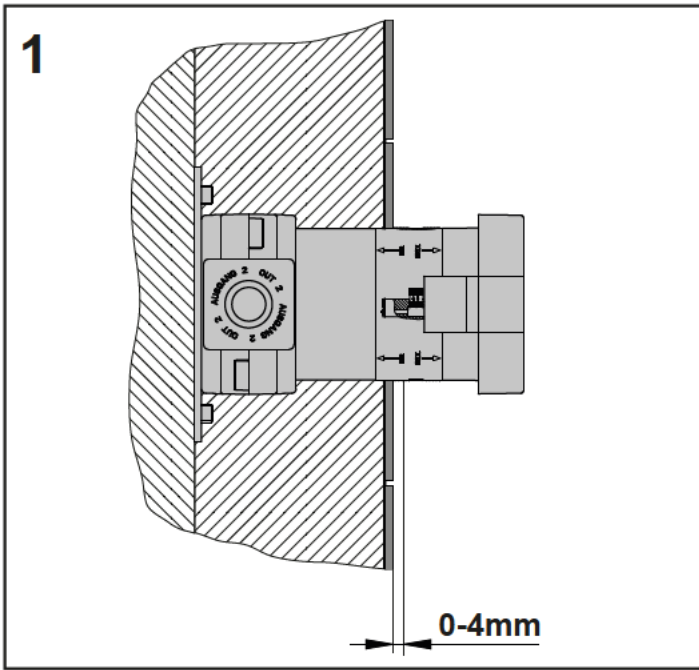

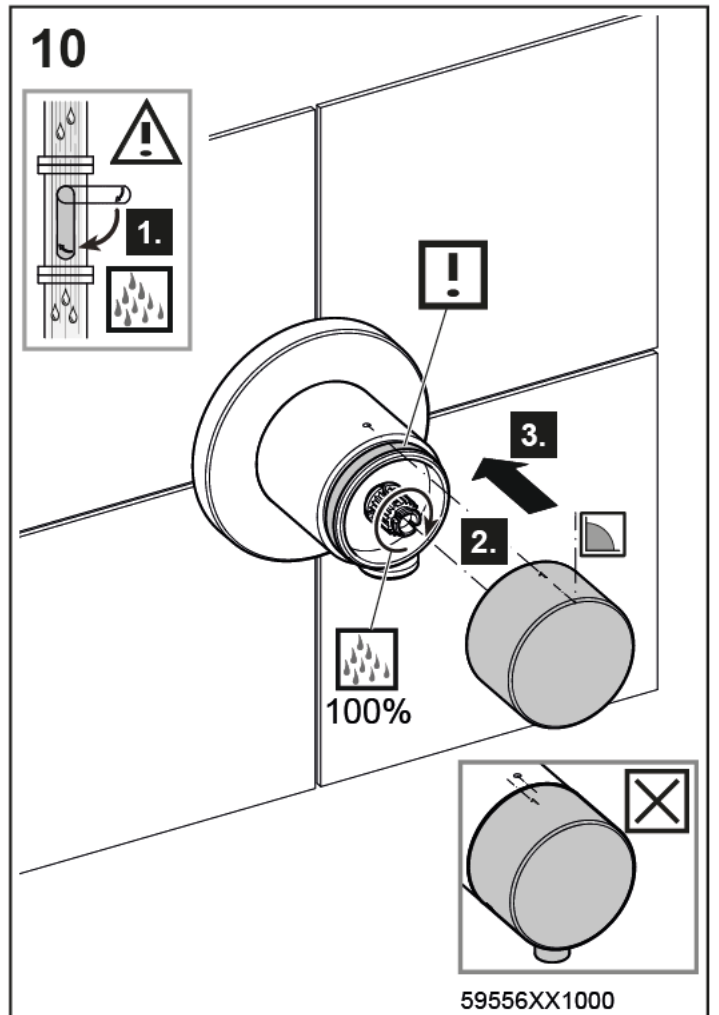
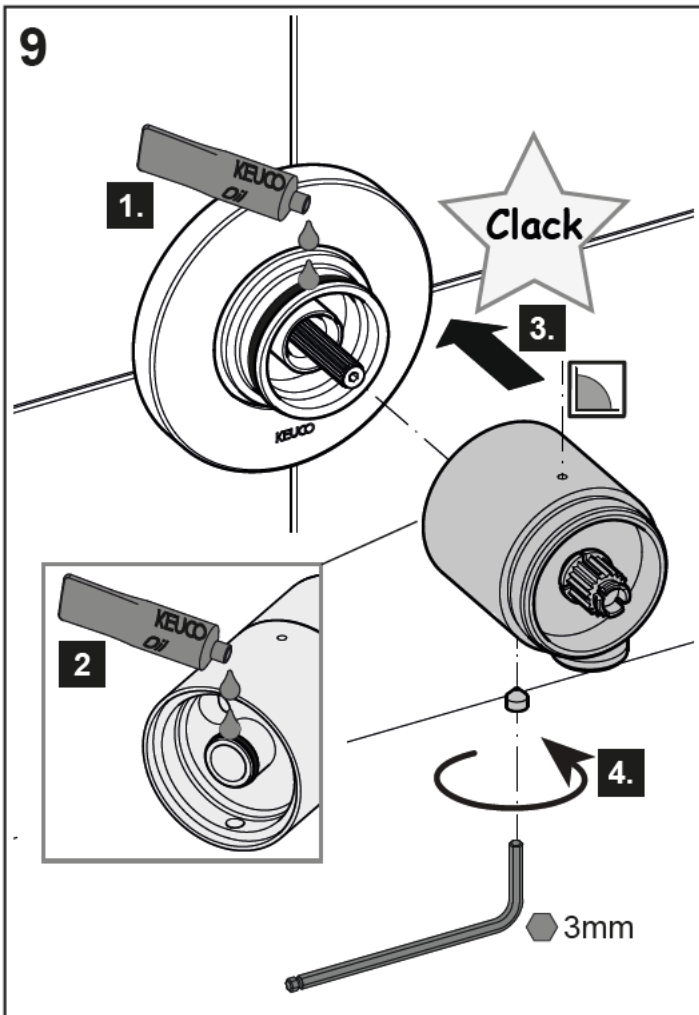
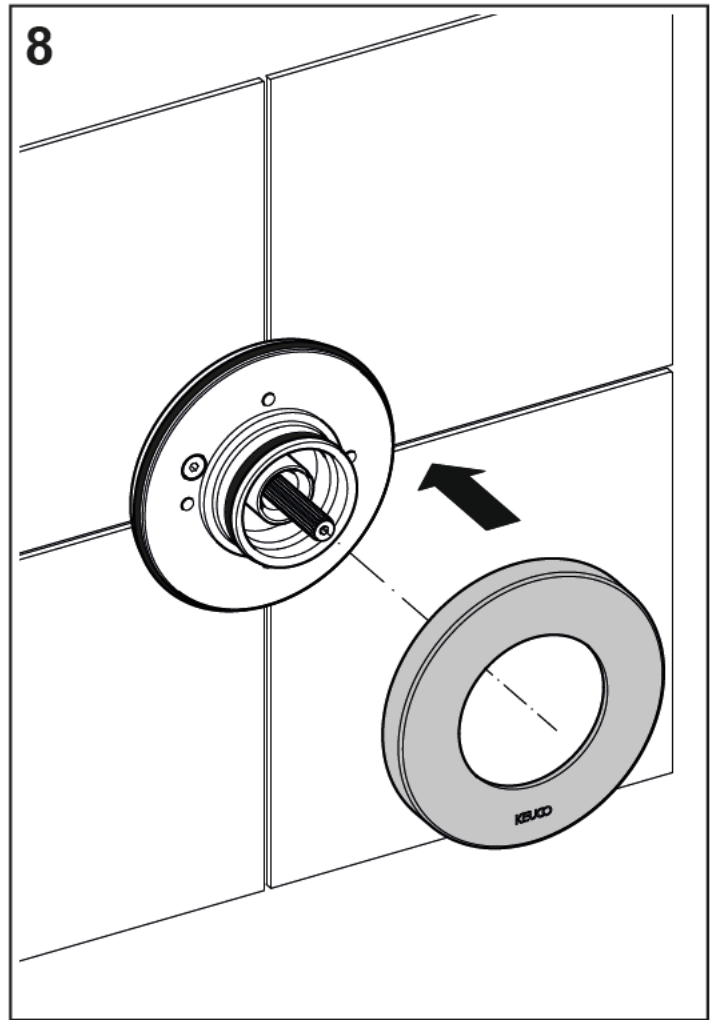
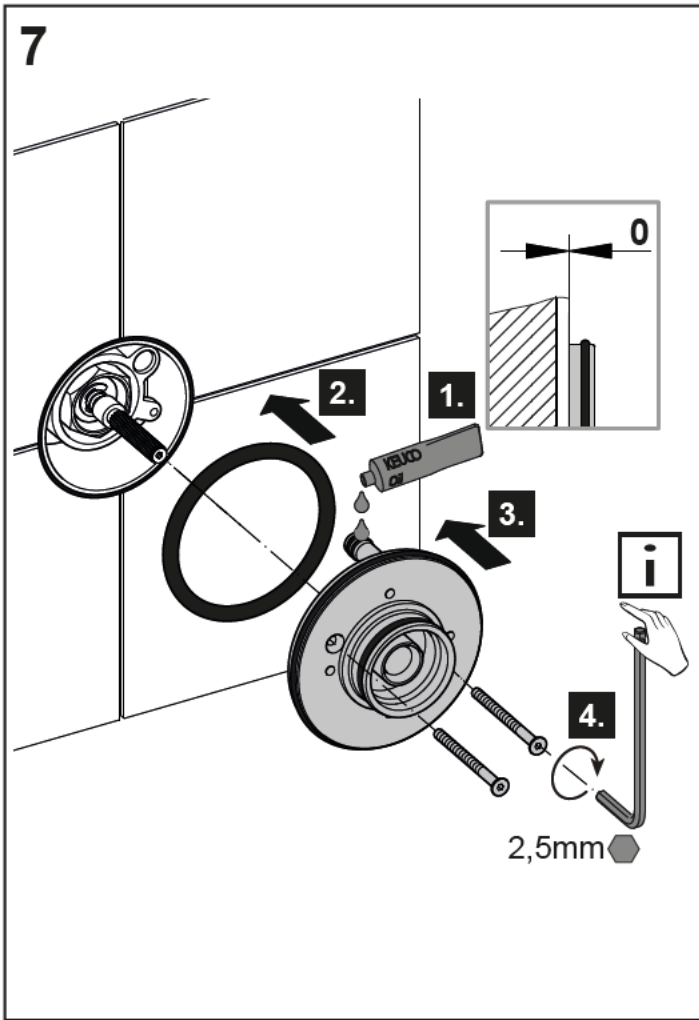

11

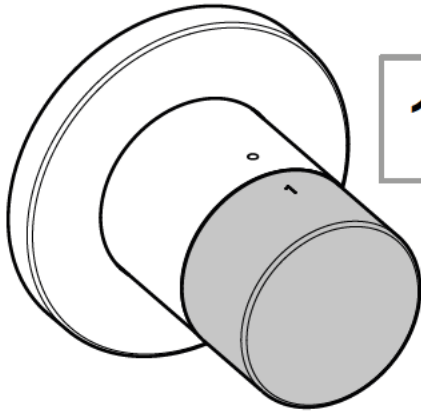

1 100%

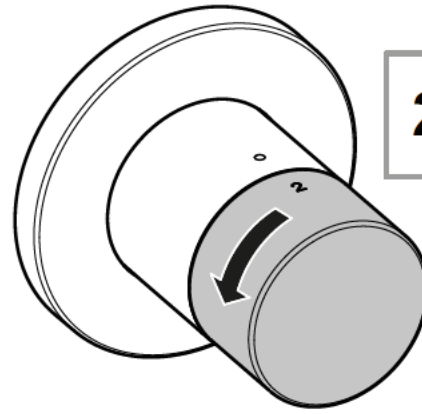

2 100%

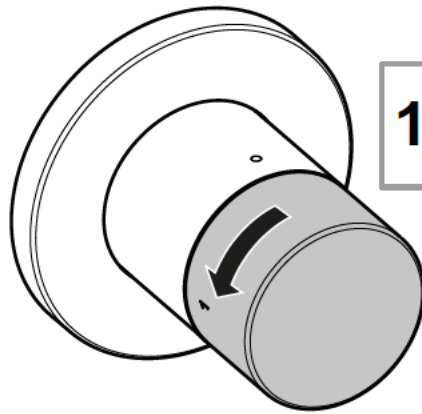

1 / 2 50%

12

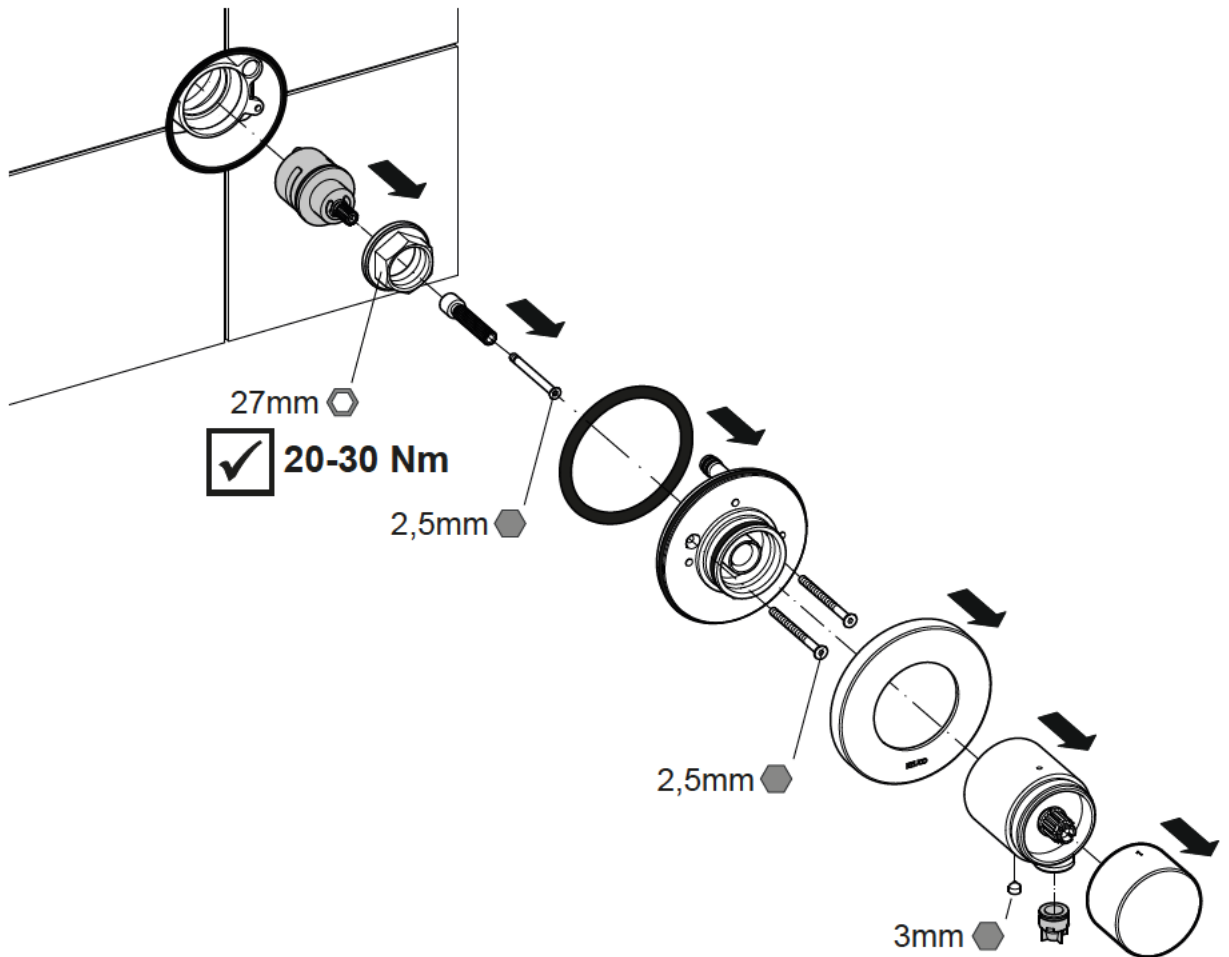

DE Ersatzteile
EN Spare parts
ES Piezas de recambio

FR Liste de pièces
IT Elenco delle parti
NL Onderdelen

CS Náhradní díly
PL Zestaw części
RU Запчасти

