

Serie | 8, Built-in warming drawer, 60
x 29 cm, Stainless steel
BID630NS1B



- **Push-pull mechanism:** easy opening and closing thanks to a practical spring mechanism.
- **Cleaning convenience:** Easy to clean hotplate made of tempered glass.

Technical Data

Construction type :	Built-in
Color / Material Front :	Stainless steel
Maximum number of plates :	40
Maximum number of espresso cups :	192
Dimensions :	290 x 594 x 548
Dimensions of the packed product (HxWxD) (mm) :	350 x 650 x 660
Required niche size for installation (HxWxD) :	290 x 560 x 550
EAN code :	4242002813936
Electrical connection rating (W) :	810
Current (A) :	10
Voltage (V) :	220-240
Frequency (Hz) :	60; 50
Plug type :	GB plug



Optional accessories
HEZ6WCC0 :

Serie | 8, Built-in warming drawer, 60 x 29 cm, Stainless steel BID630NS1B

Design

- Push-pull opening mechanism
- Easy to clean toughened glass heating plate
- Can accommodate up to:
 - 40 plates
 - 192 espresso cups
- Rotary dial
- Temperature control in 4 levels: ca. 30°C - 80°C (glass surface temperature)

Programmes/functions

- 5 functions: dough proving thawing of delicate foods keeping drinks and food warm pre-warming of crockery gentle cooking

Performance/technical information

- Cavity volume: 52 l
- Loading up to 25 kg
- Power cord length 150 cm Cable length
- Total connected load electric: 0.81 KW
- Nominal voltage: 220 - 240 V
- Appliance dimension (hxwxd): 290 mm x 594 mm x 548 mm
- Niche dimension (hxwxd): 290 mm x 560 mm - 568 mm x 550 mm
- Please refer to the dimensions provided in the installation manual

**Serie | 8, Built-in warming drawer, 60 x 29 cm, Stainless steel
 BID630NS1B**

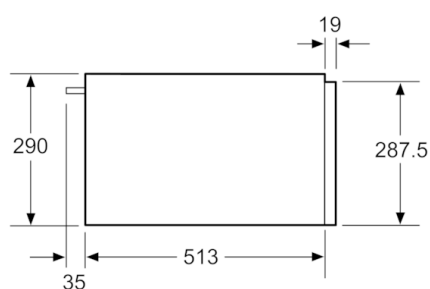

Ovens with an appliance height of 595 mm can be installed above a warming drawer. An intermediate floor is not required.

measurements in mm

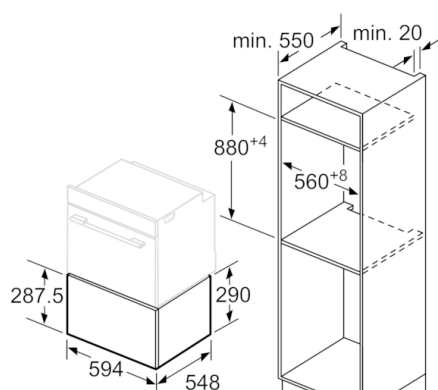

measurements in mm