

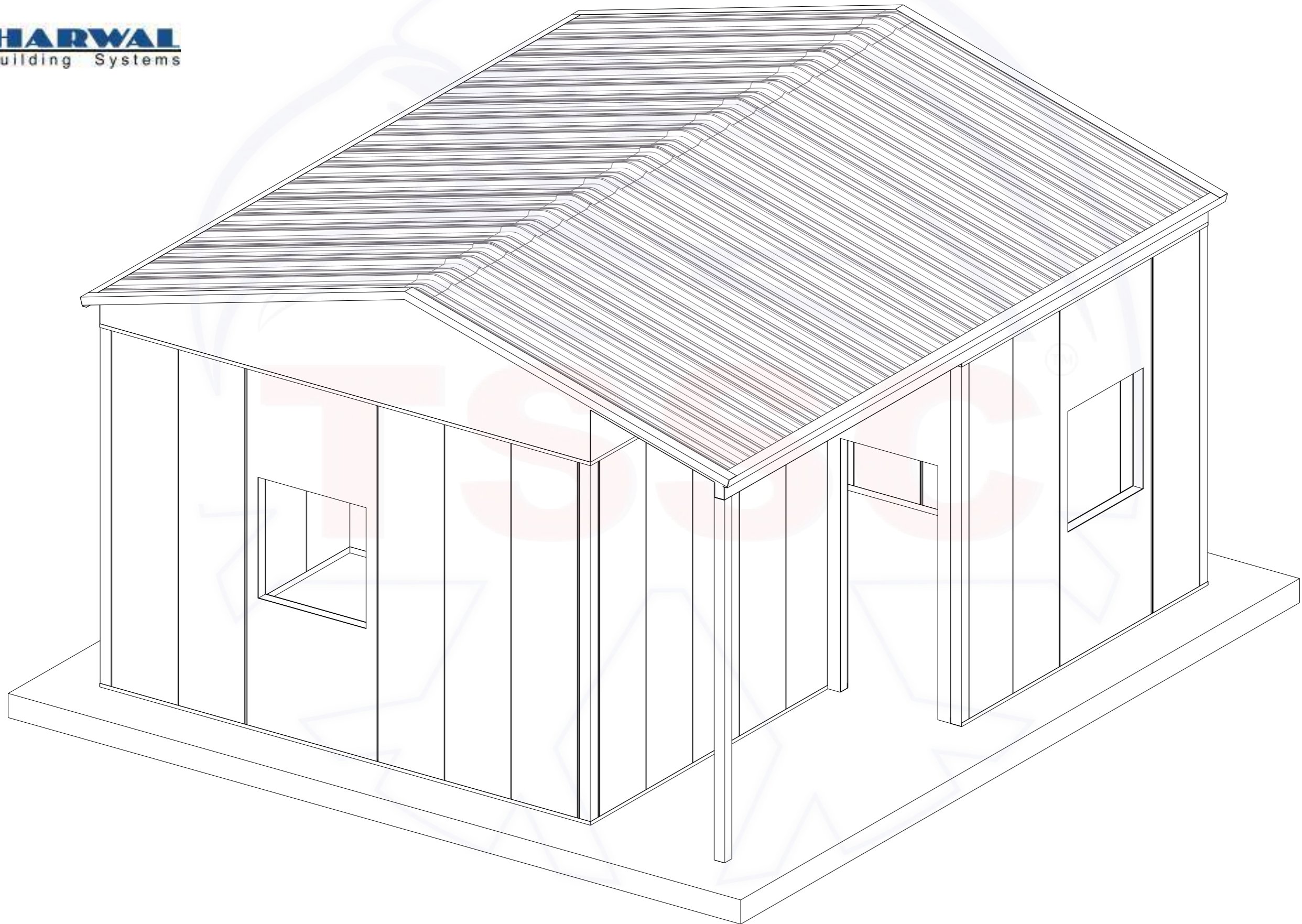

TSSC AFFORDABLE HOMES

INSTALLATION PROCESS

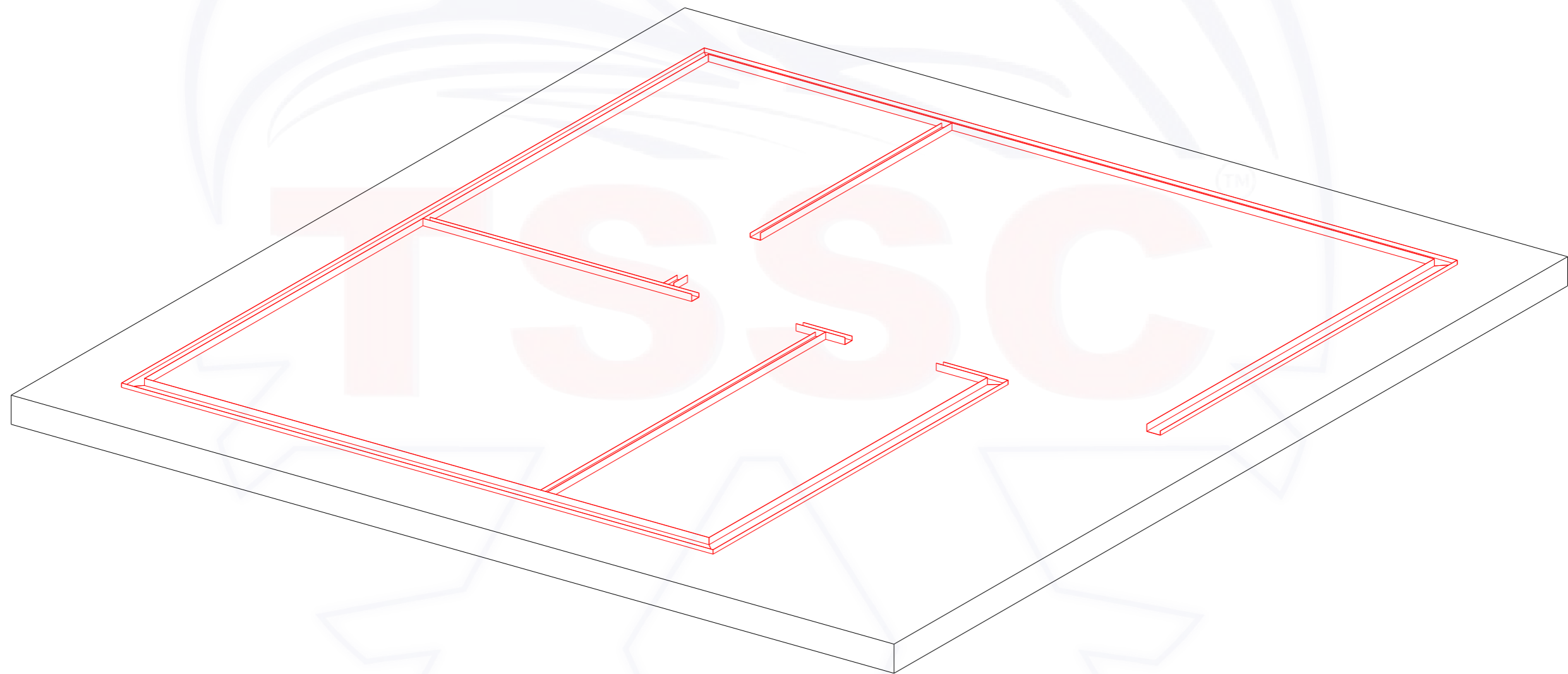



STEP 1: BASED FROM THE FLOOR PLAN DRAWING, INSTALL ALL THE BASE TRACKS (U CHANNEL) BY SCREWING TO THE CONCRETE FLOOR.

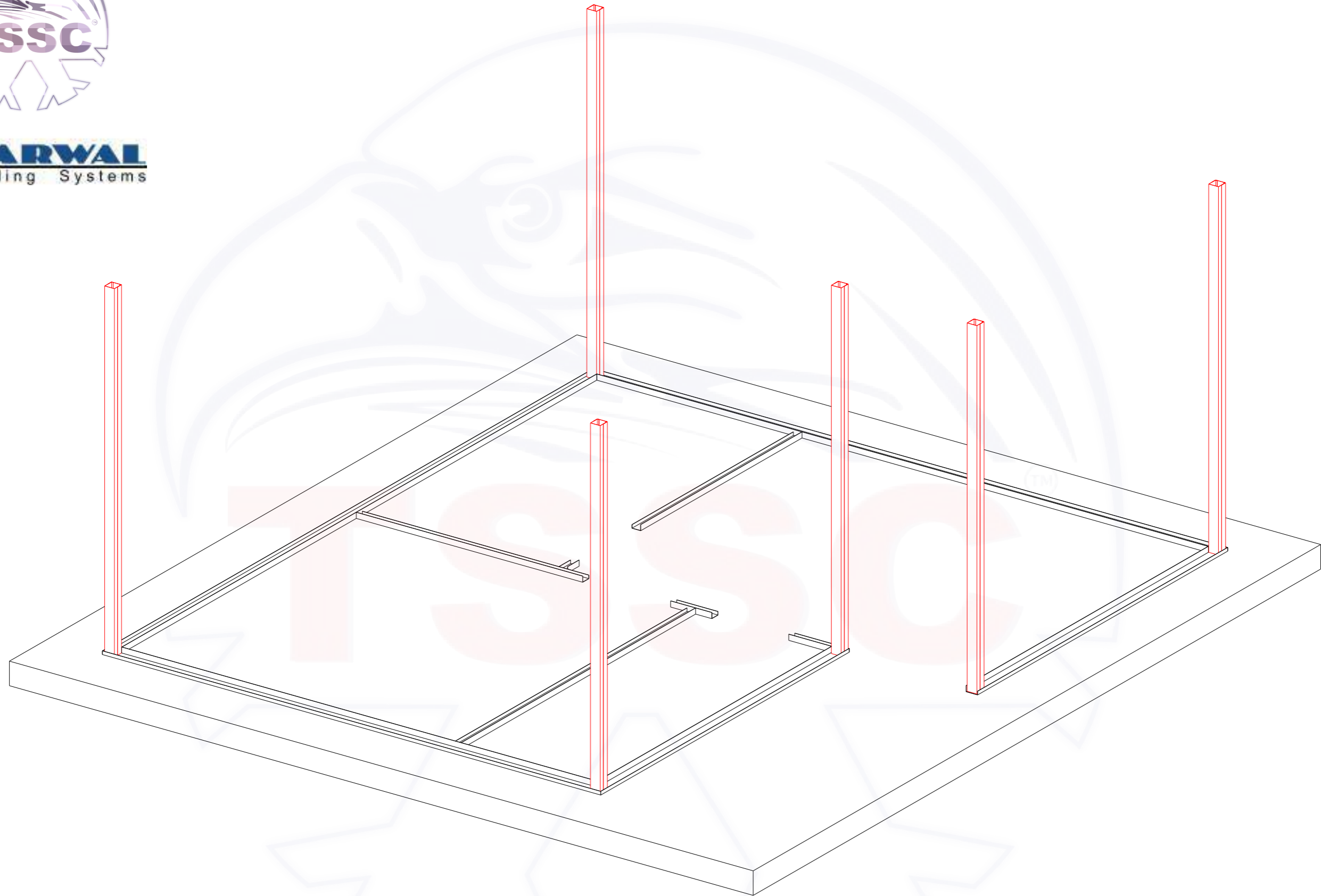

STEP 2: FIX ALL THE CORNER COLUMNS USING EXPANSION ANCHOR.

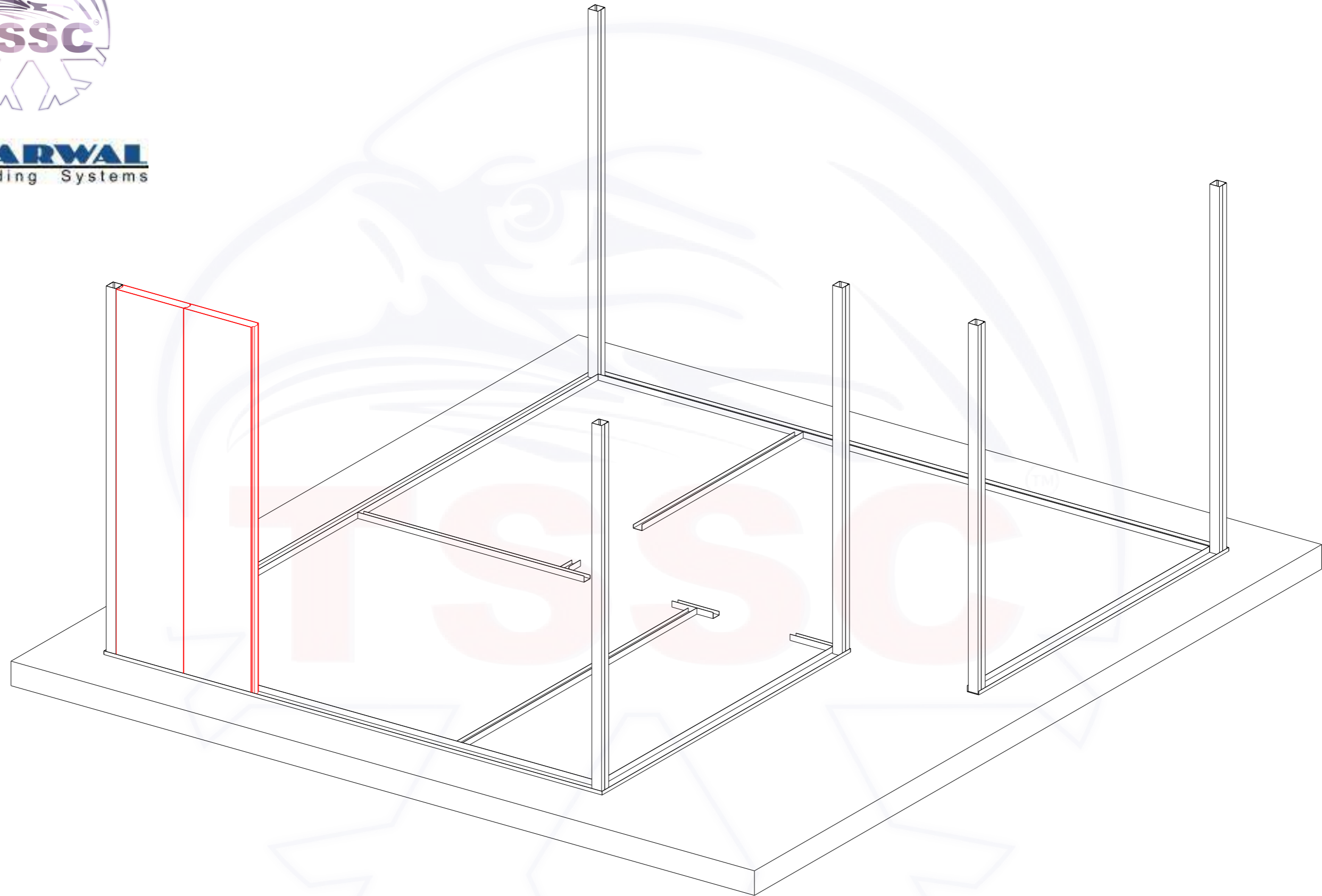

STEP 3: WITH REFERENCE TO WALL PANEL LAYOUT, INSTALL THE FIRST 2 EASYWALL PANELS



HARVAL
Building Systems

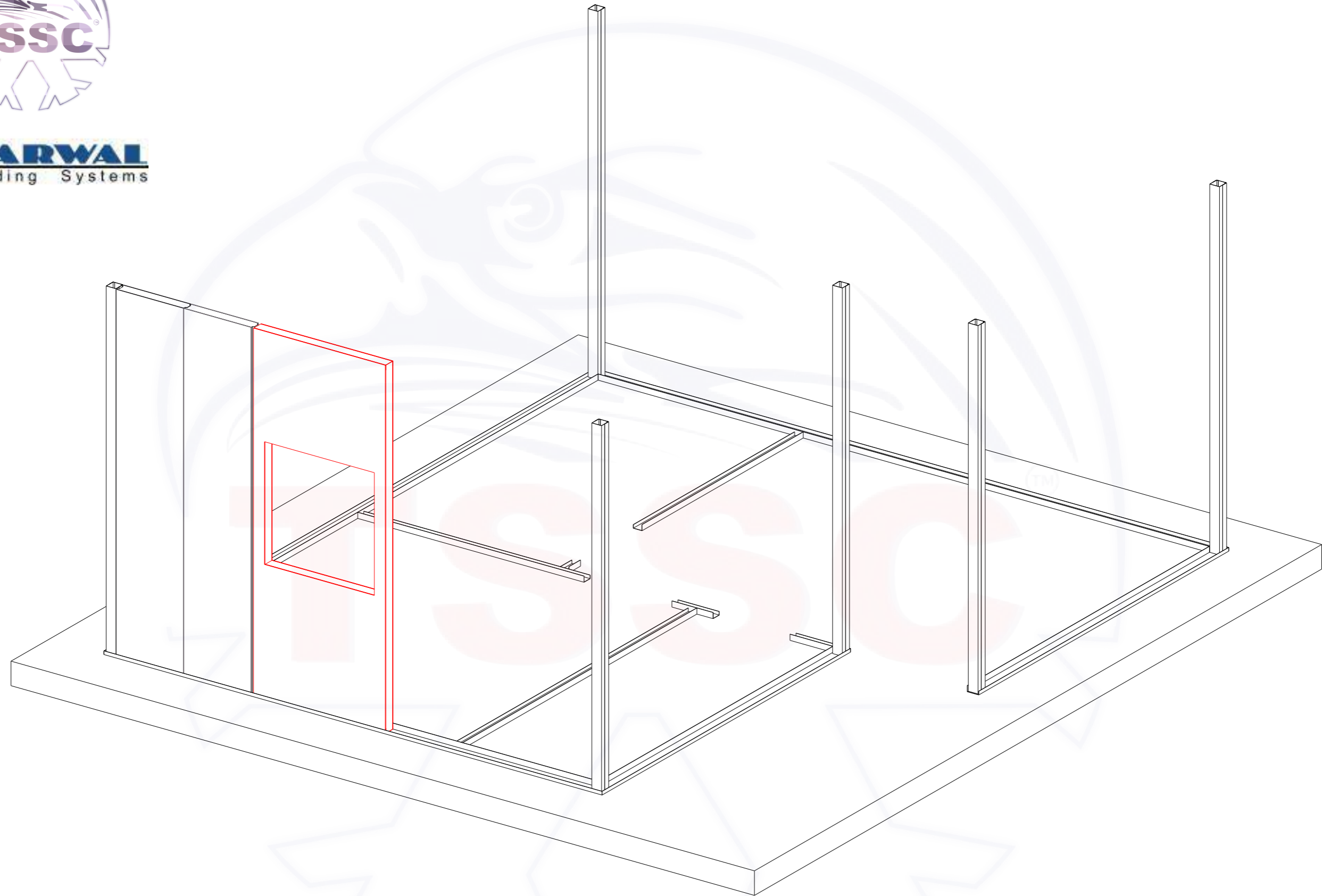

STEP 4: PLACE THE FIRST LGS FRAME FOR WINDOW OPENING

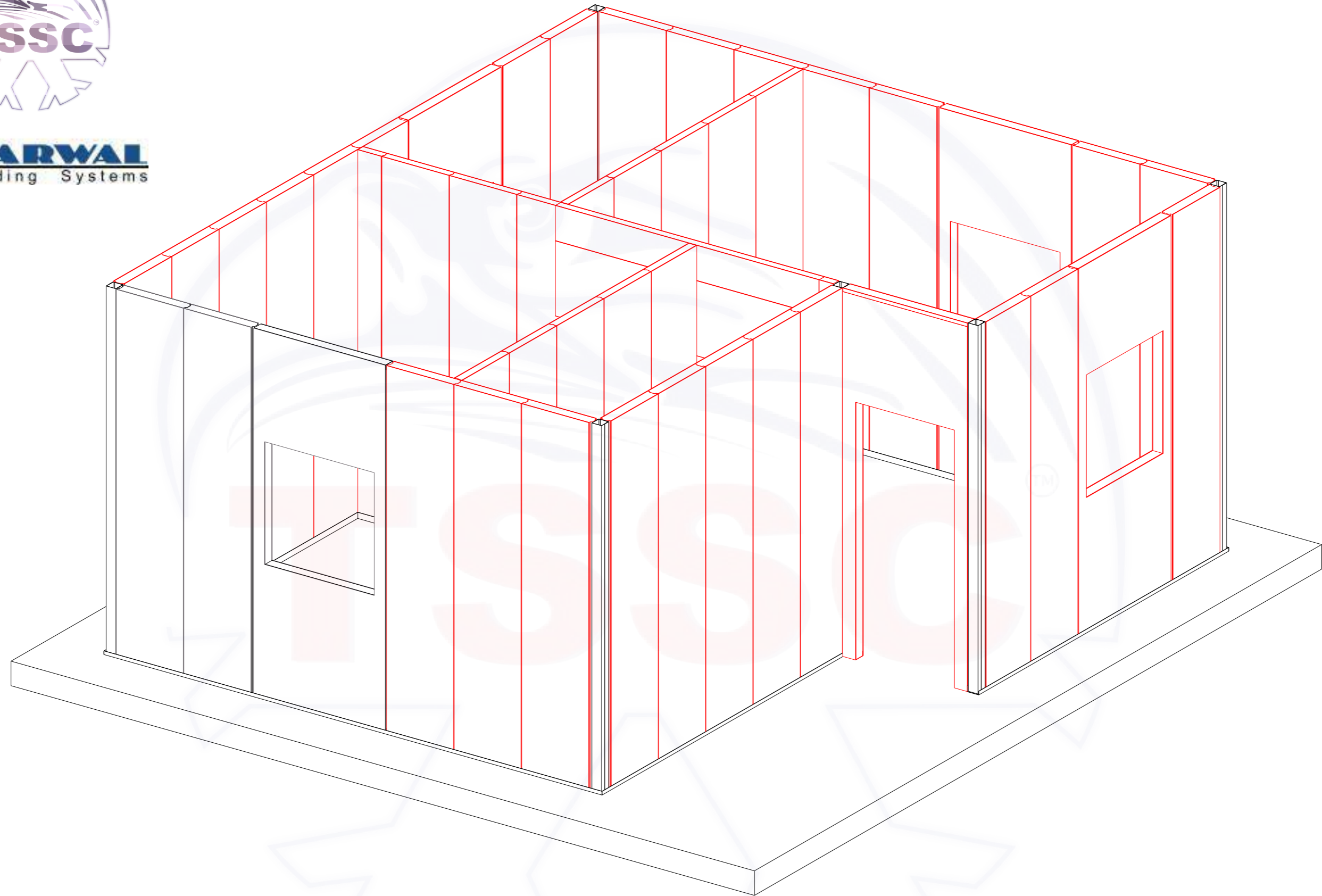

STEP 5: INSTALL ALL THE REMAINING EASYWALL PANELS AND LGS FRAMES

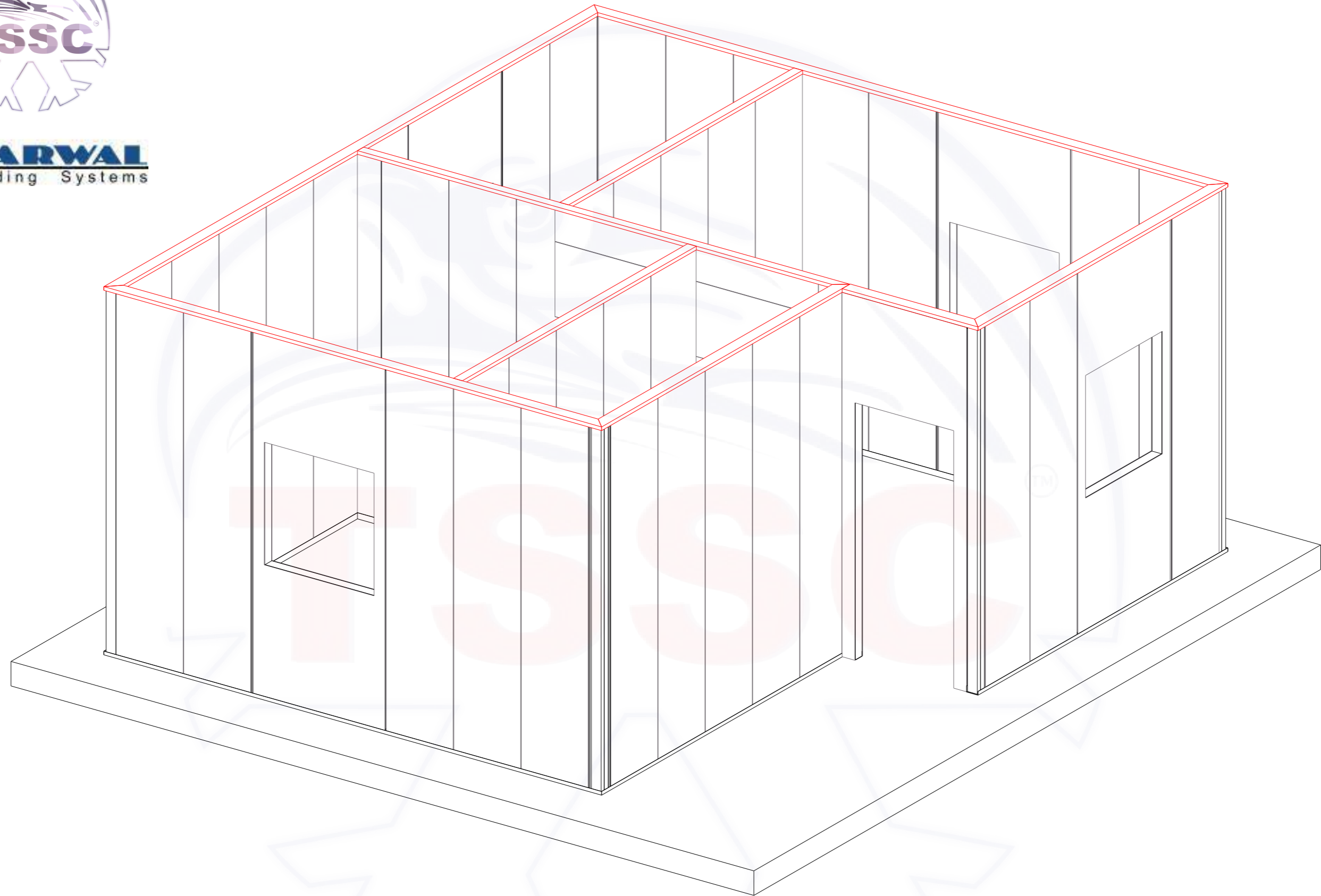

STEP 6: FIX THE TOP TRACKS (U CHANNEL)

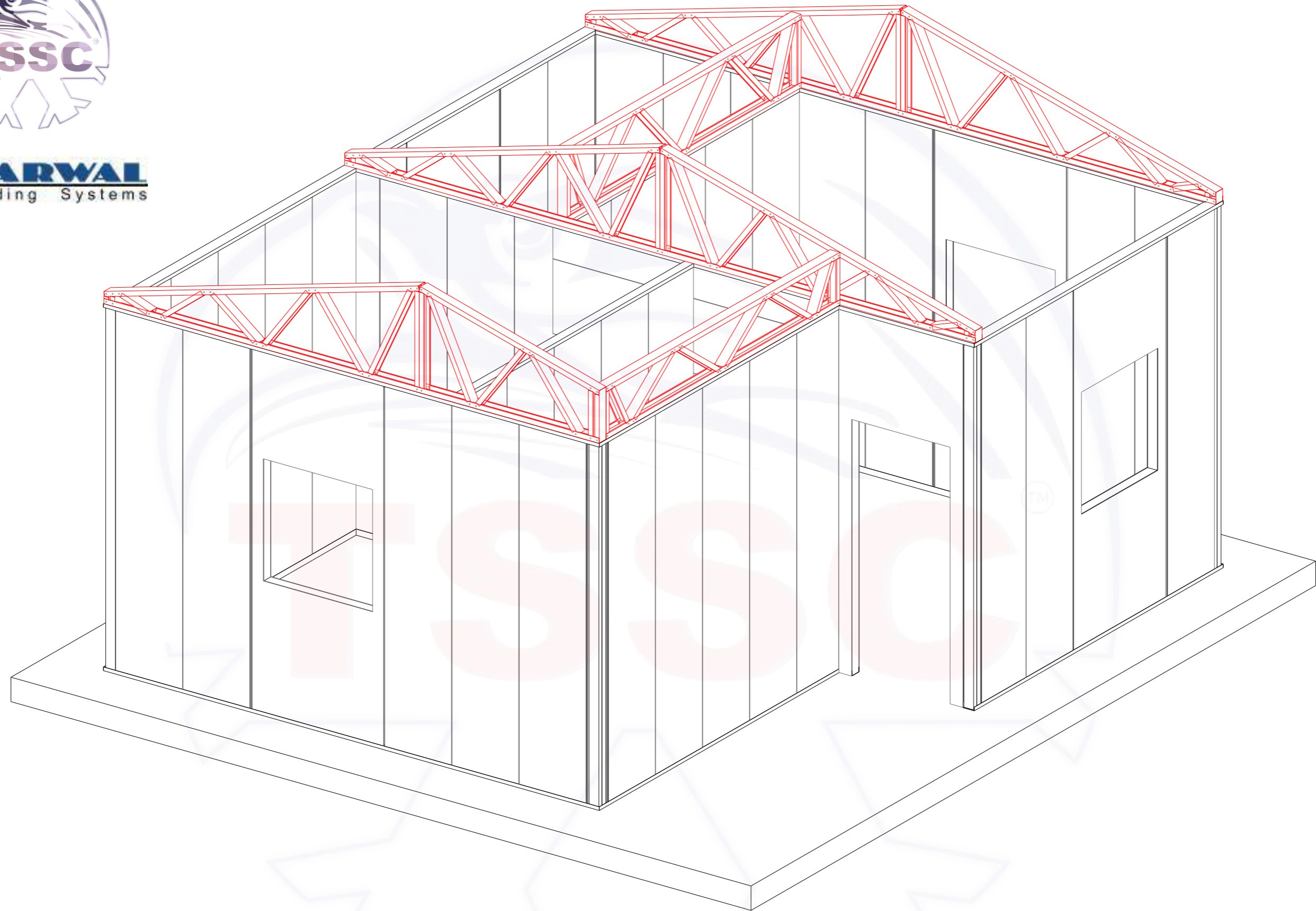

STEP 7: BASED FROM ROOF FRAMING PLAN, INSTALL THE ROOF TRUSSES



HARVAL
Building Systems

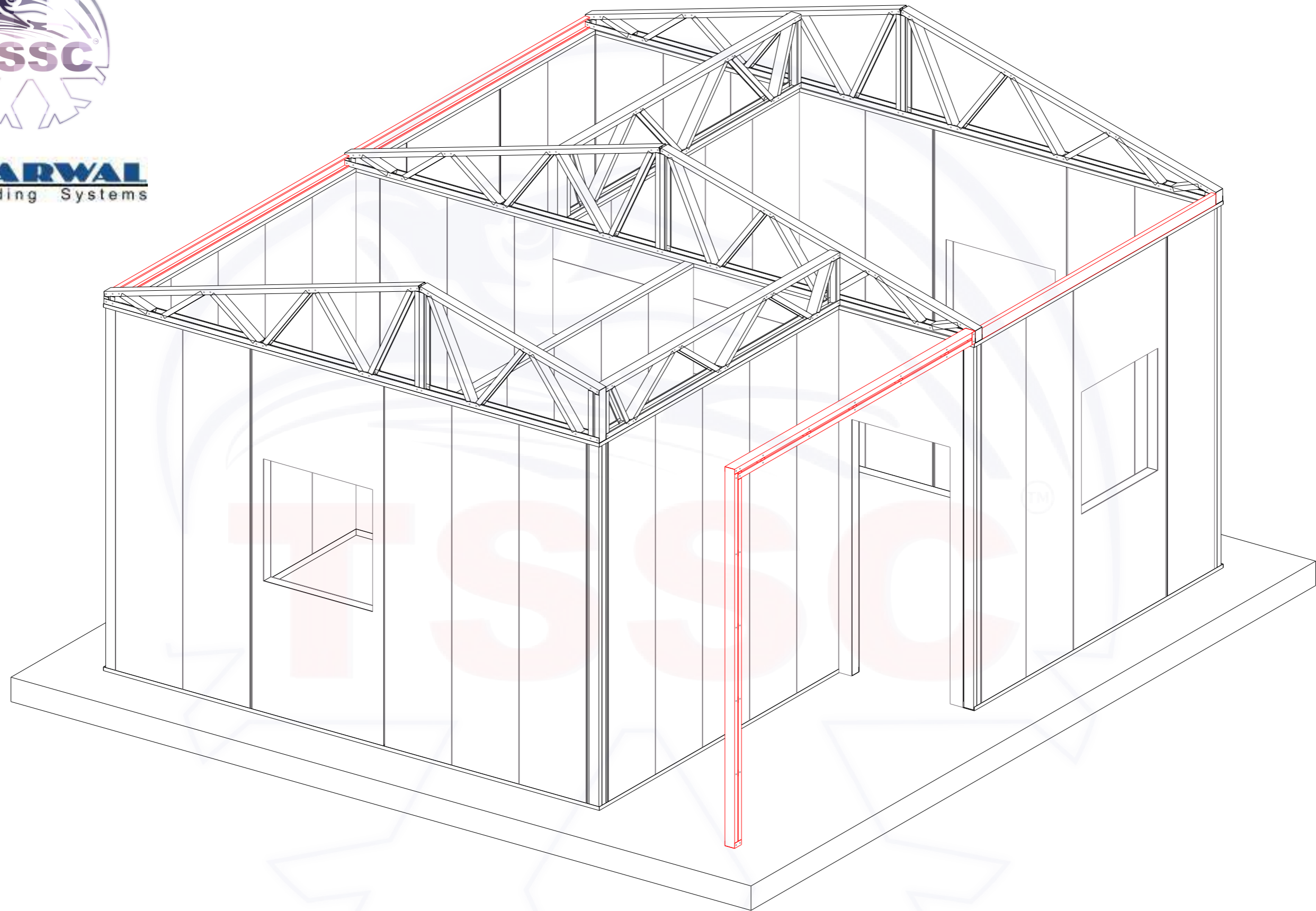

STEP 8: INSTALL THE COLUMN & BEAM AND EAVE PURLINS



HARVAL
Building Systems

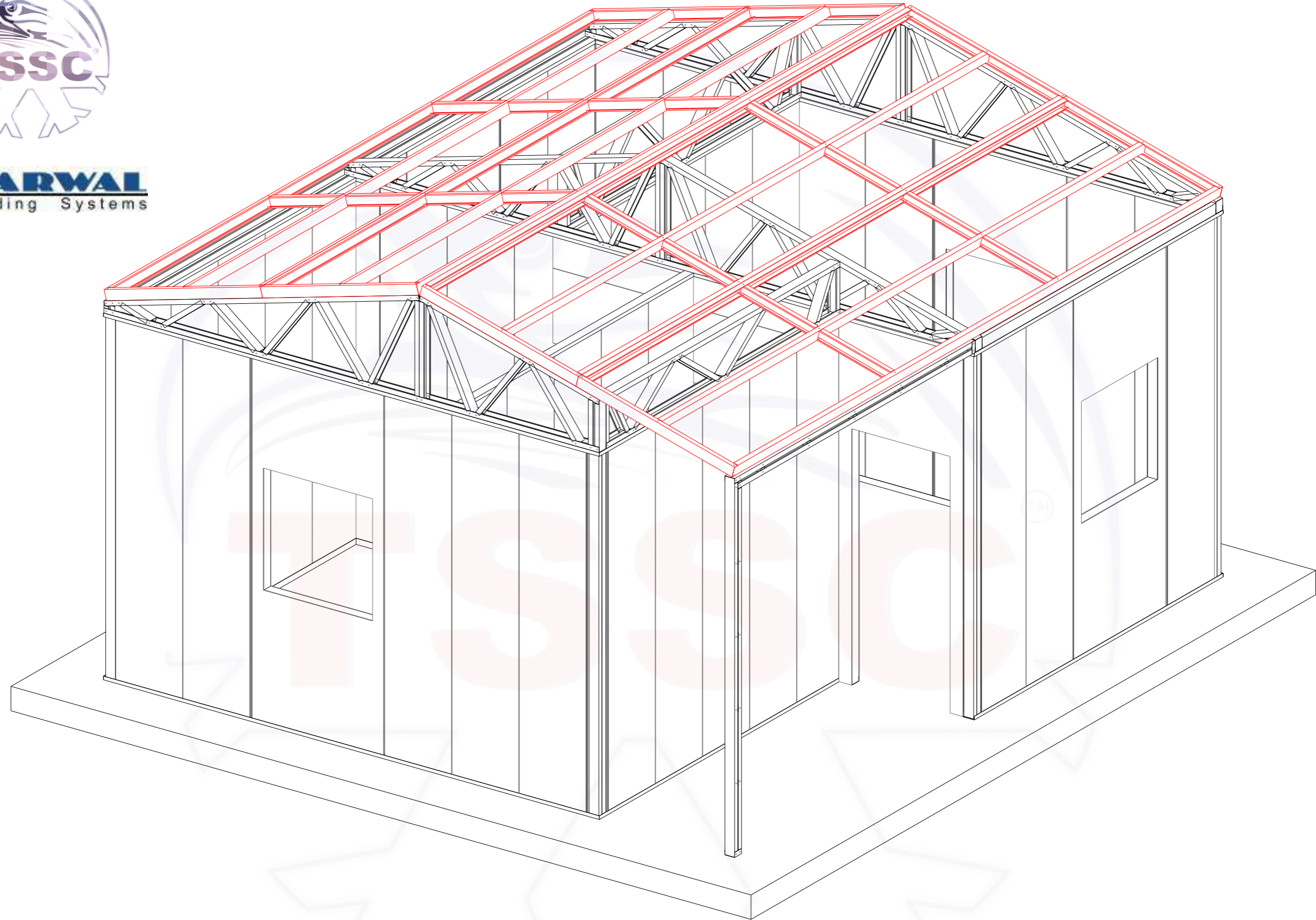

STEP 9: PLACE THE ROOF FRAME ON TOP OF ROOF TRUSSES

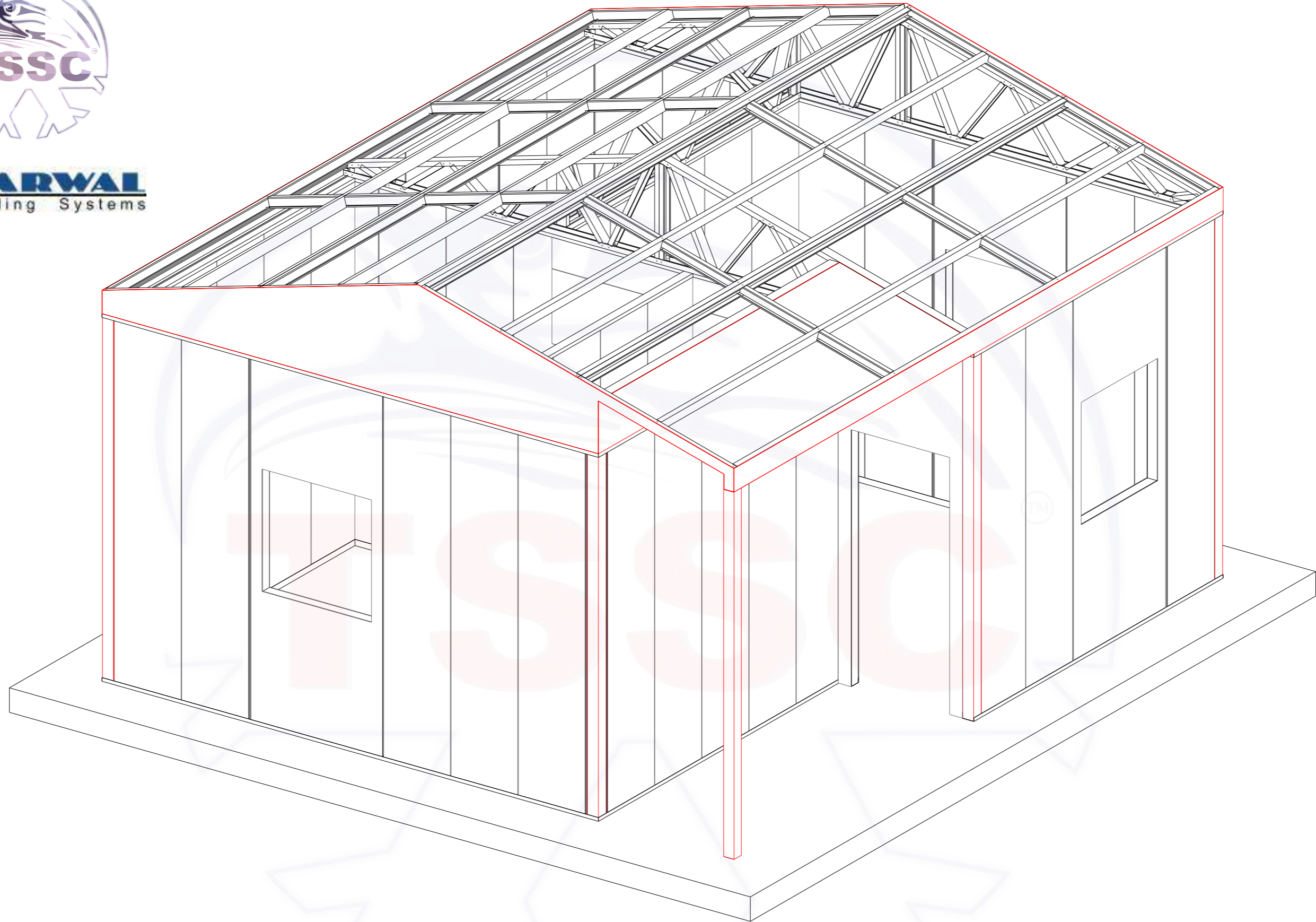

STEP 10: FIX THE CEMENT BOARD TO CORNER COLUMNS,
WALL AT GABLE SIDE AND SOFFIT



HARVAL
Building Systems

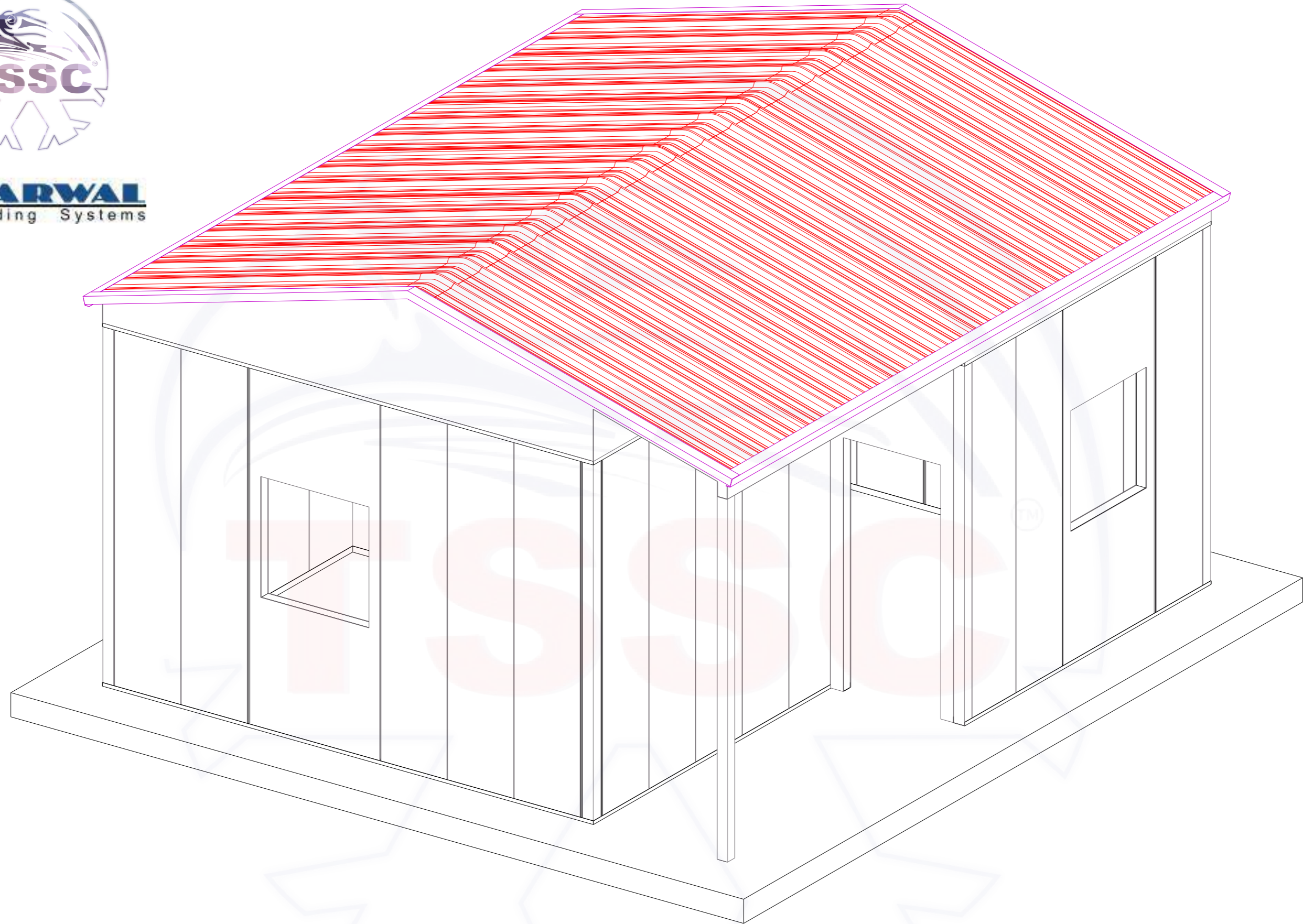

STEP 11: FIX THE ROOF SANDWICH PANELS AND FLASHINGS



HARVAL
Building Systems

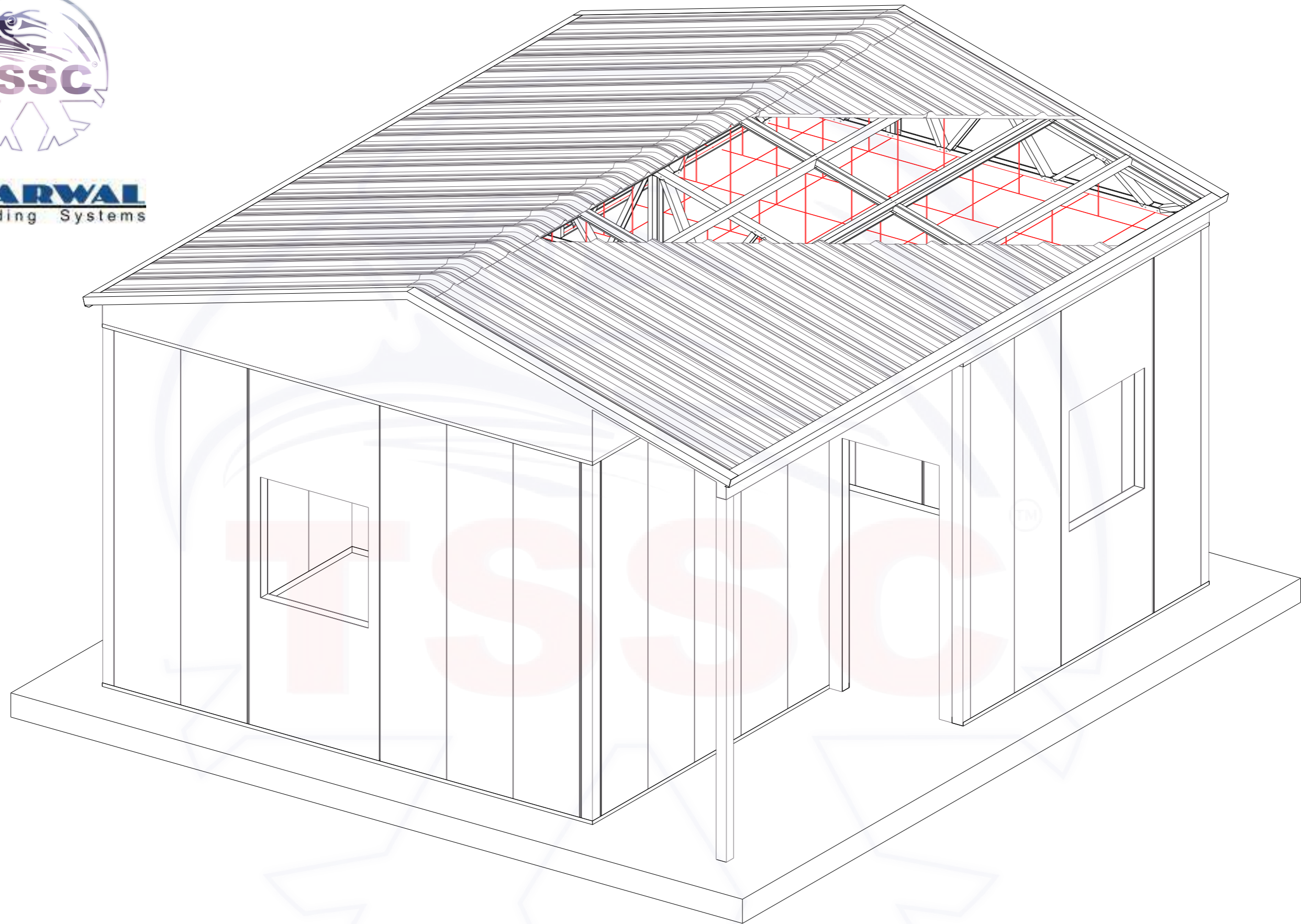

STEP 12: INSTALL THE FALSE CEILING
STEP 13: FIX THE DOORS & WINDOWS
STEP 14: MEP & FINISHING WORKS