

Assembly Manual v1.1
Z-AXIS LIFTING DEVICE

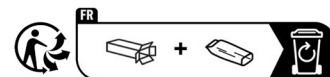

English

FDA CE FC    **RoHS** **MADE IN CHINA**

CONTENTS

Main Body

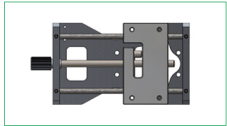

Sliding Plate ×1

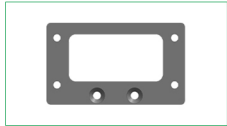

Fixing Plate ×1

Ortur Laser Master 2

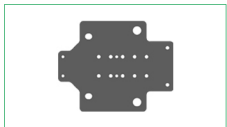

Laser Backboard ×1



Coupling ×1



M3×7×11mm Pillar Washers ×2



M3×20mm Self-tapping Screws ×4



M3x6mm Flat Cup Screws ×2

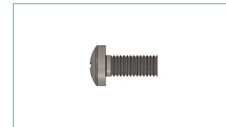

M3x10mm Screws ×4

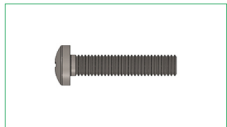

M3x20mm Screws ×2

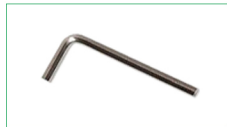

2.5mm Allen Wrench ×1



Support Blocks 3mm ×2



Support Blocks 5mm ×1

Ortur Laser Master 2 S2



Support Blocks 3mm ×2



Support Blocks 5mm ×1

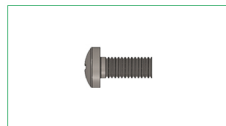

M3x10mm Screws ×4



M3×20mm Self-tapping Screws ×4



M3x6mm Flat Cup Screws ×2

Not all parts will be used, there are parts that are not needed for different models of machines.

Ortur Laser Master 2 Pro

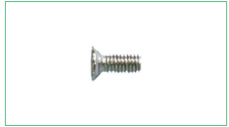

M3x6mm
Flat Cup Screws ×2

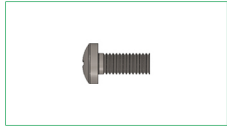

M3x10mm
Screws ×8

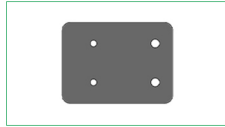

Y-axis
Extension Plate ×1

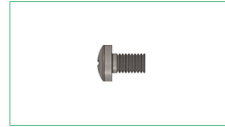

M2x4mm
Screws ×2

Aufero Laser 1

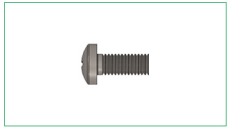

M3x10mm
Screws ×4

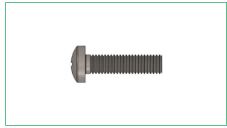

M3x16mm
Screws ×2



M3 T Nuts ×2

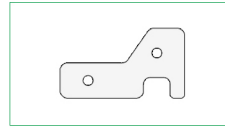

Limit Plate ×2

Aufero Laser 2

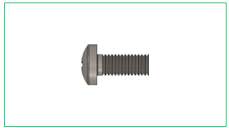

M3x10mm
Screws ×8



M3x6mm
Flat Cup Screws ×2

Not all parts will be used, there are parts that are not needed for different models of machines.

Ortur Laser Master 2

Assembly Steps (**NOTE:** The working area of the machine will be shortened to X390 x Y380 due to the addition of the Z-axis Lifting Device.)

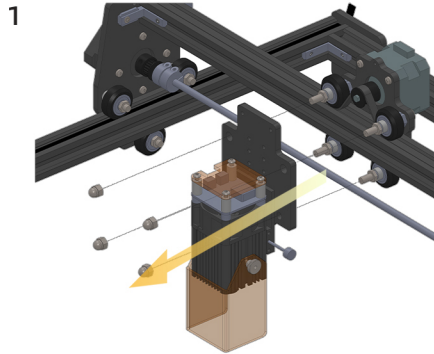

Remove the laser module

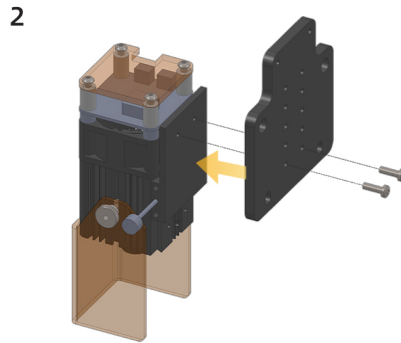

Remove the laser module

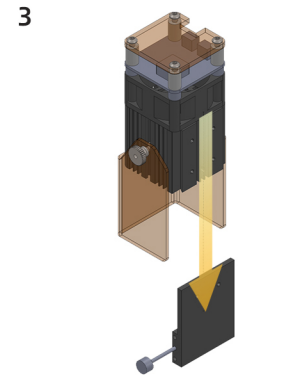

Remove the slider

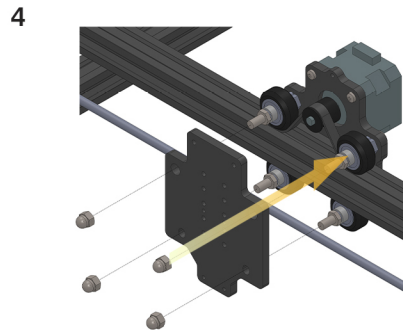

Install the laser backboard

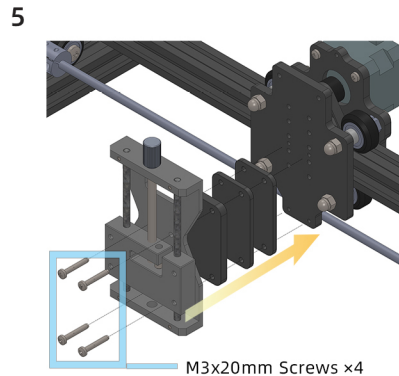

Install the sliding Plate

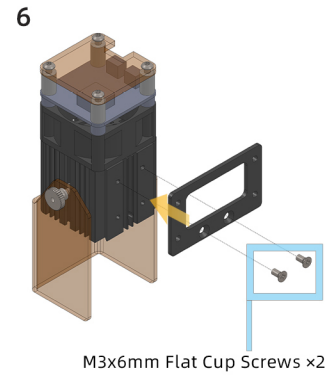

Install the fixing plate

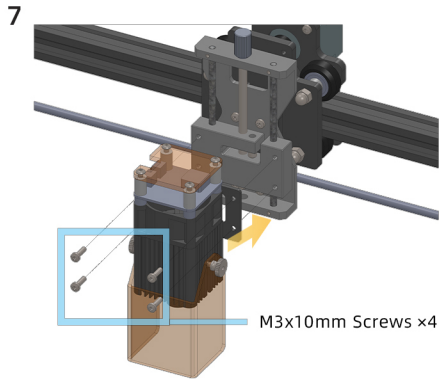

Install the laser module with the fixing plate to the sliding plate

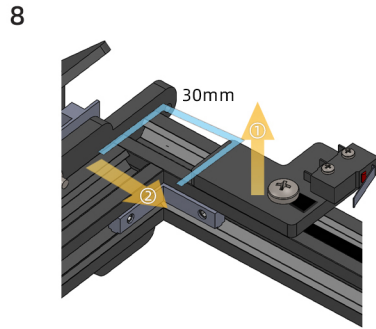

Loosen the screw, move the Y limit switch back 30 mm, and then tighten the screw to fix it

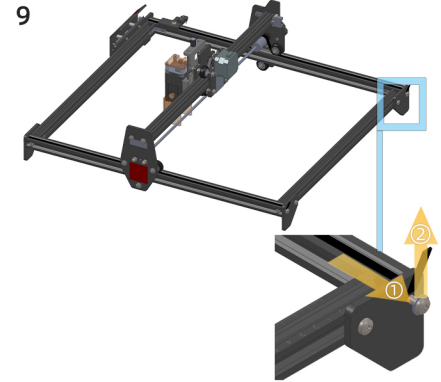

Loosen the screw, tighten the timing belt, and then tighten the screw to fix it

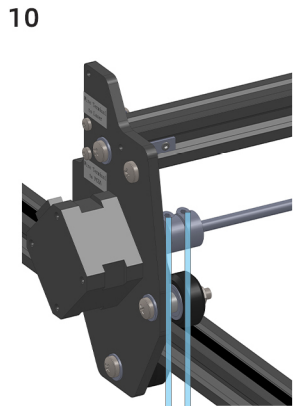

Loosen the screws

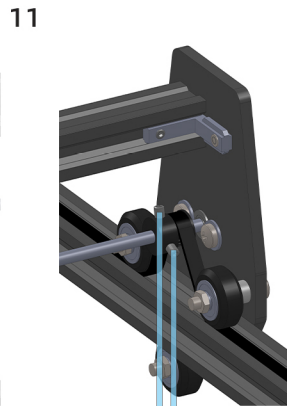

Loosen the two screws

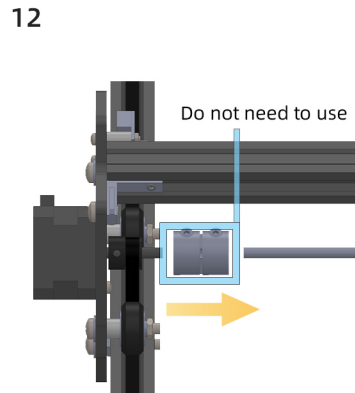

Disassemble the old Coupling

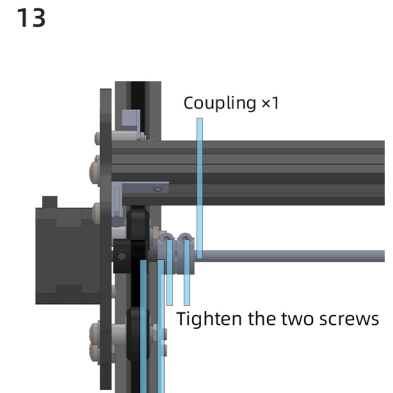

4mm

14

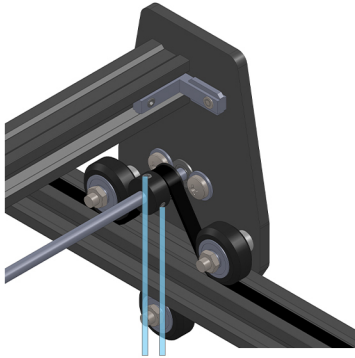

Tighten the two screws

15

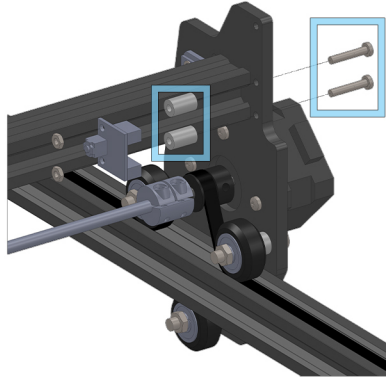

The parts in the box do not need to be used

16

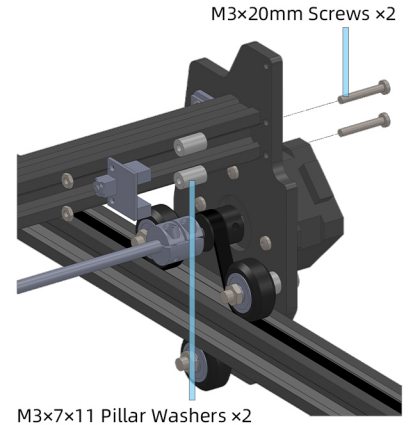

M3x20mm Screws x2

M3x7x11 Pillar Washers x2

Reinstall