

# Compressors, Chillers & Condensers

## CARLYLE OPEN DRIVE COMPRESSORS/ACCESSORIES SERVICE VALVES

### 5F COMPRESSORS

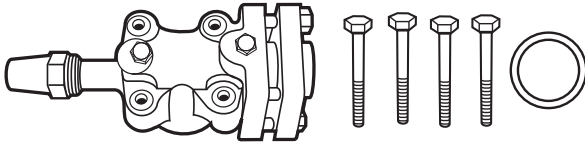

COMPRESSOR MODEL	SUCTION SERVICE VALVE PART NO.	DISCHARGE SERVICE VALVE PART NO.
5F20-S674	06DA660063	06DA660062
5F20-A684	06DA660063	06DA660062
5F20-S684	06DA660063	06DA660062
5F30-AI89	06EA660090	06DA660065
5F30-S644	06EA660090	06DA660065
5F30-A219	06EA660090	06DA660065
5F30-S664	06EA660090	06DA660065
5F40-A219	06EA660090	06DA660065
5F40-S219	06EA660090	06DA660065
5F60-A219	5F660-002	5F660-001
5F60-S219	5F660-002	5F660-001

### 5H COMPRESSORS

COMPRESSOR MODEL	SUCTION SERVICE VALVE PART NO.	DISCHARGE SERVICE VALVE PART NO.
5H40-(+)219	5H660-008	5F660-002
5H46-(+)219	5H660-008	5F660-002
5H60-(+)219‡	06LA660010	06LA660010
5H66-(+)219‡	06LA660010	06LA660010**
5H80-(+)219	06LA660010*	06LA660010**
5H86-(+)219	06LA660010*	06LA660010
5H120-(+)219‡	06LA660011	06LA660011
5H126-(+)219‡	06LA660011	06LA660011

(+) May be either "A" (Remanufactured) or "S" (New Manufactured).

‡ These Models require a suction and a discharge manifold in order to mount the service valve.

\* Requires a suction valve adapter (Part No.: 5H660-006).

\*\* Requires a discharge valve adapter (Part No.: 5H660-005).

### RELIEF VALVE KIT

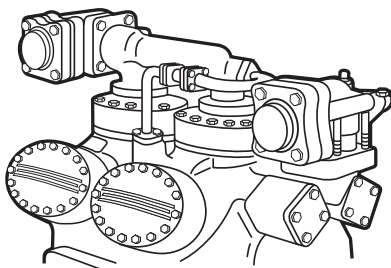

Compressor Models 5H 120 & 126  
Require the addition of a relief valve  
and associated piping.

P/N: 5H120-337

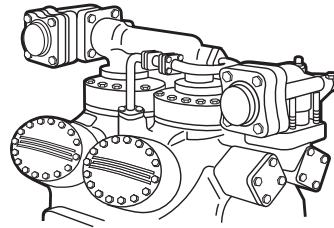

The Models listed requires a suction and discharge manifold in order to mount the service valve.

COMPRESSOR MODEL	SUCTION MANIFOLD PART	DISCHARGE MANIFOLD
5F60-A219	5F60-1094	NONE
5H60, 66	5H660-007	5H660-007
5H120, 126	5H660-001	5H660-003

### MUFFLERS



COMPRESSOR MODEL	MUFFLER PART NO	LENGTH (in)	CONN. SIZE (in)
5F20	06DA605614	11/1/2004	1-1/8 O.D.F
5F30, 40, 60	05HY500853	13-3/4	1-3/8 O.D.F
5H40, 46, 60, 66	05HY500863	22-5/8	2-5/8 O.D.F
5H80, 86, 120, 126	05HY501013	22-5/8	3-1/8 O.D.F

### EXTERNAL UNLOADER CONVERSION KIT

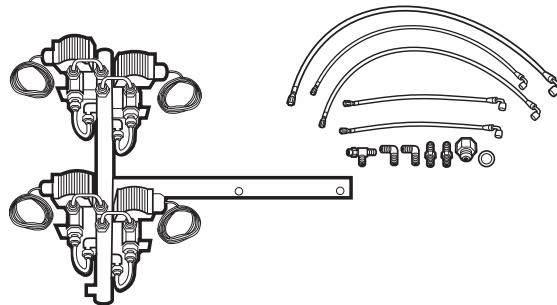

Kit is used to bypass the standard 5 line responds 5F40/5H126 cylinder unloading system that to suction pressure. A field supplied controller is used in conjunction with this kit to control solenoid valves that activate/deactivate cylinder unloaders. External capacity control results in more precise compressor capacity matching to the load.

COMPRESSOR MODEL	PART NO
5F40	5F40-4FI-A
5F60	5F60-4FI-A
5H40, 46	5H40-4FI-A
5H60, 66, 80, 86	5H60-4FI-A
5H120, 126	5H120-4FI-A

5F Kits contain hand hole cover.

5H Kits contain blankoff plates.

120 Volt solenoid coils.

Compressors,  
Chillers, Condensers

Motors

Electrical

Heating  
Components

Indoor Air  
Quality

Thermostats

Oils &  
Chemicals

Accessories, Supplies  
& Commodities

Tools &  
Instruments

Refrigeration

# Compressors, Chillers & Condensers

Compressors,  
Chillers, Condensers

Motors

Electrical

Heating  
Components

Indoor Air  
Quality

Thermostats

Oils &  
Chemicals

Accessories, Supplies  
& Commodities

Tools &  
Instruments

Refrigeration

## CARLYLE OPEN DRIVE COMPRESSORS/ACCESSORIES CRANKCASE HEATERS

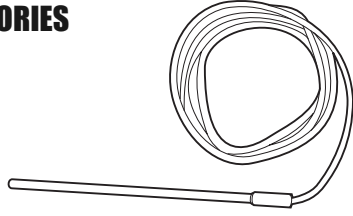

COMPRESSOR MODEL	PART NO	WATT S	VOLT S	LEAD LENGTH (IN.)	SHEATH LENGTH (IN.)
5F20, 30, 40, 60	HT31AZ120	100	120	48	7
5F20, 30, 40, 60	H731AZ240	100	240	48	7
5H40, 46, 60, 66, 80*, 86*, 120*, 126*	HT31AZ121	200	120	63	7
5H40, 46, 60, 66, 80*, 16*, 120*, 126*	HT31AZ241	200	240	63	7

\*These Models Require Two Heaters.

## CRANKCASE HEATER RELAYS

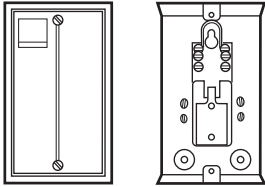

PART NO	COIL VOLTS
HN61AJ101	120
HN61AJ108	240

The Crankcase Heater Relay is used to energize the Heater when the compressor is not in operation. The Crankcase Heater Relay is not required when using 32 Series control panels.

## OIL SAFETY SWITCH

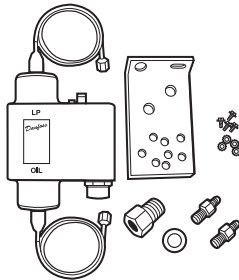

KIT	PART NO		PRESSURE DIFFERENTIAL CUT				
	CONTROL ONLY	TIME DELAY	CONNECTION	IN	OUT	VOLTS	RESET
5F20-212	P529-4120	45 Sec- onds	36" Lg. Cap w/1/4" Fl. Nuts	15-20 psi	11-15 psi	115/230	Manual

## OIL COOLER PACKAGE

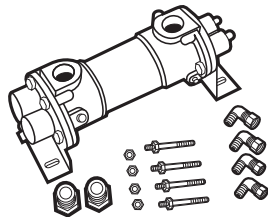

COMPRESSOR MODEL USED ON	PART NO
All 5F	5F20-B103
5H40, 46, 60, 66, 80, 86	5H40-B283
5H120, 126	5H120-B283

## OIL FILTER PACKAGE

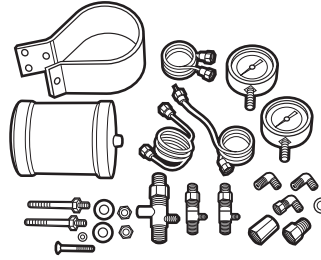

Package Includes:  
(1) partial flow oil filter with fittings, (2) angle valves, tubing and (2) oil pressure gauges. All 5H120, 126 are supplied standard with a full flow oil filter.

Use on: 5H40, 46, 60, 66, 80, 86 compressor models

P/N: 5H40-A274

OIL FILTER ONLY . . . P/N: 05HG660020

## CAPACITY CONTROL VALVE PACKAGE

For use on 5F20,30 compressors.

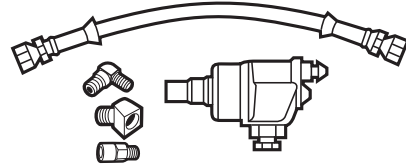

COMPRESSOR MODEL	PART NO	REFRIGERANT USAGE
5F20, 30	5F20-752	R-12
5F20, 30	5F20-A752	R-22,R-502

## FELT FILTER KIT

Felt Filters are installed in the compressor's suction strainer as a temporary clean up medium.

NOTE: Filter Kit is included with service compressors.

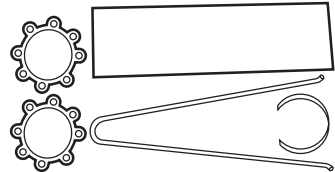

COMPRESSOR MODEL	KIT	FILTER ONLY	FILTERS REQUIRED PER COMP
5F40, 46	5F40-A352	5F40-3792	1
5F60, 66	5F60-A352	5F60-3792	2
5H40, 46	5H40-A382	5H40-4032	1
5H60, 66	5H60-A382	5H60-4032	2
5H80, 86	5H80-A382	5H80-4032	1
5H120, 126	5H120-A382	5H120-4552	2

## DOWEL PIN

P/N: AX35AA238



Tapered dowel pin (no. 6 x 2-3/4" long) is used to maintain alignment and to ensure exact compressor/ motor repositioning after service. Two Pins are required for both motor and compressor. (Pins for motor are included in motor fastening package.)

# Compressors, Chillers & Condensers

## CARLYLE OPEN DRIVE COMPRESSORS/ACCESSORIES

### WATER-COOLED HEAD PACKAGE 5H COMPRESSORS

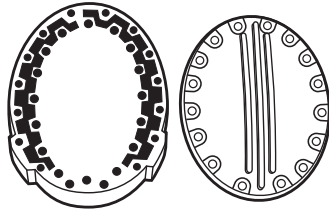

Water Cooled Heads are required for compressors used on low temp R-22 applications. See Compressor Ratings on pages 4 & 5 for application ranges. The water cooled head packages listed contain the necessary heads, covers, gaskets, and fittings to convert standard 5F/H compressors to water cooled heads.

COMPRESSOR MODEL	PART NO
5H40, 46	5H40-507
5H60, 66	5H60-507
5H80, 86	5H80-507
5H120, 126	5H120-507
5F20	5F20-172
5F30	5F30-172
5F40	5F40-172
5F60	5F60-172

## DRILL & REAMER KIT

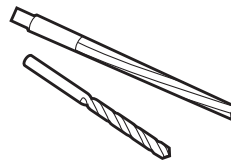

Drill and reamer kit includes a 9/32 in. drill bit and a no.6 taper reamer to facilitate installation of the no.6 tapered dowel pin.

**P/N: 5H40680004**

## VIBRATION ISOLATORS

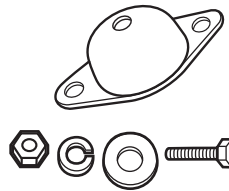

VIBRATION ISOLATORS limit the transfer of vibration. They are attached underneath the surface to which the compressor is mounted. Four isolators are supplied in each package. One for each corner of the unit. Associated hardware is also included. Select proper size isolator by dividing total unit weight by 4.

PART NO	ISOLATOR LOADING LBS/ISOLATOR
5F20-623	90 to 150
5F30-623	150 to 210
5F60-633	210 to 290
5F60-663	290 to 390
5H40-653	350 to 450
5H60-673	450 to 650
5H80-673	650 to 950
5H120-467	950 to 1250
5H120-527	1250 to 1550

## FLEXIBLE STEEL COUPLINGS FOR DIRECT DRIVE UNITS

NOTE: A Dial Indicator must be used to properly align the compressor and motor shafts for reliable operation.

When 5H126-623 coupling is used with a 404T or 405T frame motor, field boring is required. Enlarge motor bore to 2.875/2.875 in. diameter. Increase Keyway size to 3/4 x 3/8 in.

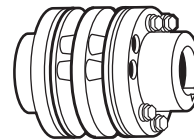

COMPRESSOR MODEL	PART NO	H P	FRAME SIZE	SHAFT DIA (in)	MAXIMUM COUPLING HP RATING	WT (lbs)
5F20, 30	5F20-847	7-1/2, 10	213T, 215T	1.375	11.5	10
5F20, 30	5F30-847	15	254T	1.625	17.5	10
5F40, 60	5F40-603	7-1/2, 10	213T, 215T	1.375	17.5	15
5F40, 60	5F40-623	15	254T	1.625	17.5	15
5F40, 60	5F60-623	20	256T	1.625	30	21
5F40, 60	5F60-613	25,30	284T, 286T	1.875	34.5	21
5H40, 46	5H40-613	20	256T	1.625	34.5	21
5H40, 46	5H60-613	25,30	284T, 286T	1.875	65	24
5H40, 46	5H60-613	40,50,60	324TS, 326TS, 364TS	1.875	65	24
5H40, 46	5H60-623	40,50	324T, 326T	2.125	65	24
5H40, 46	5H80-613	60	364T	2.375	86	30
5H60, 66	5H60-613	30	286T	1.875	65	24
5H60, 66	5H60-613	40,50,60	324TS, 326TS, 364TS	1.875	65	24
5H60, 66	5H60-623	40,50	324T, 326T	2.125	65	24
5H60, 66	5H80-613	60,75	364T, 365T	2.375	86	30
5H60, 66	5H80-663	75	365TS	1.875	86	30
5H60, 66	5H120-623	100	404TS	2.125	150	35
5H80, 86	5H60-613	40,50,60	324TS, 326TS, 364TS	1.875	65	24
5H80, 86	5H60-623	40,50	324T, 326T	2.125	65	24
5H80, 86	5H80-613	60,75	364T, 365T	2.375	86	30
5H80, 86	5H80-663	75	365TS	1.875	86	30
5H80, 86	5H120-623	100	404TS, 405TS	2.125	150	35
5H120, 126	5H60-613	60	364TS	1.875	65	24
5H120, 126	5H80-613	60,75	364T, 365T	2.375	86	30
5H120, 126	5H80-663	75	365TS	1.875	86	30
5H120, 126	5H120-623	100,125	404TS, 405TS	2.125	150	35
5H120, 126	5H126-623 *	100,125	404T, 405T	2.875	200	40
5H120, 126	5H126-623 *	150,200	444TS, 445TS	2.375	200	40

# Compressors, Chillers & Condensers

Compressors,  
Chillers, Condensers

Motors

Electrical

Heating  
Components

Indoor Air  
Quality

Thermostats

Oils &  
Chemicals

Accessories, Supplies  
& Commodities

Tools &  
Instruments

Refrigeration

## CARLYLE OPEN DRIVE COMPRESSORS/ACCESSORIES

### MOTOR FASTENING KITS FOR DIRECT DRIVE APPLICATIONS

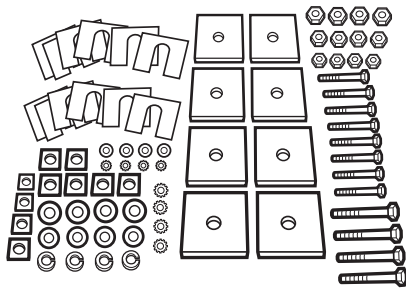

Motor Fastening Kit includes steel blocks and shims to align motor shaft to compressor shaft, hardware to attach motor to base and tapered dowel pins to pin motor to base and lock in alignment. Not enough memory to convert the items on the clipboard.

MODEL	SHAFT HT (in)	H P	FRAME SIZE	SHAFT HT (in)	PART NO
5F20, 30	6-1/4	7-1/2,10	213T, 215T	5/1/2004	5F40-401
5F20, 30	6-1/4	7-1/2,10	213T, 215T	6/1/2004	5F40-801
5F20, 30	6-1/4	15	254T	5/1/2004	5F40-801
5F40, 60	8	7-1/2,10	213T, 215T	6/1/2004	5F40-801
5F40, 60	8	15,20	254T, 256T	7	5F40-401
5F40, 60	8	25,30	284T, 286T	6/1/2004	5F40-401
5H40, 46	9	20	256T	7	5F40-801
5H40, 46	9	25,30	284T, 286T	8	5H40-401
5H40, 46	9	40,50	324, 326 T/Ts	9	5F40-401
5H40, 46	9	60,75	364, 365 T/TS	7	5F60-401
5H60, 66	9	30	286T	8	5H40-401
5H60, 66	9	40,50	324, 326 T/TS	9	5F40-401
5H60, 66	9	60,75	364, 365 T/TS	10	5F60-401
5H60, 66	9	100	404 T/TS	8	5F60-401
5H80, 86	9	40,50	324, 326 T/TS	9	5F40-401
5H80, 86	9	60,75	364, 365 T/TS	10	5F60-401
5H80, 86	9	100,125	404, 405 T/TS	9	5F60-401
5H120, 126	11	60,75	364, 365 T/TS	10	5H40-401
5H120, 126	11	100,125	404, 405 T/TS	11	5F40-401
5H120, 126	11	150,200	444, 445 TS		5F60-401

NOTE: Motor Fastening kit approximate shipping weight is 42 lbs.

### MOTOR FASTENING KIT FOR BELT DRIVE APPLICATIONS

Motor Fastening Kit attaches motor to base. Kit includes: bolts, nuts and washers.

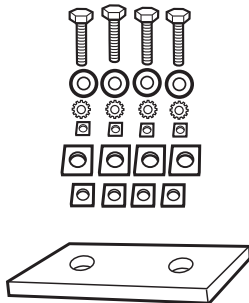

COMPRESSOR MODEL	PART NO	SIZE	FRAME SIZE
5F20, 30	5F20-821	5, 7-1/2, 10	184T, 213T, 215T
5F30	5F30-821	15	254T
5F40, 60	5F20-821	7-1/2, 10, 15, 20, 25	213T, 215T, 254T, 256T, 284T
5H40	5F30-821	20, 25, 30, 40, 50	256T, 284T, 286T, 324T, 326T
5H60	5F30-821	40, 50	324T, 326T
5H60	5H40-711	40, 50, 60, 75	324T, 326T, 364T, 365T
5H80, 120	5H40-711	40, 50, 60, 75, 100, 125, 150	324T, 326T, 364T, 365T, 404T, 405T, 444T

Compressor Mounting Block is used when a 5H66,80,86 is matched to a 100 Hp motor, or when a 5H86 is matched to a 125 Hp motor. The block raises compressor to allow alignment between compressor and motor shaft. Two blocks are required per compressor.

P/N: 5H40-1422