

# Brockway 3, 4, & 5-Light Pendant

**TFC1075, TFC1094, TFC1103 | 1.0**

## GENERATION LIGHTING PENDANT

### GENERAL PRODUCT INFORMATION:

These fixtures are intended to be installed utilizing NEC compliant junction boxes.

This product is safety listed for damp locations.

Incandescent version may be dimmed with a standard incandescent dimmer. LED version may be dimmed with a LED dimmer. Consult lamp manufacturer for additional information.

This instruction shows a typical installation.

### CAUTION - RISK OF FIRE

This product must be installed in accordance with the applicable installation code by a person familiar with the construction and operation of the product and the hazards involved.

**Use minimum 90°C supply conductors.**

**SAVE THESE INSTRUCTIONS!**

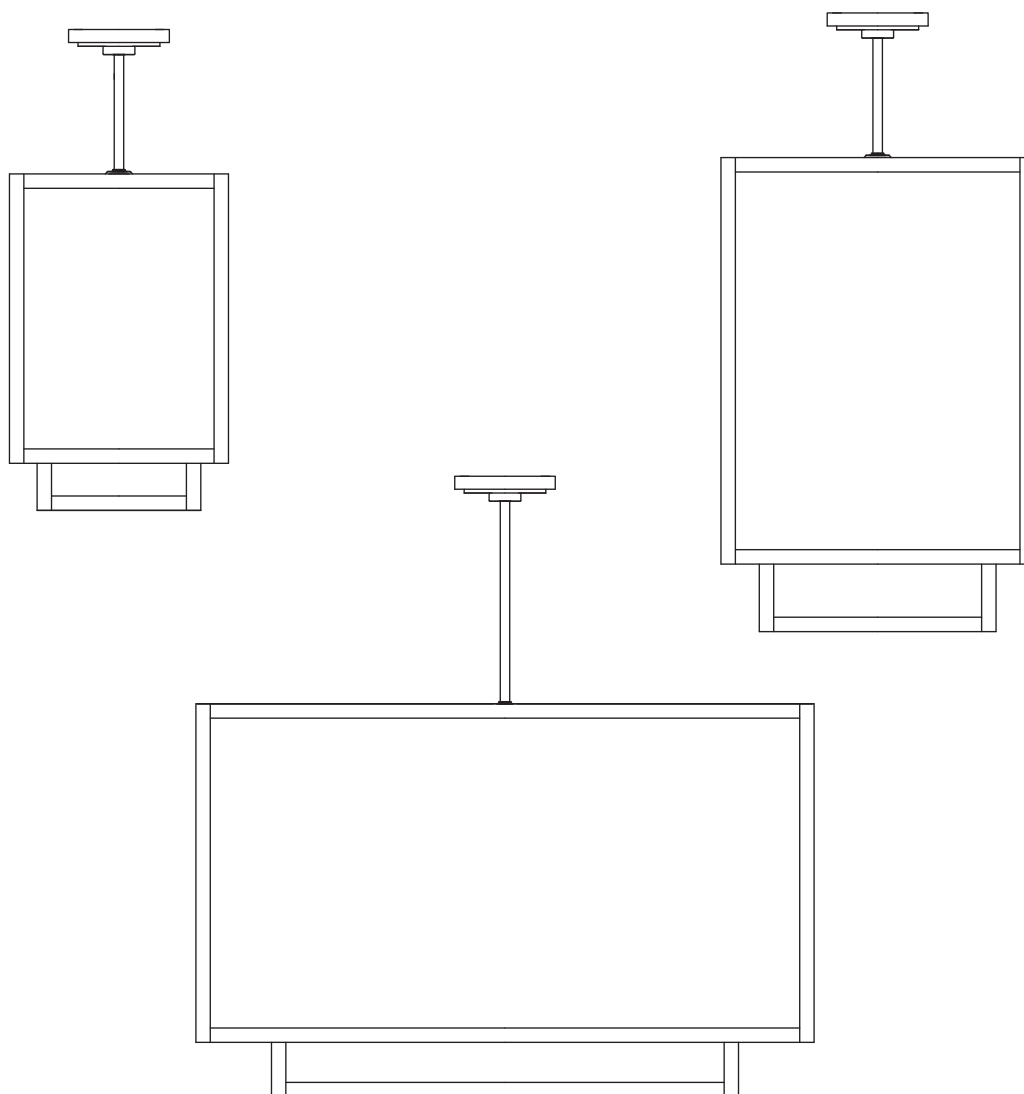

GENERATION LIGHTING

7400 Linder Ave., Skokie, IL 60077

T 847.410.4400 | F 847.410.4500

[www.generationlighting.com](http://www.generationlighting.com)

# Install the Fixture

1A

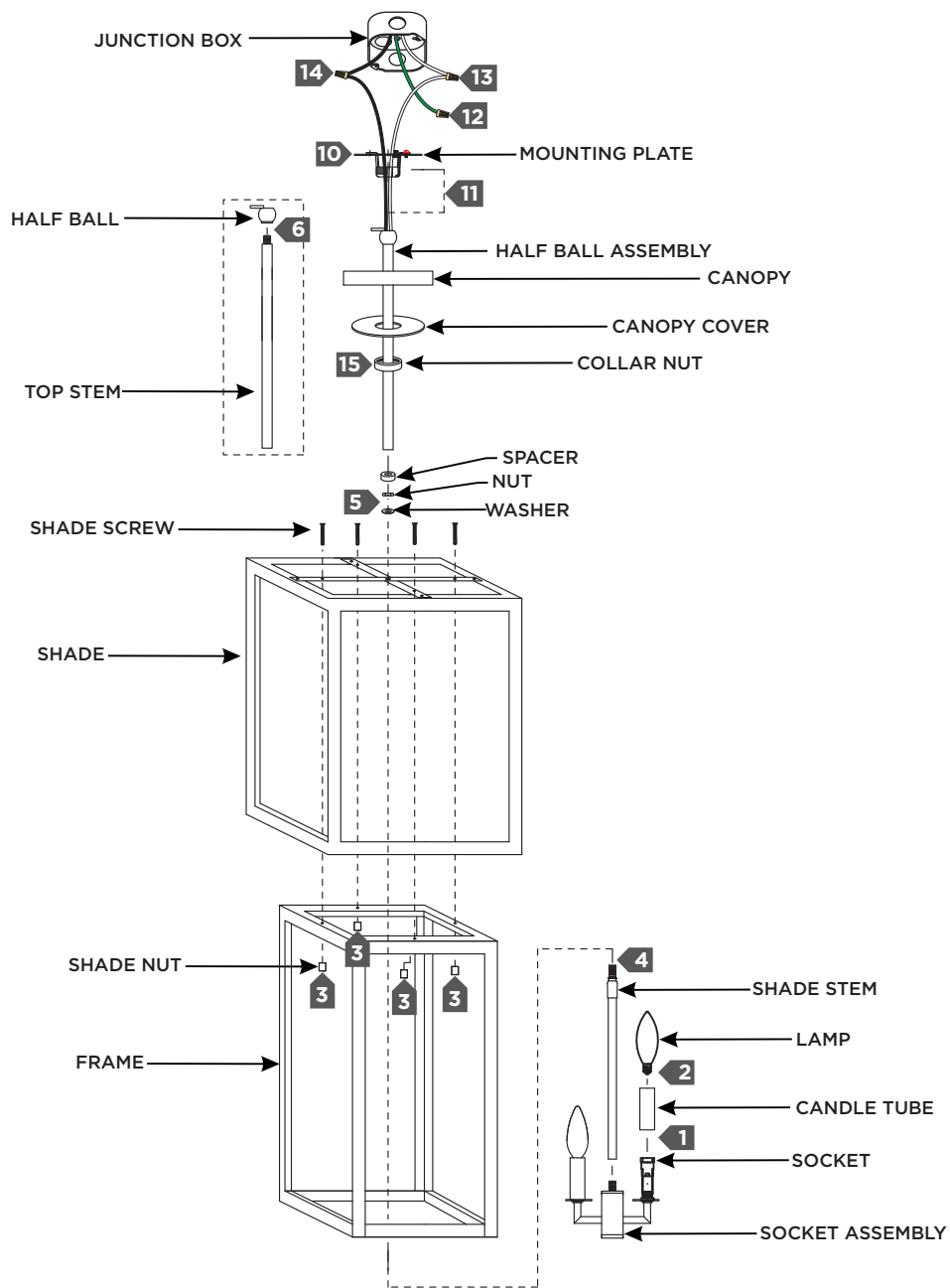

- 1 Place the candle tubes over the sockets.
- 2 Screw the lamps into the sockets. Refer to the label on the lamp socket for Max Wattage Information.
- 3 Assemble the shade to the frame by lining up the holes on top, then secure them together with the shade screws and nuts.
- 4 Feed the fixture wires through the shade stem and screw it onto the socket assembly.
- 5 Feed the fixture wires through the shade/frame assembly, insert the shade stem threads into the shade, and secure them together with the washers and nuts.
- 6 Screw the half ball to the top stem.
- 7 Determine the wanted height or look of the fixture with the stems, then assemble them by screwing them together.
- 8 Feed the fixture wires through the stem assembly, place the spacer on the shade stem threads, then screw the stem assembly onto the shade stem.
- 9 Feed the fixture wires through the collar nut, canopy cover, canopy, and the half ball assembly then screw them onto the stem assembly.
- 10 Secure the mounting plate to the junction box.
- 11 Slide the half ball assemblies onto the mounting plate.
- 12 Connect the fixture to a suitable ground in accordance with local electrical codes.
- 13 Connect the white fixture wire (square and/or rigid) to the neutral power line wire with a wire nut.
- 14 Connect the black fixture wire (round and/or smooth) to the hot power line wire with a wire nut.
- 15 Neatly place all the wires into the junction box, place the canopy and canopy cover onto the mounting plate, and secure it in place by screwing the collar nut tightly onto the mounting plate.