

## Instructions

# Bellevue AJ9 Arne Jacobsen 1929

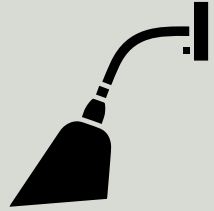

---

Please read these instructions carefully and retain them for future reference to ensure the product is used correctly. For your own safety, please study each step of this instruction manual first. &Tradition is not responsible for any faults or damage caused by not following these instructions correctly. Do not modify this product in any way. If you have any questions or comments, please do not hesitate to contact us by mail on: [info@andtradition.com](mailto:info@andtradition.com)

&Tradition®

Bellevue AJ9  
Arne Jacobsen  
1929

A

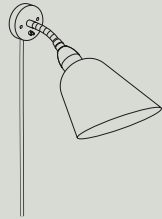

B



C



**Safety precautions**

- Dispose of plastic bag from packaging and do not allow children to play with it.
- Keep product well out of children's reach.
- The lamp is only intended for interior use.
- Consult a professionally qualified electrician if in any doubt.
- Do not place the cable within reach of small children or anywhere with a risk of falling over it.
- If the external cable or cord of this lamp is damaged, it must be replaced by the manufacturer or a similar qualified person in order to avoid a hazard.
- To reduce the risk of strangulation, wiring should be effectively fixed to the wall. Avoid trailing cable to prevent trip hazards and keep out of reach of children.

**Contents**

- A Wall lamp fitted with 2 meter cord
- B 2 x screws (for mounting the lamp to the wall bracket)
- C Wall bracket

**Tools needed**

- Bulb type E14
- Screwdriver
- Screws and plugs appropriate for wall

**Cleaning instructions**

- The Bellevue lamp is made from solid brass and lacquered aluminum. The brass used is uncoated and will therefore develop a unique and beautiful patina over time.
- Wipe surface of lamp shade with a soft, damp sponge or cloth, and wipe immediately after with a dry cloth.
- Do not use any abrasive cleaning tools such as steel wool, scouring sponges or stiff brushes.
- Never use strong cleaning agents such as white spirit, terpentine household glass cleaner or cellulose thinners.
- Only wipe the inside of the shade with a soft, damp cloth or feather duster.

06/23

For indoor use only  
E14 Maximum 25W  
Bulb not included



&Tradition®

For standard installation please follow step 1-6  
For hard-wired installation please follow step 7-16

**Step 1 / 16**

Ensure the power cord can be connected so it is not over-stretched or an obstacle. Place the wall bracket (C) on top of a spirit level in the desired location for the lamp. Ensure the mount is level and mark the placement of the holes with a pencil.

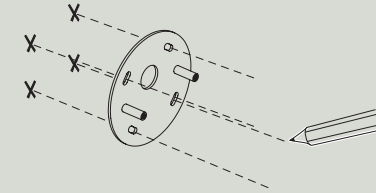

**Step 2 / 16**

Drill the holes for the bracket and use the correct type of screw and plug for the type of wall which the lamp is to be fitted to. Tighten the screws and ensure the bracket is safely fixed in place.

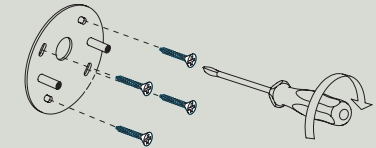

**Step 3 / 16**

Place the lamp (A) over the wall bracket. Align the screw holes of the lamp with the bracket and tighten the screws (B) with a Hex/Allen key.

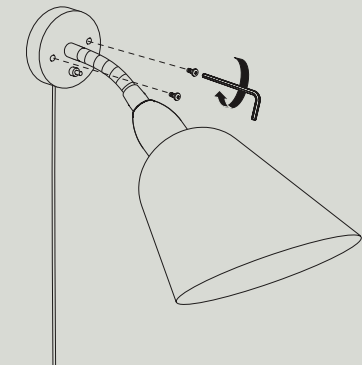

&Tradition®

#### Step 4 / 16

Install the light bulb.

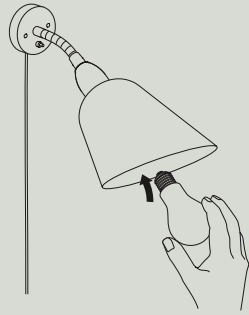

#### Step 5 / 16

Insert the plug into a wall socket and use the switch on the base to turn the lamp on and off.

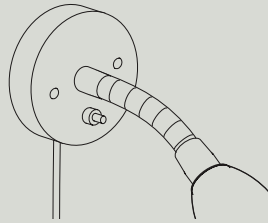

#### Step 6 / 16

Use the flexible swan-neck to set the shade at a desired angle. It is best to set the angle before turning the lamp on as the shade gets hot when the lamp is in use for longer periods of time.

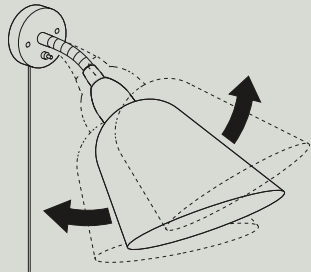

&Tradition®

#### Hard-wired version

#### Step 7 / 16

Cut off the cord a couple of cm below the wire output on the bottom of the lamp housing.

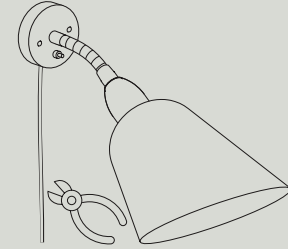

#### Step 8 / 16

Pull the cord up through the hole in the lamp housing.

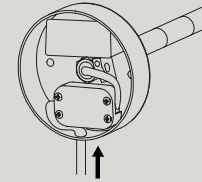

#### Step 9 / 16

Pull out the black plastic strain relief protector from the hole.

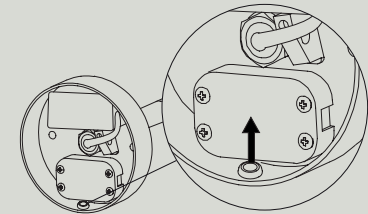

#### Step 10 / 16

Install the plug to cover the hole by tearing off the protection tape and insert plug.

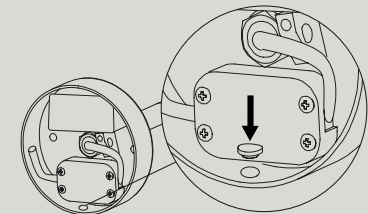

&Tradition®

### Step 11 / 16

Install the wall bracket by pulling the wires from the main outlet through the hole in the wall bracket.

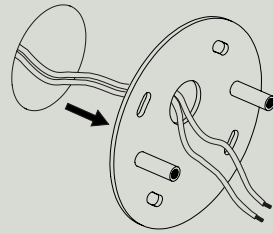

### Step 12 / 16

Place the wall bracket on top of a spirit level in the desired location of the lamp. Ensure the bracket is levelled and mark the placement of the holes with a pencil.

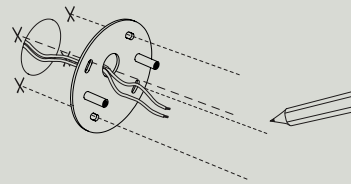

### Step 13 / 16

Drill holes for the bracket and use the correct type of screws and plugs for the type of wall, on which the lamp is to be installed. Tighten the screws and ensure the bracket is safely fixed.

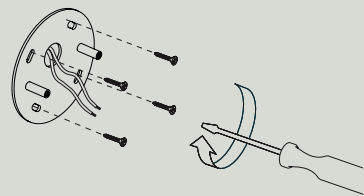

&Tradition®

### Step 14 / 16

Install the wires from the outlet into the white terminal connector (A).

Connect the blue supply wire to the blue fixture wire, using the port labelled 'N'.

Connect the brown supply wire to the brown fixture wire, using the port labelled 'L'.

Close the cap to the terminal connector and place it inside the lamp housing.

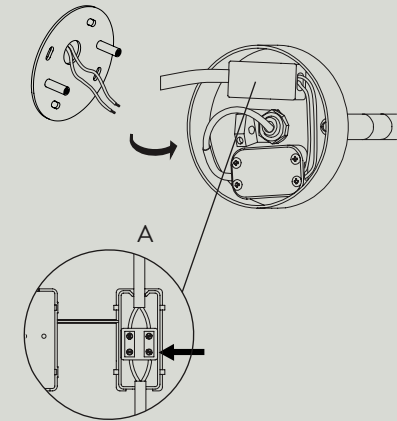

### Step 15 / 16

Place the lamp carefully on the wall bracket. Insert and tighten screws to fix the lamp to the wall bracket.

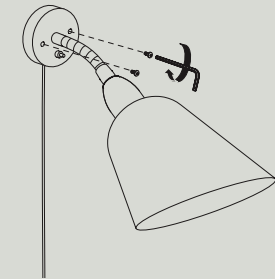

### Step 16 / 16

Install a light bulb, and use the flexible swan-neck to set the shade at a desired angle. It is best to set the angle before turning the lamp on as the shade gets hot when the lamp is in use for longer periods of time.

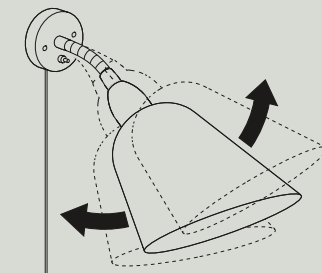

&Tradition®

