

## Instructions

# Bellevue AJ11 Arne Jacobsen 1929

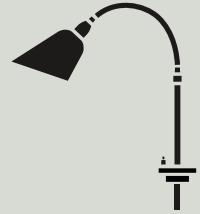

---

Please read these instructions carefully and retain them for future reference to ensure the product is used correctly. For your own safety, please study each step of this instruction manual first. &Tradition is not responsible for any faults or damage caused by not following these instructions correctly. Do not modify this product in any way. If you have any questions or comments, please do not hesitate to contact us by mail on: [info@andtradition.com](mailto:info@andtradition.com)

&Tradition®

# Bellevue AJ11

## Arne Jacobsen

### 1929

---

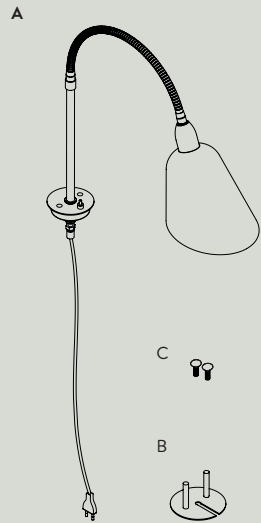

#### Safety precautions

- Dispose of plastic bag from packaging and do not allow children to play with it.
- Keep product well out of children's reach.
- The lamp is only intended for interior use.
- Consult a professionally qualified electrician if in any doubt.
- Do not place the cable within reach of small children or anywhere with a risk of falling over it.
- If the external cable or cord of this lamp is damaged, it must be replaced by the manufacture or a similar qualified person in order to avoid a hazard.

#### Contents

- A** Lamp
- B** Bottom plate for fixation
- C** 2 x Screws

#### Tools needed

- Bulb type E14
- Electric drill, 79mm hole drill
- Wrench

#### Cleaning instructions

- Wipe surface of lamp shade with a soft, damp sponge or cloth, and wipe immediately after with a dry cloth.
- Do not use any abrasive cleaning tools such as steel wool, scouring sponges or stiff brushes.
- Never use strong cleaning agents such as white spirit, turpentine household glass cleaner or cellulose thinners.
- Only wipe the inside of the shade with a soft, damp cloth or feather duster.

04/23

For indoor use only  
E14 Maximum 25W  
Bulb not included



&Tradition®

#### For installation please follow step 1-7

**Please note that the table top which the lamp is to be installed must be between 20 - 40 mm thick in order for the lamp to be securely installed.**

#### Step 1 / 7

---

Find the desired location for the lamp on the table top and mark the middle using a pencil. Next, drill a hole, 79mm in diameter, using a hole drill.

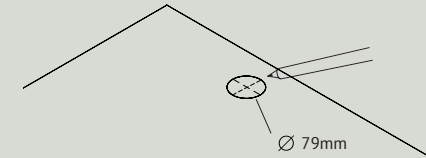

#### Step 2 / 7

---

Place the lamp (A) in the drilled hole. Be sure to place the cord in first.

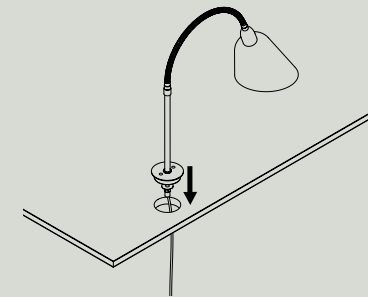

#### Step 3 / 7

---

Slide the bottom plate (B) around the bolt, beneath the table top but above the washers and align the threading on the bottom plate with the holes in the top plate.

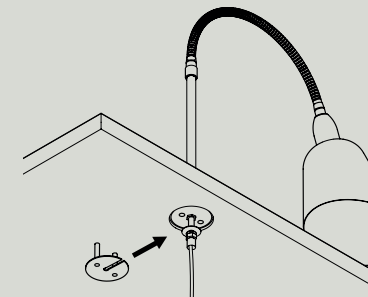

&Tradition®

#### Step 4 / 7

---

Install the lamp on the table by mounting the screws into the holes in the top plate and all the way through the holes in the bottom plate beneath the table top

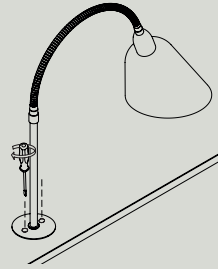

#### Step 5 / 7

---

Tighten the nut by turning it counter-clockwise using a wrench.

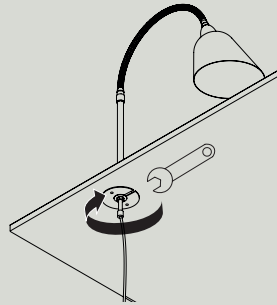

#### Step 6 / 7

---

Install the light bulb.

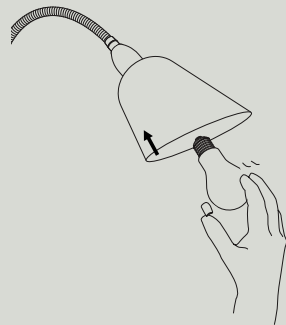

&Tradition®

#### Step 7 / 7

---

Use the flexible swan-neck to set the shade in a desired angle. It is best to set the angle before turning on the lamp since the shade will turn warm when the lamp is on.

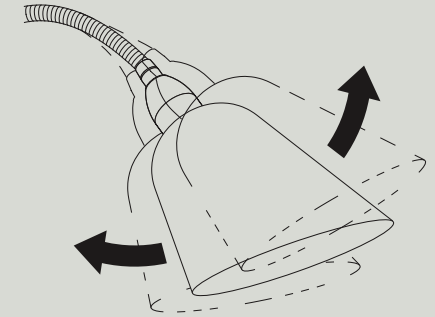

&Tradition®

