

SLAMP®

THE LEADING LIGHT

ASSEMBLING INSTRUCTIONS

LA LOLLO XL

Suspension
 Dim: Ø31" 1/2 x h. 31" 1/2 , maximum cable length 55"

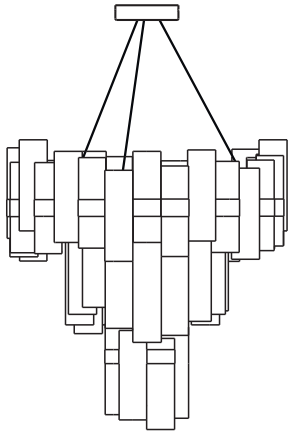

130W - 220-240Vac / 24Vdc - 15.000 Lumen - 2700 Kelvin
 CRI > 90 - Dimmable with: TRIAC

CE IP 20

MADE IN ITALY - INTERNATIONAL PATENT
 Utility Model, Ornamental Design, Trade Mark, Copyright on Artist Design

SLAMP S.p.A. Via Vaccareccia 12/14 - 00071 Pomezia (Roma)
 Tel.+39 06 9162391 - Fax 06 91623933 - info@slamp.it - www.slamp.com

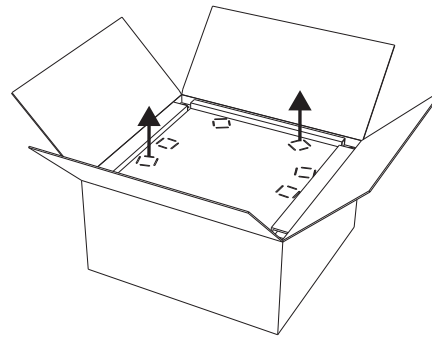

A After opening the external packaging, lift up the internal package by the tabs, as illustrated in the figure.

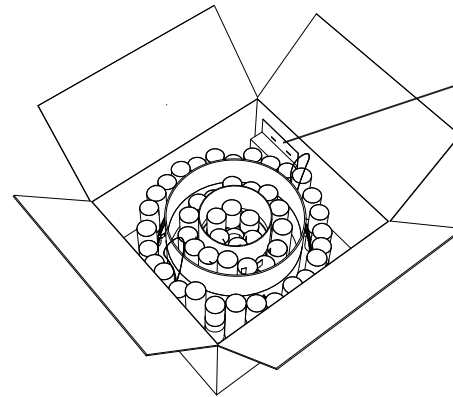

B Remove the ceiling rose and rigging kit to connect the lamp electronically. **Caution!** Make the electrical connection before removing it from the packaging to avoid damage.

OK - off



C Before assembling the lamp, make sure that the main switch is off.



Pay attention not blocking the ceiling electric wires



Pay attention to use all the screws for the corresponding holes of the metallic bracket as shown in the figure

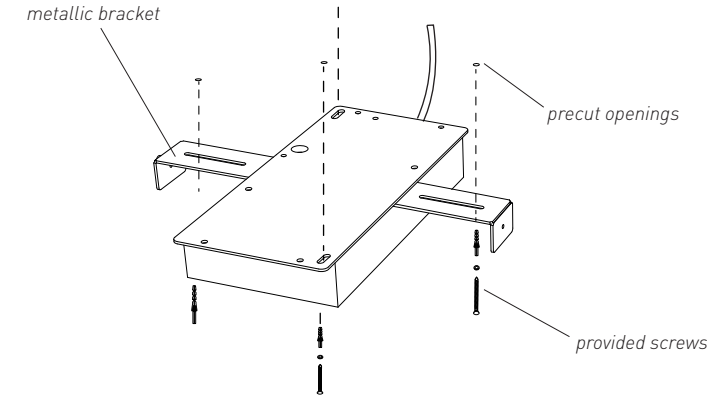

D Make holes in ceiling using the bracket's precut openings. Insert screw anchors and fasten the bracket using provided screws, as shown. Do not block the electrical ceiling wires.

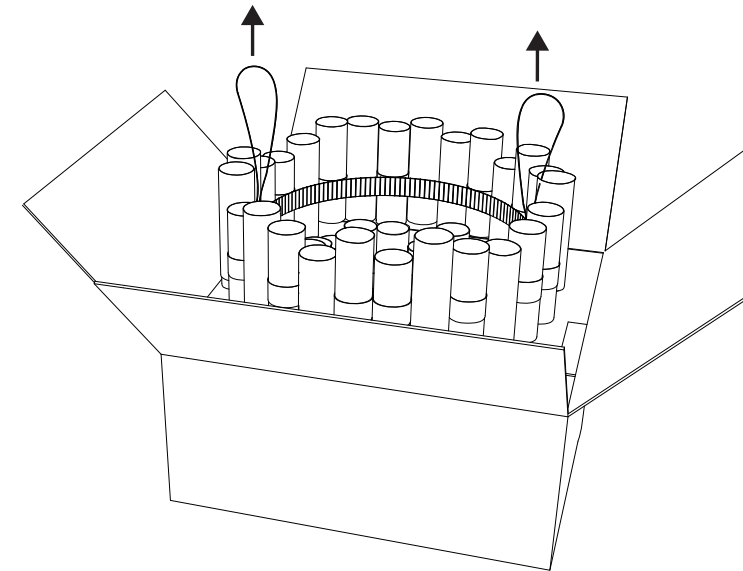

E Lift the lamp from the packaging using the handles.

INSERT THE ELECTRIC WIRES INTO THE CEILING ROSE

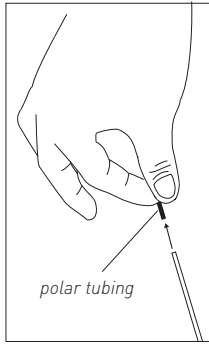

! Attention!
Slide the wire's tubing off before threading it into the ceiling rose. Replace it after having made the knot for polarity reference.

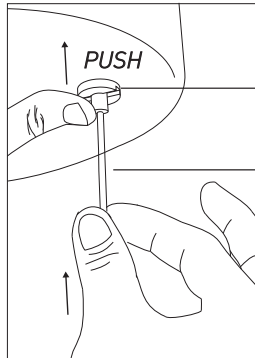
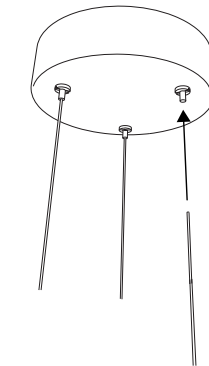

steel clamp

electric wire

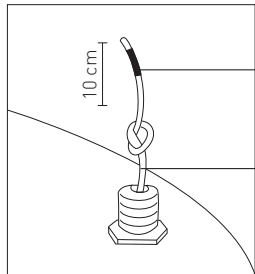
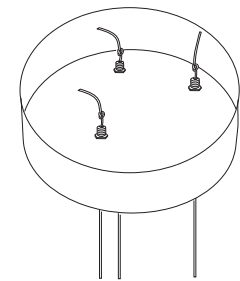

polar tubing

electric wire

10 cm

! LEAVE ABOUT 10 CM SLACK AND REPLACE THE POLAR TUBING.

Insert electric wires into the steel clamp, removing the polar tubing and pushing inward as shown. Make a knot at the end of the electrical wire, leaving 10 cm. Slack on each, and replace the corresponding polar tubing.

F

ELECTRICALLY CONNECT THE LAMP

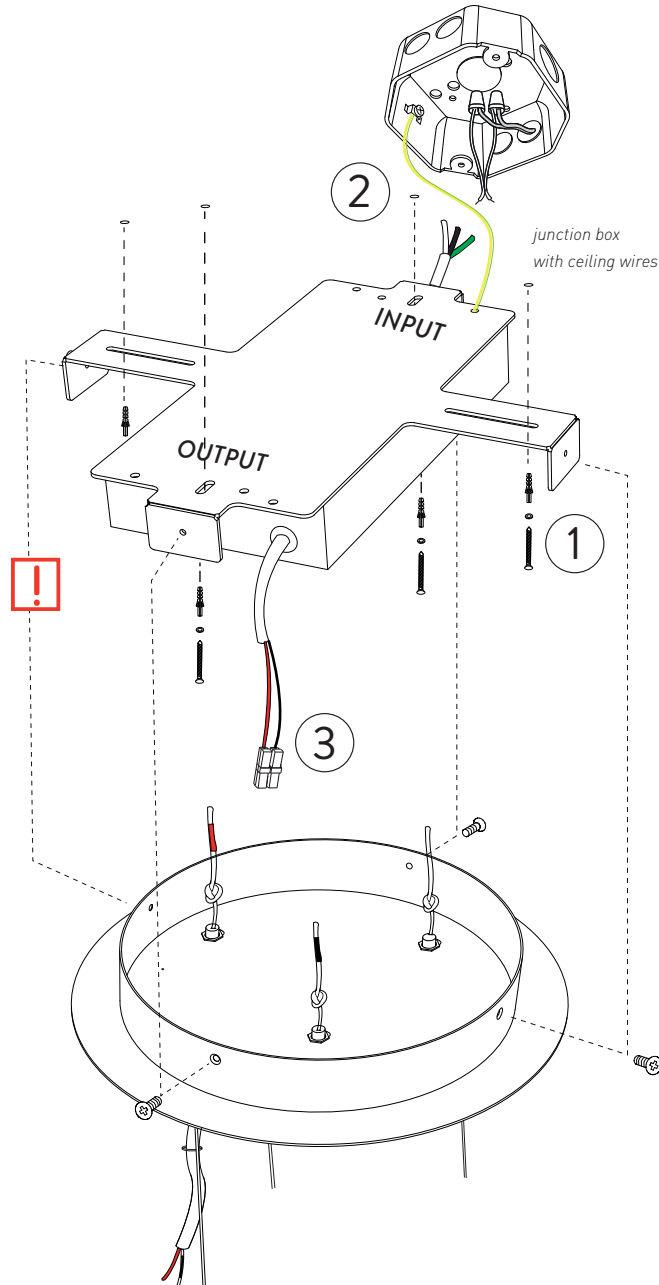

F

Collegare elettricamente la lamapda seguendo i passaggi nella colonna accanto.

Electrically connect the lamap following the steps below.

1 Make 4 holes in ceiling using the bracket's precut openings. Insert screw anchors and fasten the bracket using provided screws, as shown. Do not block the electrical ceiling wires. The bracket and power supply must be positioned as shown, in order to be completely covered by the ceiling rose.

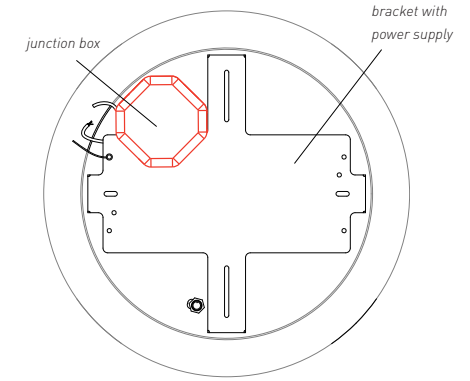

2 Connect the green or yellow-green ground wire to the green screw in the junction box and also to the mounting bracket with the UL and CSA listed green wire supplied with the round terminal using the nut.

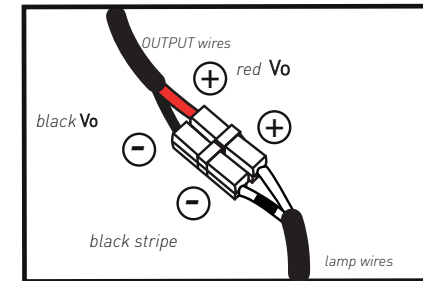

PAY ATTENTION NOT REVERSE THE POLARITY!
THE NEGATIVE CABLE IS THE ONE WITH THE BLACK STRIPE

3 Connect the OUTPUT wires to the lamp wires through the wire connector.

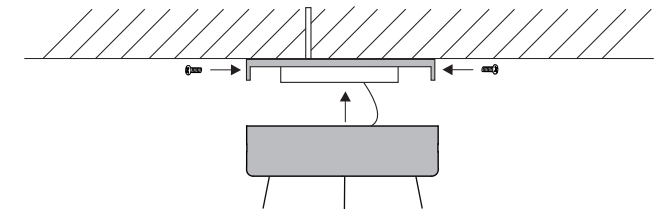

4 Attach ceiling rose to the bracket using the side screws.

4 DIMMING THE LAMP VIEW OF THE POWER SUPPLY CONNECTION

Use a **TRIAC** system to make the lamp dimmable, as instructed in the provided transformer technical sheet.

Attention! Dimming device not provided

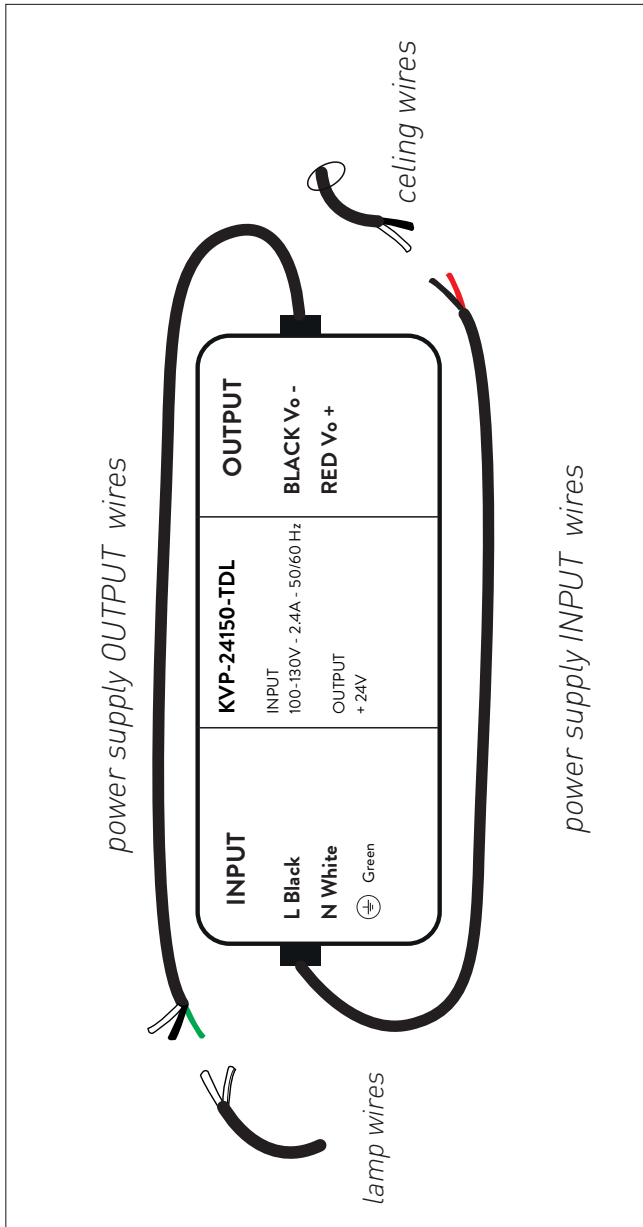

DECIDERE L'ALTEZZA DELLA LAMPADA DETERMINE LAMP HEIGHT

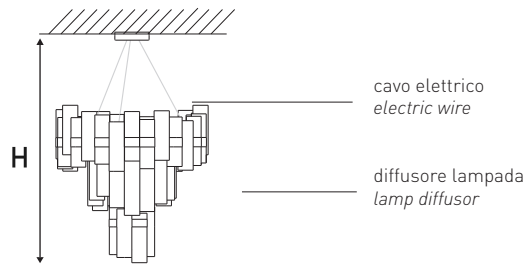

Per decidere l'altezza della lampada è necessario regolare la lunghezza dei cavi elettrici come mostrato sotto.
To determine lamp height, the length of the electric wire must be adjusted as shown.

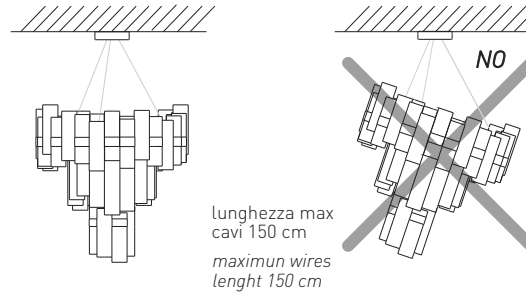

La lunghezza dei cavi può essere modificata anche dopo aver terminato l'installazione. Per assicurare la planarità della lampada regolare i cavi come indicato sotto.

Wire length can be changed after installation.
To level the lamp, adjust wires as shown.

G

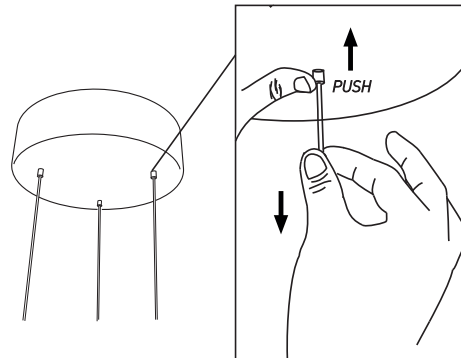

Se si desidera allungare i cavi, premere l'estremità dei morsetti e tirare i cavi verso il basso.

H

To release wires, push the grip-locks and pull down.



Damaged light sources must be replaced directly by the manufacturer or other professionals to avoid further problems.



If the product does not turn on, make sure that the polarity is connected correctly.



If the lamp's light source has been damaged, to avoid dangers, it must be replaced exclusively by manufacturer, by its customer service, or by other skilled workers.

CLEANING



Our lamp's surfaces should be cleaned using a soft, water damp cloth, otherwise use antistatic spray. Under no circumstances should acetone, trichloroethylene, ethyl alcohol, ammonia, or detergent containing even small quantities of these substances be used, because they attack plastic surfaces. Scouring powder, abrasive creams and all cleaning equipment with rough surfaces, should also be avoided.



SLAMP è conforme alla Direttiva UE (Unione Europea) del 2002 (2002/96/CE) riguardante i rifiuti di apparecchiature elettriche ed elettroniche, che mira a ridurre l'impatto dei rifiuti elettronici sull'ambiente. La Direttiva RAEE è stata recepita dalle leggi di tutti gli stati membri dell'Unione Europea.

SLAMP is in conformity with Directive 2002/96/EC (Waste Electrical and Electronic Equipment - WEEE).

ENGLISH/ INFORMATION FOR USERS

Directive 2002/96/EC (Waste Electrical and Electronic Equipment - WEEE)
The use of the WEEE symbol indicates that this product may not be treated as household waste. By ensuring this product is disposed of correctly you will help protect the environment. For more detailed information about the recycling of this product, please contact your local authority, your household waste disposal service provider or the shop where you purchased the product.

Our lamp's surfaces should be cleaned using a soft, water damp cloth, otherwise use antistatic spray. Under no circumstances should acetone, trichloroethylene, ethyl alcohol, ammonia, or detergent containing even small quantities of these substances be used, because they attack plastic surfaces. Scouring powder, abrasive creams and all cleaning equipment with rough surfaces, should also be avoided.

SLAMP:
THE LEADING LIGHT