



1718 W. Fullerton Chicago, IL 60614  
 Ph: 773.770.1195 • Fax: 773.935.5613  
 www.PureEdgeLighting.com • info@PureEdgeLighting.com  
 © 2016 PureEdge Lighting. All Rights Reserved.

## Installation Instructions for Monorail 24", 48" and 96"



### IMPORTANT INFORMATION

- This product is ETL listed for indoor dry locations.
- Monorail is bendable horizontally to a radius as small as 6" and vertically to a radius as small as 24".
- The product is intended to be used with PureEdge Lighting Monorail systems only.

**SAVE THESE INSTRUCTIONS!**



## Techniques to Bend the Monorail

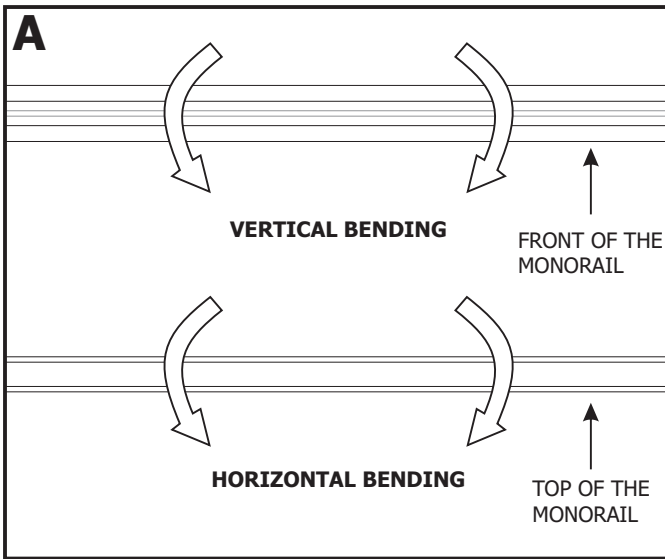

**NOTE:** There are three techniques to bend the monorail horizontally which are Plywood Template, Free Style, and Wiremold pipe bender. Monorail can only be bent vertically by a Wiremold pipe bender. When bending vertically, bend the Monorail in short increments and avoid bending it back which may cause the rails to separate from the insulator.

**NOTE:** If necessary, use a hack saw to cut the Monorail to the desired length.

## Horizontal Bending Using a Plywood Template

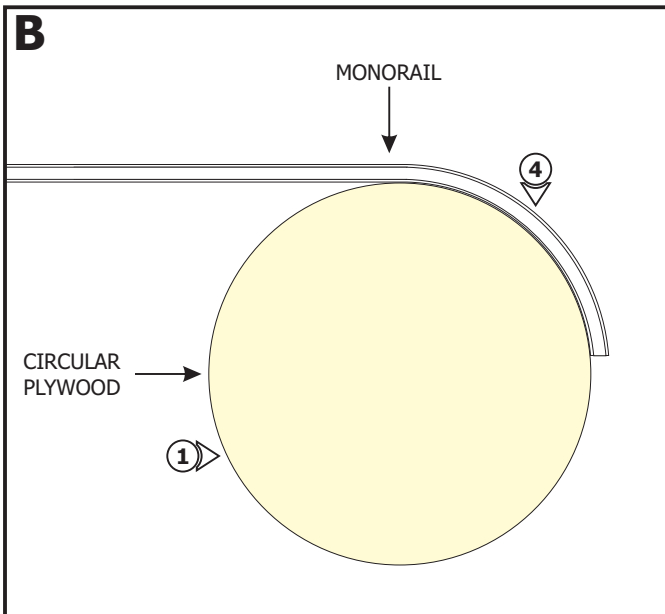

- 1:** Determine the radius of the curve or circle.
- 2:** Draw the curve on plywood and cut out the pattern from the plywood.
- 3:** Secure the plywood in place.
- 4:** Hold one edge of the Monorail against the plywood. Start bending the Monorail against the plywood until the desired curve or circle is achieved.

## Free Style Horizontal Bending

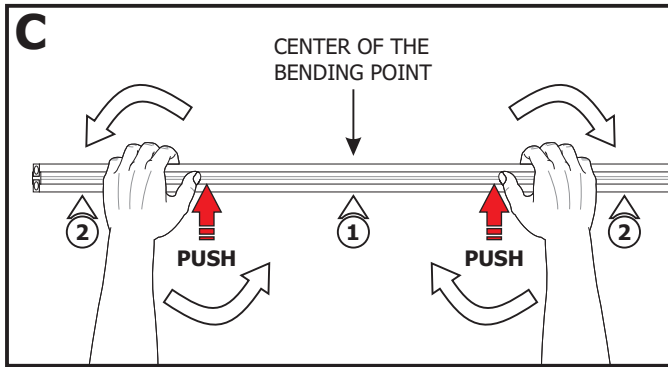

**1:** Locate the center of the bending point on a Monorail section. The bending point should be centered between hands.

**2:** For a smooth curve, bend the Monorail with hands as far apart as possible. Move hands close together as bending progresses and the desired shape is achieved.

## Wiremold Pipe Bender (Horizontal or Vertical Bend)

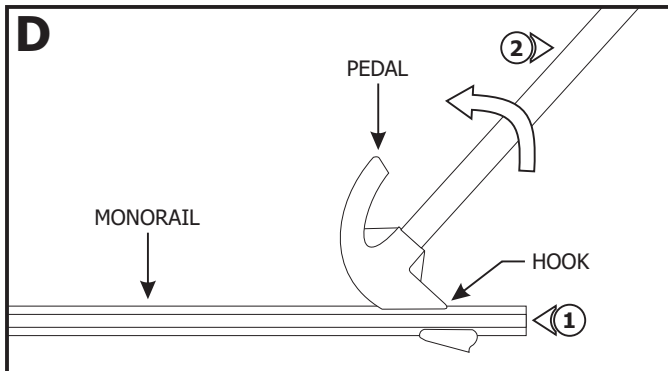

**NOTE:** The Wiremold pipe bender can be used to create smooth horizontal curve of 90° or less. Do not step on the pedal of the pipe bender which will flatten and damage the Monorail. For offsets, refer to the instructions provided with the pipe bender.

**1:** Feed the Monorail through the pipe bender hook.

**2:** Start bending the Monorail with small angles (less than 10°) by gently pulling back on the pipe bender handle.

**3:** After each bend unhook and check the Monorail against the pattern.

## Joining Monorail Sections with Straight Conductive Connectors

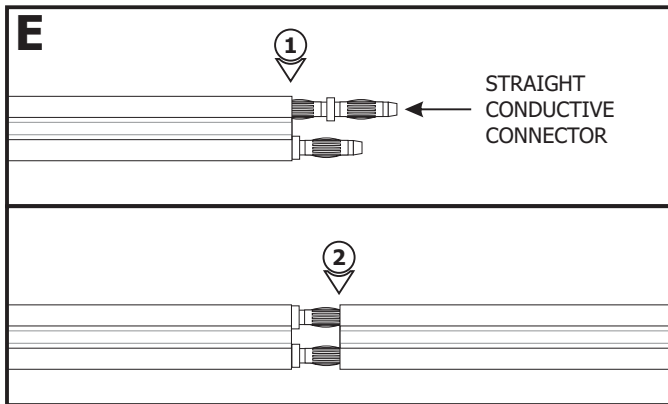

**1:** Push the straight conductive connectors completely into the end of one Monorail section.

**2:** Push the other Monorail section entirely onto the straight conductive connectors.

## Joining Monorail Sections with Straight Isolating Connectors

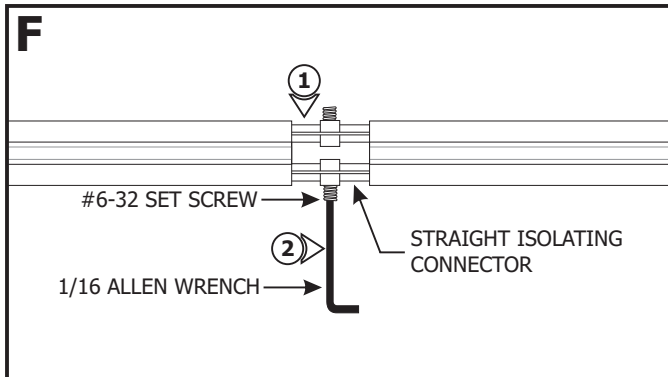

**1:** Push the straight isolating connectors completely into one Monorail section end and push the other Monorail section entirely onto the straight isolating connectors.

**2:** Tighten the #6-32 set screws on each of the isolating connector firmly with the 1/16 Allen wrench. **Do not over tighten the set screws as this may strip the threads.**