



1718 W. Fullerton Chicago, IL 60614  
 Ph: 773.770.1195 • Fax: 773.935.5613  
 www.PureEdgeLighting.com • info@PureEdgeLighting.com  
 © 2016 PureEdge Lighting. All Rights Reserved.

## Installation Instructions for Monorail 2"- 96" Rigid Standoffs

MS-\_\_-\_\_

### IMPORTANT INFORMATION

- This product is ETL listed for indoor dry locations.
- The product is intended to be used with PureEdge Lighting Monorail systems only.
- Use Monorail standoffs where the Monorail sections join together and approximately every 3 feed max throughout the Monorail run.

**SAVE THESE INSTRUCTIONS!**



### Install the Standoff

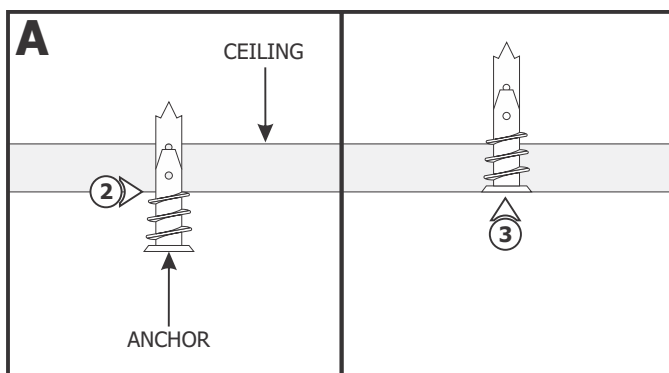

- 1: Hold the Monorail section against the ceiling or use a plumb bob to mark the standoff locations onto the ceiling (this may require more than one person).
- 2: Tap the anchors onto the marked locations up to the threaded portion with a hammer.
- 3: Screw the threaded portion of the anchors in with a Phillips screwdriver.

- 4: Mount the integrated washer-nipple to the anchor with the #8 screw provided.
- 5: Tighten the threaded post completely onto the integrated washer-nipple.

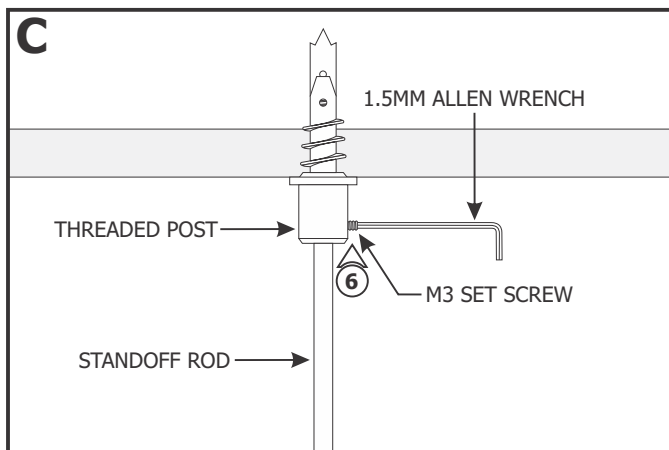
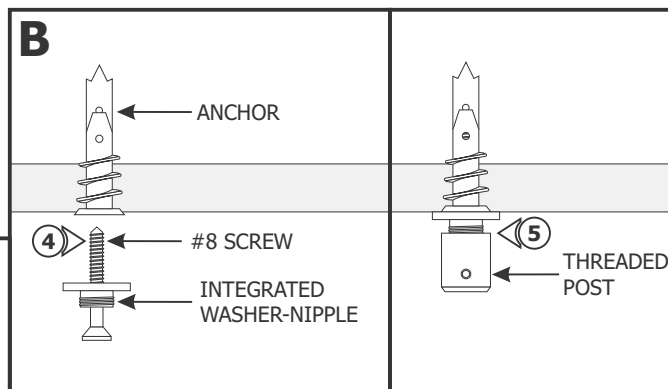

- NOTE:** To resize the standoff height, refer to "Shortening the Standoff Height" section on page 2 before proceeding with these steps.
- 6: Push the standoff rod completely into the threaded post and tighten the M3 set screw with the 1.5mm Allen wrench.
  - 7: Repeat steps 4 through 6 for the remaining standoffs.

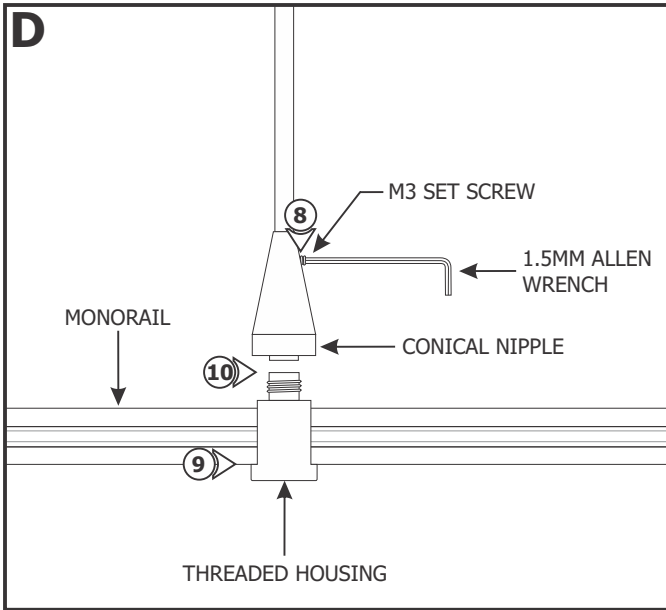

**8:** Slightly loosen the M3 set screw on the conical nipple of each of the standoffs with the 1.5mm Allen wrench so that the conical nipples can rotate easily.

**9:** Place the Monorail into the threaded housings (this may require more than one person).

**10:** Tighten the threaded housings to the conical nipples (this may require more than one person). **Make sure threaded housings are not cross threaded.**

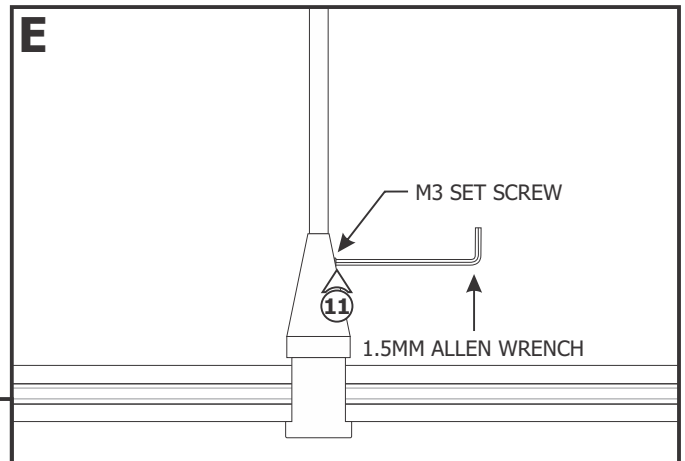

**11:** Tighten the M3 set screw on the conical nipples with the 1.5mm Allen wrench.

## Shortening the Standoff Height (Optional)

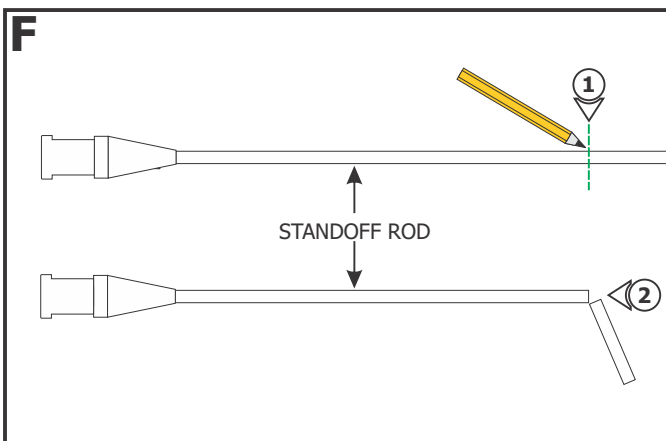

**1:** From the end of the standoff rod, mark the rod to the amount that needs to be shorten. For example to resize a 24" standoff to 17", mark 7" from end of the standoff rod.

**2:** Using a hacksaw, cut the marked section.

**3:** Clean the burrs of the cut section.

**4:** Repeat steps 1 through 3 for all standoffs. Make sure that all standoff heights match after resizing them.

**5:** Follow steps 6 through 11 on "Install the Standoffs" to complete the installation.