

**ERIS Outdoor**  
**3-720-xx**

oxygen

FIXTURE TYPE \_\_\_\_\_

LOCATION \_\_\_\_\_

PROJECT \_\_\_\_\_

DATE \_\_\_\_\_



-22 Oiled Bronze



-16 Gray

<b>LIGHT SOURCE</b>	1 x 10.1W LED, 3000K, CRI 90
<b>LUMINAIRE POWER</b>	12.4W at 120V
<b>RATED LIFE</b>	60000 hr RL
<b>OPTIONAL COLOR TEMPERATURES</b>	2700K, 3500K, 4000K
<b>LUMEN OUTPUT</b>	Delivered: 529 lm (LM-79)
<b>INPUT VOLTAGE</b>	120V to 277V AC, 50/60Hz
<b>DRIVER OUTPUT</b>	350mA, 14.7W max power
<b>DIMMING</b>	TRIAC and ELV dimming at 120V AC; 0-10V dimming, 100% to 1% current output
<b>CONSTRUCTION</b>	Cast Aluminum and Glass
<b>DIFFUSER</b>	- Frosted Glass
<b>FINISHES</b>	Gray (-16), Oiled Bronze (-22)
<b>MOUNTING</b>	4" Octagonal J-Box*, 4" Square J-Box* *Deep J-Box (Required to house driver) (Installer must provide a bead of caulk between fixture housing and mounting surface)
<b>STANDARDS</b>	UL Wet listed, Conforms to UL STD 1598, Certified CAN/CSA STD C22.2 No 250.0

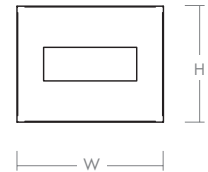
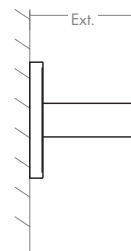
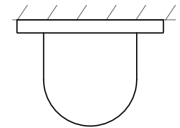

**DIMENSIONS**

<b>W:</b>	<b>6.00"</b>
<b>H:</b>	<b>4.75"</b>
<b>Ext:</b>	<b>4.38"</b>
<b>M.C:</b>	<b>2.38" From top of fixture</b>

Order example for standard fixture:

**3-720-22** (x- Voltage - xxx-Sequence # - xx-Finish)

**3:** 120V to 277V

Order example for optional color temperatures: **3-720-2722**

**27:** 2700K, **35:** 3500K, **40:** 4000K

