

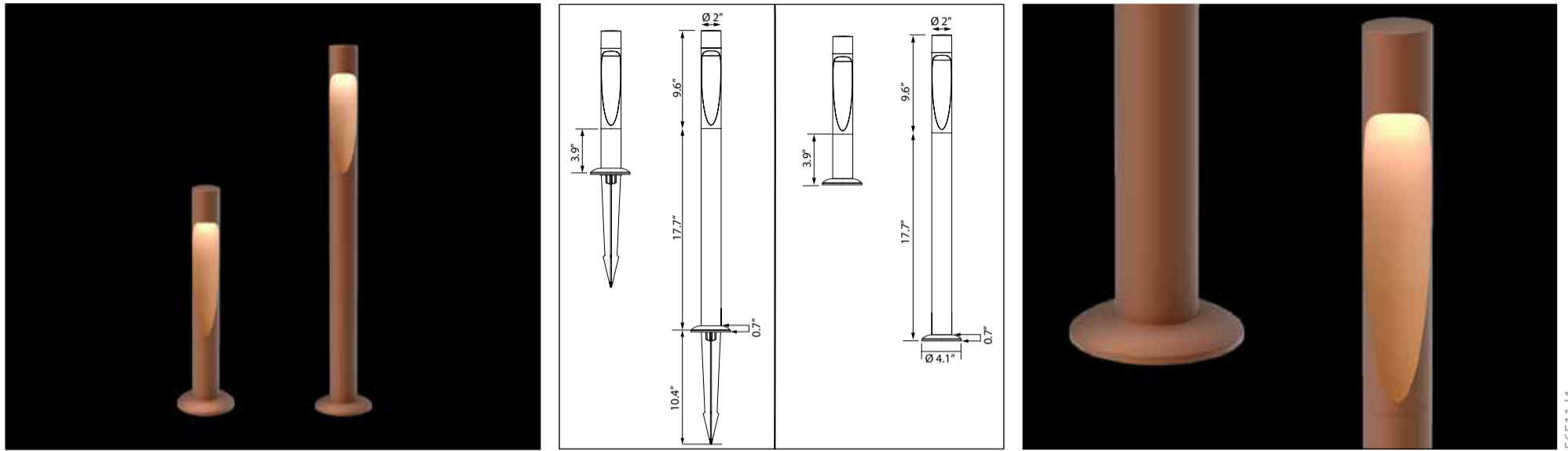

Flindt Garden Anchor & Base

Design Christian Flindt

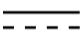

56511-14

Light source	Voltage/frequency	Weight	Ingress protection	Impact protection
LED 7W 	24Vdc 	Max. 4.4 Lbs	Suitable for Wet location Anchor/Base: (Fixed installation) IP44	IK 06

Recommended cleaning substances:

Wipe off dust with a dry, soft cloth. Remove greasy spots etc. with a soft cloth dampened in lukewarm water (<122° F/ 50° C) with a mild detergent. Never use detergents containing abrasives and solvents.

Warning: Scouring powder and similar substances will scratch surfaces.

All installation is subject to local code and jurisdiction. Consult a qualified electrician to ensure correct branch circuit conductor.

The installer must ensure that the foundation is stable and can support the luminaire's weight. The Installer must use proper means to secure the luminaire to the ground.



Due to possibility of personal injury or property damage, always contact a qualified electrician for servicing or repair of this fixture. To avoid risk of electrical shock, personal injury, or death, disconnect power to fixture before servicing.

How to calculate max. numbers of luminaires that can be connected:	
Powersupply maximum wattage	40 Watt
Wattage of luminaire	7 Watt
Total number of luminaires	$40w/7w = 5,7 \approx 5$ Luminaires

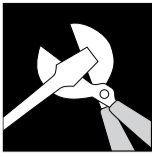

Base and Anchor mounted bollards intended for professional installed below-ground cable routing. Installer to ensure cables and conduit meet all applicable codes and regulations.

A

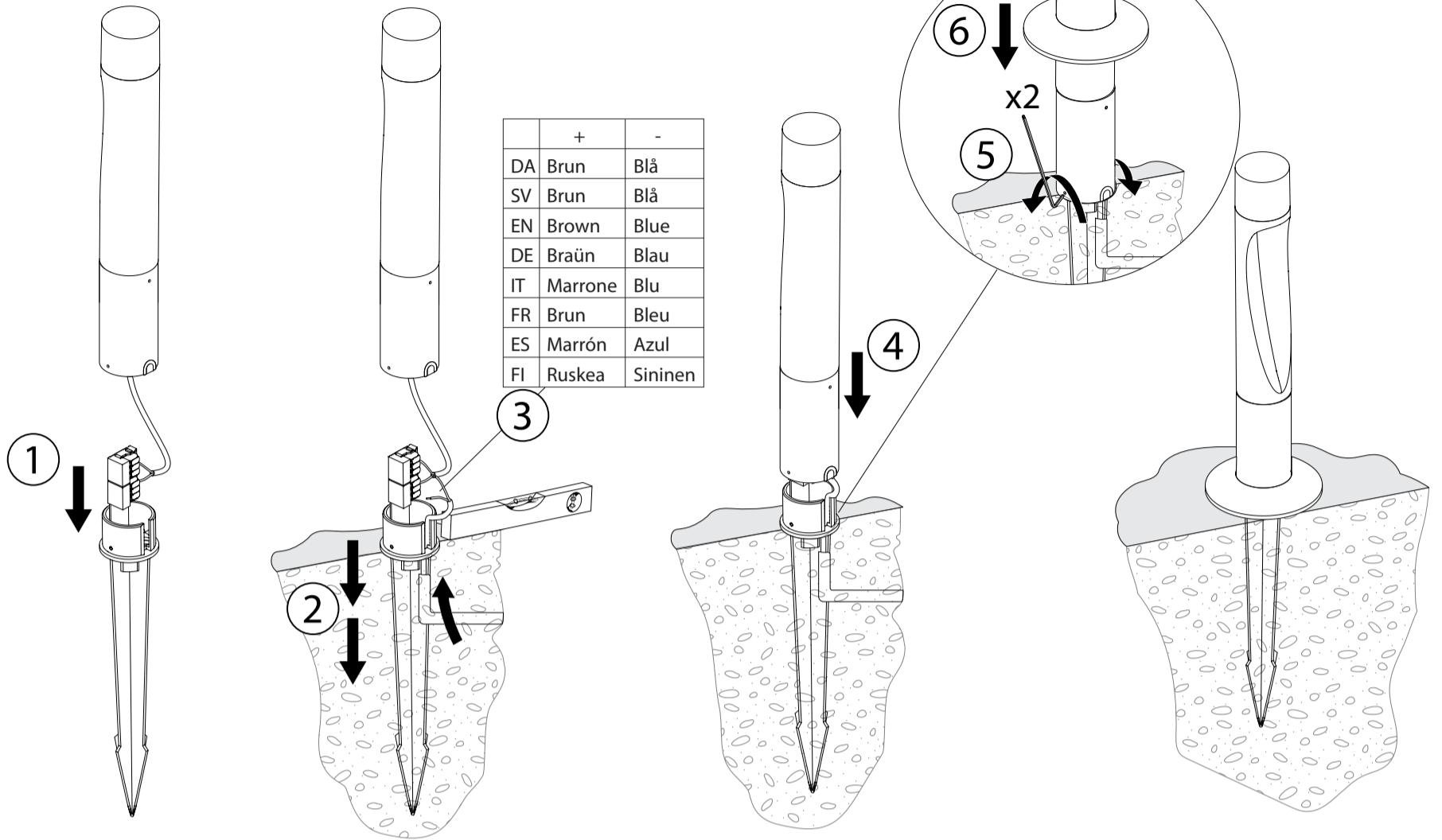

B

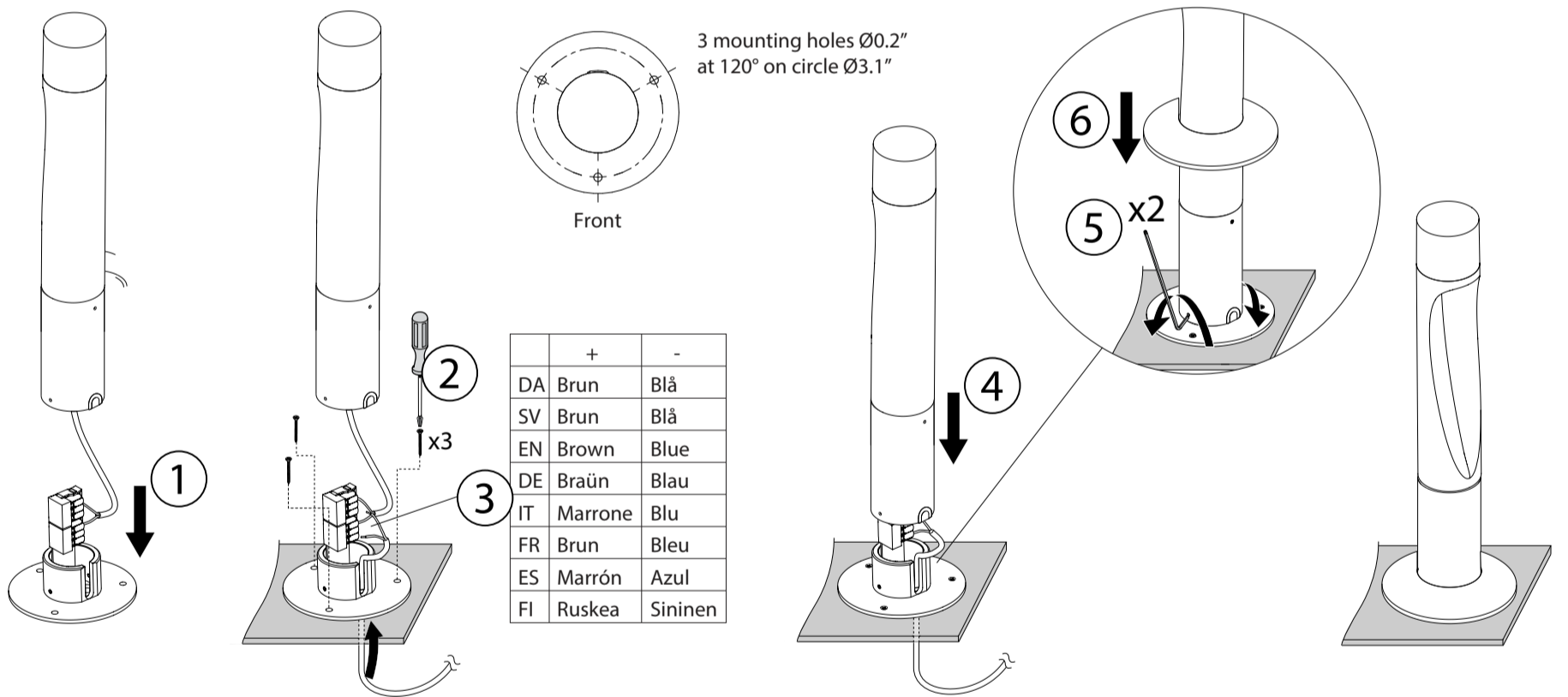

Installation with fixed installation

