

Assembly & Installation Instructions

A462

Fizz Kitchen Pendant With Brass Accent - 18700

Page 1 of 5

CAUTION: FAILURE TO INSTALL THIS FIXTURE PROPERLY MAY RESULT IN SERIOUS PERSONAL INJURY OR DEATH AND PROPERTY DAMAGE. We recommend installation by a licensed electrician. This product must be installed in accordance with applicable installation code(s), by a person familiar with the construction and operation of the product and the hazards involved.*

Caution: Do not exceed maximum wattage noted on fixture. Use only recommended bulbs with fixture.

Please Note: After installation extra hardware and accessories are possible due to our kits are used on multiple products and options.

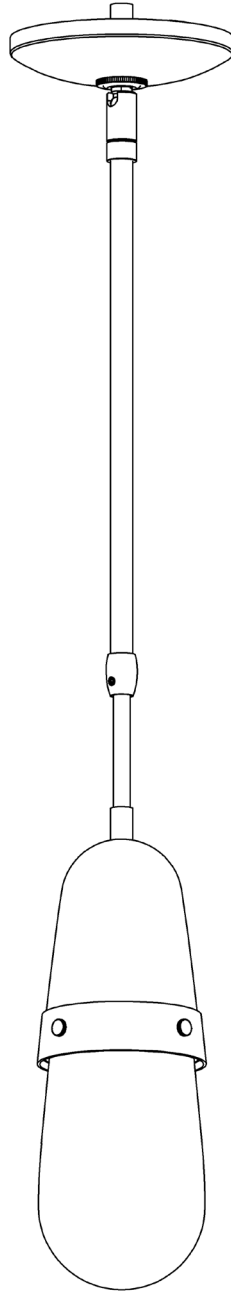

Assembly & Installation Instructions

A462

Fizz Kitchen Pendant With Brass Accent - 18700

Page 2 of 5

Component Parts

A	Fixture Cup
B	Brass Ring
C	Knurled Screw (4)
D	Fixture Coupling
E	Fixture Pipe
F	Crossbar
G	Jam Nut
H	Threaded Nipple
I	Canopy
J	Canopy Ring
K	Canopy Pipe
L	Ground Screw
M	Clutch
N	Set Screw
O	Plastic Clutch Sleeve
P	Socket
Q	Glass

Assembly & Installation Instructions

A462

Fizz Kitchen Pendant With Brass Accent - 18700

Page 3 of 5

Stem Assembly (Figure 1)

CAUTION: BE SURE POWER IS OFF AT THE MAIN BREAKER BOX PRIOR TO INSTALLATION.

1. Carefully unpack the fixture from the carton.
2. Carefully slip fixture pipe (E) over fixture wires.
3. Apply a drop of the supplied thread locking compound to the threads of fixture pipe (E) and screw pipe into fixture coupling (D), being careful not to twist or pinch the wires.
Note: Application of the thread locking compound is necessary to prevent the stem from loosening during regular maintenance and cleaning of the fixture. Be certain to apply the compound.

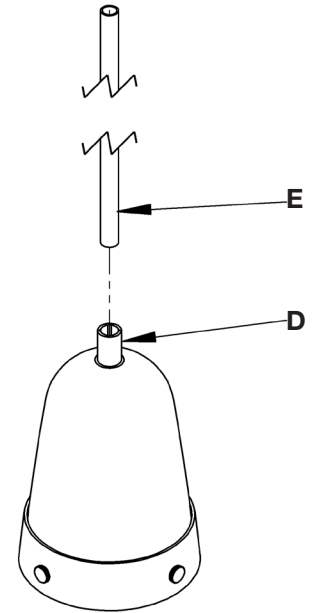

(Figure 1)

Prepare Canopy (Figure 2)

1. Thread the jam nut (G) and crossbar (F) onto threaded nipple (H); leave both parts loose.
2. Using two machine screws (not provided), temporarily fasten the crossbar (F) to the electric box. **Note:** A new electric box comes with screws. When replacing a fixture, retain the existing screws for use with the new fixture.
3. Adjust the length of threaded nipple (H) in crossbar (F) so that canopy ring (J) will hold canopy (I) against the ceiling with no threads showing for best appearance. When the correct adjustment is established, tighten jam nut (G) against crossbar (F) to hold the adjustment.
4. Remove the crossbar (F) from the electrical box and proceed with the assembly instructions on following page.

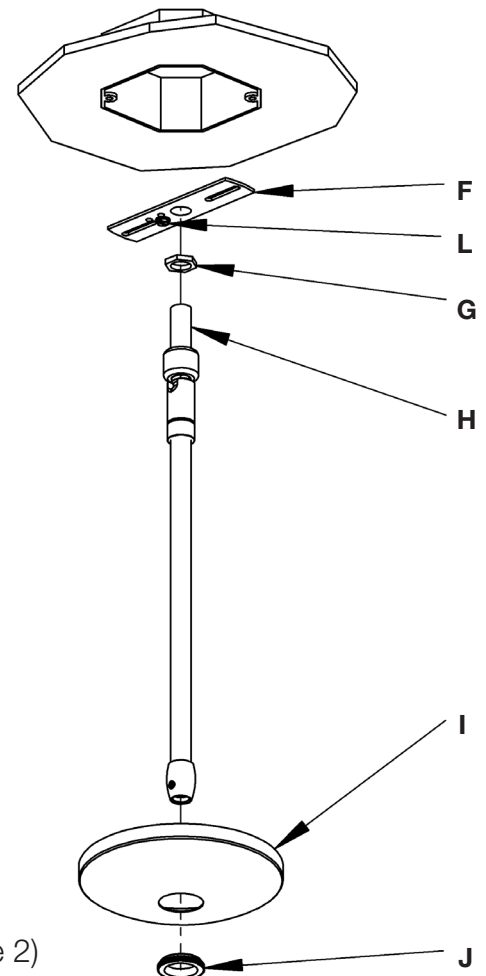

(Figure 2)

Assembly & Installation Instructions

A462

Fizz Kitchen Pendant With Brass Accent - 18700

Page 4 of 5

Install Fixture (Figures 3 & 4)

1. Carefully slide canopy ring (J) and canopy (I) down over fixture pipe (E) until they rest on the fixture. Make sure smaller diameter side of canopy ring (J) is oriented up toward the canopy (I) (Figure 3).
2. Slip wires from the fixture pipe (E) through the canopy pipe (K).
3. Unscrew the clutch (M) from the canopy pipe (K); slide it across the wires and onto the fixture pipe (E). Follow this with the plastic sleeve (O), oriented so the tapered end nests in the clutch (M). (Figure 4)
4. Slide the canopy pipe (K) on to fixture pipe (E) as far as necessary to give you the total length of the fixture which you desire. Be careful not to scratch the pipe surfaces and to pull excess wire up through the canopy pipe (K). There must be a minimum 1-1/2" of inner pipe inside the outer pipe. Hand-tighten the clutch (M) to temporarily hold this adjustment. The clutch is not securely fastened at this point; do not depend on it to hold the fixture.
Important: To ensure full connection strength, be sure the tapered end of the plastic clutch sleeve is oriented toward the clutch when assembled and securely tighten set screw (Figure 4).

5. Using two machine screws (not provided), fasten the crossbar (F) to the electric box.
Note: A new electric box comes with screws. When replacing a fixture, retain the existing screws for use with the new fixture.
6. Using suitable wire connectors (not provided), connect fixture wires to supply wires (white to white supply, black to black supply). Attach a pigtail lead to the crossbar ground screw (L). Connect all ground wires (bare copper or green to bare copper or green). Push wires back into outlet box.
Caution: Make sure wire connectors are twisted on securely, and no bare wire is exposed.
7. Slide canopy (I) against ceiling, and secure with canopy ring (J).
8. Once the fixture is fastened to the ceiling, tighten the set screw (N) firmly with hex wrench provided.

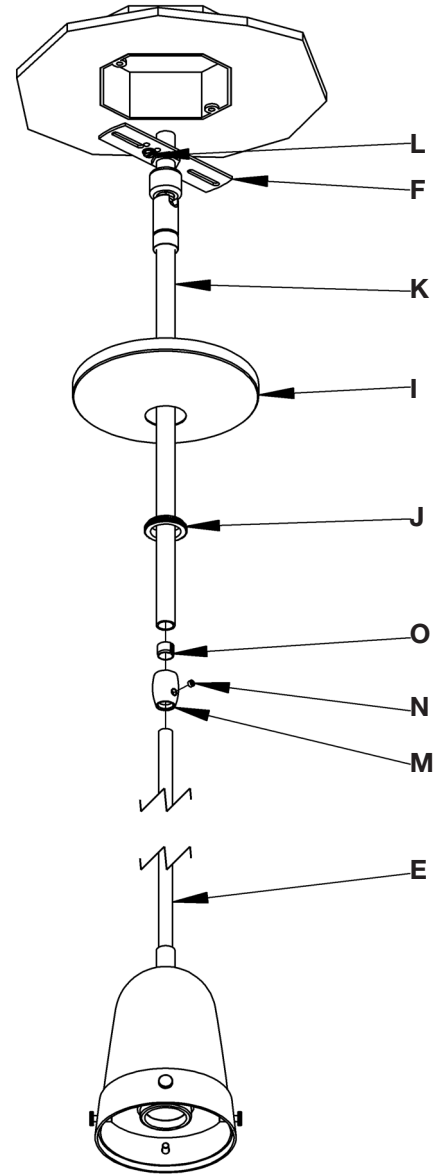

(Figure 3)

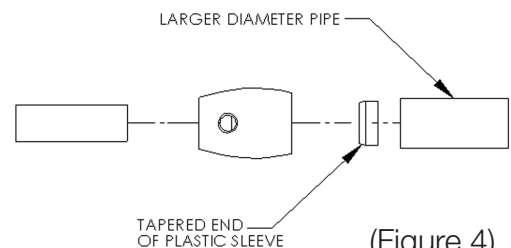

(Figure 4)

Assembly & Installation Instructions

A462

Fizz Kitchen Pendant With Brass Accent - 18700

Page 5 of 5

Install Glass (Figure 5)

1. Install bulb (not included) into socket (P).
2. Slide glass (Q) over bulb and socket (P) and up into fixture cup (A).
3. Align groove in glass (Q) with knurled screws (C).
4. Tighten screws (C) evenly to secure glass (Q). Be sure not to overtighten.
5. Restore electricity at main breaker.

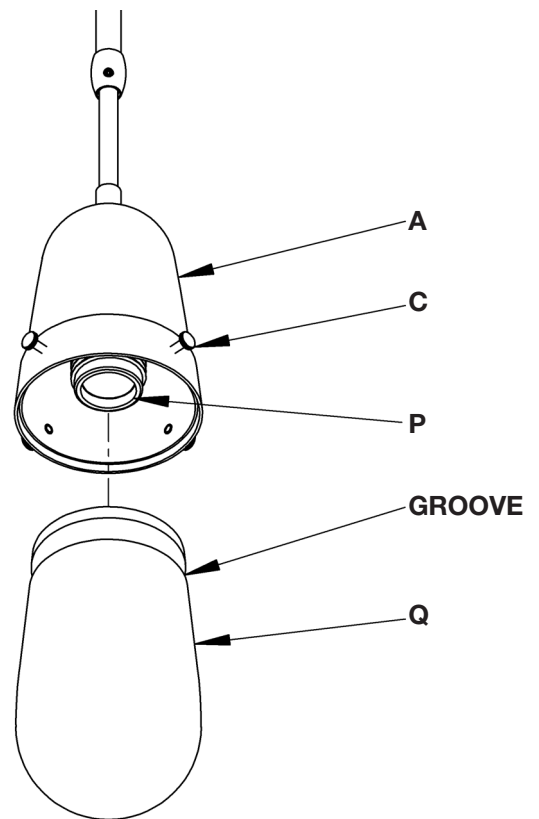

(Figure 5)

If you need further assistance, or find that you are missing any parts, please contact the dealer from which you purchased this product. We hope you enjoy your fixture!

***Hubbardton Forge will not be liable for injury or damage caused by improper installation, lamping or use of this fixture.**

ASSEMBLY & INSTALLATION INSTRUCTIONS

A717

Fizz Mini Pendant 187000

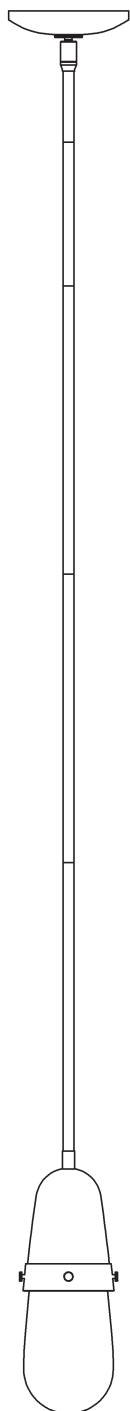

HUBBARDTON FORGE.

MODERN AMERICAN BLACKSMITHS | FINE, HAND CRAFTED LIGHTING
CASTLETON, VERMONT USA | HUBBARDTONFORGE.COM

48298

1 OF 4

Component Parts

- A Fixture**
- B Fixture Coupling**
- C Crossbar**
- D Jam Nut**
- E Threaded Nipple**
- F Ground Screw**
- G Canopy Ring**
- H Canopy**
- I Swivel**
- J 3" Fixture Pipe (1)**
- K 6" Fixture Pipe (1)**
- L 12" Fixture Pipe (3)**
- M Stem Nipple (6)**
- N Thumb Screws**
- O Bulb (not included)**
- P Glass**



ASSEMBLY & INSTALLATION INSTRUCTIONS

A717

Fizz Mini Pendant 187000

CAUTION: FAILURE TO INSTALL THIS FIXTURE PROPERLY MAY RESULT IN SERIOUS PERSONAL INJURY OR DEATH AND PROPERTY DAMAGE. We recommend installation by a licensed electrician. This product must be installed in accordance with applicable installation code(s), by a person familiar with the construction and operation of the product and the hazards involved.*

Caution: Do not exceed maximum wattage noted on fixture. Use only recommended bulbs with fixture.

Please Note: After installation extra hardware and accessories are possible due to our kits are used on multiple products and options.

To Install Fixture (Figure 1) on following page

CAUTION: BE SURE POWER IS OFF AT THE MAIN BREAKER BOX PRIOR TO INSTALLATION.

1. Carefully unpack fixture (A) from the carton.
2. Thread jam nut (D) and crossbar (C) onto threaded nipple (E) with ground screw (F) facing towards swivel (I); leave both parts loose.
3. Using two machine screws (not provided), temporarily fasten crossbar (C) to the electric box.

NOTE: A NEW ELECTRIC BOX COMES WITH SCREWS. WHEN REPLACING A FIXTURE, RETAIN THE EXISTING SCREWS FOR USE WITH THE NEW FIXTURE.

4. Adjust the length of threaded nipple (E) in crossbar (C) so that canopy ring (G) will hold canopy (H) against the ceiling with no threads showing for best appearance. When the correct adjustment is established, tighten jam nut (D) against crossbar (C) to secure the adjustment.
5. Remove crossbar (C) from the electrical box and proceed with the assembly instructions.
6. Locate fixture pipes (J, K, L), fixture (A) and stem nipples (M). Nipples (M) can be found in the kit bag.
7. Provided are multiple fixture pipes in three different lengths. Choose the combination that will achieve the overall height desired. Refer to the table below to determine the pipes required to reach the desired overall height. Once you have determined the components necessary, feed the wires that exit fixture coupling (B) through the individual components and thread pipes and couplings together. Wires will slip easier through loose components than through pipes and couplings that are pre-assembled. Once wires are run, apply thread locking compound to all the connection points and assemble the pipes and nipples.

		Overall Height of Fixture															
		13.5	16.5	19.5	22.5	25.5	28.5	31.5	34.5	37.5	40.5	43.5	46.5	49.5	52.5	55.5	58.5
# of Pipes Required	3" Pipe (J)		1		1		1		1		1		1		1		1
	6" Pipe (K)			1	1			1	1			1	1			1	1
	12" Pipe (L)					1	1	1	1	2	2	2	2	3	3	3	3

NOTE: APPLICATION OF THE THREAD LOCKING COMPOUND IS NECESSARY TO PREVENT THE PIPE FROM LOOSENING DURING REGULAR MAINTENANCE AND CLEANING OF THE FIXTURE. BE CERTAIN TO APPLY THE COMPOUND.

8. Carefully slide canopy ring (G) and canopy (H) over wires and fixture pipes (J, K, L) until they rest on fixture (A).
9. Slip wires from the fixture (A) through assembled swivel (I) and thread swivel onto final pipe. It may be necessary to remove a nipple (M) for this to work on shorter overall fixture heights.
10. Refer to instructions on next page to continue installation.



HUBBARDTON FORGE.

MODERN AMERICAN BLACKSMITHS | FINE, HAND CRAFTED LIGHTING
CASTLETON, VERMONT USA | HUBBARDTONFORGE.COM

48298

3 OF 4

ASSEMBLY & INSTALLATION INSTRUCTIONS

A717

Fizz Mini Pendant 187000

11. Using two machine screws (not provided), fasten crossbar (C) to the electric box.
12. Using suitable wire connectors (not provided) connect fixture wires to supply (white/ribbed to white and black/smooth to black). Attach a pigtail lead to crossbar ground screw (F). Hold canopy (H) close, connect all ground wires (bare copper or green to bare copper or green).

CAUTION: MAKE SURE WIRE CONNECTORS ARE TWISTED ON SECURELY, AND NO BARE WIRE IS EXPOSED.

13. Slide canopy (H) against ceiling, and secure with canopy ring (G).

CAUTION: BE SURE NO WIRES ARE PINCHED BETWEEN CANOPY (H) AND THE CEILING.

14. Install bulb (O) (not included) into socket.
15. Slide Glass (P) over bulb and into fixture.
16. Align groove in glass with thumb screws (N).
17. Tighten thumb screws evenly to secure glass. Be sure not to overtighten.
18. Restore electricity at main breaker.

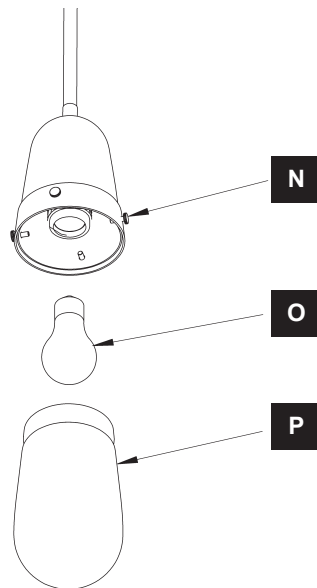

(Figure 2)

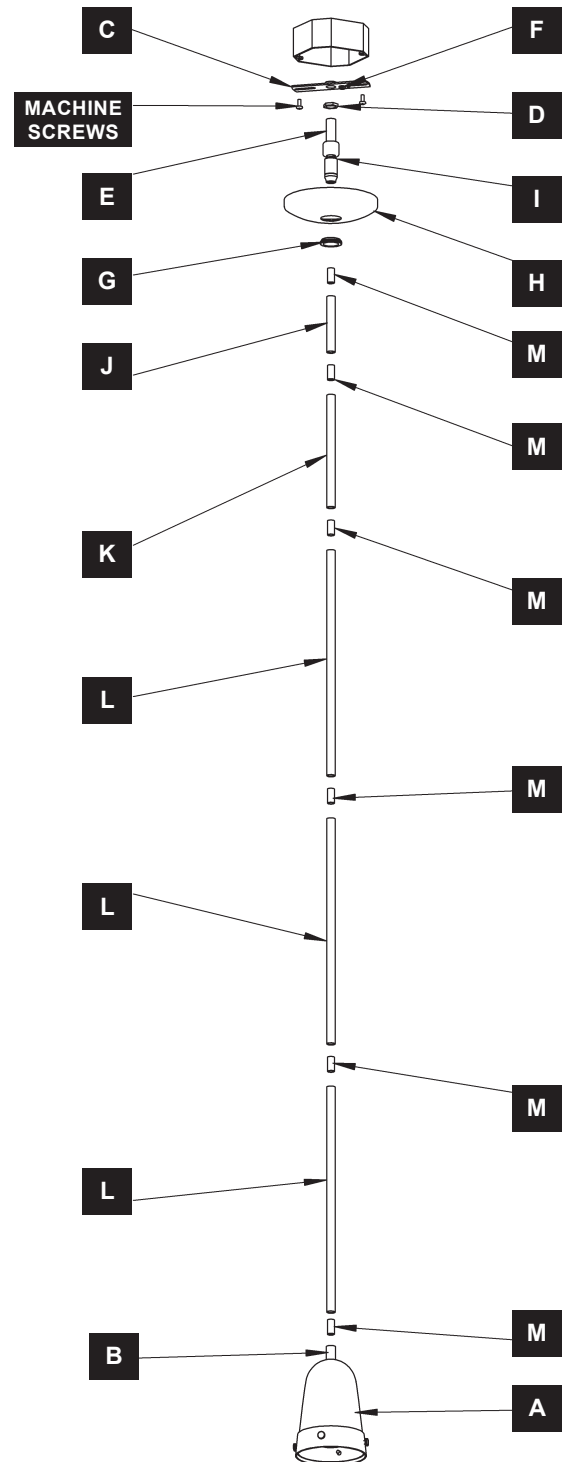

(Figure 1)

If you need further assistance, or find that you are missing any parts, please contact the dealer from which you purchased this product. We hope you enjoy your fixture!

** Hubbardton Forge will not be liable for injury or damage caused by improper installation, lamping or use of this fixture.*