

ASSEMBLY & INSTALLATION INSTRUCTIONS

A489

Courbe Pendant 139797

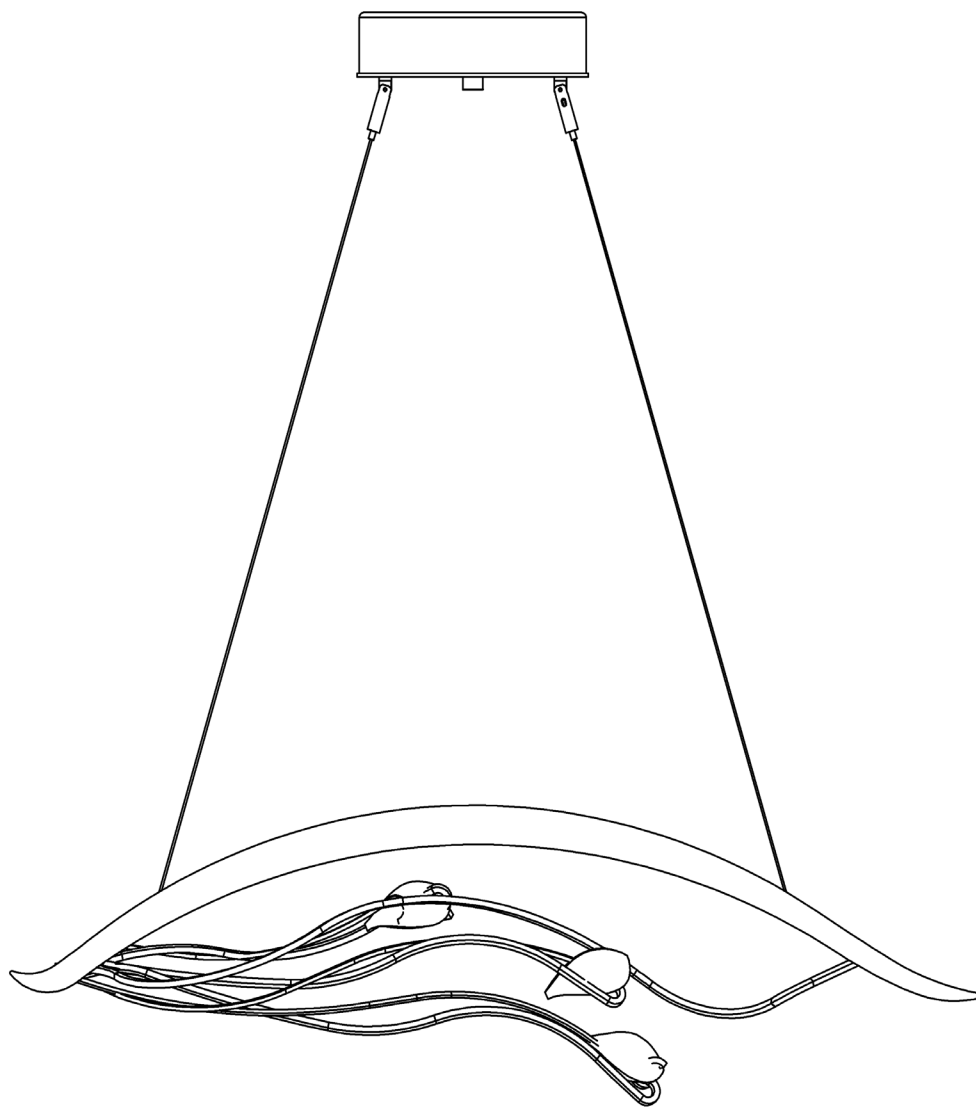

HUBBARDTON FORGE.

MODERN AMERICAN BLACKSMITHS | FINE, HAND CRAFTED LIGHTING
CASTLETON, VERMONT USA | HUBBARDTONFORGE.COM

37233 Rev A

Component Parts

- A Canopy**
- B Canopy Cover Plate**
- C Cap**
- D Threaded Nipple**
- E Ground Screw**
- F Cupped Washer**
- G Fixture**
- H Support/Supply Cable (2)**
- I Gripper (2)**
- J Crystals (3)**
- K Crystal Holder (3)**
- L Crystal Lock (3)**



ASSEMBLY & INSTALLATION INSTRUCTIONS

A489

Courbe Pendant 139797

CAUTION: FAILURE TO INSTALL THIS FIXTURE PROPERLY MAY RESULT IN SERIOUS PERSONAL INJURY OR DEATH AND PROPERTY DAMAGE. We recommend installation by a licensed electrician. This product must be installed in accordance with applicable installation code(s), by a person familiar with the construction and operation of the product and the hazards involved.*

Caution: Do not exceed maximum wattage noted on fixture. Use only recommended bulbs with fixture.

Please Note: After installation extra hardware and accessories are possible due to our kits are used on multiple products and options.

To Attach to Ceiling (Figure 1 - on following page)

CAUTION: BE SURE POWER IS OFF AT THE MAIN BREAKER BOX PRIOR TO INSTALLATION.

1. Carefully unpack fixture from the carton.
2. Locate canopy assembly. Remove cap (C) and canopy cover plate (B) and set aside for later use.
3. Thread the wires in the electrical box through the hole in the canopy (A) while moving the canopy into position. Using two machine screws (not provided) fasten canopy (A) to the electric box.

NOTE: POSITION THE CANOPY SO THAT THE GRIPPERS ARE IN LINE WITH THE DESIRED DIRECTION OF YOUR FIXTURE.

NOTE: A NEW ELECTRIC BOX COMES WITH SCREWS. WHEN REPLACING A FIXTURE, RETAIN THE EXISTING SCREWS FOR USE WITH THE NEW FIXTURE.

4. Using suitable wire connectors (not provided) connect driver wires to supply wires (white to white and black to black). Attach a pigtail lead to the canopy (A) using the provided ground screw (E) and cupped washer (F) in your kit bag. Holding canopy cover plate (B) up close to canopy (A), connect all ground wires (bare copper or green to bare copper or green) together.

CAUTION: MAKE SURE WIRE CONNECTORS ARE TWISTED ON SECURELY AND NO BARE WIRE IS EXPOSED.

5. Align (+) and (-) labels on canopy cover plate (B) with (+) and (-) labels on canopy (A).
6. Slip canopy cover plate (B) over threaded nipple (D) and up against canopy (A). Secure with cap (C).

CAUTION: BE SURE NO WIRES ARE PINCHED BETWEEN THE CANOPY (A) AND THE CEILING.

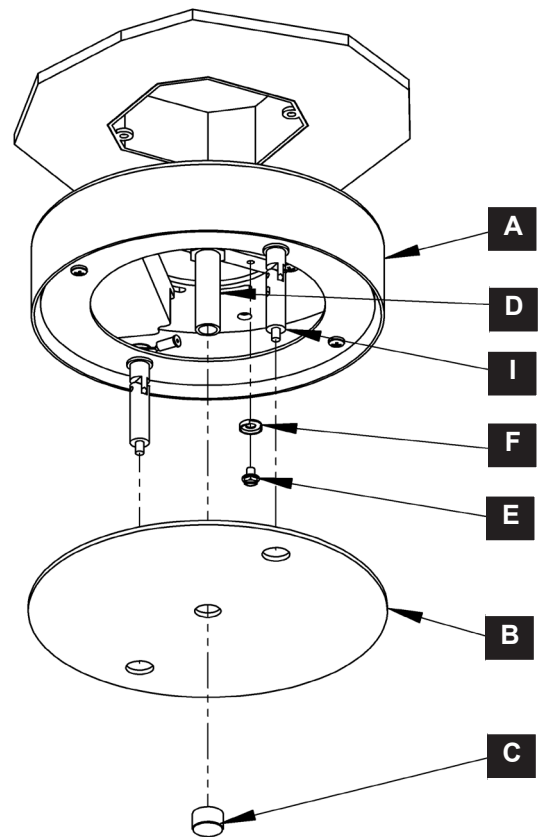

(Figure 1)



HUBBARDTON FORGE.

MODERN AMERICAN BLACKSMITHS | FINE, HAND CRAFTED LIGHTING
CASTLETON, VERMONT USA | HUBBARDTONFORGE.COM

37233 Rev A

To Hang Fixture (Figure 2)

1. Locate the positive (+) and negative (-) labels on bottom side of fixture (G).
2. Align the positive (+) and negative (-) labels on the fixture (G) with the positive (+) and negative (-) labels on the canopy cover plate (B).
3. Push the support/supply cable (H) from the positive (+) side of the fixture (G) into the positive (+) gripper (I). Push the cable (H) in far enough so that the cable exits the side of the gripper (I).
4. Repeat step 3 for the supply/support cable (H) on the negative side (-).
5. Adjust fixture (G) to desired height by pushing the supply/support cables (H) into the gripper (I).
6. If fixture (G) need to be lowered, press in the plunger on the gripper (I) and pull the supply/support cables (H) out as much as needed.
7. Once the fixture (G) is at the desired height, cut the supply/support cables (H) as close to the notch in the gripper (I) as possible.

NOTE: ONCE CABLES ARE CUT THE FIXTURE CAN NO LONGER BE LOWERED.

8. Follow instructions on the following page to install crystals.

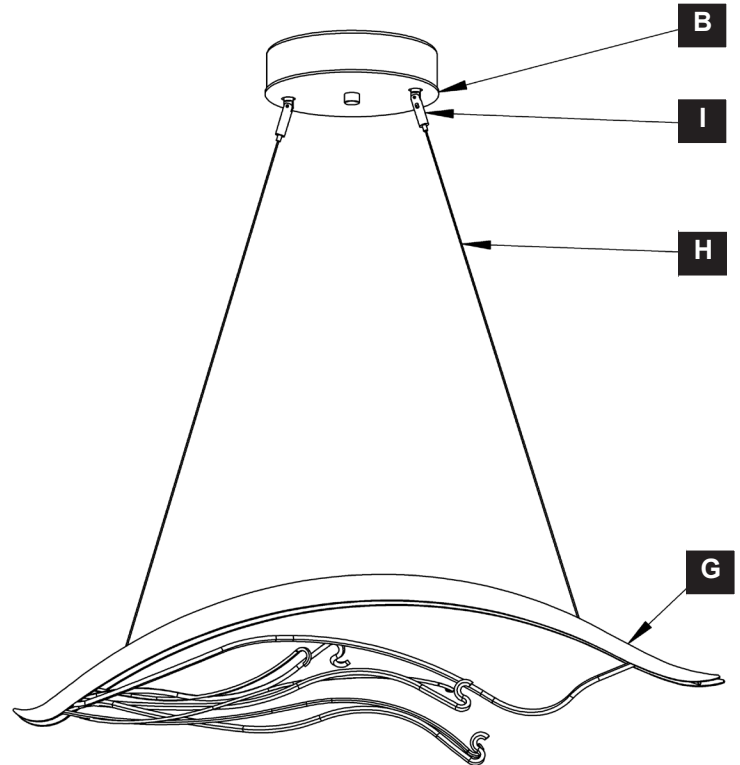

(Figure 2)

ASSEMBLY & INSTALLATION INSTRUCTIONS

A489

Courbe Pendant 139797

To Install Crystals (Figure 3)

1. Locate the crystals (J) and white gloves.

NOTE: : USING WHITE GLOVES WHILE HANDLING THE CRYSTALS (J) WILL PREVENT SMUDGES.

2. Place larger end of crystal (J) into crystal holder (K). Crystal orientation shown in Figure 3.

NOTE: CURVE IN CRYSTAL (J), MATCHES CURVE IN CRYSTAL HOLDER (K). LINING THESE UP WILL AID IN INSTALLATION.

NOTE: CENTER CRYSTAL (J) ON EACH FIXTURE SITS IN A DIFFERENT ORIENTATION THAN THE OUTER TWO CRYSTALS (J). THE CENTER CRYSTAL (J) LAYS FLAT AS COMPARED TO THE VERTICAL ORIENTATION OF THE OTHER TWO.

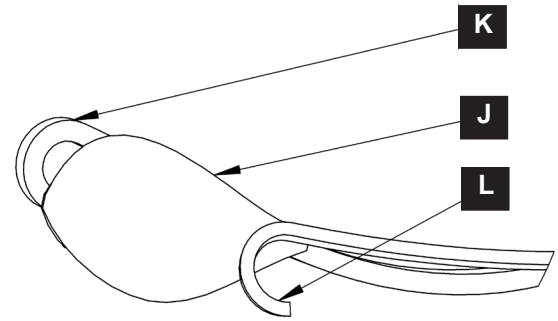

(Figure 3)

3. Flex crystal lock (L) until it's holding smaller end of crystal (J).
4. Repeat steps 2 and 3 to install the remaining crystals.
5. If needed, use the provided white gloves to polish the crystals.
6. Restore electricity at the main breaker.

If you need further assistance, or find that you are missing any parts, please contact the dealer from which you purchased this product. We hope you enjoy your fixture!

*** Hubbardton Forge will not be liable for injury or damage caused by improper installation, lamping or use of this fixture.**