

# Assembly & Installation Instructions

For Pendant 18-791 & 18-793

**A196**

Page 1 of 5

**CAUTION: FAILURE TO INSTALL THIS FIXTURE PROPERLY MAY RESULT IN SERIOUS PERSONAL INJURY OR DEATH AND PROPERTY DAMAGE. We recommend installation by a licensed electrician.**

This product must be installed in accordance with applicable installation code(s), by a person familiar with the construction and operation of the product and the hazards involved.\*

**Caution:** Do not exceed maximum wattage noted on fixture. Use only recommended bulbs with fixture.

## **Stem Assembly** (Figures 1 & 2)

### **Component Parts**

- A 8-32 Screw (2)
- B Top Assembly
- C Bottom Assembly
- D Fixture Pipe
- E Fixture Coupling

1. Carefully unpack the fixture from the carton.
2. Remove two 8-32 screws (A) from top assembly (B) to separate from bottom assembly (C). Place bottom assembly (C) and two 8-32 screws (A) to the side for later use.
3. Carefully thread fixture pipe (D), threaded end first, over fixture wires.
4. Apply a drop of the supplied thread locking compound to the internal threads of the fixture coupling (E) and screw stem into fixture, being careful not to twist the wires.

**Note:** Application of the thread locking compound is necessary to prevent the stem from loosening during regular maintenance and cleaning of the fixture. Be certain to apply the compound.

5. See instructions below to complete the installation.

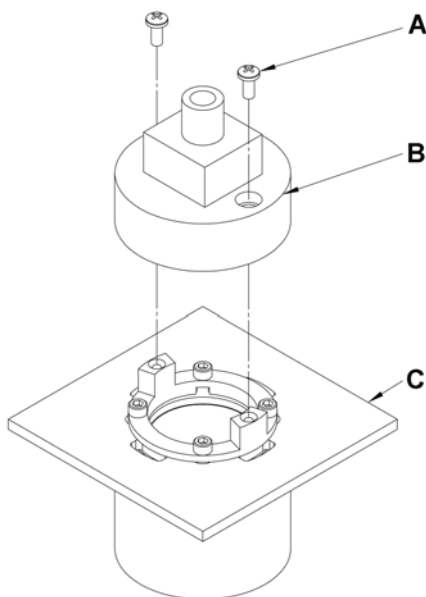

(Figure 1)

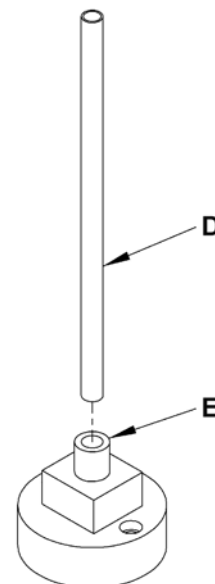

(Figure 2)

(continued)

# Assembly & Installation Instructions

For Pendant 18-791 & 18-793

**A196**

Page 2 of 5

## Prepare the Canopy (Figure 3)

### Component Parts

- F Jam Nuts (2)
- G Crossbar
- H Threaded Nipple
- I Canopy
- J Canopy Ring
- K Coupling
- L Canopy Pipe

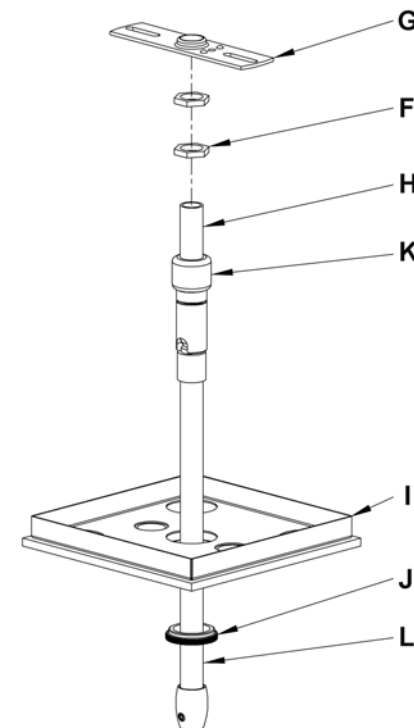

(Figure 3)

**Caution:** Be sure power is off at the main breaker box prior to installation.

1. Thread Jam Nuts (F) and Crossbar (G) onto threaded nipple (H) leave both parts loose.
2. Using two machine screws (not provided), temporarily fasten the crossbar (G) to the electric box. **Note:** A new electric box comes with screws. When replacing a fixture, retain the existing screws for use with the new fixture.
3. Adjust the length of Threaded Nipple (H) in crossbar (G) so that Canopy Ring (J) will hold Canopy (I) against the ceiling with no threads showing for best appearance. When the correct adjustment is established, tighten Jam Nuts (F) against crossbar (G) to hold the adjustment.
4. Remove the crossbar and stem from the electrical box and proceed with the assembly instructions.

## Complete Assembly and Install (Figures 4 & 5, next page)

### Component Parts

- |                   |                         |
|-------------------|-------------------------|
| D Fixture Pipe    | J Canopy Ring           |
| F Jam Nut         | L Canopy Pipe           |
| G Crossbar        | M Plastic Clutch Sleeve |
| H Threaded Nipple | N Clutch                |
| I Canopy          | O Set Screw             |

**Caution:** Be sure power is off at the main breaker box prior to installation.

1. Thread crossbar (G) onto threaded nipple (H) until tight against jam nuts (F).
2. Unscrew the clutch (N) from the canopy pipe (L); slide it across the wires and onto the fixture pipe (D). Follow this with the plastic clutch sleeve (M), oriented so the tapered end of the clutch sleeve nests in the clutch (Figure 4).
3. Thread wires from the fixture pipe (D) through the canopy pipe (L).
4. Slide the canopy pipe (L) as far as necessary to give you the total length of the fixture which you desire. Be careful not to scratch the pipe surfaces and to pull excess wire up through the canopy pipe (L). There must be a minimum 1-1/2" of inner pipe inside the outer pipe. Screw clutch (N) onto canopy pipe and hand-tighten the clutch to temporarily hold this adjustment. The clutch is not securely fastened at this point; do not depend on it to hold the fixture. **Important:** To ensure full connection strength, be sure the tapered end of the plastic clutch sleeve is oriented toward the clutch when assembled and securely tighten set screw (Figure 4).
5. Using two machine screws (not provided), fasten the crossbar to the electric box.  
**Note:** A new electric box comes with screws. When replacing a fixture, retain the existing screws for use with the new fixture.

(continued)

# Assembly & Installation Instructions

For Pendant 18-791 & 18-793

**A196**

Page 3 of 5

- Using suitable wire connectors (not provided), connect fixture wires to supply wires (white to white or ribbed side of the fixture cord, black to black or smooth side, and bare copper to bare copper or green supply). Push wires back into outlet box.

**Caution:** Make sure wire connectors are twisted on securely, and no bare wire is exposed.

- Slide fixture canopy (I) against ceiling, and secure with canopy ring (J).
- Refer to instructions following to install glass.

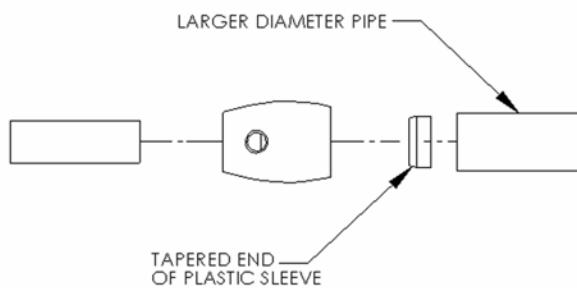

(Figure 4)

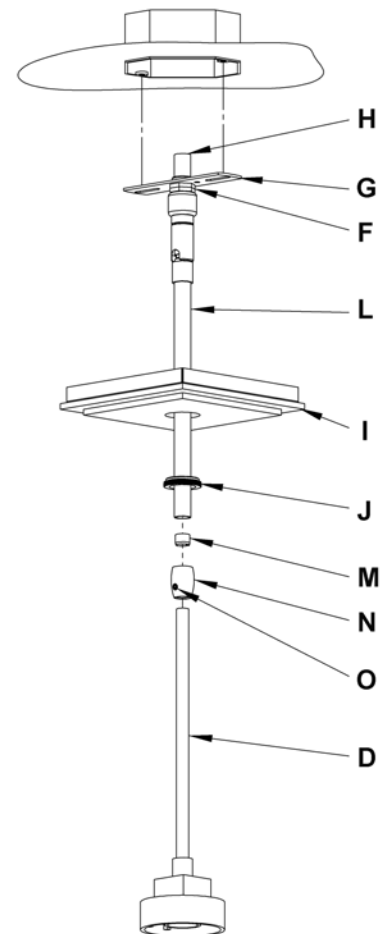

(Figure 5)

(continued)

# Assembly & Installation Instructions

For Pendant 18-791 & 18-793

**A196**

Page 4 of 5

## **To Assemble Glass or Screen Option** (Figures 6 & 7)

### **Component Parts**

- C Bottom Assembly
- P Tube Assembly
- Q 6-32 Screws (4)
- R Screen
- S Glass Tube
- T Retainer
- U Flat Head Screws (3)

1. Remove tube assembly (P) from bottom assembly (C) by removing four 6-32 screws (Q) and separating tube assembly (P) from retainer (T). Set all parts to the side for later use (Figure 6).
2. Remove flat head screws (U) from tube assembly (P) and set aside for later use.
3. Thread screws (U) through either screen (R) or glass tube (S) depending on option purchased and into tube assembly (P).
4. Tighten the three screws (U) equally into tube assembly so that screen or glass is centered.

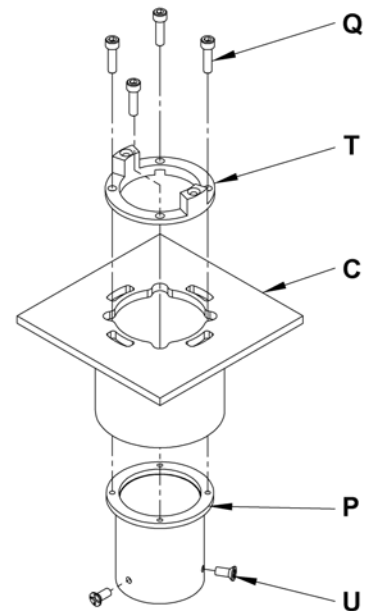

(Figure 6)

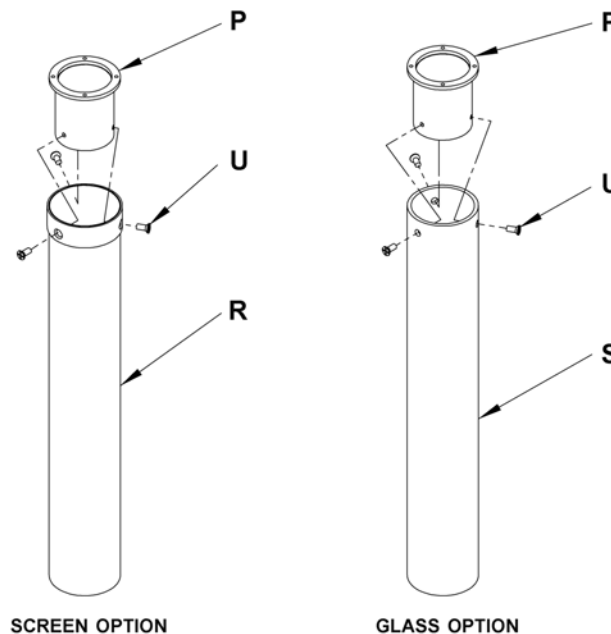

(Figure 7)

(continued)

# Assembly & Installation Instructions

For Pendant 18-791 & 18-793

**A196**

Page 5 of 5

## **To Assemble Bottom** (Figure 8)

### **Component Parts**

- A Bottom Assembly
- P Tube Assembly
- Q 6-32 Screws (4)
- T Retainer

1. Slip 6-32 screw (Q) through retainer (T) and bottom assembly (C). Thread screws (Q) into tube assembly (P) and tighten with supplied Allen wrench.

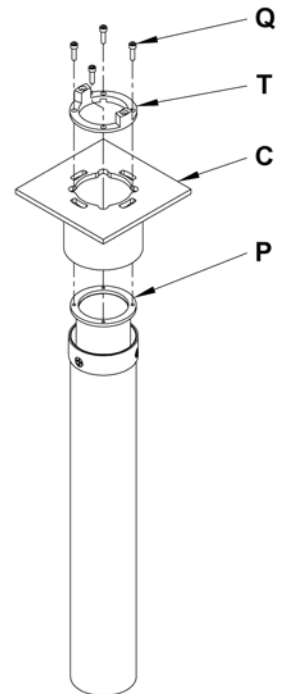

(Figure 8)

## **To Install Glass or Screen Option & Bulb** (Figure 9)

### **Component Parts**

- A 8-32 Screw (2)
- B Top Assembly
- C Bottom Assembly

1. Install light bulb (not included).
2. Install 8-32 screw (A) through top assembly (B) and thread into bottom assembly (C). To replace bulb the two 8-32 (A) screws are removed to separate bottom assembly from top assembly.
3. Restore electricity at main breaker.

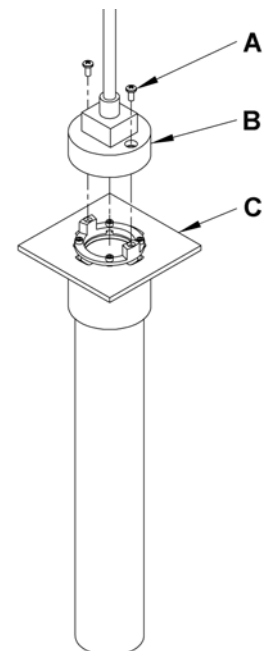

(Figure 9)

*If you need further assistance, or find that you are missing any parts, please contact the dealer from which you purchased this product. We hope you enjoy your fixture!*

\* Hubbardton Forge will not be liable for injury or damage caused by improper installation, lamping or use of this fixture.

# ASSEMBLY & INSTALLATION INSTRUCTIONS

A735

Airis Mini Pendant Large 187930

---

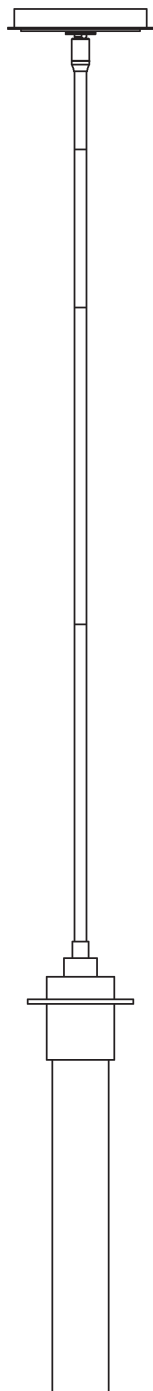

HUBBARDTON FORGE.

MODERN AMERICAN BLACKSMITHS | FINE, HAND CRAFTED LIGHTING  
CASTLETON, VERMONT USA | HUBBARDTONFORGE.COM

49016

1 OF 5

## Component Parts

- A 8-32 Screws**
- B Top Assembly**
- C Bottom Assembly**
- D Jam Nut**
- E Crossbar**
- F Threaded Nipple**
- G Ground Screw**
- H Swivel**
- I Canopy Ring**
- J Canopy**
- K 3" Fixture Pipe (1)**
- L 6" Fixture Pipe (1)**
- M 12" Fixture Pipe (3) Note: Only two 12" stems are shown in the illustration**
- N Stem Nipple (6)**
- O Fixture Coupling**
- P 6-32 Screw (4)**
- Q Retainer**
- R Tube Assembly**
- S Flat Head Screw (3)**
- T Screen or Glass Tube (depending on option purchased)**



# ASSEMBLY & INSTALLATION INSTRUCTIONS

A735

Airis Mini Pendant Large 187930

**CAUTION: FAILURE TO INSTALL THIS FIXTURE PROPERLY MAY RESULT IN SERIOUS PERSONAL INJURY OR DEATH AND PROPERTY DAMAGE.** We recommend installation by a licensed electrician. This product must be installed in accordance with applicable installation code(s), by a person familiar with the construction and operation of the product and the hazards involved.\*

Caution: Do not exceed maximum wattage noted on fixture. Use only recommended bulbs with fixture.

Please Note: After installation extra hardware and accessories are possible due to our kits are used on multiple products and options.

## To Install Fixture (Figure 1 and 2 on following page)

**CAUTION: BE SURE POWER IS OFF AT THE MAIN BREAKER BOX PRIOR TO INSTALLATION.**

1. Carefully unpack fixture from the carton
2. Remove two 8-32 screws (A) from top assembly (B) to separate from bottom assembly (C). Set bottom assembly and 8-32 screws aside for later use.
3. Thread jam nut (D) and crossbar (E) onto threaded nipple (F) with ground screw (G) facing towards swivel (H); leave both parts loose.
4. Using two machine screws (not provided), temporarily fasten crossbar (E) to the electric box.

**NOTE: A NEW ELECTRIC BOX COMES WITH SCREWS. WHEN REPLACING A FIXTURE, RETAIN THE EXISTING SCREWS FOR USE WITH THE NEW FIXTURE.**

5. Adjust the length of threaded nipple (F) in crossbar (E) so that canopy ring (I) will hold canopy (J) against the ceiling with no threads showing for best appearance. When the correct adjustment is established, tighten jam nut (D) against crossbar (E) to secure the adjustment.
6. Remove crossbar (E) from the electrical box and proceed with the assembly instructions.
7. Locate fixture pipes (K, L, M), top assembly (B) and stem nipples (N). Nipples (N) can be found in the kit bag.
8. Provided are multiple fixture pipes in three different lengths. Choose the combination that will achieve the overall height desired. Refer to the table below to determine the pipes required to reach the desired overall height. Once you have determined the components necessary, feed the wires that exit fixture coupling (O) through the individual components and thread pipes and couplings together. Wires will slip easier through loose components than through pipes and couplings that are pre-assembled. Once wires are run, apply thread locking compound to all the connection points and assemble the pipes and nipples.

		Overall Height of Fixture															
		24	27	30	33	36	39	42	45	48	51	54	57	60	63	66	69
# of Pipes Required	3" Pipe (J)		1		1		1		1		1		1		1		1
	6" Pipe (K)			1	1			1	1			1	1			1	1
	12" Pipe (L)					1	1	1	1	2	2	2	2	3	3	3	3

**NOTE: APPLICATION OF THE THREAD LOCKING COMPOUND IS NECESSARY TO PREVENT THE PIPE FROM LOOSENING DURING REGULAR MAINTENANCE AND CLEANING OF THE FIXTURE. BE CERTAIN TO APPLY THE COMPOUND.**

9. Carefully slide canopy ring (I) and canopy (J) over wires and fixture pipes (K, L, M) until they rest on top assembly (B).
10. Slip wires from the fixture through assembled swivel (H) and thread swivel onto final pipe. It may be necessary to remove a nipple (N) for this to work on shorter overall fixture height.



HUBBARDTON FORGE.

MODERN AMERICAN BLACKSMITHS | FINE, HAND CRAFTED LIGHTING  
CASTLETON, VERMONT USA | HUBBARDTONFORGE.COM

49016

3 OF 5



14. Continue to next page to complete the installation.

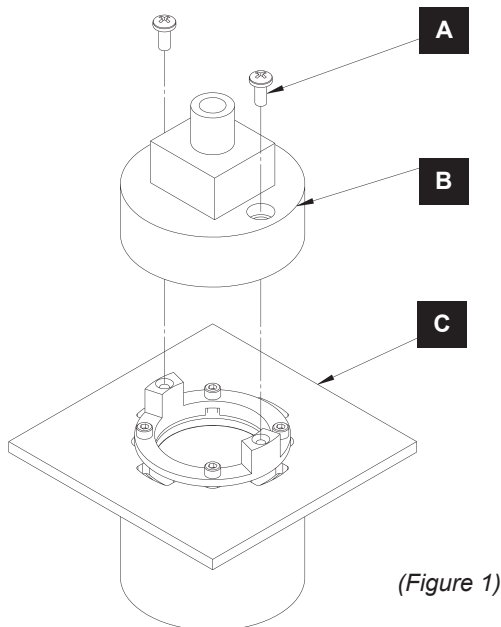

(Figure 1)

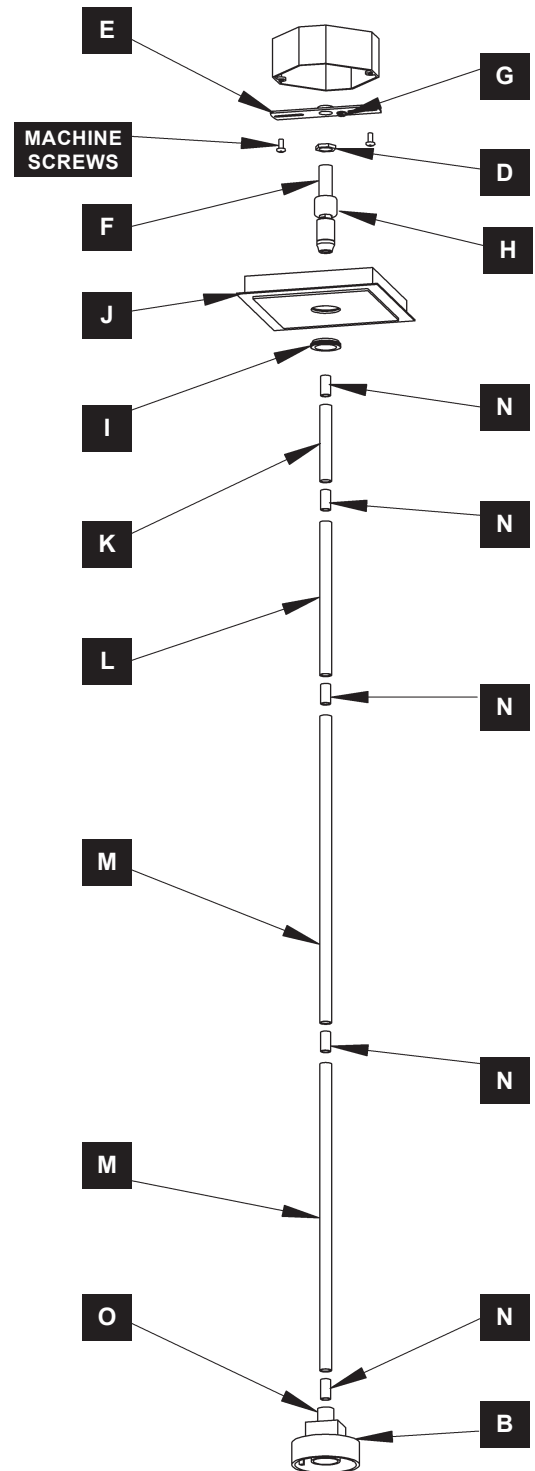

(Figure 2)

# ASSEMBLY & INSTALLATION INSTRUCTIONS

A735

## Airis Mini Pendant Large 187930

15. Refer to figure 3. Remove tube assembly (R) from bottom assembly (C) by removing four 6-32 screws (P) and separating tube assembly from retainer (Q).
16. Refer to figure 4. Remove flat head screws (S) from tube assembly then reinstall through holes in screen or glass to attach screen or glass to tube assembly. Tighten the three screws equally to center the screen or glass.
17. Refer to figure 5. Slip 6-32 screws (P) through retainer (Q) and bottom assembly (C). Thread screws (P) into tube assembly (R) and tighten with supplied Allen wrench.
18. Install GU-10 based MR-11 bulb (not included).
19. Refer to figure 6. Install 8-32 screws (A) through top assembly (B) and into bottom assembly (C). Reverse this process when replacing bulb.
20. Restore electricity at main breaker.

(Figure 3)

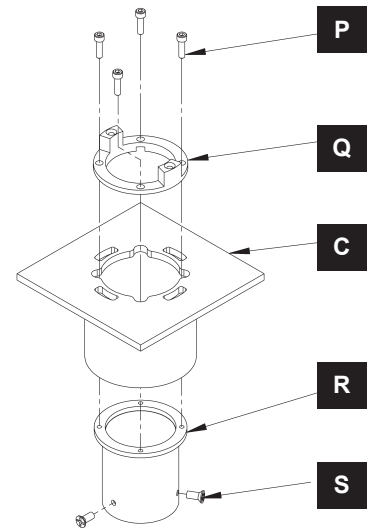

(Figure 4)

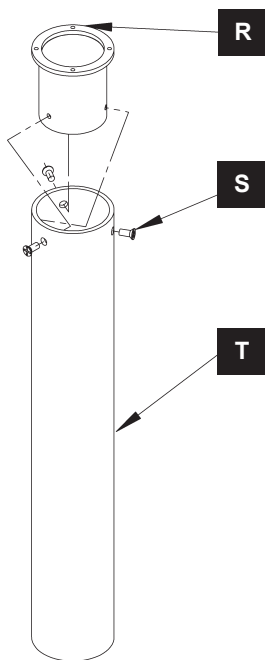

(Figure 5)

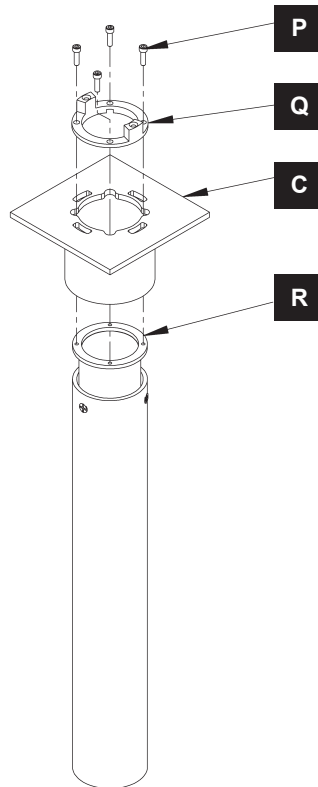

(Figure 6)

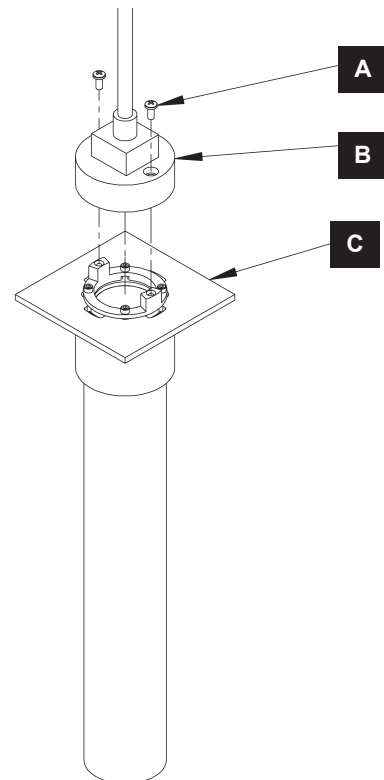

If you need further assistance, or find that you are missing any parts, please contact the dealer from which you purchased this product. We hope you enjoy your fixture!

*\* Hubbardton Forge will not be liable for injury or damage caused by improper installation, lamping or use of this fixture.*



HUBBARDTON FORGE.

MODERN AMERICAN BLACKSMITHS | FINE, HAND CRAFTED LIGHTING  
CASTLETON, VERMONT USA | HUBBARDTONFORGE.COM