

INSTALLATION INSTRUCTIONS

Item#P23-084 (New. 02/11/2019)

READ AND SAVE THESE INSTRUCTIONS

WARNING! SHUT POWER OFF AT FUSE OR CIRCUIT BREAKER.

AVERTISSEMENT! COUPER LE COURANT AU NIVEAU DES FUSIBLES OU DU DISJONCTEUR.

PREPARATION (Fig. 1)

1. Shut off power at the fuse box or circuit breaker box and remove the old fixture including the mounting hardware.
2. Carefully unpack your new fixture and lay out all the parts in a clean area. Take care not to misplace any small parts necessary for installation.
3. Align the outside clear glass (F) onto lamp head (K) and secure with screws (E).
4. Insert small etched glass (G) over the socket (L) and secure with screw shell (H)
5. Thread two mounting screws (A) into pre-drilled hole in the circular strap (B). Space the same distance apart as the holes in the canopy (D).
6. Attach the circular strap (B) to the junction box using mounting screws (C) (Size: #8-32N*L0.5"). Note: The side of the circular strap (B) marked "GND" must face out.
7. Determine the desired hanging height and if necessary, cut the cord (M) leaving an additional 5" to allow for the electrical connections. Secure the cord (M) into metal bushing (N) by tightening screw (O). Carefully cut and remove approximately 4" of the outer sheathing from the cord (M) and strip 1/2" of the wire ends bare to expose the copper strands.

CONNECTING THE WIRES (Fig. 2)

8. Connect the electrical wires as shown in Fig.2 making sure that all wire connectors are secured. If your outlet box has a ground wire (green or bare copper), connect the fixture's ground wire to it. Otherwise, connect the fixture's ground wire directly to the circular strap (B) using the green screw provided. Tuck wires neatly back into the junction box.

COMPLETING THE INSTALLATION (Fig. 1)

9. Place the canopy (D) onto the mounting screws (A) and secure with knurled knobs (J).
10. Install (1) one candelabra base bulb (I) up to 60 watts each or CFL or LED equivalent (not included) in accordance with the fixture specification—**DO NOT EXCEED THE MAXIMUM WATTAGE RATING! (NE PAS DEPASSER LA PUISSANCE NOMINALE MAXIMALE!)**.

Your installation is now complete. Return power to the junction box and test the fixture.

Fig. 1

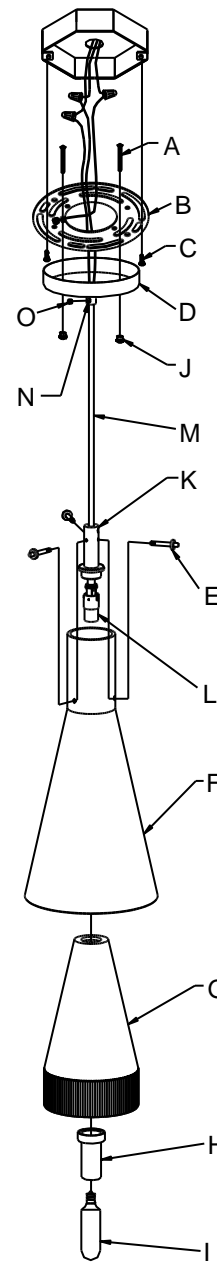

Set# A-020

- Circular Strap
- Ground Screw
- Mounting Screw*2

Fig. 2

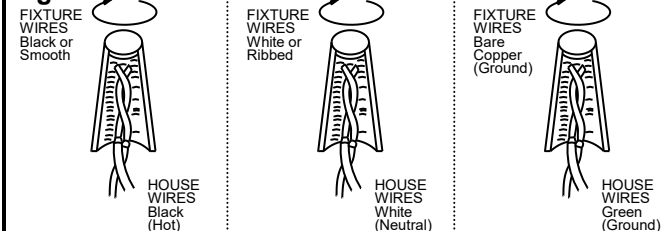

LA-3091E

ETL LISTED
Intertek

american
lighting
association