

# Curt Pendant

AC1083 AC1094 AC1106 | 1.0

## GENERATION LIGHTING PENDANT

### GENERAL PRODUCT INFORMATION:

These fixtures are intended to be installed utilizing NEC compliant junction boxes.

This product is safety listed for damp locations.

Incandescent version may be dimmed with a standard incandescent dimmer. LED version may be dimmed with a LED dimmer. Consult lamp manufacturer for additional information.

This instruction shows a typical installation.

**CAUTION - RISK OF FIRE**  
 This product must be installed in accordance with the applicable installation code by a person familiar with the construction and operation of the product and the hazards involved.  
 Use minimum 90°C supply conductors.

**SAVE THESE INSTRUCTIONS!**

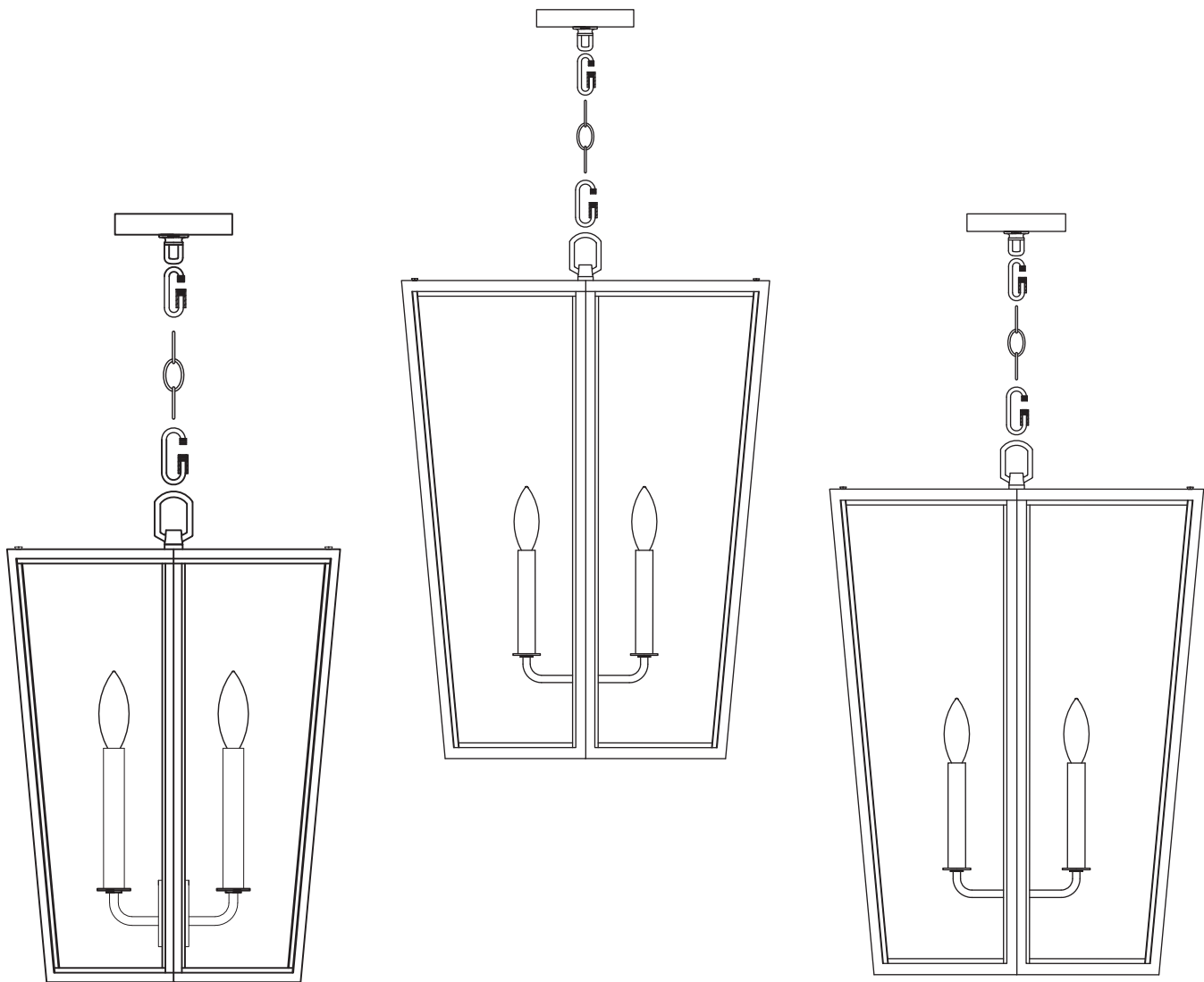

GENERATION LIGHTING  
 7400 Linder Ave., Skokie, IL 60077  
 T 847.410.4400 | F 847.410.4500  
[www.generationlighting.com](http://www.generationlighting.com)

# Install the Fixture

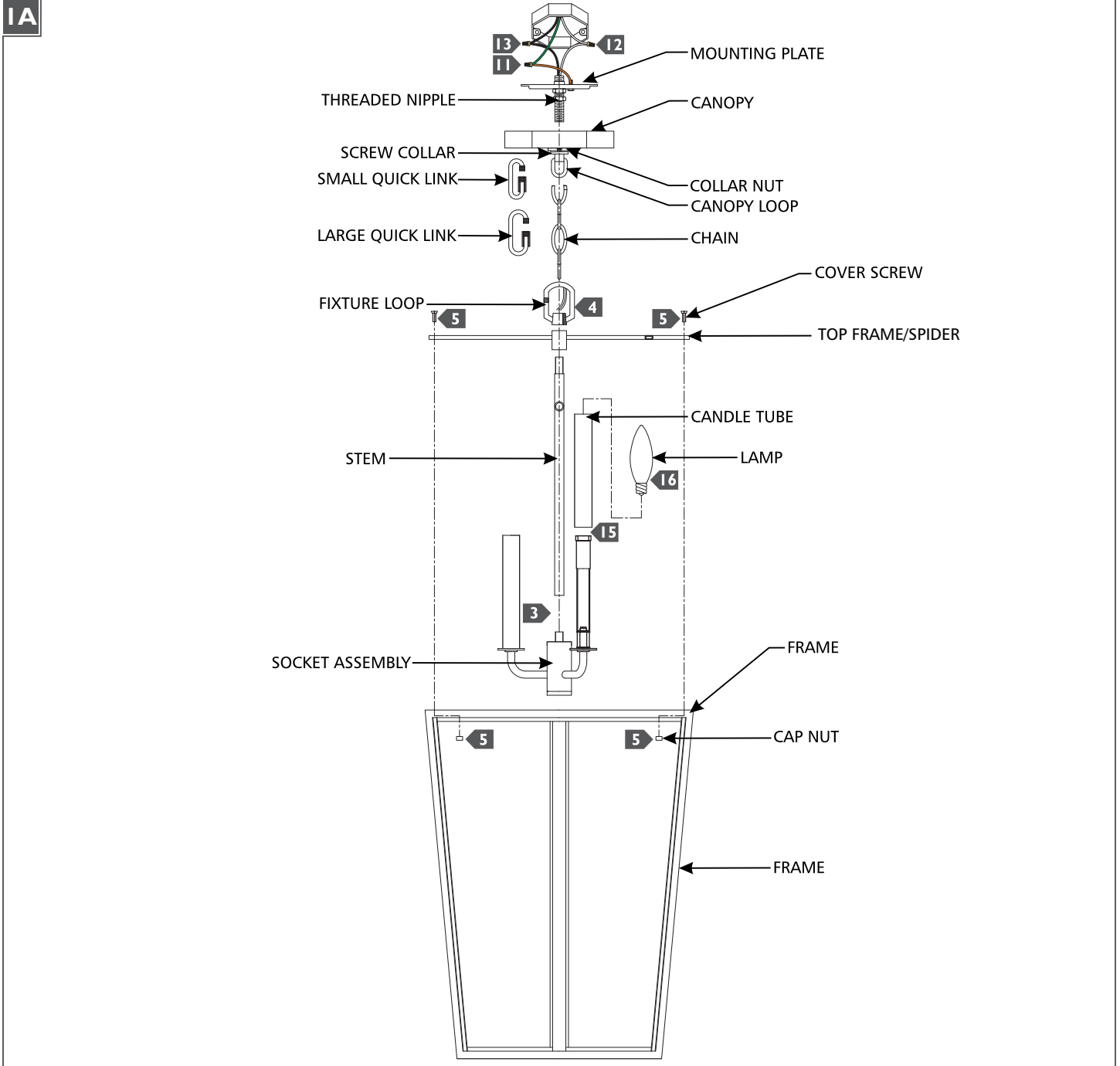

- 1** If necessary, screw the short end of the threaded nipple onto the mounting plate, then screw the screw collar and canopy loop onto the threaded nipple.
- 2** Secure the mounting plate to the junction box.
- 3** Feed the fixture wires through the stem and screw it to the top of the socket assembly.
- 4** Feed the fixture wires through the top frame/spider and fixture loop, then secure them together by screwing the fixture loop onto the stem.
- 5** Align the top frame/spider to the top of the frame and secure them together using the frame screws and cap nuts.
- 6** Determine the wanted height of the fixture and remove a portion of the chain from the bottom by opening a link with pliers.
- 7** Install a large quick link to bottom end of the chain, then secure the large quick link onto the fixture loop.
- 8** Unscrew the collar nut from the screw collar, then install the collar nut and the canopy onto the chain (in that order).
- 9** Install a small quick link onto the remaining end of the chain, then secure the small quick link onto the canopy loop.
- 10** Weave the cord through the chain, collar nut, and canopy, threaded nipple, and out of the junction box. Trim the cord leaving enough to make electrical connections.
- 11** Connect the fixture to a suitable ground in accordance to local electrical codes.
- 12** Connect the white fixture wire (square and/or rigid) to the neutral power line wire with a wire nut.
- 13** Connect the black fixture wire (round and/or smooth) to the hot power line wire with a wire nut.
- 14** Neatly place all the wires into the junction box, place the canopy onto the mounting plate, and secure it in place by screwing the collar nut tightly onto the screw collar.
- 15** Install the candle tubes by sliding them over the sockets.
- 16** Screw the lamps into the sockets. Refer to the label on the lamp socket for Max Wattage information.