

# Garrett Table Lamp

CT1001 | 1.1

## GENERATION LIGHTING

### Portable

#### GENERAL PRODUCT INFORMATION:

This product is safety listed for dry locations only.

This instruction shows a typical installation.

**IMPORTANT SAFETY INSTRUCTIONS**  
 This portable lamp has a polarized plug (one blade is wider than the other) as a safety feature to reduce the risk of electric shock. This plug will fit in a polarized outlet only one way. If the plug does not fit fully in the outlet, reverse the plug. If it still does not fit contact a qualified electrician. Never use with an extension cord unless plug can be fully inserted. Do not attempt to defeat this safety feature.

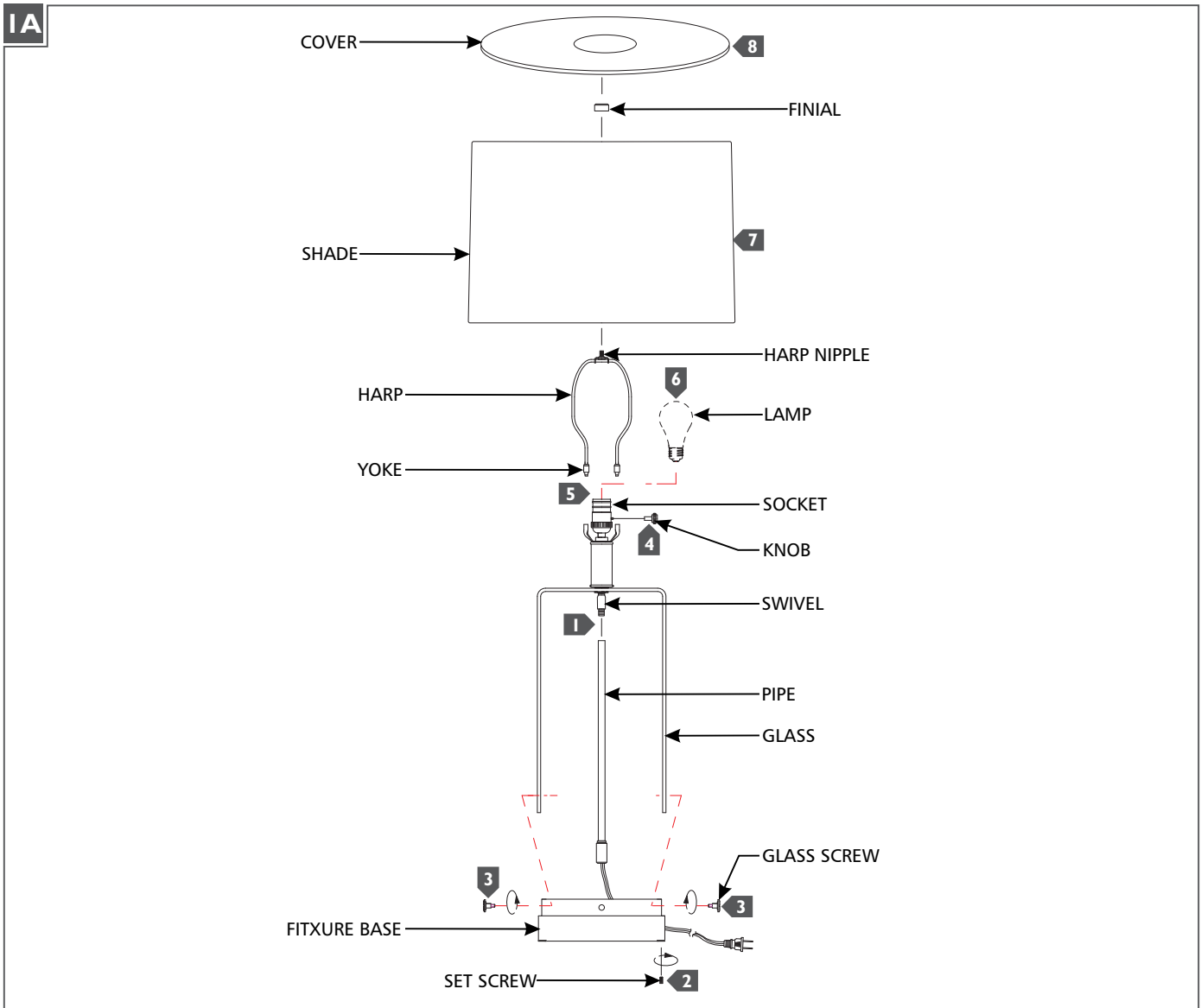

- 1** Screw the pipe to the swivel inside the socket/glass assembly.
- 2** Determine the desired length of the power cord by feeding the cord into the base to shorten it or gently pulling it out of the base to increase the length. Tighten the set screw on the bottom of the base to secure the power cord in place.
- 3** Carefully lower the socket/glass assembly onto the fixture base, align the glass holes with the holes on the fixture base, and secure it in place using the glass screws.
- 4** Install the knob onto the socket by screwing it on.
- 5** Install the harp by inserting it in the yoke.
- 6** Screw the lamp into the socket. Refer to the label on the lamp socket for Max Wattage information.
- 7** Install the shade by placing the shade over the harp nipple and screwing the finial onto the nipple to secure it in place.
- 8** Place the cover on the top of the shade.

**SAVE THESE INSTRUCTIONS!**

GENERATION LIGHTING

7400 Linder Ave, Skokie, IL 160077

800.969.3347

**[www.generationlighting.com](http://www.generationlighting.com)**

© 2019 Generation Lighting. All rights reserved.

The "Generation Lighting" graphic is a registered trademark of Generation Lighting. Generation Lighting reserves the right to change specifications for product improvements without notification.