

SOOCAS | NEOS



User Manual

**The Dual-action Brushing and  
Flossing Electric Toothbrush**

# Table of Contents

Socas Neos User Manual · EU .....	01
-----------------------------------	----

Thank you for choosing Soocas oral care series: Soocas Neos Electric Toothbrush

Please read this manual carefully and the correct method of usage for Soocas Neos Electric Toothbrush to fully understand its performance to better clean and care for your oral health.

Product Name: Soocas Neos Eclectic Toothbrush

Model: T03

Input Power: 5V  $\approx$  1A

Charging Time: 8 Hours

Charging Method: Wireless

Made in China

Product Origin: Shenzhen, China

Address: Room 401, 402, 1101, 1102, 1103, 1104, Building 2 Chongwen Area, Nanshan iPark, No. 3370 Liuxian Avenue, Fuguang Community, Taoyuan Subdistrict, Nanshan District, Shenzhen, China



All products bearing this symbol are waste electrical and electronic equipment (WEEE as in directive 2012/19/EU) which should not be mixed with unsorted household waste. Instead, you should protect human health and the environment by handing over your waste equipment to a designated collection point for the recycling of waste electrical and electronic equipment, appointed by the government or local authorities. Correct disposal and recycling will help prevent potential negative consequences to the environment and human health. Please contact the installer or local authorities for more information about the location as well as terms and conditions of such collection points.



# Table of Contents

---

Safety Precautions .....	3
How to Get Started? .....	4
Cleaning and Maintenance .....	7
Power Recharge .....	8
Environmental Protection .....	8
Troubleshooting .....	10



# Safety Precautions

When using this product for the first time, it is common to experience minor discomfort with some gum bleeding. This is because the gums are not quite used to the high-vibration cleaning method. It is recommended to use gentle mode for beginners and expects this discomfort to continue for 1-2 weeks upon initial usage. If bleeding persists for longer than 2 weeks, please stop using the product immediately and consult professional assistance from your dentist.

## ⚠ Warning

- For users with teeth correction, dental repair, dental implants, etc., please use this product under the guidance of a dentist or doctor.
- This product meets the safety standards of electromagnetic devices. For any issues related to pacemakers or other implantable devices, please consult a doctor or the manufacturer of the implant before use.
- This product is only designed for cleaning teeth, gums, and the tongue. Do not use it for any other purpose. If you feel any discomfort or pain, please stop using this product and seek professional assistance from a dentist or a doctor.
- Do not immerse the charging base in water or any liquid.
- Do not plug in the power supply with the charging base's power plug if it has any liquid on it.
- This product has a built-in rechargeable battery. Do not throw it into the fire or charge it in a high-temperature environment.
- Do not knock or drop this product. If the product is damaged due to collision or falling, please stop using it.
- Do not modify, disassemble or repair this product by yourself.
- This device is not suitable for people with physical, sensory, or mental disabilities, and lack of experience and knowledge (including children) to use unless they are supervised or instructed by a person responsible for their safety.
- Children should not play with this product.
- Cleaning and maintenance should not be done by children without supervision.
- Use a safe and compliant power adapter for charging.

## Cautious

- Please check for obvious damage before using the product. Do not use it if it is damaged or the machine has suffered a severe fall.
- Make sure that the charging port and charging cable are dry before charging; otherwise, it may cause an electric shock or short circuit.
- This product has a built-in battery, do not throw it into the fire.
- Do not place it in a high-temperature or damp place, and avoid direct sunlight.
- The charging base cannot be used in outdoor direct sunlight.
- Do not use the toothbrush when soaking in a bath or shower.
- Do not share the brush head with others. Do not place metal objects on the charging base while it is powered on.
- Note: The product and accessory illustrations in the manual are for reference only. Due to product updates and upgrades, the actual product may differ slightly from the illustration. Please refer to the actual product.
- This product is intended for home-use only. Do not use it in a commercial setting.

# How to Get Started?

## 1. To Charge

- Please charge first before using it for the first time. Please use the 5V --- 1A charging adapter.
- Reminder: The charging base for this product is manufactured specifically for T03, thus it is not compatible with other products.

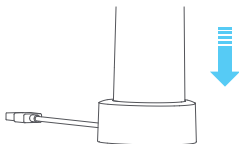

- ## 2. Ensure the bristle direction of the toothbrush head is aligned with the front of the toothbrush handle, then push the toothbrush head onto the motor shaft gently. Note that there will be a small gap between the toothbrush head and the handle to reduce friction between the two parts from the vibration of the motor.

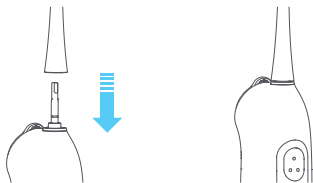

- ## 3. Wet the toothbrush head and squeeze an appropriate amount of toothpaste on it.

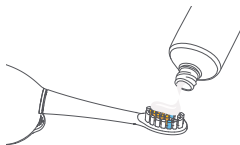

#### 4. To Turn On/Off and Pause

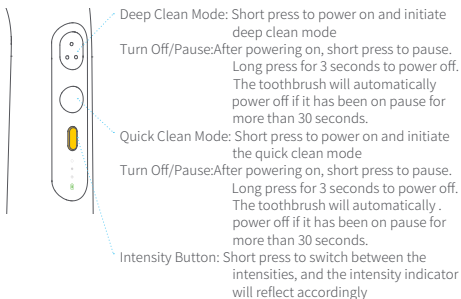

#### 5. Proper Cleaning Method

- Deep Clean Mode: The cleaning method that brush first then brush and floss simultaneously is ideal for morning brushing routines when using the deep clean mode.

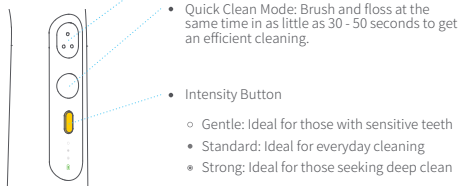
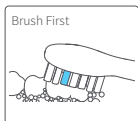

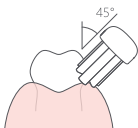

Place the bristle at 45° angle to the gum line and move slowly

Refrain from applying excessive force on the teeth as it harms the teeth and the gums. Moving the toothbrush head horizontally in short distances and letting the high-frequency vibration do the cleaning is recommended.

Brushing in short distances horizontally



#### 6. Refilling the Water

Lift the water tank cover and refill an appropriate amount of water. Lift down the water tank cover after done refilling to enjoy a brushing while flossing experience.

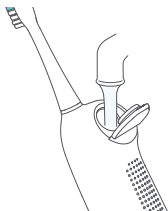
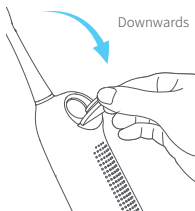

- It is recommended to use water below 104 °F.
- To prevent blockage or damage, do not mix toothpaste, salt, solid mouthwash tablets, or any chemical containing isopropyl myristate.

# Daily Cleaning and Maintenance

After brushing, rinse the toothbrush head under the water  
Reminder: It is recommended to replace the toothbrush head every three months

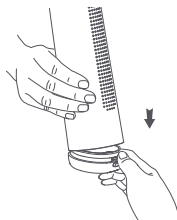
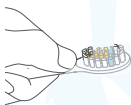

Hold the toothbrush body with one hand and press down on the release button at the bottom to uncover the water tank. Pour out the remaining liquid.



Use the water tank cleaning brush to thoroughly clean the interior of the water tank, then dry the product after cleaning

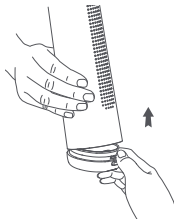

Align the cover to seal the water tank tightly

## Regular charging

	Battery Indicator Explanation	Battery Power Remaining
Under Normal Operation	Constant Green Light	30-100%
	Constant Red Light	10-30%
	Flashing Red Light	<10%
While Charging	Constant Green Light	100%
	Flashing Green Light	30-100%
	Flashing Red Light	0-30%

- When the battery indicator is flashing red light and the product cannot be turned on, it is an indicator the product is out of power and must be charged. It takes approximately 8 hours for a full charge, actual charging time varies depending on the remaining power on the battery.
- Reminder: Please recharge between 0C° - 45C°. It is unable to recharge in extreme low temperature (below 0C°) and extreme high temperature (higher than 45C°).

## Environmental Protection Protocol

When the product is at the end of its service life, according to local laws and regulations, one must remove the internal battery and undergo proper recycling and disposal procedures before the parts can be disposed of. If you are having trouble displacing the battery, please dispose of the product in accordance with the local waste clarification regulation.

## Warning

- Do not throw batteries into the fire to prevent battery explosion or the release of toxic and harmful substances.
- Do not short-circuit the battery to prevent battery combustion and fire.
- Unless the intention is to discard the product, do not disassemble the product parts to prevent damaging the product.
- Strict safety procedures must be taken place. Before removing the battery, the power connection must be disconnected.
- Before discarding the product, the battery must be removed from the product.
- The product must be powered off when removing the battery.
- Batteries should be disposed of safely.

## Remove the rechargeable battery

1. Use a flathead screwdriver to pry open the handle end cap.
2. Detach the cover and use a flathead screwdriver to pray open the inner motor. Pop out the motor.

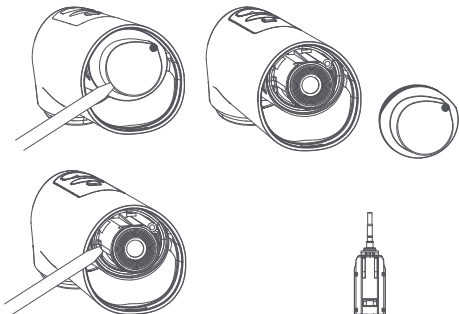

3. Cut the red wires on the inner motor.

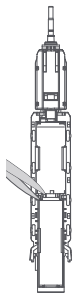

# Troubleshooting

Fault phenomenon	Possible reasons	Solution
Unable to boot	Unable to boot while charging	Disconnect charging
	Power is too low	Timely charging
Unable to install brush head	There is a foreign object in the brush head jack	Use a tool to take out foreign objects in the brush head jack
	There is an adhesive foreign object on the transmission shaft	Clean the transmission shaft
	Non-genuine brush head	Replace with genuine brush head
	Interpolation in reverse direction	Please refer to the installation instructions of the brush head
Brush head vibration is weak	Brush head is not installed in place	Reinstall the brush head