

T-9407/T-9409 7" & 9" Vertical Grinder 6,500 RPM

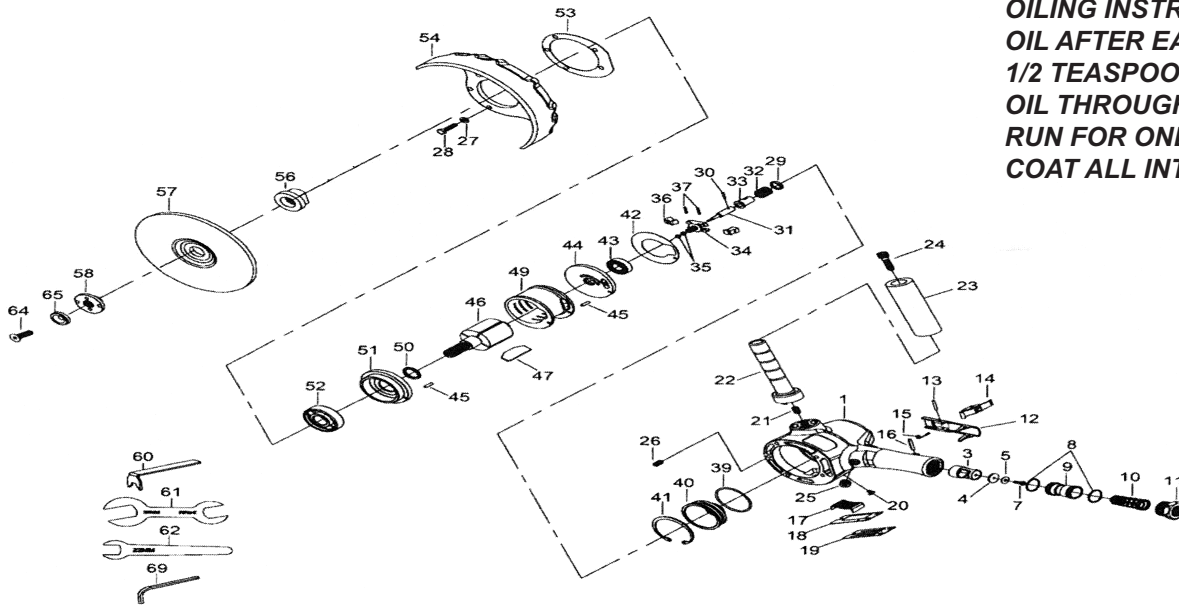

OILING INSTRUCTIONS:
OIL AFTER EACH USE WITH
1/2 TEASPOON OF AIRTOOL
OIL THROUGH THE AIR INLET.
RUN FOR ONE SECOND TO
COAT ALL INTERNAL PARTS



USE 90 PSI MAXIMUM

Ref #	Part #	Description	Qty.	Ref #	Part #	Description	Qty.
1	940701	Housing Assembly (Includes 21,25,26)	1	34	940734	Governor Valve Seat	1
3	940703	Throttle Valve Seat	1	35	940735	Nut	2
4	940704	Gasket	1	36	940736	Weight	2
5	940705	Washer	1	37	940737	Pin	1
7	940707	Screw	1	39	940739	O-Ring	1
8	940708	O-Ring	2	40	940740	Cup	1
9	940709	Throttle Valve	1	41	940741	Retainer	1
10	940710	Spring	1	42	940742	Gasket	1
11	940711	Air Inlet	1	43	940743	Bearing	1
12	940712	Trigger Assembly (Includes 13,14,15)	1	44	940744	Rear End Plate	1
13	940713	Spring Pin	1	45	940745	Pin	2
14	940714	Trigger Release	1	46	940746	Rotor	1
15	940715	Spring	1	47	940747	Rotor Blade (set of 4)	1set
16	940716	Spring Pin	1	49	940749	Cylinder	1
17	940717	Exhaust Deflector	1	50	940750	Spacer	1
18	940718	Gasket	1	51	940751	Front End Plate	1
19	940719	End Cap	1	52	940752	Bearing	1
20	940720	Screw	3	53	940753	Gasket	1
21	940721	Heli-Coil	1	54	940754	Guard 7"	1
22	940722	Side Handle (Includes 23)	1		940954	Guard 9"	1
23	940723	Grip	1	56	940756	Flange	1
24	940724	Screw	1	58	940758	Nut	1
25	940725	Set Screw	1	60	940760	Spanner	1
26	940726	Heli-Coil	5	61	940761	Spanner (24-26 mm)	1
27	940727	Washer	5	62	940762	Spanner (22 mm)	1
28	940728	Screw	5	64	940764	Screw	1
29	940729	Retaining Ring	1	65	940765	Washer	1
30	940730	Pin	1	69	940769	Hex Key Wrench	1
31	940731	Governor Valve Plunger	1				
32	940732	Spring	1				
33	940733	Governor Valve Bushing	1				

505 N. Railroad Ave. 33435
P.O. Box 1117 33425
Boynton Beach, Florida

SEE OUR CATALOG
at
www.taylorpneumatic.com

0116TPTC /all rights reserved /COPYRIGHT 2016 / final

Ph. (561) 732-1111
Fax (561) 731-4412
Toll Free 800-805-8665

General instructions

Grinders T-7707, T-8707, T-9407, T-9409, T-9600, T-9600C, T-9707, T-9709



OILING INSTRUCTIONS:

OIL AFTER EACH USE WITH 2 OR 3 TABLESPOONS OF AIRTOOL OIL THROUGH THE AIR INLET. RUN FOR ONE SECOND TO COAT ALL INTERNAL PARTS.

TYPE 27 GRINDERS - GENERAL INSTRUCTIONS

1. ALWAYS DISCONNECT THE TOOL FROM AIR SOURCE WHEN CHANGING ACCESSORIES OR SERVICING THE TOOL.

2. USE SAFETY GLASSES, FULL FACE SHIELDS, HEARING PROTECTION AND GLOVES.

3. STAY IN CONTROL OF THE GRINDER - DO NOT OVER REACH.

4. ALWAYS REMOVE WRENCHES FROM THE TOOL AFTER SERVICING. WRENCHES LEFT ATTACHED MAY RESULT IN SERIOUS HARM TO THE OPERATOR.

5. VIBRATION MAY BE HARMFUL TO YOUR ARMS AND HANDS. WEAR PROTECTION.

6. INSPECT THE TOOL AND AIR SUPPLY ON A REGULAR BASIS.

7. DO NOT REMOVE GUARDS OR SAFETY DEVICES. DO NOT MODIFY OR DEFEAT SAFETY DEVICES.

8. DO NOT MAKE CONTACT WITH ELECTRICAL LINES.

9. LEAVE TRIGGER OFF BEFORE CONNECTING THE TOOL TO THE AIR SUPPLY. AVOID ACCIDENTAL STARTS.

10. WEAR THE PROPER CLOTHING. DO NOT WEAR JEWELRY, LOOSE CLOTHING, OR LONG HAIR AS IT CAN GET CAUGHT IN ROTATING PARTS. KEEP GLOVES AWAY FROM ROTATING PARTS.

11. DO NOT WORK IN HAZARDOUS ATMOSPHERES WHERE SPARKS COULD IGNITE OR DETONATE FUMES.

12. WATCH WHAT YOU ARE DOING. USE COMMON SENSE WHEN OPERATING PNEUMATIC TOOLS. DO NOT USE PNEUMATIC TOOLS WHEN TIRED OR UNDER THE INFLUENCE OF MEDICATION, ALCOHOL OR DRUGS. SERIOUS PERSONAL INJURY MAY RESULT FROM A MOMENTS INATTENTION.

13. USE 90 PSI AT THE TOOL. USE 3/8", 1/2" or 3/4" HOSE OR LARGER WITH FITTINGS 9/32 MINIMUM I.D. AS SPECIFIED

14. ONLY USE CLEAN DRY COMPRESSED AIR. NEVER USE OXYGEN, CARBON DIOXIDE, COMBUSTIBLE GASES OR ANY OTHER BOTTLED GAS TO POWER THIS TOOL.

15. SECURE YOUR WORK BEFORE STARTING - USE CLAMPS OR FIND A SUITABLE WAY TO MAINTAIN STABILITY.

16. STORE TOOLS IN A CLEAN DRY ENVIRONMENT.

17. DO NOT USE DAMAGED TOOLS - MARK, AND RETURN FOR SERVICE.

18. NEVER FORCE THE TOOL. LET THE TOOL DO THE WORK.

19. STOP USE IMMEDIATELY IF TOOL IS MAKING AN UNUSUAL NOISE OR VIBRATION. HAVE TOOL CHECKED BY PROFESSIONAL TECHNICIAN.

20. OPERATE AT RATED TOOL SPEED.

21. ALWAYS USE A GRINDING WHEEL WITH A MAXIMUM SPEED RATING EQUAL TO OR GREATER THAN THE LABELED SPEED OF THE TOOL.

22. USE ONLY REINFORCED TYPE 27 WHEELS, 7" OR 9" DEPENDING ON THE MODEL.

23. FOLLOW WHEEL MANUFACTURERS MOUNTING INSTRUCTIONS.

24. DO NOT OPERATE WITHOUT THE WHEEL GUARD IN PLACE.

25. WORK IN A WELL VENTILATED AREA AND USE APPROVED PERSONAL PROTECTIVE EQUIPMENT SUCH AS DUST MASKS, THAT ARE SPECIFICALLY DESIGNED TO FILTER OUT MICROSCOPIC PARTICLES. SOME DUST CREATED BY POWER SANDING, SAWING, GRINDING AND OTHER CONSTRUCTION ACTIVITIES CONTAIN CHEMICALS KNOWN TO CAUSE CANCER, BIRTH DEFECTS OR OTHER REPRODUCTIVE HARM. SOME EXAMPLES OF THESE CHEMICALS ARE: CRYSTALLINE SILICA FROM BRICKS, CEMENT AND OTHER MASONARY PRODUCTS, ARSENIC AND CHROMIUM FROM CHEMICALLY TREATED LUMBER AND LEAD FROM LEAD BASED PAINTS.

YOUR RISK FROM EXPOSURE VARIES, DEPENDING ON HOW OFTEN YOU DO THIS TYPE OF WORK. TO REDUCE YOUR EXPOSURE TO THESE CHEMICALS WEAR PROTECTIVE MASKS AND CLOTHING.

26. KEEP CHILDREN, PETS AND BYSTANDERS AWAY WHILE OPERATING A PNEUMATIC TOOL. DISTRACTIONS CAN CAUSE YOU TO LOSE CONTROL. PROTECT OTHERS IN THE WORK AREA FROM DEBRIS SUCH AS METAL FILINGS AND SPARKS. PROVIDE BARRIERS OR SHIELDS AS NEEDED.

27. LUBRICATION - THIS TOOL REQUIRES A HIGH SPEED GREASE TO LUBRICATE THE PINION GEARS. ADD GREASE THROUGH THE GREASE FITTINGS AS NEEDED, APPROXIMATELY EVERY 8 HOURS.

28. THESE WARNINGS AND INSTRUCTIONS CAN NOT COVER ALL POSSIBLE CONDITIONS OR SITUATIONS. THE OPERATOR MUST UNDERSTAND THAT COMMON SENSE AND CAUTIONS ARE FACTORS WHICH CAN NOT BE BUILT INTO THE PRODUCT BUT MUST BE SUPPLIED BY THE OPERATOR.

505 N. Railroad Ave. 33435

P.O. Box 1117 33425

Boynton Beach, Florida 33435

SEE OUR CATALOG

at

www.taylorpneumatic.com

PH. 561-732-1111

FAX 561-731-4412

Toll Free 800-805-8665