

# T- 9010

## 1/4" Hand Riveter

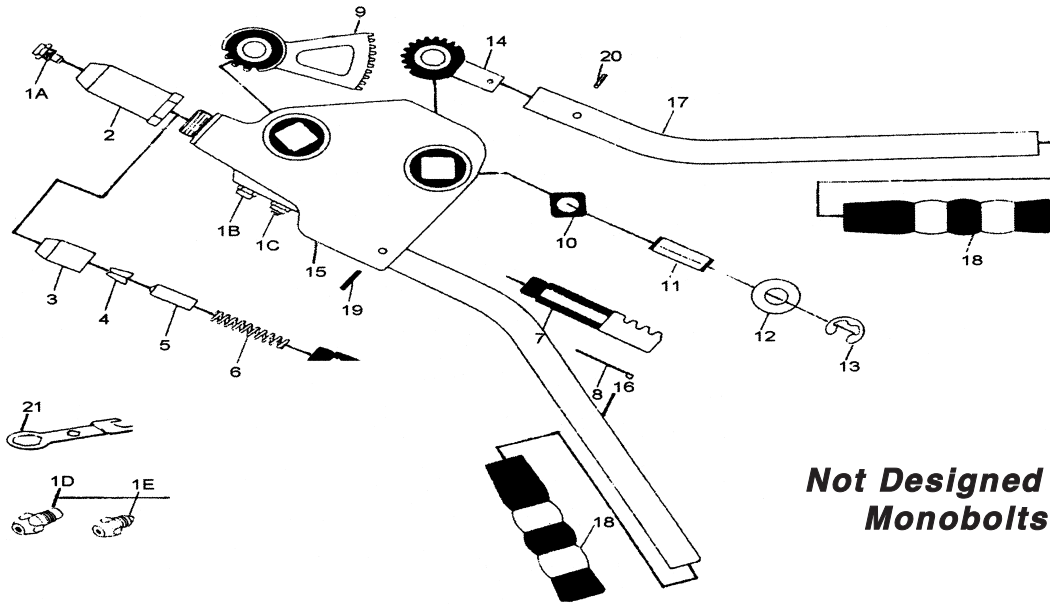

**Not Designed for  
Monobolts**

**USE 90 PSI MAXIMUM**

Ref #	Part #	Description	Qty.	Ref #	Part #	Description	Qty.
1A	901001A	1/4" Nose	1	10	901010	Bearing	4
1B	901001B	Klik-Split Nose	1	11	901011	Pin	2
1C	901001C	3/16" Nose	1	12	901012	Washer	4
1D	901001D	5/32" Nose	1	13	901013	E-Ring	4
1E	901001E	1/8" Nose	1	14	901014	Gear Rod	1
2	901002	Frame Head	1	15	901015	Housing	1
3	901003	Jaw Case	1	16	901016	Lower Handle	1
4	901004	Jaws (2 pcs.)	2	17	901017	Upper Handle	1
5	901005	Jaw Pusher	1	18	901018	Grip	2
6	901006	Spring	1	19	901019	Lower Pin	1
7	901007	Gear Rack	1	20	901020	Upper Pin	1
8	901008	Bearing Plate	1	21	901021	Wrench	1
9	901009	Gear	1				

505 N. Railroad Ave. 33435  
P.O. Box 1117 33425  
Boynton Beach, Florida

SEE OUR CATALOG  
at  
[www.taylorpneumatic.com](http://www.taylorpneumatic.com)

0116TPTC /all rights reserved /COPYRIGHT 2016 / final

Ph. (561) 732-1111  
Fax (561) 731-4412  
Toll Free 800-805-8665