

T-8859HRS Angle Sander

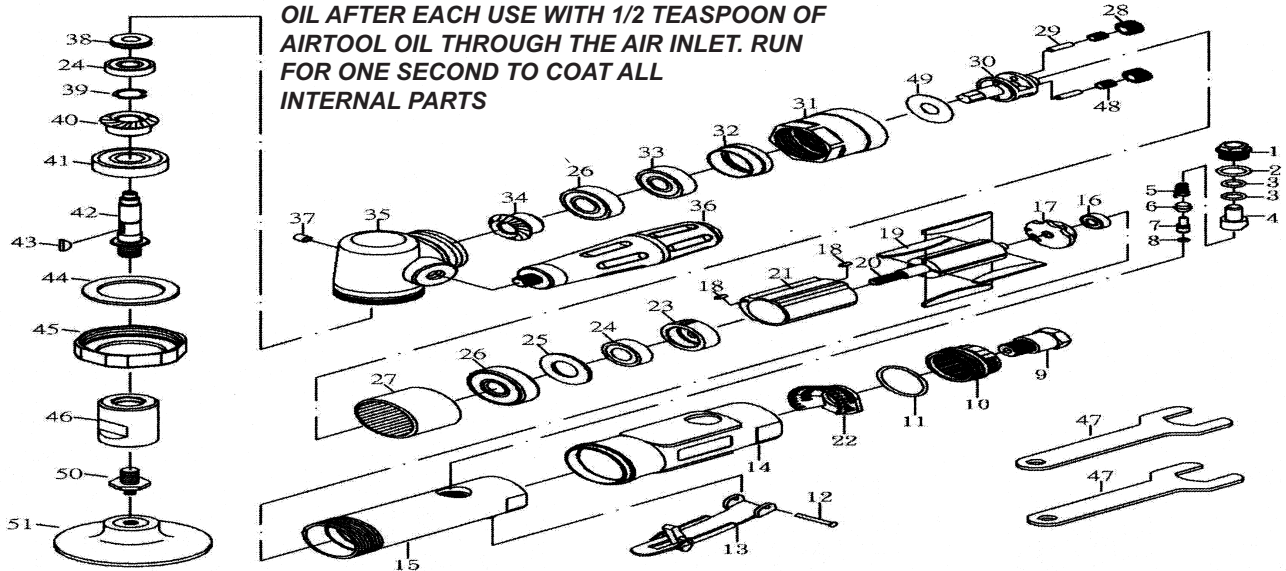

OILING INSTRUCTIONS:
OIL AFTER EACH USE WITH 1/2 TEASPOON OF AIRTOOL OIL THROUGH THE AIR INLET. RUN FOR ONE SECOND TO COAT ALL INTERNAL PARTS



USE 90 PSI MAXIMUM

Ref #	Part #	Description	Qty.	Ref #	Part #	Description	Qty.
1	8859R01	Screw	1	26	8859HRS26	Bearing	2
2	8859R02	O-Ring	1	27	8859HRS27	Ring Gear	1
3	8859R03	O-Ring	2	28	8859HRS28	Idler Gear	2
4	8859R04	Air Regulator	1	29	8859HRS29	Idler Gear Pin	2
5	8859R05	Spring	1	30	8859HRS30	Idler Gear Plate	1
6	8859R06	Valve Stem Bushing	1	31	8859HRS31	Clamp Nut	1
7	8859R07	Valve Stem	1	32	8859HRS32	Bearing Bushing	1
8	8859R08	O-Ring	1	33	8859HRS33	Bearing	1
9	8859R09	Air Inlet	1	34	8859HRS34	Bevel Gear	1
10	8859R10	Exhaust Sleeve	1	35	8859HRS35	Angle Housing	1
11	8859R11	O-Ring	1	36	8859HRS36	Handle	1
12	8859R12	Spring Pin	1	37	8859HRS37	Oil Cap	1
13	8859R13	Lever	1	38	8859HRS38	Bearing	1
14	8859R14	Protecting Rubber	1	39	8859HRS39	Snap Ring	1
15	8859R15	Housing	1	40	8859HRS40	Bevel Gear	1
16	8859R16	Bearing	1	41	8859HRS41	Bearing	1
17	8859R17	Rear Plate	1	42	8859HRS42	Shaft	1
18	8859R18	Pin	2	43	8859HRS43	Key	1
19	8859R19	Rotor Blade (set of 4)	1 set	44	8859HRS44	Washer	1
20	8859HRS20	Rotor	1	45	8859HRS45	Clamp Nut	1
21	8859R21	Cylinder	1	46	8859HRS46	Shaft	1
22	8859HRS22	Cone Muffler	1	47	8859HRS47	Wrench	2
23	8859HRS23	Front Plate	1	48	8859HRS48	Needle Bearing	2
24	8859R24	Bearing	2	49	8859HRS49	Washer	1
25	8859HRS25	Washer	1	50	8859HRS50	Adaptor	1
				51	T-8859HRS51	3" Pad	1

505 N. Railroad Ave. 33435
P.O. Box 1117 33425
Boynton Beach, Florida

SEE OUR CATALOG
at
www.taylorpneumatic.com

0116TPTC /all rights reserved /COPYRIGHT 2016 / final

Ph. (561) 732-1111
Fax (561) 731-4412
Toll Free 800-805-8665