

T-8825 1/4" Mini Ratchet

T-8826 3/8" Mini Ratchet

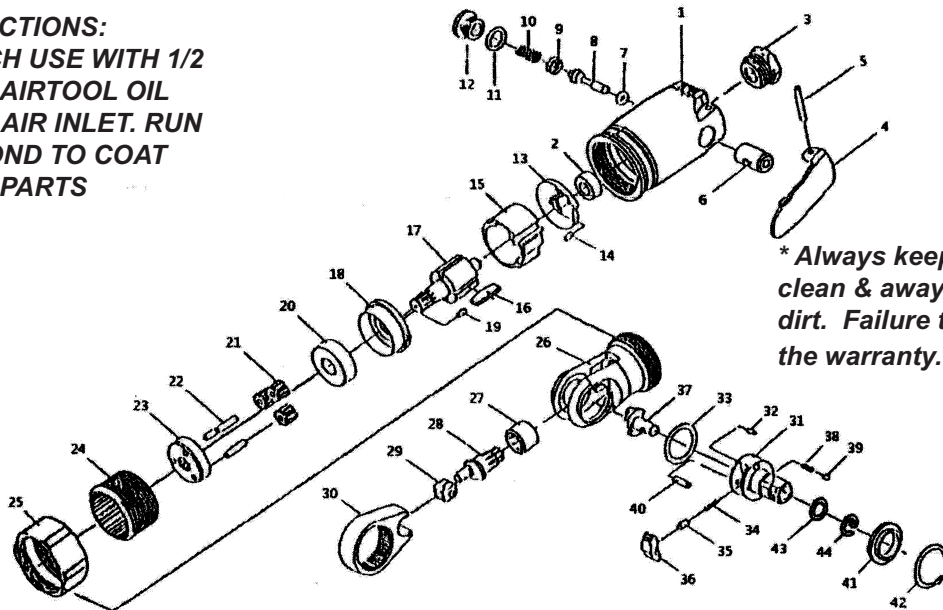

OILING INSTRUCTIONS:
OIL AFTER EACH USE WITH 1/2
TEASPOON OF AIRTOOL OIL
THROUGH THE AIR INLET. RUN
FOR ONE SECOND TO COAT
ALL INTERNAL PARTS



** Always keep ratchet head clean & away from sand and dirt. Failure to do so may void the warranty.*

USE 90 PSI MAXIMUM

Ref #	Part #	Description	Qty.	Ref #	Part #	Description	Qty.
1	882501	Housing	1	24	882524	Ring Gear	1
2	882502	Bearing	1	25	882525	Nut	1
3	882503	Air Inlet	1	26	882526	Ratchet Head	1
4	882504	Lever	1	27	882527	Bearing	2
5	882505	Lever Pin	1	28	882528	Crankshaft	1
6	882506	Bushing	1	29	882529	Bushing	1
7	882507	O-Ring	1	30	882530	Yoke	1
8	882508	Valve	1	31	882531	Anvil 1/4"	1
9	882509	Spring Seat	1		882631	Anvil 3/8"	1
10	882510	Spring	1	32	882532	Stop Pin	1
11	882511	Seal	1	33	882533	Wear Washer	1
12	882512	Throttle Plug	1	34	882534	Spring	1
13	882513	Rear End Plate	1	35	882535	Lock Pin	1
14	882514	Pin	1	36	882536	Pawl	1
15	882515	Cylinder	1	37	882537	Reverse Button	1
16	882516	Rotor Blades (4 per set)	1set	38	882538	Detent Spring	2
17	882517	Rotor	1	39	882539	Detent Ball	2
18	882518	Front End Plate	1	40	882540	Retaining Pin	1
19	882519	Pin	1	41	882541	Thrust Washer 1/4"	1
20	882520	Bearing	1		882641	Thrust Washer 3/8"	1
21	882521	Planet Gear	3	42	882542	Retaining Ring	1
22	882522	Pin	3	43	882543	O-Ring	1
23	882523	Gear Plate	1	44	882544	Socket Retainer	1

505 N. Railroad Ave. 33435
P.O. Box 1117 33425
Boynton Beach, Florida

SEE OUR CATALOG
at
www.taylorpneumatic.com

Ph. (561) 732-1111
Fax (561) 731-4412
Toll Free 800-805-8665