

T-8707 7" Angle Grinder



USE 90 PSI MAXIMUM

Ref #	Part #	Description	Qty.	Ref #	Part #	Description	Qty.
1	870701	Valve Body	1	51	870751	Rotor Blade (4 per set)	1 set
2	870702	Valve Handle	1	52	870752	Front End Plate	1
3	870703	Valve	1	53	870753	Cylinder Spacer Plate	1
4	870704	Valve Seat	1	54	870754	Spindle Cover	1
5	870705	Band	1	55	870755	Bevel Gear	1
6	870706	Handle Body Connector	1	56	870756	Bevel Gear	1
7	870707	Valve Body Nut	1	57	870757	Gear Cover	1
8	870708	Filter	1	58	870758	Handle	1
9	870709	Pin	1	59	870759	Bolt	1
10	870710	Roller Pin	1	60	870760	Nut	1
11	870711	Roll Pin	1	61	870761	Allen Head Plug	1
12	870712	Spring	1	62	870762	Spring Washer	1
13	870713	Spring	1	63	870763	Spring Washer	1
14	870714	O-Ring	1	64	870764	Snap Ring	1
15	870715	Handle	1	65	870765	Roll Pin	1
16	870716	Air Inlet	1	66	870766	Key	1
17	870717	Valve Bushing	1	67	870767	Key	1
18	870718	Valve Lever	1	68	870768	Spacer	1
19	870719	Valve Body Nut	1	69	870769	Spacer	1
20	870720	Safety Switch	1	70	870770	Adjusting Spacer	1
21	870721	Filter	1	71	870771	Adjusting Spacer	1
22	870722	Governor Valve Bushing	1	72	870772	Spacer	1
23	870723	Pin	1	73	870773	Helicoil Insert	1
24	870724	Roll Pin	1	74	870774	Outside Snap Ring	1
25	870725	O-Ring	1	75	870775	Bearing	1
26	870726	Spring	1	76	870776	Bearing	1
27	870727	Cone Spring	1	77	870777	Bearing	1
28	870728	Inner Snap Ring	1	78	870778	Bearing	1
29	870729	O-Ring	2	79	870779	Ring	1
30	870730	Governor Valve	1	80	870780	O-Ring	1
31	870731	Governor Spindle	1	88	870788	Spindle 5/8 -11th	1
32	870732	Governor Cage	1	89	870789	Wheel Holder Flange	1
33	870733	Governor Weight	2	90	870790	Guard	1
34	870734	Roll Pin	2	91	870791	Wheel Nut	1
35	870735	Adjusting Spacer	1	92	870792	Allen Head Screw	1
36	870736	Spring	1	93	870793	Roll Pin	1
37	870737	Pin	1	94	870794	Inner Snap Ring	1
38	870738	Exhaust Cover	1	95	870795	Wrench	1
41	870741	Allen Bolt	1	96	870796	Allen Wrench	1
42	870742	O-Ring	1	97	870797	Air Inlet	1
47	870747	Motor Housing	1	99	870799	Wrench	1
48	870748	Rear End Plate	1	100	8707100	Spanner Wrench	1
49	870749	Cylinder	1	101	8707101	Allen Wrench	1
50	870750	Rotor	1				

products, arsenic and chromium from chemically treated lumber and lead from lead based paints. Your risk from exposure varies, depending on how often you do this type of work. To reduce your exposure to these chemicals wear protective masks and clothing.

26. Keep children, pets and bystanders away while operating a pneumatic tool. Distractions can cause you to lose control. Protect others in the work area from debris such as metal filings and sparks. Provide barriers or shields as needed.

27. **Lubrication** - this tool requires a high speed grease to lubricate the

pinion gears. Add grease through the grease fittings as needed, approximately every 8 hours.

28. These warnings and instructions can not cover all possible conditions or situations. The operator must understand that common sense and cautions are factors which can not be built into the product but must be supplied by the operator.

505 N. Railroad Ave. 33435
P.O. Box 1117 33425
Boynton Beach, Florida

SEE OUR CATALOG
at
www.taylorpneumatic.com

0116TPTC /all rights reserved /COPYRIGHT 2016 / final

Ph. (561) 732-1111
Fax (561) 731-4412
Toll Free 800-805-8665

T-8707 7" Angle Grinder



Type 27 Grinders - General Instructions

1. Always disconnect the tool from air source when changing accessories of servicing the tool.
2. Use safety glasses, full face shields, hearing protection and gloves.
3. Stay in control of the grinder, do not over reach.
4. Always remove wrenches from the tool after servicing. Wrenches left attached may result in serious harm to the operator.
5. Vibration may be harmful to your arms and hands, wear protection.
6. Inspect the tool and air supply on a regular basis.
7. Do not remove guards or safety devices. Do not modify or defeat safety devices.
8. Do not make contact with electrical lines.
9. Leave trigger off before connecting the tool to the air supply, avoid accidental starts.
10. Wear the proper clothing. Do not wear jewelry, loose clothing, or long hair as it can get caught in rotating parts. Keep gloves away from rotating parts.
11. Do not work in hazardous atmospheres where sparks could ignite or detonate fumes.
12. Watch what you are doing, use common sense when operating pneumatic tools. Do not use pneumatic tools when tired or under the influence of medication, alcohol or drugs. Serious personal injury may result from a moments inattention.
13. Use 90 psi of clean air at the tool. Use 3/8" hose or larger with fittings 9/32 minimum i.d.
14. Only use clean dry compressed air, never use oxygen, carbon dioxide, combustible gases or any other bottled gas to power this tool.
15. Secure your work before starting, use clamps or find a suitable way to maintain stability.
16. Store tools in a clean dry environment.
17. Do not use damaged tools; mark, and return for service.
18. Never force the tool. Let the tool do the work.
19. Stop use immediately if tool is making an unusual noise or vibration. Have tool checked by professional technician.
20. Operate at rated tool speed.
21. Always use a grinding wheel with a maximum speed rating equal to or greater than the labeled speed of the tool.
22. Use only reinforced type 27 wheels 7" in diameter.
23. Follow wheel manufacturers mounting instructions.
24. Do not operate without the wheel guard in place.
25. Work in a well ventilated area and use approved personal protective equipment such as dust masks, that are specifically designed to filter out microscopic particles. Some dust created by power sanding, sawing, grinding and other construction activities contains chemicals known to cause cancer, birth defects or other reproductive harm. Some examples of these chemicals are: crystalline silica from bricks, cement and other masonry (continued on back)

OILING INSTRUCTIONS:
OIL AFTER EACH USE WITH 1 /2 TEASPOON OF AIRTOOL OIL THROUGH THE AIR INLET. RUN FOR ONE SECOND TO COAT ALL INTERNAL PARTS

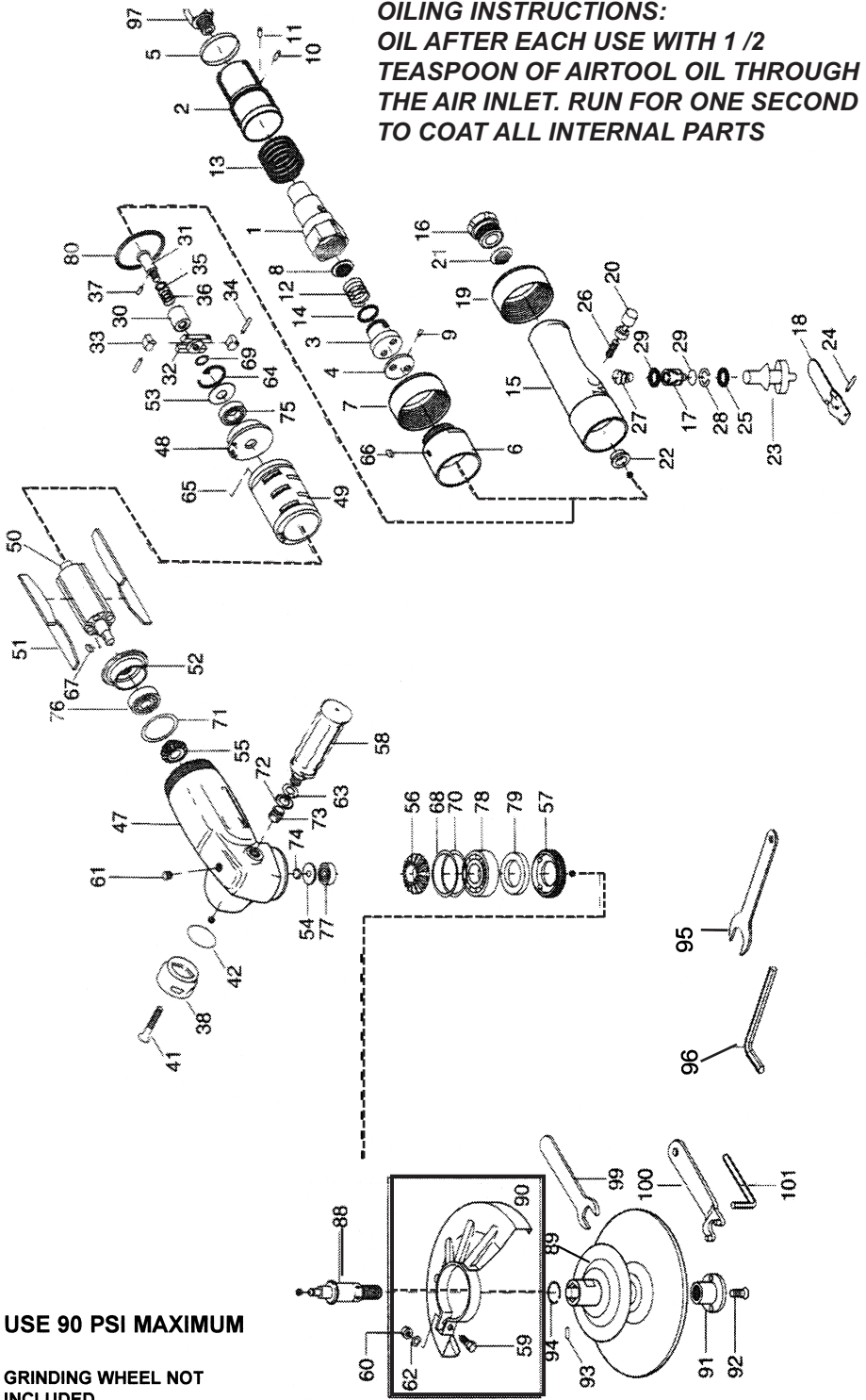

505 N. Railroad Ave. 33435
P.O. Box 1117 33425
Boynton Beach, Florida

SEE OUR CATALOG
at
www.taylorpneumatic.com

0116TPTC /all rights reserved /COPYRIGHT 2016 / final

Ph. (561) 732-1111
Fax (561) 731-4412
Toll Free 800-805-8665