

T-7763 1/4" Screwdriver

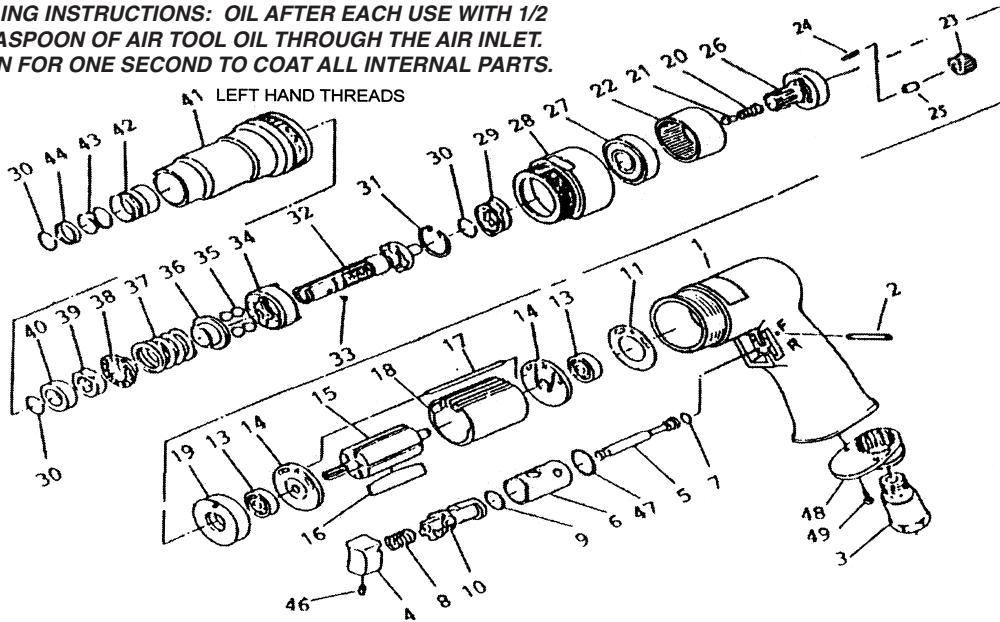

OILING INSTRUCTIONS: OIL AFTER EACH USE WITH 1/2 TEASPOON OF AIR TOOL OIL THROUGH THE AIR INLET. RUN FOR ONE SECOND TO COAT ALL INTERNAL PARTS.



TO ADJUST CLUTCH, first disconnect tool from air supply. **Caution-** do not allow #20 & #21 to fall out of drive spine or any dirt to enter assembly or housing.

Remove #41 (left hand thread). Remove #31 through #40 as a complete unit. Gently grasp drive dog ears on #34 in vice. Use 17mm open end wrench to adjust #39. Tightening will increase torque and loosening will decrease torque.

Re-install #41 using caution not to lose #20 and #21

- Optional 776337A 20-90 in.lbs. 
 - Standard 776337B 45-115 in.lbs.
 - Optional 776337C 45-145 in.lbs. 
- 

USE 90 PSI MAXIMUM

Ref #	Part #	Description	Qty.	Ref #	Part #	Description	Qty.
1	776301	Housing	1	25	776325	Spacer	3
1A	776301A	Complete Housing	1	26	776326	Work Spindle	1
2	776302	Pin	1	27	776327	Bearing	1
3	776303	Air Inlet	1	28	776328	Clamp Nut	1
4	776304	Trigger	1	29	776329	Drive Dog	1
5	776305	Valve Stem	1	30	776330	Retainer Ring	3
6	776306	Reverse Bushing	1	31	776331	Retaining Ring	1
7	776307	O-Ring	1	32	776332	Cam Spindle	1
8	776308	Valve Spring	1	33	776333	Ball	1
9	776309	O-Ring	1	34	776334	Clutch Carrier	1
10	776310	Reverse Lever	1	35	776335	Ball	4
11	776311	Motor Gasket	1	36	776336	Washer	1
13	776313	Bearing	2	37	776337B	Spring (standard)	1
14	776314	End Plate	2	38	776338	Washer	1
15	776315	Rotor	1	39	776339	Adjusting Nut	1
16	776316	Rotor Blades (5 per set)	1 set	40	776340	Spacer	1
17	776317	Pin	1	41	776341	Clutch Housing	1
18	776318	Cylinder	1	42	776342	Ball Retainer	1
19	776319	Spacer	1	43	776343	Spring	1
20	776320	Spring	1	44	776344	Washer	1
21	776321	Plunger	1	46	776346	Set Screw	1
22	776322	Internal Gear	1	47	776347	O-Ring	1
23	776323	Planet Gear	3	48	776348	Exhaust Diffuser	1
24	776324	Pin	3	49	776349	Screw	2

505 N. Railroad Ave. 33435
P.O. Box 1117 33425
Boynton Beach, Florida

SEE OUR CATALOG
at
www.taylorpneumatic.com

12/15TPTC /all rights reserved /COPYRIGHT 2015 / final

Ph. (561) 732-1111
Fax (561) 731-4412
Toll Free 800-805-8665