

# T-7701SS

## Straight Handle

## Scissor Shear

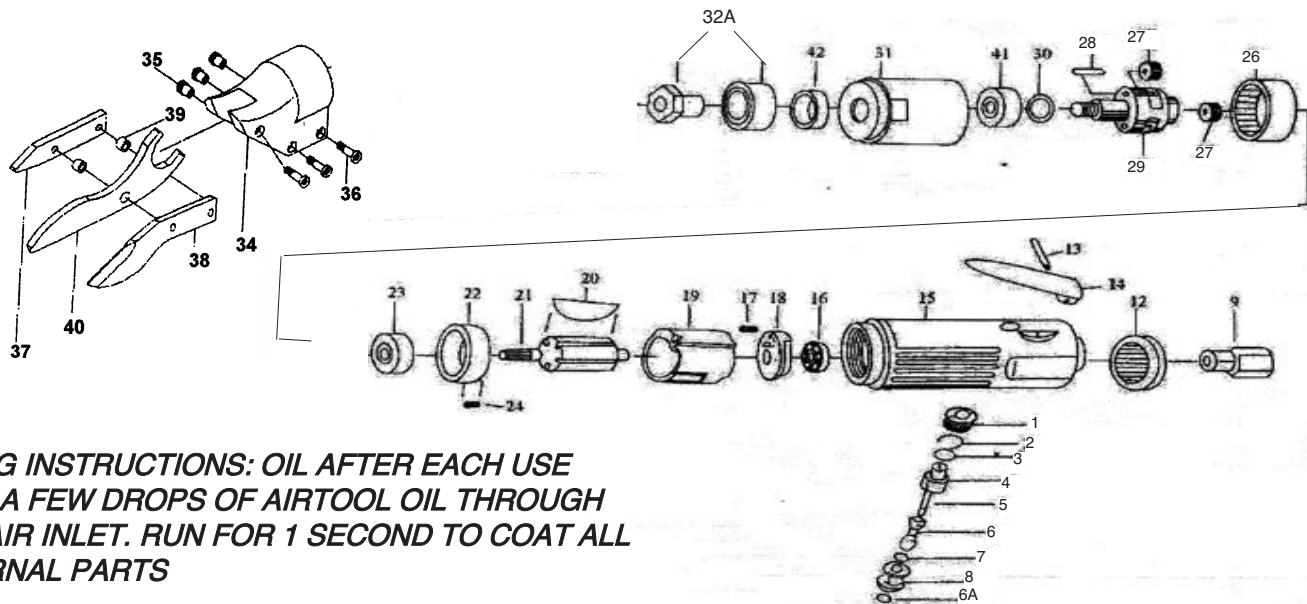

**OILING INSTRUCTIONS: OIL AFTER EACH USE WITH A FEW DROPS OF AIRTOOL OIL THROUGH THE AIR INLET. RUN FOR 1 SECOND TO COAT ALL INTERNAL PARTS**

### USE 90 PSI MAXIMUM

Ref #	Part #	Description	Qty.	Ref #	Part #	Description	Qty.
1	7701SS01	Valve Screw	1	23	7701SS23	Bearing	1
2	7701SS02	O-Ring	1	24	7701SS24	Spring Pin	2
3	7701SS03	O-Ring	1	25	7701SS25	Bearing	1
4	7701SS04	Air Controller	1	26	7701SS26	Internal Gear	1
5	7701SS05	Valve Spring	1	27	7701SS27	Planet Gear	1
6	7701SS06	Valve Stem	1	28	7701SS28	Planet Pin	3
6A	7701SS06A	O-Ring	1	29	7701SS29	Planet Carrier	3
7	7701SS07	O-Ring	1	30	7701SS30	Spacer	1
8	7701SS08	Valve Bushing	1	31	7701SS31	Bearing and Gear Cap	1
9	7701SS09	Inlet Bushing	1	32A	7701SS32A	Bearing & Nut Assembly	1
12	7701SS12	Exhaust Deflector	1	34	7701SS34	Shear-Housing	1
13	7701SS13	Spring Pin	1	35	7701SS35	Lock Nut	3
14	7701SS14	Throttle Lever	1	36	7701SS36	Lock Screw	3
15	7701SS15	Motor Housing	1	37	7700SS37	Right Blade	1
16	7701SS16	Bearing	1	38	7700SS38	Left Blade	1
17	7701SS17	Spring Pin	1	39	7700SS39	Spacer	2
18	7701SS18	Rear End Plate	1	40	7700SS40	Center Blade	1
19	7701SS19	Cylinder	1				
20	7701SS20	Rotor Blade (4 per set)	1set				
21	7701SS21	Rotor	1				
22	7701SS22	Front Plate	1				

505 N. Railroad Ave. 33435  
P.O. Box 1117 33425  
Boynton Beach, Florida

FOR WARRANTY INFORMATION &  
WARRANTY REGISTRATION VISIT  
[www.taylorpneumatic.com](http://www.taylorpneumatic.com)

Ph. (561) 732-1111  
Fax (561) 731-4412  
Toll Free 800-805-8665