

# T-7602

## Heavy Duty Needle Scaler

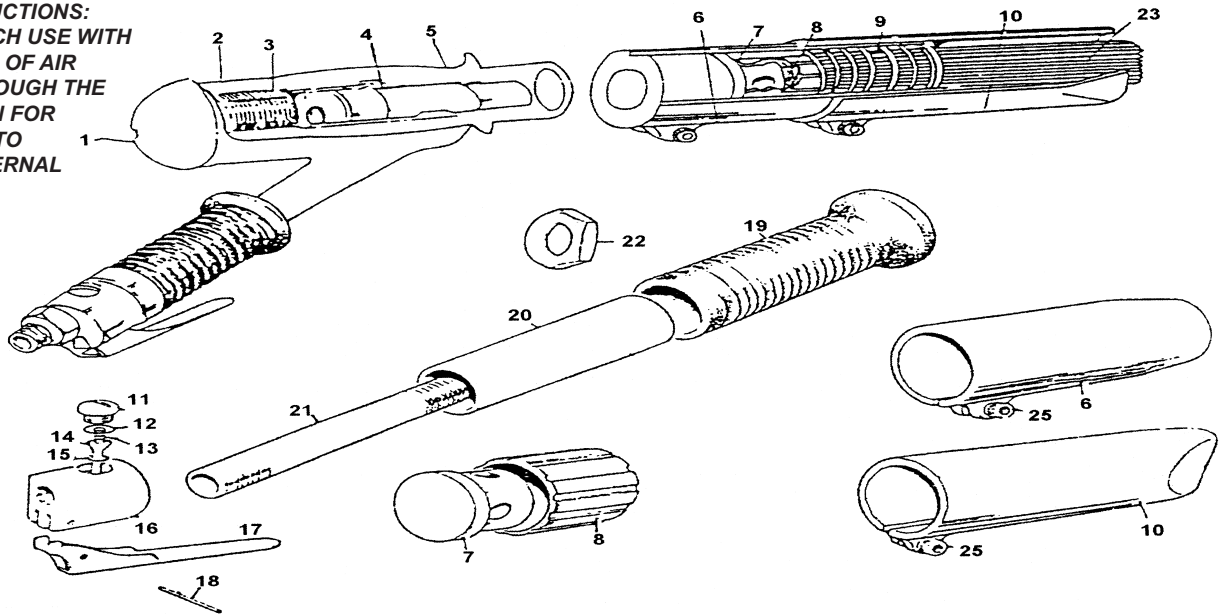

**OILING INSTRUCTIONS:**  
**OIL AFTER EACH USE WITH**  
**1/2 TEASPOON OF AIR**  
**TOOL OIL THROUGH THE**  
**AIR INLET. RUN FOR**  
**ONE SECOND TO**  
**COAT ALL INTERNAL**  
**PARTS.**



### USE 90 PSI MAXIMUM

| Ref # | Part # | Description         | Qty. | Ref # | Part # | Description              | Qty.  |
|-------|--------|---------------------|------|-------|--------|--------------------------|-------|
| 1     | 760201 | Body Cap            | 1    | 14    | 760214 | Valve Stem               | 1     |
| 2     | 760202 | Body                | 1    | 15    | 760215 | O-Ring                   | 1     |
| 3     | 760203 | O-Ring              | 1    | 16    | 760216 | Valve Body               | 1     |
| 4     | 760204 | Cylinder            | 1    | 17    | 760217 | Trigger                  | 1     |
| 5     | 760205 | Piston              | 1    | 18    | 760218 | Pin                      | 1     |
| 6     | 760206 | Needle Cover        | 1    | 19    | 760219 | Handle Grip              | 1     |
| 7     | 760207 | Driver              | 1    | 20    | 760220 | Handle Tube              | 1     |
| 8     | 760208 | Needle Holder (4mm) | 1    | 21    | 760221 | Center Tube              | 1     |
| 9     | 760209 | Spring              | 1    | 22    | 760222 | Nut                      | 1     |
| 10    | 760210 | Needle Cover        | 1    | 23    | 760223 | Needles 4mm (35 per set) | 1 set |
| 11    | 760211 | Valve Screw         | 1    | 25    | 760225 | Screw                    | 2     |
| 12    | 760212 | O-Ring              | 1    |       |        |                          |       |
| 13    | 760213 | Spring              | 1    |       |        |                          |       |

505 N. Railroad Ave. 33435  
P.O. Box 1117 33425  
Boynton Beach, Florida

SEE OUR CATALOG  
at  
[www.taylorpneumatic.com](http://www.taylorpneumatic.com)

12/15TPTC /all rights reserved /COPYRIGHT 2015 / final

Ph. (561) 732-1111  
Fax (561) 731-4412  
Toll Free 800-805-8665