

ANGELO S/C SEAT FOR W/H PAN INSTALLATION INSTRUCTIONS

To install this product correctly, please follow the instructions below ensuring you are prepared with the required tools.

Fitting

1. Use Fig. 1 below to insert Parts 2), 3), 4) and 5) into the ceramic holes in the order shown in Fig. 2.
2. Fix Base Seat with Screws provided, ensuring it remains adjustable.
3. Connect the seat/cover onto the Base Seat pins, adjusting the Base Seat as necessary.
4. Carefully close seat/cover and adjust its positioning to align with the pan.
5. Carefully lift the seat/cover together into the upright position. Compress the silver hinge release buttons, and lift the seat/cover off.
6. Tighten the Screws, taking care not to 'overtighten', and fit Hinge Covers.
7. Position seat on Base Seat pins once more (Fig. 3). When the 'click' sound is heard, the seat is securely fitted.

Cautions / Cleaning

- Do not allow the seat/seat cover to open more than 105° (before installation or after removing for cleaning purposes)
- Do not force the seat/seat cover closed as this will weaken the soft close mechanism
- To remove seat for cleaning, simply release the button and lift the seat off. To re-fit the seat, follow points 1-6 above.
- Use a soft cloth with soap and water to clean. Take care to dry the seat after cleaning.

Fig. 1 (Exploded view of components)

- 1) Hinge Cover
- 2) Screw
- 3) Base Seat
- 4) Washer
- 5) Top Fixing Nut

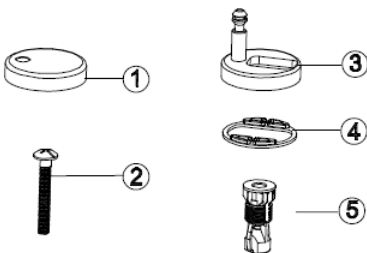

Fig. 2

