

W12-01591

11.5M SMETAL ASM - STD

Stock Number	Description	Quantity
PSV/27/941	MIDIBUS SHEETMETAL FINISHER	1.00
PSV/38/258	MIDI SHEETMETAL CAPPING FINISHER 3.22M	0.99
PSV/27/943	MIDIBUS SHEETMETAL FINISHER	1.00
AUE-00248	MIDI SHEETMETAL CAPPING FINISHER 3.22M	0.95
PSV/27/946	MIDIBUS SHEETMETAL FINISHER	1.00
PSV/38/257	MIDI SHEETMETAL CAPPING FINISHER 8.7M	0.76
PSV/27/947	MIDIBUS SHEETMETAL FINISHER	1.00
PSV/38/257	MIDI SHEETMETAL CAPPING FINISHER 8.7M	0.71
PSV/29/594	SPONGE RUBBER GROUNDING PLATE UPPER	1.00
PSV/37/888	ALUM SHT.2500x1250x2.5MM	0.93
PSV/29/595	SPONGE RUBBER GROUNDING PLATE LOWER	1.00
PSV/37/888	ALUM SHT.2500x1250x2.5MM	0.67
PSV/29/596	RUBBER GROUNDING PLATE LOWER	1.00
PSV/37/888	ALUM SHT.2500x1250x2.5MM	0.43
PSV/37/583	TAPE SPONG.RUB. 12x12mm x6.0M	45.00
PSV/37/583	EXTERIOR CAPPING MIDI BUS PANEL PART	2.00
PSV/56/066	LEVER LATCH - BLACK (FLUSH FITTING)	2.00
PSV/43/348	M8x20 TORX BUTTON SCREW PATCHED	66.00
PSV/11/383	BULBTITE RUBBER SEAL	0.70
PSV/56/582	RADIATOR BULB SEAL	1.30
PSV/56/587	WHEELARCH RUBBER SEAL	0.95
PSV/09/209	11.5M SMETAL - VENTA STD	1.00
PSV/36/777	S/METAL EMG DOOR FINISHER SLITE 1.5MM	1.00
> > PSV/36/779	S/METAL PANEL EMG DR STREETLITE 1.5MM	1.00
> > PSV/40/787	S'METAL BRKT EMG DOOR PANEL SUPPORT	1.00
> > PSV/43/702	5/32x1/2^ CSK.POP	5.00
> PSV/56/076	S/METAL PANEL ASSY SLITE 1.5MM DAIMLER	1.00
> > PSV/36/764	N/S SHEETMETAL EGG CRATE PANEL	1.00
> > PSV/36/884	S/METAL PANEL STREETLITE 1.5MM	1.00
> > PSV/13/916	ALUM ACCESSY BALLY RUBBER	1.07
> PSV/36/886	LW S/METAL PANEL ASSY STREETLITE 1.5MM	1.00
> > PSV/36/885	LW S/METAL PANEL STREETLITE 1.5MM	1.00
> > PSV/13/916	ALUM ACCESSY BALLY RUBBER	0.63
> PSV/36/888	S/METAL PANEL ASSY STREETLITE 1.5MM	2.00
> > PSV/36/887	S/METAL PANEL STREETLITE 1.5MM	1.00
> > PSV/13/916	ALUM ACCESSY BALLY RUBBER	1.37
> PSV/56/074	S/METAL PAN S/LITE STD FUEL ASM -LW DAIM	1.00
> > PSV/09/210	S/METAL PANEL S/LITE FUEL STD - LW DAIM	1.00
> > PSV/13/916	ALUM ACCESSY BALLY RUBBER	1.07
> > PSV/40/786	MIDIBUS SHEETMETAL ATTACHMENT BRACKET	2.00
> > PSV/11/093	FUEL FILLER FLAP - LARGE	2.00
- - - PSV/41/216	USE DEF-00051 LRGE.FLP.D	1.00
- - - PSV/41/217	EPOXY COATING FOR DEF000	1.00
> > PSV/51/209	FUEL PANEL DOOR STIFFENER	1.00
> PSV/36/910	SLITE DF W/ARCH SHTMETAL PANEL ASM 1.5MM	1.00

W12-01591

11.5M SMETAL ASM - STD

Stock Number	Description	Quantity
> PSV/36/911	S/METAL PANEL ASM SLITE 1.5MM DAIMLER	1.00
> PSV/36/912	SLITE DF W/ARCH S/METAL PANEL ASM 1.5MM	1.00
> PSV/36/914	SLITE DF W/ARCH S/METAL PANEL ASM 1.5MM	1.00
> PSV/36/915	SLITE SIDE SHEETMETAL RAD PANEL	1.00
> PSV/36/918	LW S/METAL PANEL ASSY STREETLITE 1.5MM	1.00
> > PSV/36/917	LW S/METAL PANEL STREETLITE 1.5MM	1.00
> > PSV/13/916	ALUM ACCESSY BALLY RUBBER	1.37
> PSV/36/920	LW S/METAL PANEL ASSY STREETLITE 1.5MM	1.00
> > PSV/36/919	LW S/METAL PANEL STREETLITE 1.5MM	1.00
> > PSV/13/916	ALUM ACCESSY BALLY RUBBER	1.37
> PSV/36/922	LW S/METAL PANEL ASSY STREETLITE 1.5MM	1.00
> > PSV/36/921	LW S/METAL PANEL STREETLITE 1.5MM	1.00
> > PSV/13/916	ALUM ACCESSY BALLY RUBBER	1.37
PSV/36/924	LW S/METAL PANEL ASSY STREETLITE 1.5MM	1.00
> > PSV/36/923	LW S/METAL PANEL STREETLITE 1.5MM	1.00
> > PSV/13/916	ALUM ACCESSY BALLY RUBBER	1.11
> PSV/09/211	SLITE S/METAL PANEL ASSY	1.00
> > PSV/09/211	MIDI CURVED SHEETMETAL FINISHER	1.00
> > PSV/09/212	SIDE SHEETMETAL PANEL - SLITE 1.5MM	1.00
> > PSV/13/916	ALUM ACCESSY BALLY RUBBER	1.41
> > PSV/14/985	MIDIBUS WHEELARCH STIFFENER	1.00
> PSV/11/260	PROTEX EXTENDED STRIKER	1.00
> PSV/56/086	HINGE PANEL STRIKER PLATE	1.00
> PSV/56/034	S'LITE DF DAIMLER BATT DOOR ASM - 1.5MM	1.00
> > PSV/09/213	S/METAL PANEL STREETLITE 1.5MM	1.00
> > PSV/09/214	S/METAL PANEL STREETLITE 1.5MM	1.00
> > PSV/10/937	ALUM ACCESSORY TOGGLE M8	8.00
> > PSV/13/916	ALUM ACCESSY BALLY RUBBER	1.31
> > PSV/09/215	SLITE BATTERY DOOR BONDING SUPPORT	1.00
> > PSV/09/216	DF DAIMLER BATTERY PANEL STRUT BRKT	1.00
--- PSV/09/217	MAXI BATTERY PANEL STRUT BRACKET	2.00
--- PSV/09/218	MIDI BATTERY DOOR STAY ATTACHMENT	1.00
--- PSV/09/219	MIDI BATTERY DOOR STAY ATTACHMENT	1.00
--- PSV/09/220	DF DAIMLER BATTERY PANEL STRUT BRKT	1.00
> > PSV/60/186	DOOR STRUT BRACKET	1.00
> > PSV/11/093	FUEL FILLER FLAP - LARGE	1.00
--- PSV/41/216	USE DEF-00051 LRGE.FLP.D	1.00
--- PSV/41/217	EPOXY COATING FOR DEF000	1.00
> > PSV/10/899	STAY - TELESCOPIC HEAVY DUTY	1.00
> > PSV/64/985	M6x25 CAD.ENG.BOLT	1.00
> > PSV/62/953	M6x30 CAD.ENG.BOLT	1.00
> > PSV/21/122	M8X15 TORX BUTTON SCREW PATCHED	8.00
> > PSV/63/032	M6 SELF FINISH HEX NUT	2.00
> > PSV/60/161	M6 SELF FINISH NYLOC NUT	2.00
> > PSV/67/844	1/8x3/8^ CSK.POP	10.00

W12-01591

11.5M SMETAL ASM - STD

Stock Number	Description	Quantity
> > PSV/43/704	1/4in.FLAT STEEL WASHER	7.00
> > PSV/43/704	HINGE BAR SECTION - BATTERY DOOR	1.00
> > PSV/70/273	HINGE BAR SECTION - BATTERY DOOR	1.00
> PSV/11/122	MIDIBUS SHEETMETAL ATTACHMENT BRACKET	2.00
> PSV/11/123	MIDIBUS WHEELARCH S/METAL BRACKET ASSY	4.00
> > PSV/43/675	M8 X 20 CLOSED END NUTSERT	2.00
> > PSV/40/789	MIDIBUS WHEELARACH SHEETMETAL BRACKET	1.00
> PSV/56/083	MIDIBUS WHEELARCH S/METAL BRACKET ASSY	4.00
> > PSV/40/790	MIDIBUS WHEELARACH SHEETMETAL BRACKET	1.00
> > PSV/43/675	M8 X 20 CLOSED END NUTSERT	2.00
> PSV/43/675	MIDIBUS WHEELARACH SHEETMETAL BRKT ASSY	4.00
> PSV/11/124	MIDIBUS RADIATOR S'METAL BRACKET ASSY	2.00
> PSV/11/124	S'LITE ALUM PANEL ATTACHMENT BRACKET	15.00
> PSV/12/998	SLITE SHEETMETAL ATTACHEMENT 1/2 BRACKET	10.00
> PSV/56/080	SLITE SHEETMETAL BRKT ASSY	1.00
> > PSV/40/797	SLITE SHEETMETAL BRACKET	1.00
> > PSV/43/675	M8 X 20 CLOSED END NUTSERT	2.00
> PSV/43/675	SLITE SMETAL ATTACHMENT BRKT	2.00
> > PSV/40/798	SLITE SHEETMETAL BRACKET	1.00
> > PSV/43/675	M8 X 20 CLOSED END NUTSERT	1.00

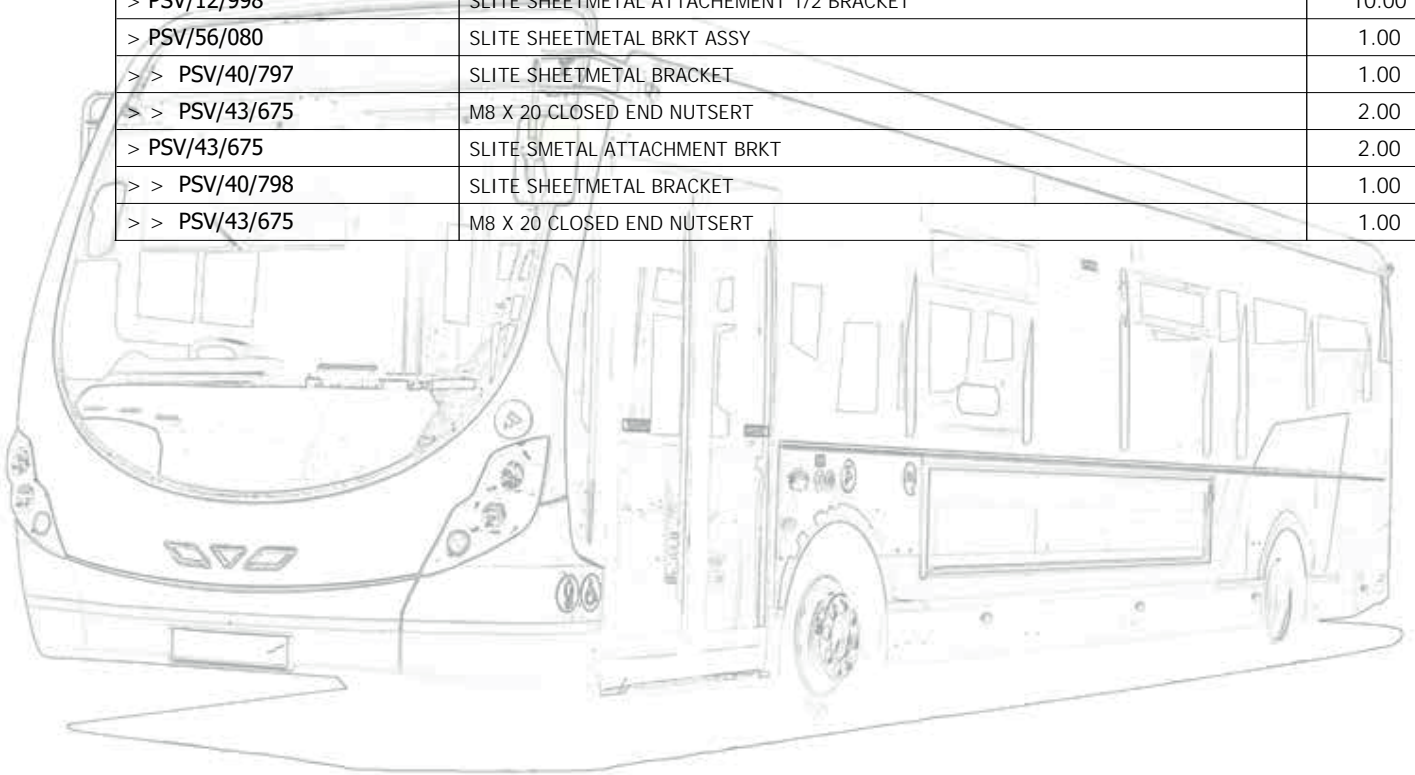

W12-01591
SHEETMETAL - BODY PANELS - BASIC ASSEMBLY



PSV/37/583 TAPE SPONG.RUB. 12x12mm x6.0M

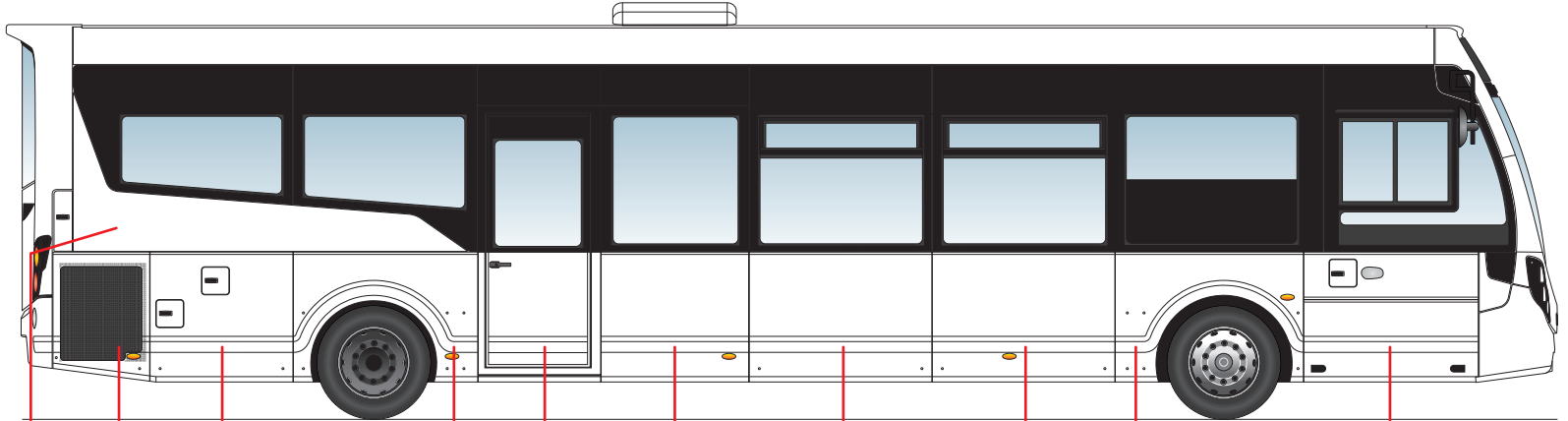

PSV/14/887 PSV/56/074 PSV/56/074 PSV/36/914 PSV/36/777 PSV/36/923 PSV/36/888 PSV/36/922 PSV/36/912 PSV/56/034

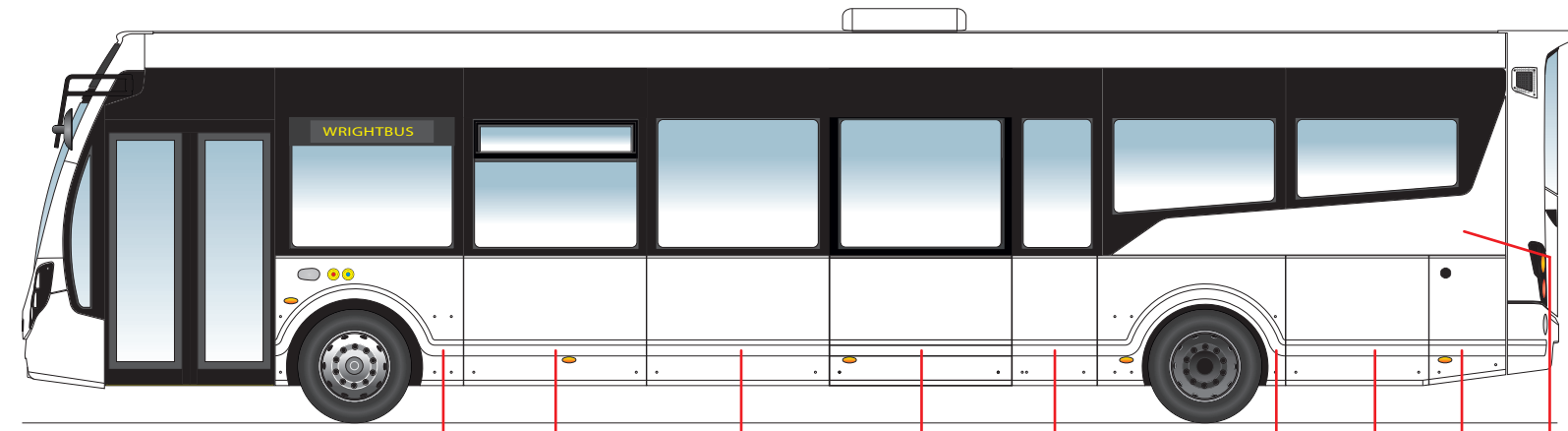
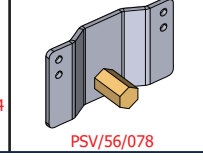
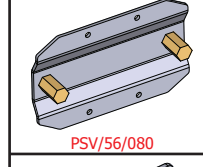
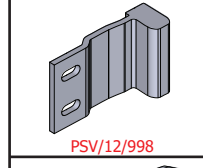
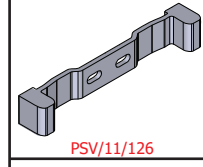
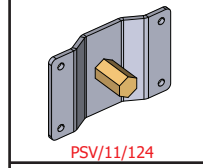
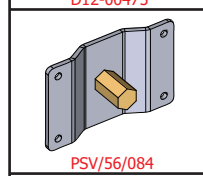
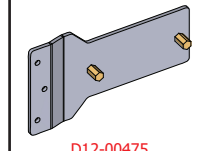

PSV/09/211 PSV/36/918 PSV/36/888 PSV/36/920 PSV/36/886 PSV/36/910 PSV/56/076 PSV/36/91 PSV/39/004

