

# xitrix

## USB 1080P HD WEBCAM WITH MICROPHONE

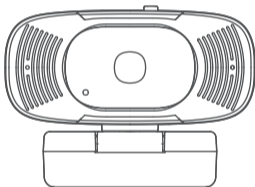

XPN-MT36

---

User Manual

## 1. Appearance Display

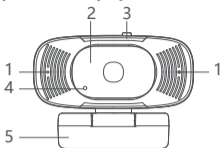

1. Dual Microphones
2. Lens
3. Privacy lens slider button
4. Indicator Light
5. Adjustable Mount
6. USB Cable

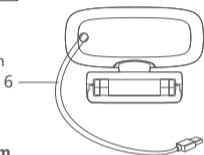

## 2. Setting up your webcam

### (1) Place your webcam

Designed for the way you like to make a video call, Live, conference, etc. Place the Webcam XPN-MT36 where you want it-on a computer monitor, desktop, or tripod. (Tripod is not including in the package)

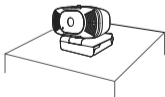

## For placement on a monitor

Grasp the webcam as shown and open the flexible clip base with your other hand. Mount the webcam, making sure the foot on the flexible clip base is flush with the back of your monitor.

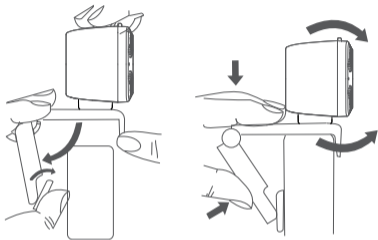

## (2) Connect your webcam

Connect the computer to XPN-MT36 with a USB cable, plug and play.



### 3. Product Specification

<b>Specification Model</b>	<b>XPN-MT36 (1080P)</b>
<b>Camera Parameters</b>	
Imaging Sensor	1/2.7 inch CMOS Sensor
Total Pixels	2 million
Output Image Format	MJPEG and YUY2
Field of view	96°
AIC	Automatic Exposure (AE) Auto White Balance (AWB) Dynamic Black Level Calibration (ABLC)
Resolution	1920*1080@30fps 1280*720@30fps 640*480@30fps
<b>Microphone Parameters</b>	
MIC Quantity	2
Pickup Voice Distance	3 meters
SNR	≥60dB
AIC	Automatic gain control Automatic noise reduction control Automatic echo noise reduction control
<b>Other Parameters</b>	
Interface type	USB2.0
Voltage	5V/500mA

System Requirements	Win2000/XP/Vista/Win7/Win8/Win10 Linux with UVC (above linux-2.6.26) MAC - OS X 10.4.8 or later Win CE with UVC Android 4.0 or above with UVC
Size	72 x 57 x 51mm
Weight	107g

#### 4. Some Suggestions

- (1) Do not sit right in front of a window or other bright light source.
- (2) Having an uncluttered background will have your viewers concentrating on you.
- (3) Visit your preferred video calling provider's website for exact information on system and performance requirements.

#### 5. FAQ Processed

##### ● No image displayed

- 1) Check if the USB port and USB cable of the terminal device are connected correctly.
- 2) Check if the USB cable is stable.
- 3) Check if the USB port can work normally.

##### ● The image breaks frequently

- 1) Check if the USB cable is stable.
- 2) Check if the USB port and USB cable of the terminal device are connected correctly.

##### ● The definition is not good after accessing software

Check the software video input settings to see if the camera video input is set correctly.

## 6. Warranty and Service Information

One-Year Limited Warranty applies to all xitris products. xitris warrants this product for a period of one year from the date of purchase.

The following information must be presented to obtain Warranty Service: (1) the product and its original packaging or packaging affording an equal degree of protection, (2) proof of purchase, clearly indicates the date of purchase and the product type, (3) return reason.

### **This Warranty does not cover defects or damages that result from:**

- (a) Improper use, accident or negligence, such as contact with liquid; physical damage (cracks, scratches, etc.) on the product surface.
- (b) Use non-xitris brand or uncertified products, accessories or other peripheral equipment.
- (c) Improper operation by anyone other than xitris, attempted repair or installation.
- (d) The product has not been charged in six months.

