



# USER MANUAL

M11 Mirror Dash Cam



# CONTENTS

<b>SAFETY CAUTION</b>	<b>01</b>
<b>WARM SUPPORT</b>	<b>02</b>
<b>PACKING LIST</b>	<b>03</b>
<b>PRODUCT OVERVIEW</b>	<b>04</b>
<b>INSTALLATION</b>	<b>05</b>
<b>ABOUT YUTUCAM APP</b>	<b>12</b>
Main menu	13
Albums	14
<b>FORMATTING THE MICROSD CARD</b>	<b>15</b>
<b>GETTING START</b>	<b>16</b>
Adjust the View Angle	18
Audio	19
Play Recorded Video	20
Lock the Current Video	21
Setup	22
<b>PLAY VIDEOS ON COMOUTER</b>	<b>25</b>
<b>SPECIFICATIONS</b>	<b>26</b>
<b>TROUBLESHOOTING GUIDE</b>	<b>27</b>

# SAFETY CAUTION

Incorrect operation of product(s) may lead to safety risks. Therefore, we STRONGLY recommend you read the instructions carefully before the first use.

Do not let the device come into contact with liquids!

Moisture damage will avoid the warranty for the device. In case any liquid has penetrated the device, disconnect the charging cable and turn off the device immediately.

Do not attempt to open the housing of the device. If opened, the warranty becomes void.

Clean the device with a soft clean cloth to avoid scratching the lens or screen of the device.

Please safekeeping, prevent the lens from scratching and dirty.

# WARM SUPPORT

Dear Friends,

Congratulations on purchasing one of the best dash cam on the market! We appreciate your business and want to earn your trust. Please refer to the notes below and follow the instructions in this manual to ensure that you use the dash camera correctly and have a good experience with this product.

If your dash camera does not seem to be functioning properly, please check the Troubleshooting/FAQ section. You also can contact our support team:

**support@euki.cn** . We will provide a fast solution in 24 hours.

Problems are often due to something simple that was overlooked, or require only changing one setting to solve. Thank you again for ordering from EUKI . We truly appreciate your business. We LOVE our customers and we will always be here with our professional camera engineers. Wishing you the best,  
EUKI Customer Support Team



**SCAN ME**

02 · **support@euki.cn**

# PACKING LIST

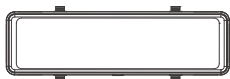

- Mirror Dash CAM

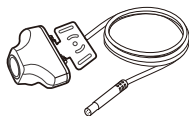

- Rear Camera

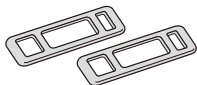

- Strap x2

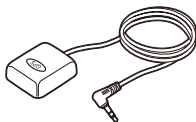

- GPS

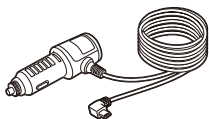

- Car Charger Adapter



- Rear Camera Extension Cable



- Screw x2



- Adhesive



- User Manual

03 · [support@euki.cn](mailto:support@euki.cn)

# PRODUCT OVERVIEW

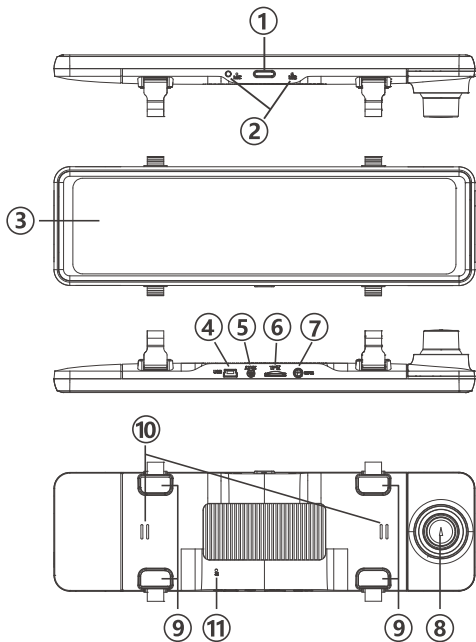

- 1** Power Button/Screen
- 2** Mic
- 3** Touch Screen
- 4** Power Input
- 5** Rear Camera

- 6** SD Card Slot
- 7** GPS Slot
- 8** Camera Lens
- 9** Back Clasp
- 10** Speaker
- 11** Rest Slot

# INSTALLATION

## Installation of front camera

① Insert the micro SD card into the dedicated slot.

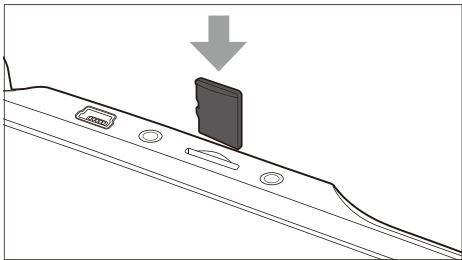

- Micro SD Card U3 or above is Highly Recommended for M10 mirror dash cam.
- Please format the SD card in the camera before using this mirror dash cam.

② Attach the mirror dash cam on the rear view mirror.

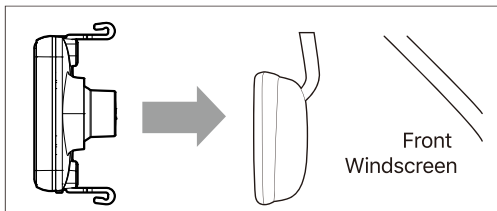



③ Fix with straps behind the front camera.

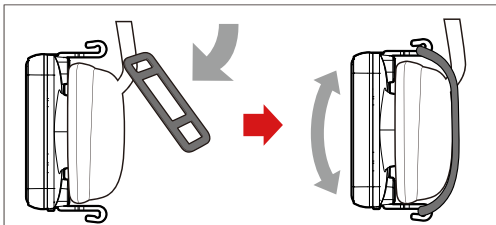

- Be careful not to block the field of view of the front camera lens.
- Make sure that the strap can hold the camera and rear view mirror firmly.

④ Connect the car charger to the car cigarette lighter port, then connect the USB connector to the USB power input of the mirror dash cam.

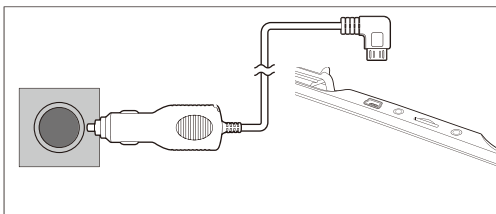

⑤ Adjusting the view angle of the front camera.

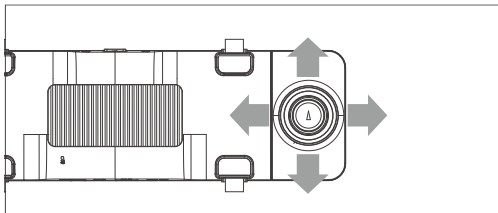

- The front camera lens can be rotated up and down, left and right, please manually adjust to a suitable position.
- Please peel off the protective films on the camera lens to obtain the best view.

⑥ Connect the rear camera and the extension cable to the dash cam to check whether the rear camera works well.

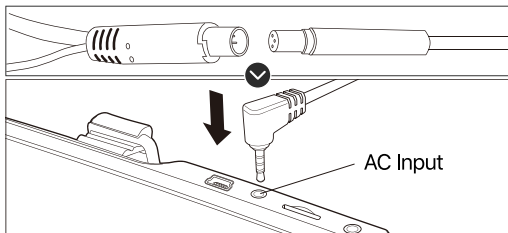

⑦ Connect the GPS module to the dash cam, and attach it on the A-Pillar.

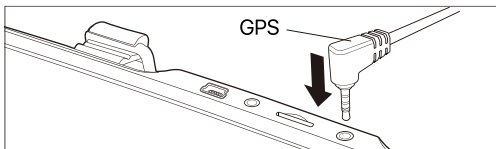

⑧ To hide the cables, please refer to the following instructions.

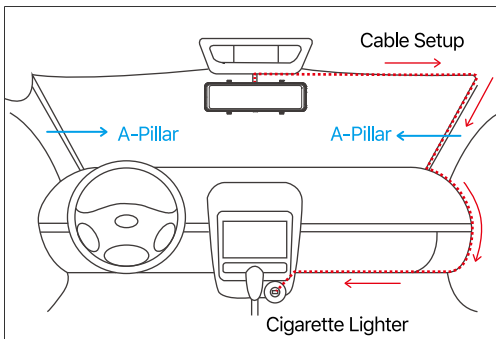

## Installation of rear camera

### Position 1:

Install the rear camera on the rear windshield. Position 1 is designed for live stream rear review only, not for reversing guide. This kind of installation is easier.



### Position 2:

Install the rear camera nearby the license plate. The rear image position 2 is sharp for live stream rear view and reversing guide. This kind of installation is highly recommended.



※ For the reversing guide feature, install the rear camera in position 2, then connect the red trigger cable of rear camera extension cable to the positive lead of the car reversing lamp.

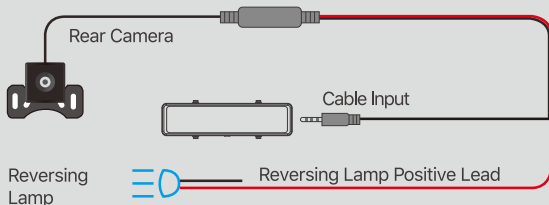

### Tips:

- Please clean the position to ensure the adhesive quality before install the rear camera.
- Please clean the rear windshield regularly to ensure the video quality if choose the position 1.
- If choose the position 2, you can install the rear camera with the included adhesive sticker or screws.

### Notes:

- The device is fastened with a very strong acrylic foam tape, which resists changing conditions and UV radiation. It is not recommended to remove it and to re-fasten it. However, if it is necessary to remove the camera holder and to re-fasten it, a new tape strip should be used.

- The easiest way to remove the camera holder is to remove first the camera and thereat to grasp firmly from the edges from the edges of the holder, as close as possible to the windshield.by turning the holder clockwise or anti-clockwise, the tape should release.As the tape is characterized by strong tensile strength, it is difficult to remove it by pulling. Do not use a screwdriver or any other tool for removing ,as this may damage the holder or windshield.
- In some car models power supply to the charging socket is not interrupted when the engine is switched off. In this case disconnect the charger from the charging socket, to avoid draining the car's battery.
- After installation,start the car and it will work and begin to record the video, please adjust the camera angle to make it in the middle of the road.

# ABOUT YUTUCAM APP



iOS



Android

- ① Plug the camera into a power source to turn ON
- ② Download the **YUTUCAM** app
- ③ Locate SSID: **XTUCam-XXXXXX** in your Wifi settings.
- ④ Enter the password: **12345678** Default
- ⑤ Open the YUTUCAM app, and add the camera by WIFI connect .



## **WARNING**

Do not attempt to operate when vehicle is in motion. Only operate when your vehicle is parked.

## Main menu

When connected, the Main Menu is where you can find everything from changing the settings, viewing recorded content, snapshots

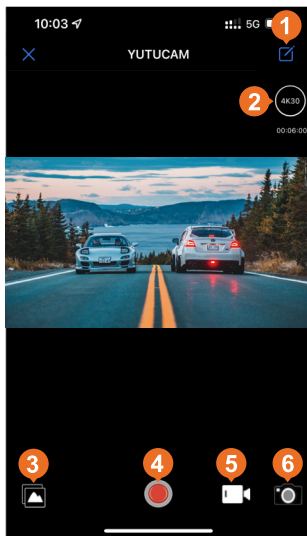

- |                        |                   |
|------------------------|-------------------|
| ① Settings             | ④ Video Recording |
| ② Set Video Resolution | ⑤ Video molde     |
| ③ Albums               | ⑥ Photo mode      |



# Albums

The Albums is where you can find all contents that the camera has recorded. View,edit,download and share your files in this menu.

**! Note:** you can only share contents that you have downloaded.

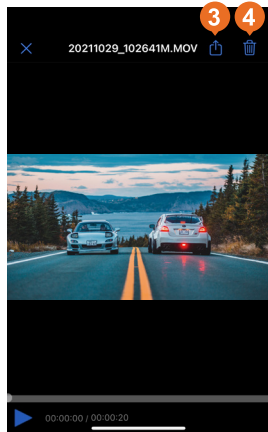
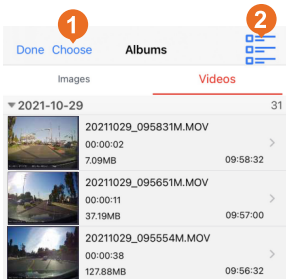

- 1 View method
- 2 Multi-Select

- 3 Download Video
- 4 Delete Video

# FORMATTING THE MICRO SD CARD

To ensure the compatibility with the camera, the SD card needs to get formatted on the camera. This dash cam supports SD card, up to 256GB with class 10 & above.

- ① After inserting the SD card into the camera and turning on the camera, touch the screen, then tap  to stop recording.



- ② Tap  to enter setting interface, select "**Format**", tap "**Confirm**" to format the SD card.

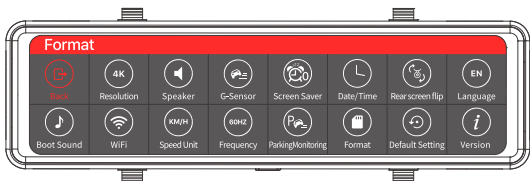

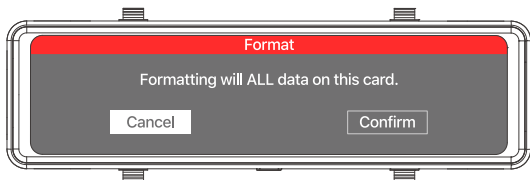

- All data will be deleted after a successful format, please remember to backup your important data on your other devices in advance.
- Every time you insert a SD card, please format it in the camera to ensure that the SD card is compatible with the camera.

## GETTING START

The camera starts recording immediately after powering on, tap  to stop recording.



 **4K** display the current recording.

**00:00:00** display the recording time.

**P** This icon appears when Parking Guard function turn on.

**G** This icon appears when G-Sensor function turn on.

 This icon appears when rear camera is connected to the monitor.

 tap to turn on / off recording sound.

 tap to take photo

 tap to start / stop recording.

 tap to display settings.

 tap to play the recorded videos on the screen.

 tap to lock the current video.

- To interrupt recording, briefly tap  . Then the red blinking round light indicating recording disappears from the screen.
- When start recording but the time still display "0:00:00", that means the SD card is full. If turning on "**Loop Record**", you don't need to change or format the card, it still records and the newest file will overwrite the oldest file automatically.

## 1. Adjust the View Angle

Slide up or down on the left side of screen to adjust the view angle.



## Screen Brightness

Slide up or down on the right screen to adjust the screen brightness.



When sliding the right side of screen, The icon  will appear, and you can adjust the brightness.

**Sliding up:** the brightness lightens;

**Sliding down:** the brightness

## 2. Audio

The Dash Cam allows the recorded videos with sound or no sound. Tap  to turn on/off the record audio.



### 3. Play Recorded Video

Tap  to play the recorded videos/locked videos/photos on the screen.



Tap the icon " ▼ " to choose the videos

## 4. Lock the Current Video

If you would like to save the recording(to lock it). Tap  on the screen to lock the current video. Otherwise the recordings will be deleted in chronological order according to how the memory of the card is filled up. The locked video will be saved in urgent video list.



- The video will last about 20s.



## 5. Setup

① Tap  to enter settings.



② Then you will see the interface below.

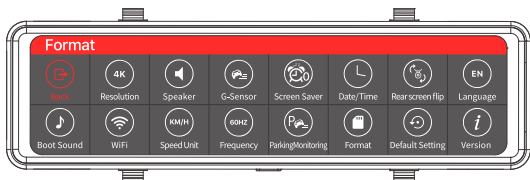

### Back

Back to the video interface.



### Resolution

Tap to shift the resolution to 4K/2K/FHD.



### Speaker

- Adjust the volume in the playback video.
- Mute low, Middle and High can be selected.



### **G-Sensor**

Back to the video interface.

- Built-in G-Sensor will detects collision and lock the footage which will never be covered by new files.
- Tap to set G-sensor sensitivity from off / Low / Middle / High.

※ The video will be stored as a file based on the time you set in the loop recording. When driving, if the road is bumpy, please adjust it to low or turn off it directly to prevent the camera doesn't work because of the memory card is full. When parking, recommend you to adjust it to medium.



### **Screen Saver**

Tap to turn off or set 1min/3min/5min



### **Date / Time**

Time setup is to set the time that display on the status bar of the screen.



### **Stream Media**

When starts recording, the camera will be comprehensive monitoring both the front and the rear traffic conditions in the real time, without delay. Tap to turn ON/OFF the stream media.

EN

## Language

English / Chinese / Japanese are available.



## Boot Sound

Tap to turn ON / OFF the Boot sound.



## WiFi

Tap to turn On/Off the WiFi.

KM/H

## Speed Unit

Tap to shift the unit to KM/H or MPH.

50HZ

## Frequency

50Hz and 60Hz can be selected. In the Americas and parts of Asia it is typically 60Hz. Other parts of the world this is usually 50Hz.



## Parking Guard

Tap to select from ON and Time-Lapse.

**ON:** The camera will be turned on automatically and start recording 20s urgent video, if there is a hit of the car during parking. The video will be saved in the list of urgent video.

**Time Lapse:** Also called fast forward mode video. For example, if the normal recording time is 1 minute, the fast forward mode video will only play for 1 second . (To use the fast forward mode, please connect the dash cam to your car's fuse box with hardwire kit.)



### **Format**

Format the micro SD card.



### **Default Setting**

Restore factory default settings.



### **Version**

Check the cameras version information.

## **PLAY VIDEOS ON COMOUTER**

The recordings can also be viewed in the computer. For this you need a separate memory card reader for microSD card. The recordings are in a separate file on the card and they can be freely used and downloaded in to the computer. No separate programme is needed for downloading or viewing.



back\_emr



back\_norm



fron\_emr



fron\_norm

back\_emr: Rear cam recorded locked videos.

back\_norm: Rear cam loop recording videos.

fron\_emr: Front cam recorded locked videos.

fron\_norm: Front cam loop recording videos.

# SPECIFICATIONS

Name	EUKI Mirror Dash Cam
Screen	11" IPS Touch Screen
Model	M11
Resolution	<b>Video</b> Front: 3840×2160 30fps, 2560×1440 30fps, 1920×1080 30fps, Front and Rear : 3840×2160 25fps+1920×1080 25fps <b>Photo</b> 8M/5M/2M
Sensor	Sony IMX415+IMX307
Working Current	5V/2.5A
Size	255×72×37mm
Net Weight	330g
Working Temperature	-20°F-150°F
Storage	Built in storage 128MB External storage Micro SD card(Max to 256GB)

# TROUBLESHOOTING GUIDE

## **Q1: Why the camera always say "no card inserted" ?**

**A:** ① Please ensure that the memory card is U3 or above.  
② Format it in the camera.

## **Q2: Why the camera doesn't work anymore ?**

**A:** Please check whether the memory is full, if yes, save the files and format the SD card.

## **Q3: Why the image is blurry?**

**A:** The windshield will reflect the light, please adjust the camera to the appropriate position.

## **Q4: Why does the camera lose power so often?**

**A:** Due to different vehicle designs, please adjust the car charger to keep it stable.

## **Q5: Why is the camera unable to be turned on?**

**A:** Please make sure that whether the charge indicator light is on or off, if off please re-insert the car charger and reset the camera.



## CUSTOMER SUPPORT

[support@euki.cn](mailto:support@euki.cn)



Made in China