

129g铜版纸 过哑油

成品尺寸：130\*160mm

设计尺寸：136\*166mm（含出血3mm）

彩印

骑马订

MORECam

GQ1

User Manual



# PTZ WIRED SECURITY CAMERA

Due to the continuous updating of the product&software, there may be a discrepancy between this user guide and App interface. All the instructions are subject to the actual operation interface.



# CATALOG

---

● WARM SUPPORT .....	01
● WHAT'S IN THE BOX .....	02
● PRODUCT INTRODUCTION .....	03
● HOW TO ADD A CAMERA TO APP .....	05
Download "Cloud Edge" APP .....	05
Register Account .....	07
Power on Camera .....	08
Connect the Camera to Wi-Fi .....	09
● MOUNTING THE CAMERA TO THE WALL .....	12
● FUNCTION INTRODUCTION .....	15
Main Page .....	15
Preview Page .....	15
Video Replay Page .....	16
Setup Page .....	17
Device Sharing .....	18
SD Card Recording .....	18
Alert Settings .....	19
● HOW DO I CONNECT THE CAMERA TO ECHO SHOW? .....	21
● TROUBLESHOOTING / FAQ .....	26

# WARM SUPPORT

---

Dear Friends,

Congratulations on purchasing one of the best security cameras on the market! We appreciate your business and want to earn your trust. Please refer to the notes below and follow the instructions in this manual to ensure that you use the action camera correctly and have a good experience with this product.

If your camera does not seem to be functioning properly, please check the Troubleshooting/FAQ section. You also can contact our support team:

[support@morecam.cn](mailto:support@morecam.cn). We will provide a fast solution in 24 hours.

Problems are often due to something simple that was overlooked, or require only changing one setting to solve.

Thank you again for ordering from morecam. We truly appreciate your business. We LOVE our customers and we will always be here with our professional camera engineers.

Wishing you the best,  
morecam Customer Support Team



**SCAN ME**

# WHAT'S IN THE BOX

---



Outdoor Camera With Mount



Power Supply Adapter



List all Tools



User Manual

# PRODUCT INTRODUCTION

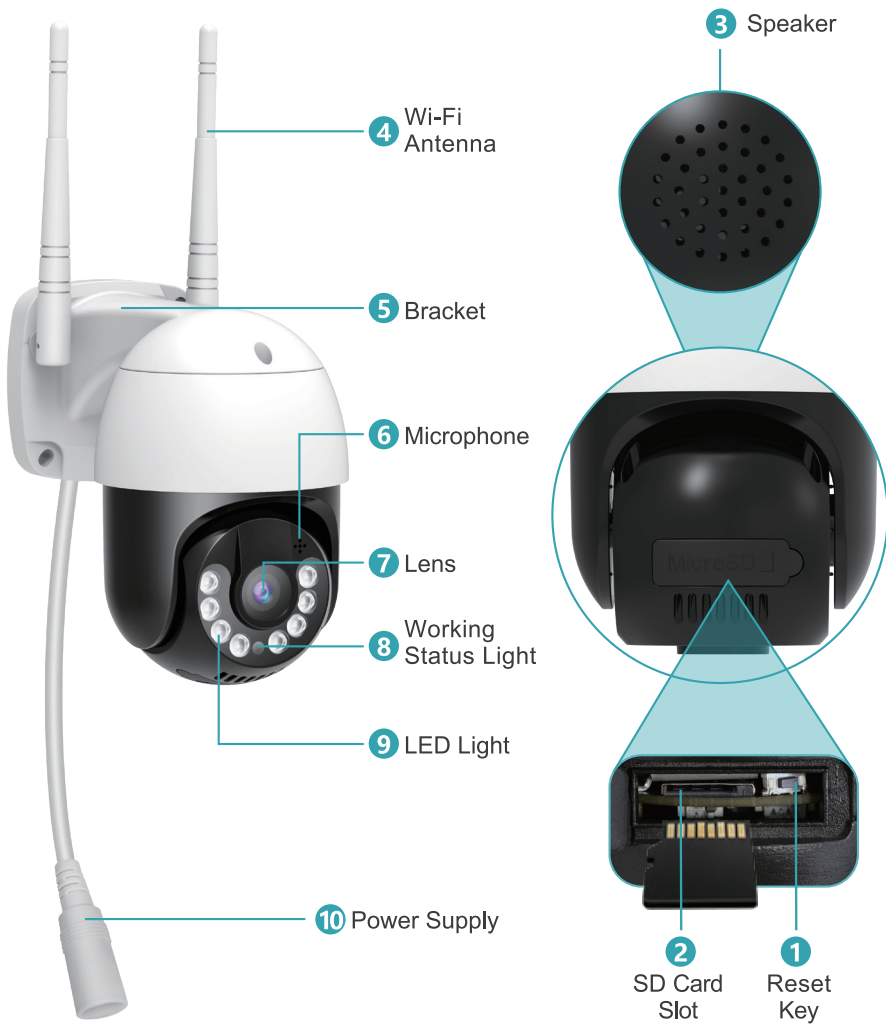

<b>Reset Key</b>	Press and hold RESET for 5 seconds to reset the device to factory setting.(You will hear 'Bugu' if reset successfully)
<b>SD Card Slot</b>	Support local SD card storage (up to 128G)
<b>Lens</b>	Support FHD 1080P resolution
<b>Microphone</b>	Capture sound for your videos
<b>PIR Sensor</b>	Can detect moving objects up to 50FT away
<b>Working Status Light</b>	<b>Solid on red:</b> Device is abnormal <b>Flashing red slowly:</b> Ready for Wi-Fi connection <b>Flashing red quickly:</b> Wi-Fi connecting <b>Solid on blue:</b> Wi-Fi connected Successfully
<b>Speaker</b>	Two-way audio output
<b>USB Charge Port</b>	Use 12V/1A USB standard charger and micro USB cable to charge the camera
<b>Thumb Screw</b>	For fixing the camera and the bottom bracket
<b>Wi-Fi Antenna</b>	Using 4DB signal antenna



# HOW TO ADD A CAMERA TO APP

---

## 1. DOWNLOAD "CLOUDEDGE" APP

Search "CloudEdge" in App Store or Google Play, or scan the QR code below to download and install it on your smartphone.



### TIPS

Please turn on the following 2 permissions when using the application for the first time,

- ① Allow "CloudEdge" to access mobile cellular data and WLAN, otherwise you will not be able to add devices.
- ② Allow "CloudEdge" to receive messages, otherwise the phone will not receive alert push notifications when motion detection or audible alerts are triggered.

The following is a screenshot of iOS cell phone operation, Android cell phone permissions open method is basically the same as this method.

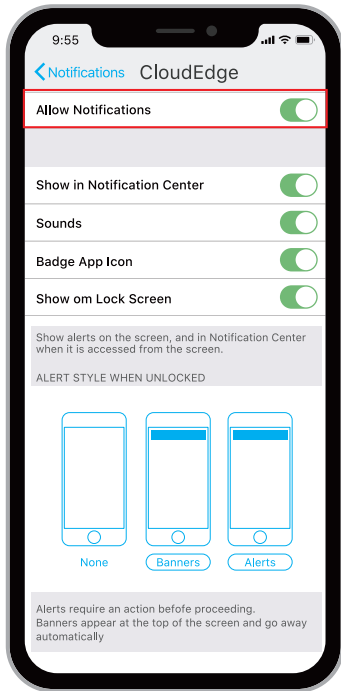
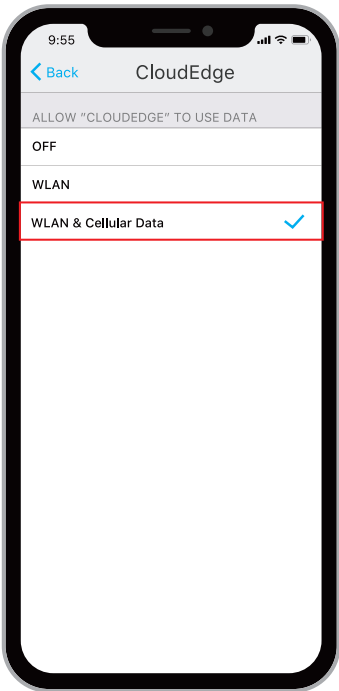

## 2. REGISTER ACCOUNT

New users must register by email

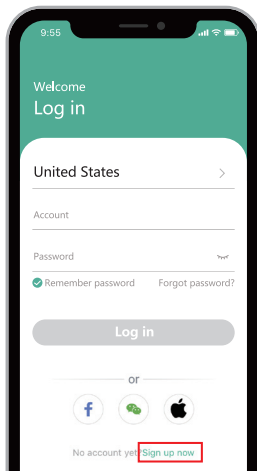

1. Click on "Sign up now"

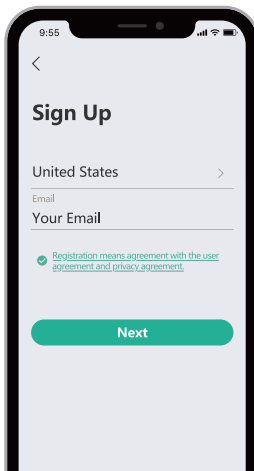

2. Input 'Your Email'

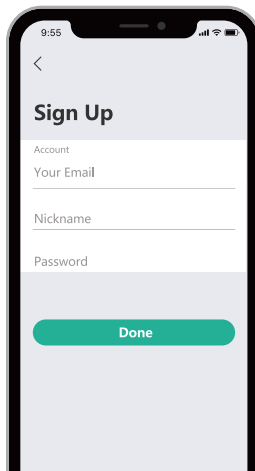

3. Set 'Nickname' and 'Password'

### TIP

- ① Please use the correct e-mail.
- ② Please select the correct country code.
- ③ When registering for a new account, please select the region where you are actually located. (Cameras cannot be shared between different registration regions.)

### 3. POWER ON CAMERA

Use the accessory charging plug of this product, connect the camera power cord, the camera work indicator lights up, wait for 20 seconds, after the power on successfully, the work indicator flashes red slowly, flashing speed 2 times per second .



#### Why the camera cannot be turned on?

1. Try a different power outlet.
2. Contact Customer Support Team: [support@morecam.cn](mailto:support@morecam.cn)

## 4. CONNECT THE CAMERA TO WIFI

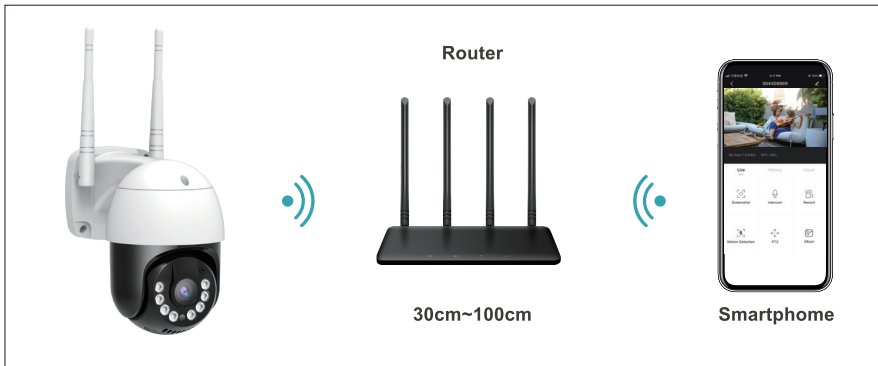

### **i** IMPORTANT:

- ① To connect the camera successfully, please allow Cloudedge to use your WLAN & Cellular Data at the first run of this App.
- ② The camera only supports 2.4GHz Wi-Fi.
- ③ Make sure the camera and your mobile device are close to the router.
- ④ Press the Power Button once to wake up the camera from sleep mode and make sure the LED indicator flashes RED slowly.
- ⑤ Insert the Reset Pin into the Reset Hole and press for 5 seconds to reset the camera. There is beeping sound from the camera after a successful reset.

## Connecting by Scanning the QR Code

Start the Wi-Fi configuration following the in-App instructions or referring to below tutorial steps.



1. Tap "+" to add device

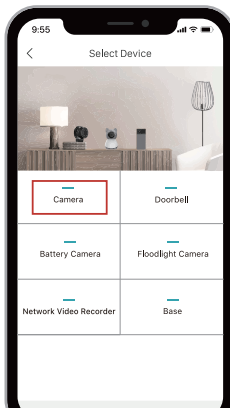

2. Select Camera

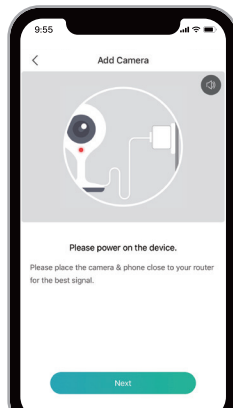

3. Check power status

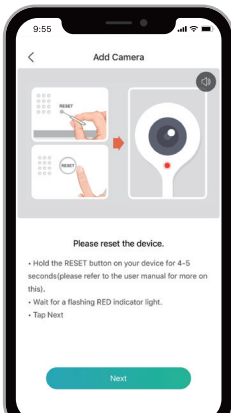

4. Reset device

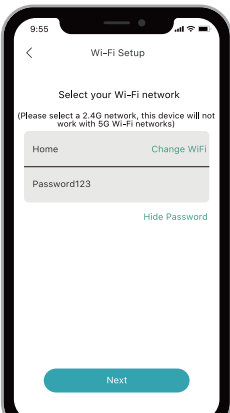

5. Input Wi-Fi password

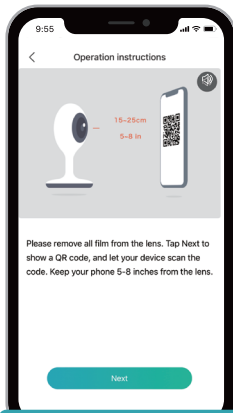

6. Prepare Code Scanning

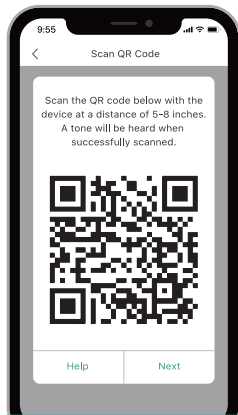

8.Generate QR Code

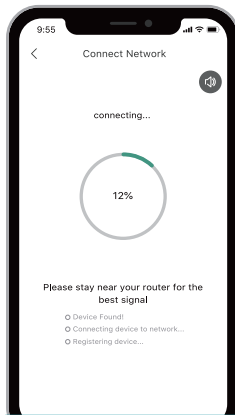

9. Wait for connection

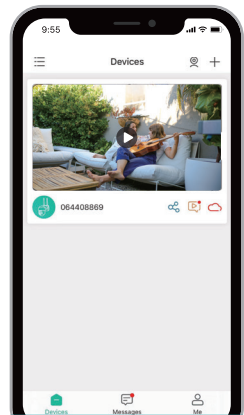

10. Device Added

## Processing Steps Of Camera and WI-FI connection failure :

- Please make sure you are using 2.4GHz Wi-Fi. In our experience, most users fail to connect the WI-FI because of selecting 5GHz WIFI and adding the camera incorrectly.
- Make sure you use the correct Wi-Fi password and a fast WI-FI network. (Note: It requires that the Wi-Fi password doesn't have special characters such as (!@#\$\$))
- Make sure the QR code on the phone screen is normal and the distance between the phone and the camera lens is 10-15cm (3.9-5.9inch) during the scanning process.
- If none of the above steps take effect, please try to re-download the APP, restore the product to factory settings, restart the router, and then add it again.
- After multiple attempts have failed, please contact customer service:

[support@morecam.cn](mailto:support@morecam.cn)

# MOUNTING THE CAMERA TO THE WALL

---

## NOTE

In order to obtain the best product performance and avoid unnecessary environmental disturbances, please pay attention to the following during the installation process:

- Try to avoid installing the product on the side of a lively road. Frequent pedestrians and vehicles will keep waking up the camera, resulting in frequent alarm messages and extremely fast power consumption.
- Do not install the product very far from the router, the product needs a good WI-FI signal to work properly.

## Extra Tools You need needed:



**Step Ladder**



**Power drill**



## Step 1:

Select the location where you need to install the camera, take the camera and the phone to the location, and use the "Installation Guide" in the application to diagnose the network and determine whether the Wi-Fi signal at the location is good. It is recommended to install the camera in a location with good Wi-Fi signal for smooth camera operation.

## Step 2:

Use Power Drill and four screws. Secure the camera bracket to the wall, 8-10 feet off the ground (2.4m-3m) is recommended, snap the camera into the bracket and secure the camera with the four thumb screw.

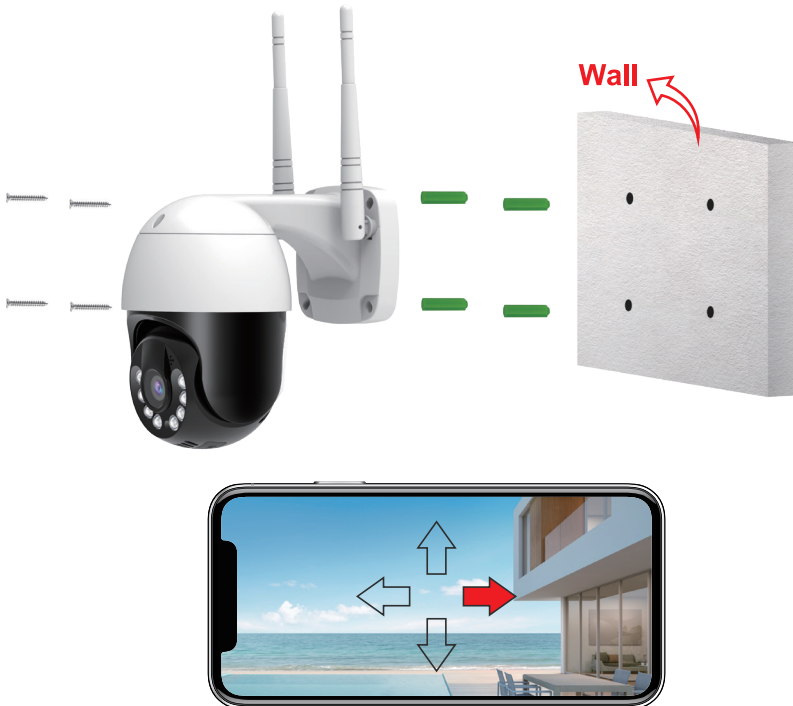

## Suggestion:

the best downward tilt angle of the lens is 15° to obtain the best alarm detection range.

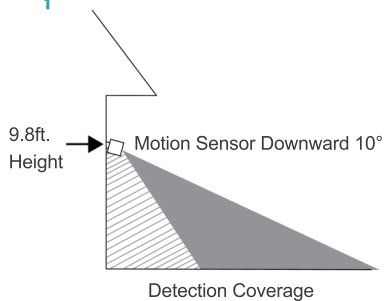
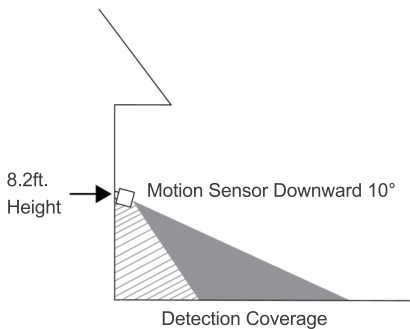
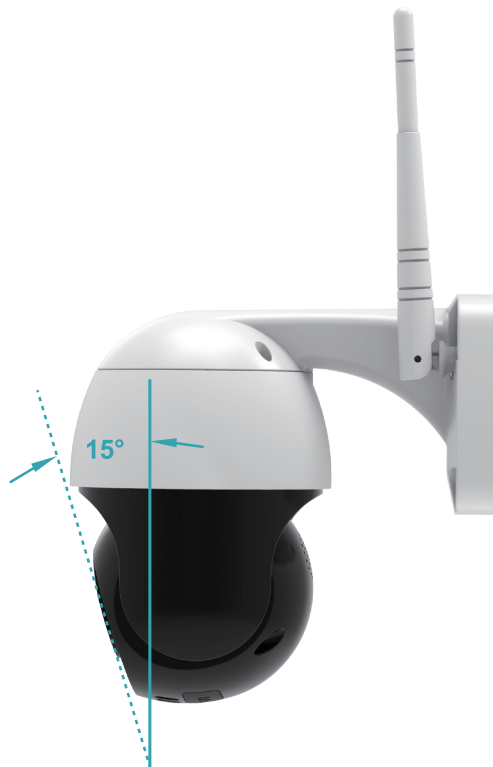

# FUNCTION INTRODUCTION

## 1. MAIN PAGE

- 1 Go to the video browsing page
- 2 Multi-screen viewing
- 3 Adding Devices
- 4 Device Sharing
- 5 View alarm pictures and video
- 6 Cloud Storage

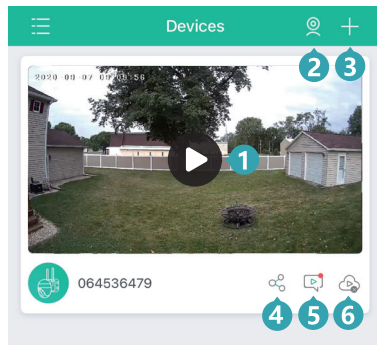

## 2. PREVIEW PAGE

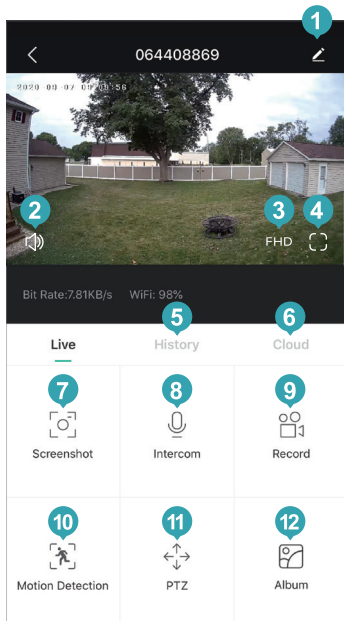

- 1 Enter settings menu(alarm settings, video, lighting, device information, firmware upgrade, etc.)
- 2 Turn on/off the speaker
- 3 Video definition settings (SD, HD options)
- 4 Full screen option
- 5 SD card video playback
- 6 Cloud storage video playback
- 7 Manual Screen-shot
- 8 Voice intercom (long press to talk)
- 9 Manually capture video clips
- 10 Turn on/off motion detection
- 11 Remote PTZ control
- 12 Albums (store screen-shots and manual video files)

## TIP

Stretch the video screen with two fingers to zoom in on the image and view image details.

### 3. VIDEO REPLAY PAGE

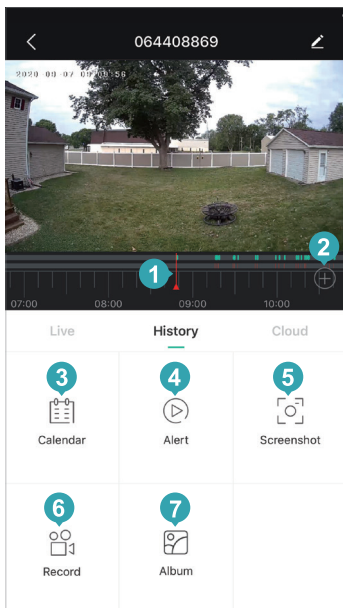

- 1 Video timeline with drag-and-drop time selection
- 2 Timeline zoom button
- 3 Select video playback date
- 4 Select alarm video clips
- 5 Video Screen-shot
- 6 Record video, first click to start recording, click again to end recording
- 7 Save video screen-shots and recorded videos

## 4. SETUP PAGE

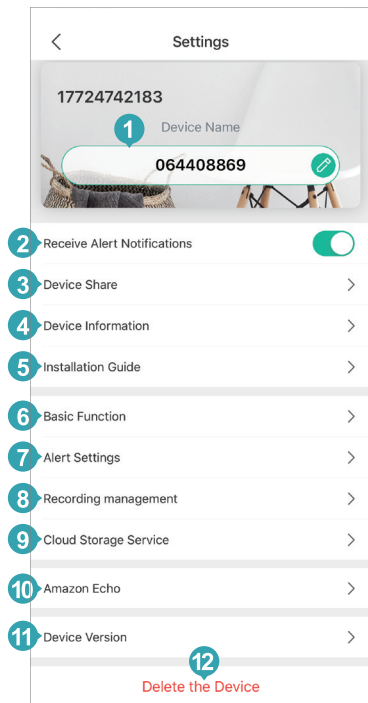

- 1 Modify device name (The default is S/N of device)
- 2 Turn alarm notifications on or off
- 3 Share the device with other operators
- 4 Get device information (network information, Mac address, time zone)
- 5 Installation instructions, the system will identify the best signal
- 6 Turn off the light, night vision settings, check the battery level
- 7 Motion detection settings, adjust the detection sensitivity, etc.
- 8 Video settings, view SD card capacity, format
- 9 Cloud storage service: Buy cloud storage
- 10 Amazon echo: Connect to Amazon Echo
- 11 Device firmware version information, version upgrade
- 12 Delete the device and operate it before rewiring

## 5. DEVICE SHARING

### Others share camera steps:

This function can be achieved through "Device Share". 1) Invite your friends to download and install "CloudEdge" APP and login. 2) Click the "Device Share"



icon to watch the operation video, and then follow the steps to complete device sharing.

### TIP

When sharing, please make sure the APP account is registered in the same region. Otherwise, you will not be able to share successfully.

## 6. SD CARD RECORDING

This product does not include an SD card. If you need an SD card to store your files, please purchase it by yourself.

### SD card requirements:

- Recommend the use of brand name cards such as San Disk, Samsung, etc.
- Support 8-128GB capacity;
- Recommend the use of standard Class 10 SD cards.
- Only FAT32 format is supported.

### NOTE

Insert the memory card into the SD card slot of the device and the device will automatically start saving the video.

## How to watch videos on SD card:

- Click the "History" or "Alert" button on the alarm information icon in the app to enter the video playback interface. Drag the timeline or select the alarm point to find the corresponding time period you want to record.
- Insert the SD card into your computer. The video file is in MP4 format. You can play the video directly using the video player.

## 7. ALERT SETTINGS

### Motion Detection Settings

Enter the application - **"Settings"** - **"Alert Settings"** - **"Motion Detection"** interface, you can adjust the motion detection settings.

- ✗ **Low** belongs to the Low gear sensitivity, motion detection distance of 4-5 meters.
- ✗ **Medium** belongs to the Med gear sensitivity, motion detection distance of 5-8 meters.
- ✗ **High** belongs to the High gear sensitivity, motion detection distance of 8-10 meters.

### Alarm Area

Enter the application- **"Settings"** - **"Alert Settings"** - **"Motion Detection"** - **"Alarm Area"**.

The alarm area has 16\*9 grids. Select the area to be monitored in the grid area and press "Save". The camera will only record video after moving objects appear in the grid area.

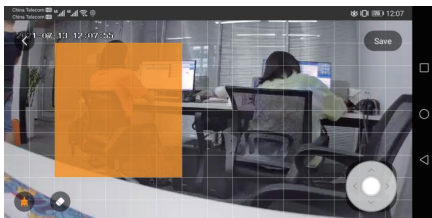
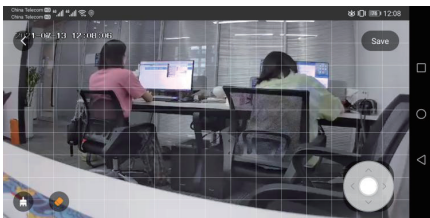

## Noise Detection

The sound and light alarm is only effective at night. When the sound and light alarm is turned on, you can choose "sound alarm", "white light alarm", "sound and light alarm", three modes.

### NOTE

If the night alarm is disabled, the camera will only record black and white video at night.

### WARM TIPS

**In the process of using this product, if you encounter the following problems, you can adjust the motion detection sensitivity to solve them.**

- If the phone receives alarm messages too frequently, it is recommended to lower the motion detection level or set the alarm area.
- If you find that there are no moving objects in the alarm picture that the phone frequently receives, it may be due to factors such as changes in light and shadow in the motion detection range, it is recommended to lower the motion detection level or set the alarm area.
- If you detect that someone is passing by the camera, but you cannot receive the alarm message, it is recommended to increase the motion detection sensitivity and increase the motion detection range.
- If you find that there is a delay in the alarm picture or video, or you can only see the back of the person, it is recommended to increase the motion detection sensitivity.



# HOW DO I CONNECT THE CAMERA TO ECHO SHOW?

---

## 1. ADD YOUR CAMERA TO 'CLOUDEDGE' APP.

Please install and set up your camera , following the [user guide](#) in the camera package.

## 2. CONFIGURE YOUR AMAZON ECHO DEVICE.

### Plug in your Echo

Plug the power adapter into your Echo Show and then into a power outlet. You must use the items included in the original Echo Show package for optimal performance. In about a minute, the display will turn on and Alexa will greet you.

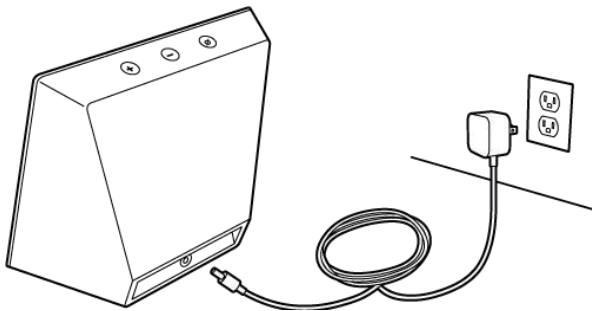

### Set up your Echo Show

Follow the on-screen instructions to set up your Echo Show. During setup, you will connect your Echo Show to the Internet, so have your Wi-Fi password and Amazon login available.

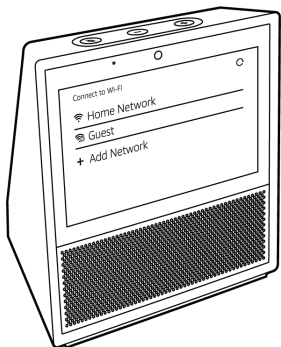

## Getting started with your Echo Show

Interacting with your Echo Show

- To power on and off your Echo Show, press and hold the Mic/Camera button.
- A short press of the Mic/ Camera button will turn off the microphones and camera and the LED will turn red.
- Your Echo Show will automatically turn on the screen when you walk in the room or say "Alexa."
- To access Settings, swipe down from the top of the screen.

## 3. ALEXA APP GUIDE

Download the free Amazon Alexa App to your phone or tablet. The Alexa App helps you get more out of your Echo Show. Link your Amazon accounts, and add skills to enable liveviewing your doorbell via your echo show.

Sign-in your Amazon account → More → Skills & Games → Search for 'Clouddge'.

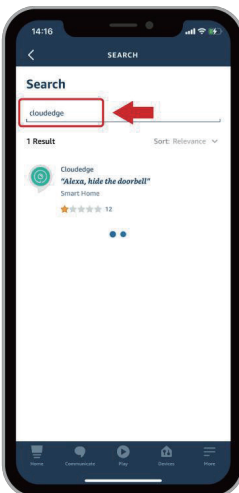
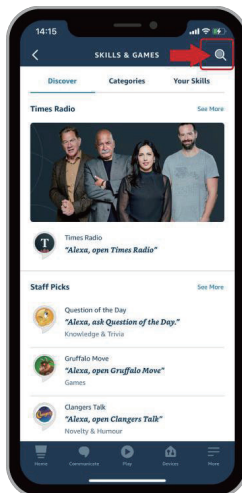
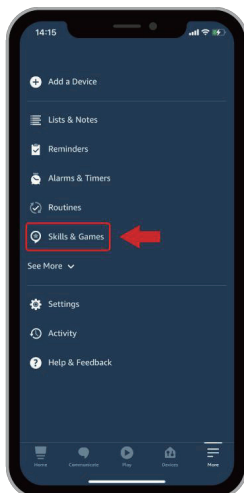
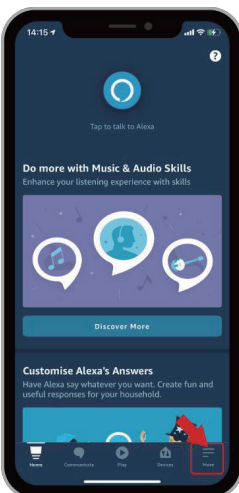
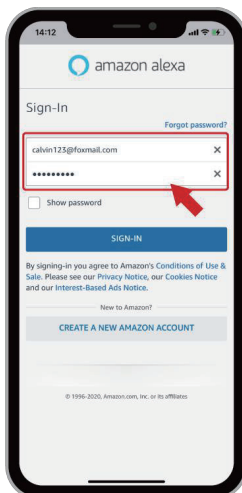

## Enable the 'Cloudedge' skill → Link Account → Authorize to access.

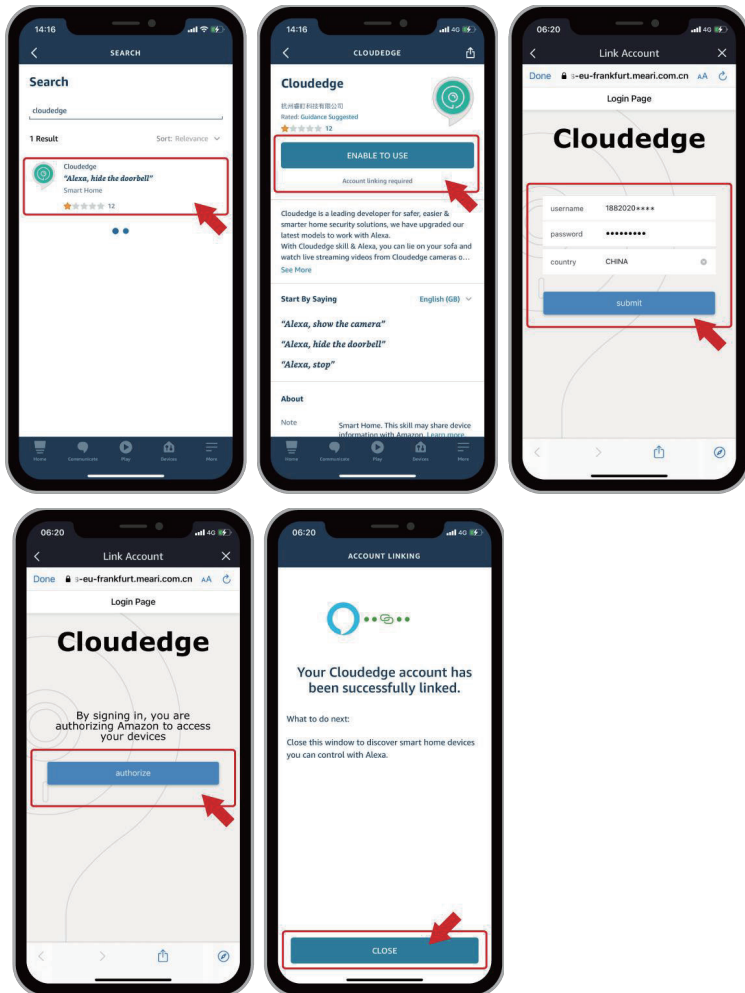

Discover devices → Devices → Camera → Radom S/N (default camera name) → Edit Name. for example: name it as “Camera QG1”

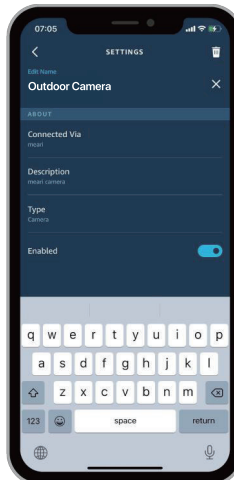
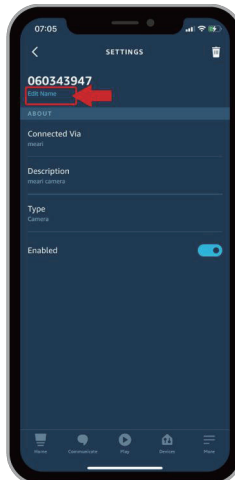
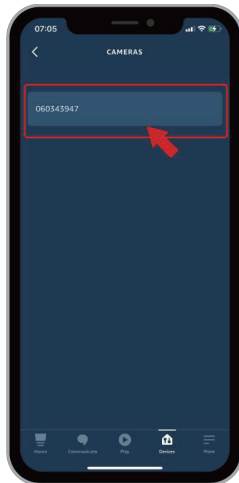
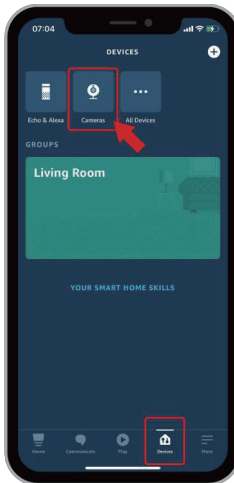
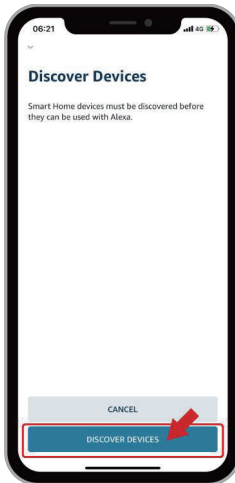

## 4. READY TO GO!

Now you can control your camera with your Echo show.

Try this voice command: "Alexa, show the camera"

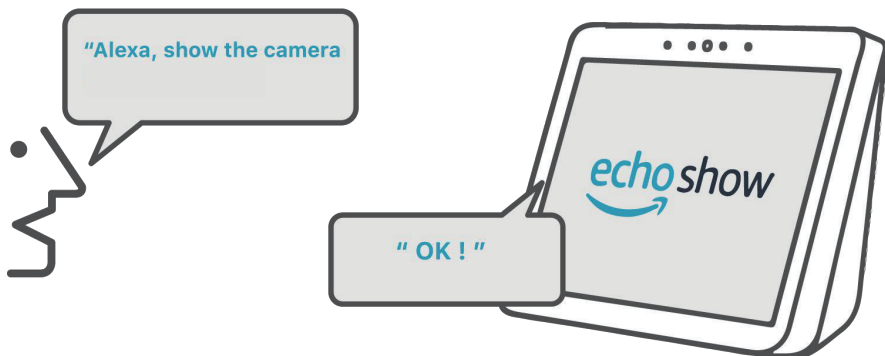

## TROUBLESHOOTING / FAQ

---

For more detailed FAQs, please log in the APP, "**Me**"-"**FAQ**"-"**Outdoor Camera**".

### Device prompted offline?

- Check whether the equipment is in the energized state and observe whether the working light of the equipment lights up normally.
- Check whether the WIFI network is good and restart the router.
- If the location of the device according to the router is far away, resulting in the inability to obtain a good WIFI signal, it is recommended to move the router to a closer location, or add a WIFI amplifier to enhance the home WIFI performance.
- Remove the floodlight camera from your CloudEdge account, Reset the device, and then re-add it.
- Check that the device firmware and applications are up to date.

## Update router or WIFI password?

- Remove the floodlight camera from your CloudEdge account, Reset the device and re-add it with a new WIFI or password.

## Can't play history videos?

- Check the status of SD card in "Settings" and make sure the SD card is successfully recognized.
- Reinsert the SD card.
- In the application, format the SD card.
- Try another new SD card.

## Frequent alarm?

- Open the application, turn down the motion detection alarm sensitivity.
- Check whether there are objects within the field of view of the device that interfere with and trigger the PIR sensor, such as outdoor units of air conditioners, moving cars, passing pedestrians, etc. The angle of the device can be adjusted appropriately to avoid these easy to interfere with objects
- Enable **"The Alert will be triggered only when human motion is detected"** to filter useless alarms using humanoid algorithm.

## Can't receive alarm on your phone?

- In the system settings of the phone, turn on the push permission of "CloudEdge" application.
- Ensure that the device's motion detection feature is successfully enabled.
- Restart your phone and try clearing the cache on your Android phone.
- Check if the network is good.







.....MOREC@M

## CUSTOMER SUPPORT

[support@morecam.cn](mailto:support@morecam.cn)