

## Instructions Notes

- Install in accordance with the IEE wiring regulations and building regulations.
- This product must be installed by a suitably competent person.

### Electrical

- Do not connect directly to mains electrical supply.
- Switch the power off at the mains supply before installing or maintaining this fitting.
- Ensure others cannot restore the electrical power supply without your knowledge.
- Ensure the product is in good working condition. If there is visible damage do not use.
- This product must be used with a good quality constant voltage LED driver. Ensure that the voltage output of the driver matches rated voltage of the LED flex.
- Do not connect directly to mains electrical supply.
- Switch the power off at the mains supply before installing or maintaining this fitting.
- Ensure others cannot restore the electrical power supply without your knowledge.
- Ensure the product is in good working condition. If there is visible damage do not use.
- This product must be used with a good quality constant voltage LED driver. Ensure that the voltage output of the driver
- During application in project after cutting, waterproof treatment is compulsory for the front connector and end caps, we strongly advise silicone glue to be used as the waterproof glue.
- Ensure you are using the correct power supply

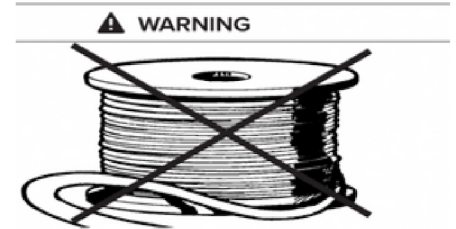

**WARNING**  
Do not light up the whole roll until it is loosened linearly and unyoked open.

### Warranty

- A warranty period is provided for products in normal use. For any faults arising during the period that are confirmed to be quality related by inspection by the company, a product of the same specification will be replaced for free.
- The digital pixel rgb neon flex 24V IP68 comes with a 3-year warranty.
- The warranty does not cover any of the following:
  - (1) Any product damage due to usage not allowed in the instructions.
  - (2) Any product damage due to disassembling or wrong operation by the user.
  - (3) Severe appearance damage or deformation of the product.



## Instructions Notes

### Precautions

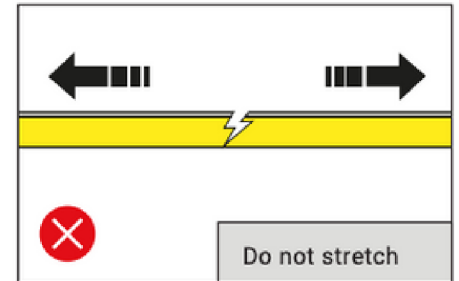
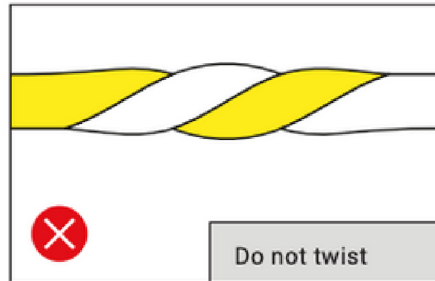

### Tolerance & Bend

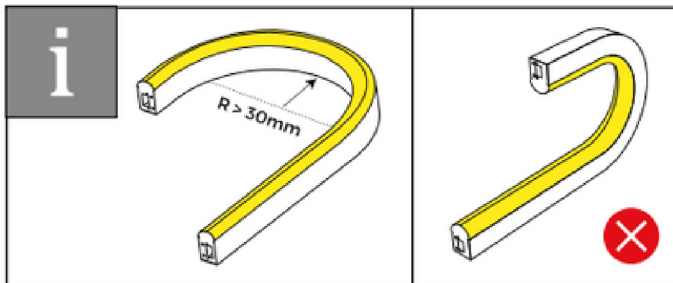

- ▶ Minimum bend radius: 30mm
- ▶ Minimum bend diameter: 60mm
- ▶ Horizontal bend only.

### Cutting

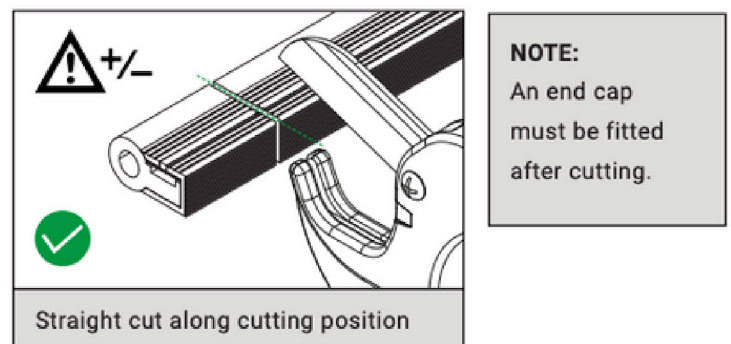

Straight cut along cutting position

**TIP:** we recommend using a pipe cutter to cut the LED flex. Use one firm press to cut cleanly through.

### Mounting / Installation

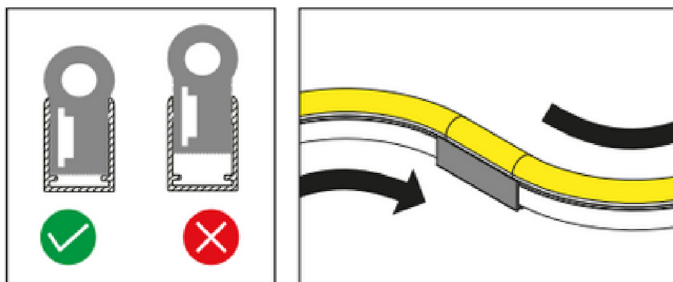

1. Install mounting channel with countersunk screws. Use appropriate fixings depending on the mounting surface.
2. Ensure that the mounting channel is securely held.
3. Install the LED flex in the correct position making sure it is properly seated in the mounting channel.
4. Use multiple mounting brackets to achieve bends and shapes with the LED flex.
5. We recommended installation be carried out by at least 2 people.

### Troubleshooting

- LED flex doesn't respond to controller Check that the data output of the controller is connected to the data input of the LED flex.
- Check the data arrows labelled on the LED flex. Ensure the data flows in the correct direction.
- The LED flex lights but the animation is distorted Check that the IC type setting on the controller matches the IC type of the LED flex.

## Instructions Notes

### Front Cap Installation

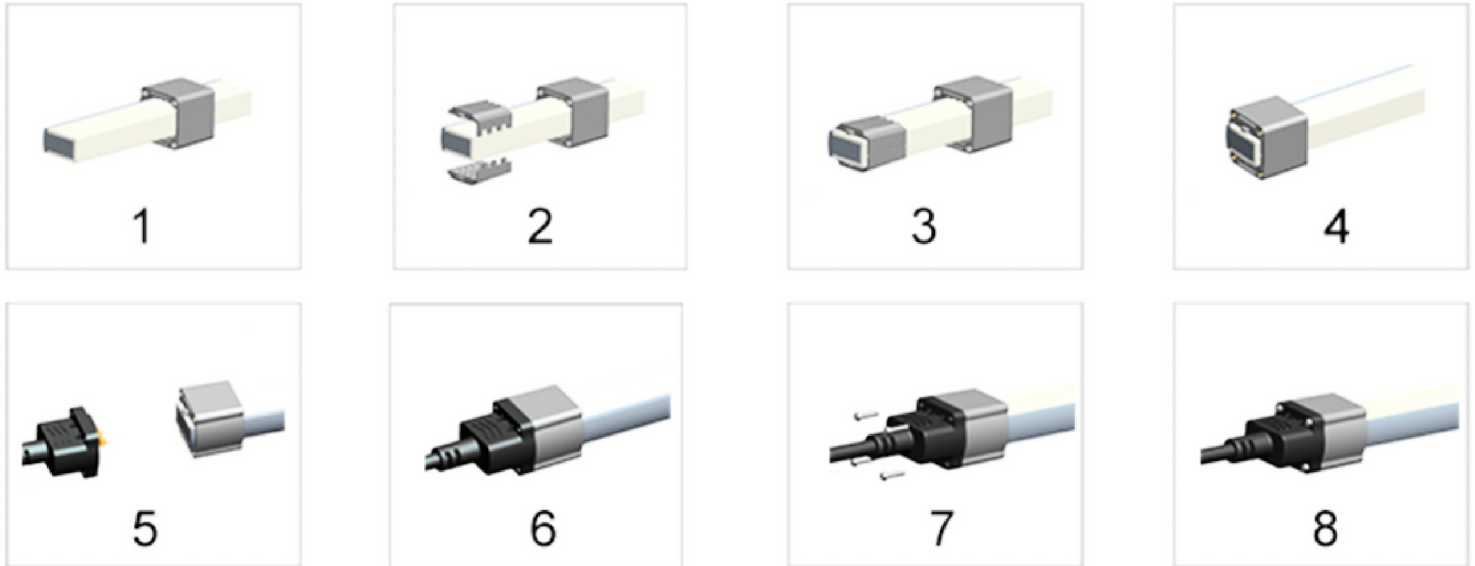

### End Cap Installation

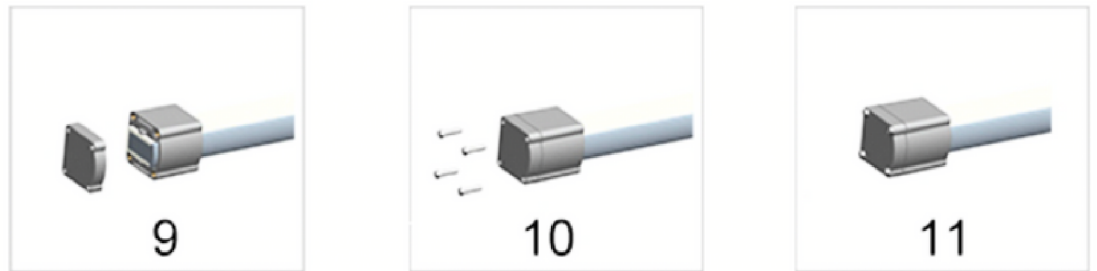

### Wiring

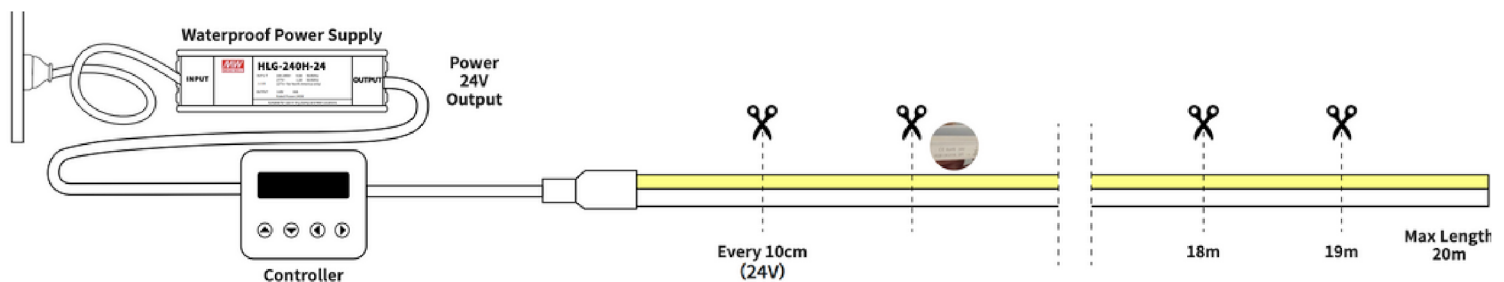

### Wiring

#### For WIFI Wire Connection:

- DAT – Black Wire/
- VCC - Red Wire/ Brown Wire
- GND – Yellow Green Stripe Wire/ Blue Wire

#### For Bluetooth Wire Connection:

- DAT 1 – Black Wire
- V+ -- Red Wire/ Brown Wire
- GND – Yellow Green Strip Wire/ Blue Wire