

Clevis & Eye Turnbuckles

Product Description

- AS2319 - 2001
- 6:1 Safety Factor
- Grades L, P & S
- Testing and Certification
- Galvanized
- Manufactured using only heat certified Australian Steel (AS1442/AS1444)



Available on Request

- Lock Nuts

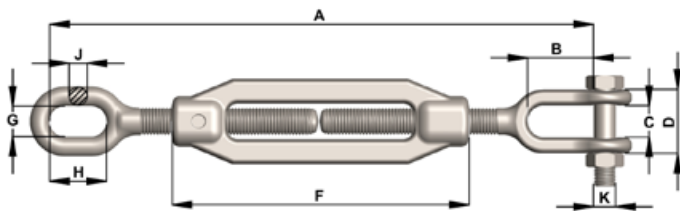

Townley Drop Forge is both NATA Accredited (Test Lab No. 13554) and AS/NZS ISO9001 Certified (Certificate number FS 604897)..

Dimensions and Working Load Limits (WLL) - Metric - Grades L , P & S

Nominal Size	A Closed	A Open	B	C	D	F	G	H	J	K	Grade L WLL	Grade P WLL	Grade S WLL
M10	235	340	30	14	30	150	11	21	7	10	0.3t	0.6t	0.8t
M12	330	470	36	15	35	190.5	15	30	9	10	0.5t	1t	1.2t
M16	355	490	45	20	40	204	17	36	12	12	0.75t	1.6t	2t
M20	390	520	55	22	46	215.5	21	42	14	16	1.25t	2.5t	3.2t
M24	445	580	59	30	58	232	25	51	17	20	2.5t	4t	5t
M33	643	793	78	38	76	252	33	70	24	27	5t	8t	10t

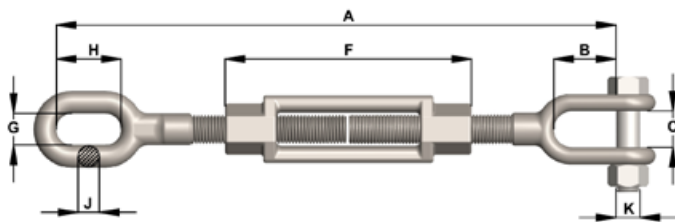

Dimensions and Working Load Limits (WLL) - BSW

Nominal Size	A Closed	A Open	B	C	F	G	H	J	K	Grade L WLL
1 1/4"	525	690	70	38	255	33	67	22	25	5t
1 1/2"	570	740	70	48	275	38	72	25	32	6t

Subject to technical modifications