

# SHADOW HUNTER<sup>®</sup>

PROFESSIONAL GRADE HUNTING BLINDS

MM46BGK and OD46BGK Kits

## INSTRUCTIONS



6714 Pointe Inverness Way, Suite 200  
Fort Wayne, IN 46804



## SAFETY PRECAUTIONS

- 2 adults at a minimum to install or take down
- Safety goggles
- Work Gloves
- Assemble blind on solid, level ground
- Do not assemble on a windy day

*Note: Aluminum edges are sharp and caution should be taken when handling. Always wear suitable gloves to protect hands.*

## GENERAL SAFETY AND WARNINGS!

**WARNING!** The safe use of this product is the sole responsibility of the user / owner. The owner must ensure that any user understands and follows proper safety precautions to avoid possible injury or death. Failure to follow these warnings may subject you to personal liabilities and or penalties as determined by the U.S. judicial system.

**WARNING!** Prior to every hunt you should inform someone of your planned hunting location and the time you are expected to return.

**WARNING!** Always carry a working signaling device like a mobile phone, two-way radio, whistle, personal locator device or way to signal for help in the event you need it. Always keep this device on your person, secure and accessible and remember to check for good operational condition before you leave for your hunt.

**WARNING!** Always be aware of and consider weather conditions. Do not climb or hunt out of elevated stands when ice, snow or freezing rain have deposited or formed on any portions of the ladder or ladder platform. Thunder and lightening can cause a threat especially if present within 5 miles / 8 kilometers of you. Adverse weather conditions like high winds, lightening, freezing rain, sleet and snow can threaten your safety and interfere with safe operation of the product described within this manual. If inclement weather conditions develop while in the stand, return to the ground and seek proper shelter immediately. Failure to follow these directions can lead to serious injury or death!

**WARNING!** Use of propane heaters or other heating systems can cause an unsafe atmosphere within the blind that is dangerous to life or health by asphyxiation from carbon monoxide. Never use any heater without a UL Listing and working carbon monoxide shut off feature and a tip safety cut off. Know the signs of carbon monoxide poisoning. If you experience headache, nausea or dizziness, immediately turn off the source and get to an area with fresh air. Failure to follow these instructions can lead to serious injury or death!

**WARNING!** Do not mechanically alter, modify, remove or omit any portion of this product or its assembly. Modification or misuse may result in serious injury or death!

**WARNING!** Capacity limitations have been set for each product to ensure your safety and the safety of others. Make note of these limitations and keep maximum occupancy limited based upon them. Never exceed these limitations. Failure to follow such capacity limitation may result in serious injury or death!

**WARNING!** DO NOT use this or any Shadow Hunter® product if you have heart problems, problems with your back or vision, equilibrium difficulties, spinal or joint problems, high blood pressure or if you are overly tired and fatigued or have any other physical impairment that may limit your ability to safely use this product as outlined in this manual. In addition do not use this or any Shadow Hunter® product if you are taking medication(s), including prescription drugs, or while using/ consuming any substance that may cause impairment, including, without limitation, alcohol or illegal drugs. Never use this product if you feel dizzy or ill. Failure to follow these precautions may lead to serious injury or death!

## ELEVATION PRECAUTIONS AND WARNINGS!

**WARNING!** Falls from the ladder platform or ladder can occur at anytime after leaving the ground which can lead to serious injury or death. It is important that any owner and user read and follow the instructions to assemble, install, and safely use the Shadow Hunter® Blind and Platform.

**WARNING!** Never hunt out of an elevated stand or platform that you are not comfortable climbing into, whether due to the height of the stand or platform or otherwise. Always choose the minimum height necessary to allow for the safest yet most effective hunting.

**WARNING!** Always inspect your ladder, platform and elevation system and the components for signs of wear, corrosion, cracks, rot or damage. If trouble areas or concerns become apparent do not attempt to climb into or use your stand. Failure to follow these instructions can cause additional damage to your equipment and may result in serious injury or death!

**WARNING!** Never climb into a stand or blind with a loaded weapon. Always unload your firearm or bow and make certain your broadheads are secured under a protective cover. Use a tether to raise and lower your unloaded firearm or bow once you are safely situated in the stand. Raise or lower your unloaded firearm or crossbow with the barrel pointed down and away from your person or other hunting companions. Failure to follow these safety instructions can cause serious injury or death!

**WARNING!** Always wear the appropriate footwear for climbing and for hunting in your blind or stand. A boot with a non-slip sole or tread and having good foot and ankle support is highly recommended. Make certain that laces are tied so as not to tangle, become snagged or cause you to trip and lose your balance. Failure to follow these instructions can cause serious injury or death!

**WARNING!** Before digging always contact your local buried utilities call center by dialing 811. This will prevent injury, loss of life and / or damage to the utility service. Failure to follow these instructions can cause serious injury or death!

**WARNING!** Make certain the ground is level and firm. Loose soil or sloped areas can present problems causing your blind to shift or tilt while climbing or while sitting in your blind. Never attempt to hunt from an unlevelled platform. Always properly anchor an elevated blind with the Summit Outdoors Elevators® Blind Anchor System. During installation always bounce on the first rung of the ladder or step to ensure you are on level and firm ground. Failure to follow these instructions can cause serious injury or death!

**WARNING!** Always maintain a three-point contact with your ladder platform while climbing up or down from the blind. This means two feet and one hand or two hands and one foot in contact with the ladder or steps at all times. Failure to follow these instructions can cause serious injury or death!

# 4x6 BLINDS

## WHAT YOU NEED TO ASSEMBLE

- Cordless Drill
- Tape Measure
- Caulk Gun
- #2 square head bit for drill
- T25 star bit for drill
- #2 Phillips Head Bit
- Hammer
- 1/8" Allen Wrench
- Step stool to easily reach the roof
- Paper towels and disposable glove (for caulk operation)
- Permanent Marker

## SPECIFIC FEATURES

Models	Upper Shelf	Corner Shelf	Door Handle or Bunk Latch	Floor Frame "Square" Measurement from Diagonal Corner to Corner	Max Capacity
MM46BGK	Yes	Yes	Door Handle	83-1/8"	1-2
OD46BGK	No	No	Bunk Latch	83-1/8"	1-2

*Note: Aluminum edges are sharp and caution should be taken when handling. Always wear suitable gloves to protect hands.*

## 4x6 PARTS LIST

Qty	Part Description	Where Used
Treated Lumber-9 pieces	(2) 70" Lumber runners with dado cuts for cross brace joists & pre attached bottom board K	Creates the floor frame See page 5 for reference
	(2) Bottom Board K (pre-attached to the 70" lumber runners)	
	(5) Cross Brace Joists	
20	3" #8 Coated Deck Screw	Floor Frame
1 Roll	1-3/8" Adhesive insect Tape	Floor Frame
1	OSB Drop in floor with pre attached critter mesh and carpet	Floor
6	2-3/4" Black Pan Head Screws	OSB Drop in Floor
125	3/4" Pan head screws with green heads	Extrusions, walls, roof
1	Front wall panel with door, coat hook (MM46BGK only) and window installed complete	
1	Back wall panel with window installed complete	
1	Upper Horizontal side wall panel with (2) window cut outs trimmed with Aluminum and pre-installed vent	
1	Upper Horizontal side wall panel with (2) window cut outs trimmed with Aluminum (NO VENT)	
1	Lower Horizontal side wall panel with pre-installed vent	
1	Lower Horizontal side wall panel wall (NO VENT)	
2	Roof panels	
1	Roof extrusion	
2	Roof peak extrusion caps	Roof Extrusion
2	Side Panel Window Kits (2 windows per polybag)	Upper Side Panels
1 Polybag	Upper shelf kit (MM46BGK only). Contains: (1) Carpeted upper shelf with lip (1) Weapon Holder (2) Shelf Brackets with pre-installed anchors and screws (1) Bag of hardware containing (12) 3/4" pan head screws and (2) 1-3/4" screws	Position above back panel window in pre-drilled holes
1	Corner Shelf (MM46BGK only)	Bridges between the back and left side panel
1 Polybag	Interior & Exterior door handle with key & (2) screws in poly bag	Door (MM46BGK only)
2	Tubes of caulk (1 black and 1 clear)	Interior & Exterior
4	1" wood spacer pieces for shipping	Discard or use for scrap

## 4x6 BLINDS - WOOD FLOOR DIAGRAM

ITEM NO.	DESCRIPTION	Qty.	Board Length
1	Bottom Board K	2	36"
2	Lumber Runners	2	70"
3	Cross Brace Joist	5	41-7/8"

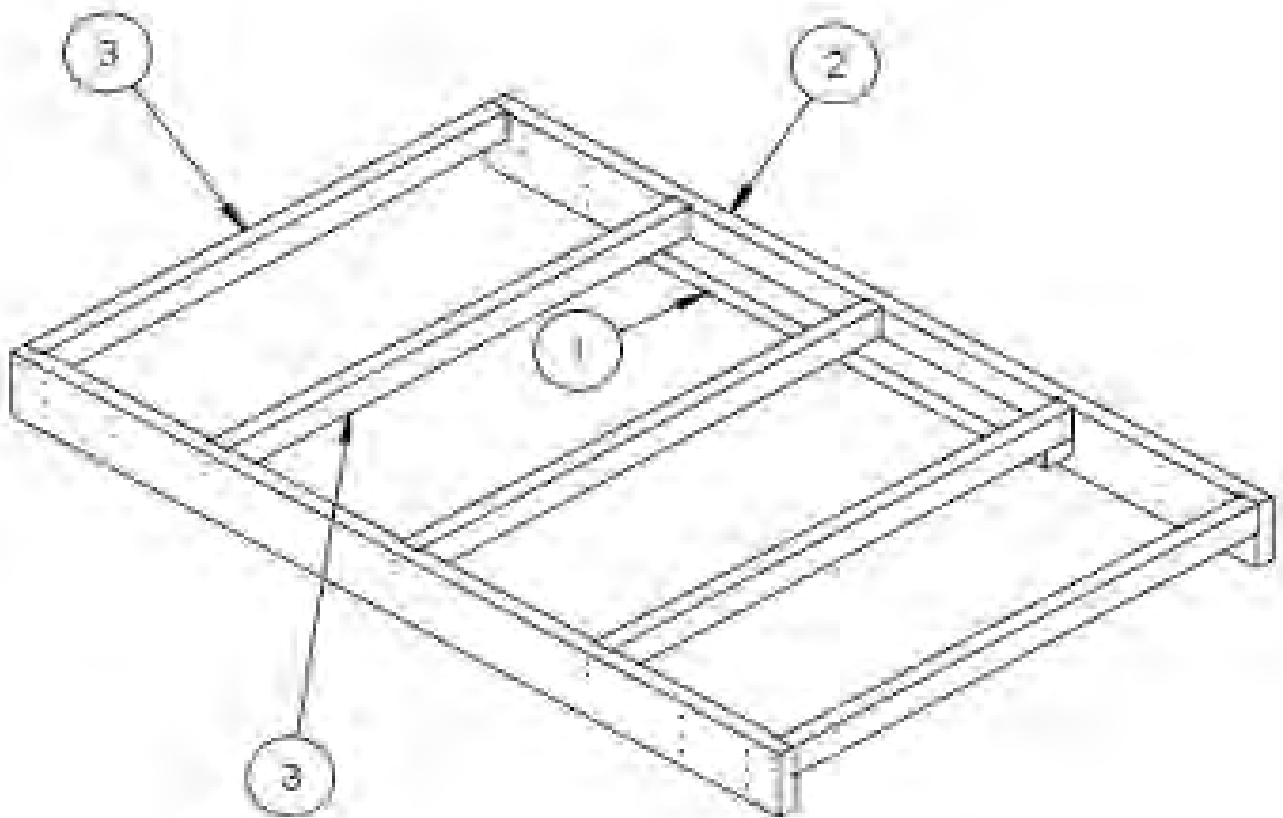

## ASSEMBLY INSTRUCTIONS

1

### Disassemble shipping container



Disassemble shipping container by pulling off Tyvek wrap and removing screws from the protective wood top. Cut plastic bands and remove.



2

### Remove all parts



Lay pieces on the ground and inventory against the parts list.

# 3

## Build the Floor Frame



Lay out wood pieces on the ground per the floor diagram provided on page 5. Use flat surface if available.

Locate the (20) 3" #8 coated deck screws.

*Note: numbers **bolded** correspond to the numbers listed on the floor diagram on page 5.*



Attach the end cross brace joists (**#3**) to the side lumber runners (**#2**). *Note: Make sure the boards are flush before attaching screws. Use 2 screws per attachment point.*



Align remaining cross brace joists (**#3**) in dado slots and attach with 2 screws per attachment point.



**Important:** Check for square. Rectangle should measure 83-1/8" from corner to corner.

Flip floor over and screw in pre-attached bottom board K. Drive screws in fully.



Flip the floor back to the upright position and check for square one last time.

# 4

## Add the Insect Tape



Working 1/2" down from the top edge of the board, attach the adhesive tape around the perimeter of the rectangle. Do not overlap the tape at the start and end points.

# 5

## Erecting the Walls-Requires two people

*Note: Lower all windows and shields prior to starting this step as it will allow for easier placement of the panels. Inspect back & front panels to ensure the 90 degree bend is not flared out. If so, press edge with your hand to return to a 90 degree angle to achieve a snug fit when inserting the side panels.*



Starting with the back panel, center the panel on the end joist and hold in place. Working 3/4" up from the bottom edge add screws every 4"-5" to secure back panel in place.

From the door position vantage point (looking at the interior back wall), Add the left bottom horizontal wall with vent.

Insert fully into the pocket of the back panel until the edge of the side panel is flush with the wood frame at the front.



Secure the side and back panels with (2) screws as indicated.



Secure left bottom horizontal panel where it meets the back panel. Position your screw in the middle of the bend and where the two panels meet, place (1) 3/4" pan head screw at the bottom and (1) 3/4" pan head screw at the top. **Do not secure to the wood frame at this point.** Repeat with bottom right side panel.

Once both side panels are secured to the back panel in (2) places, then attach to floor frame. Working 3/4" up from the bottom edge add screws every 4"-5".





## LOCATE THE UPPER SIDE PANELS



Add clear caulk to the upper horizontal side panels (metal overhang portion) by running a zig zag bead from end to end.



Starting with the right back upper horizontal panel with vent, insert pre-caulked panel into back panel and on top of bottom panel. *Note: Make sure vents are located on opposite walls-one on the upper panel and one on the lower panel.*



Using (2) 3/4" pan head screws and working 1/2" up from the edge, insert one screw between the windows and the other at the back panel in the middle of the bent metal edge. Repeat with top left side horizontal panel.

## ADD THE FRONT WALL

Using 2 people start at the top and ease the metal over the side panels on both sides working your way down to the bottom. View from inside the blind to ensure front panel is fully seated and adjust as needed. Secure all vertical panels. *Note: Do not add screws to the top at this time as those will be added once the roof is installed. Do not add screws where the side horizontal panels join at this time. Those will be completed once the windows are installed.*

Using pan head screws and working in 1/2" from the edge, add screws to all vertical panels every 4"-5"

Now secure the front panel to the floor frame

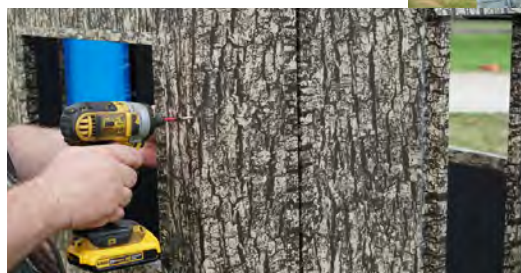

# 6

## Add the Carpeted OSB Floor



With the mesh side down, place the floor against the interior side panel and have your helper hold from outside of the blind in an upright position. Remove yourself from the interior and have your helper on the outside drop the floor in place.

Adjust as needed. Do not screw down at this time.

# 7

## Roof Assembly and Roof Extrusion Caps Assembly - Requires two people



Caulk all roof interior vertical seams with clear caulk from the bottom to half way up the opening (*do not smooth out with finger*). The goal is to seal the opening near the SIP panel but leave the ends open so they can flex when installing the roof.

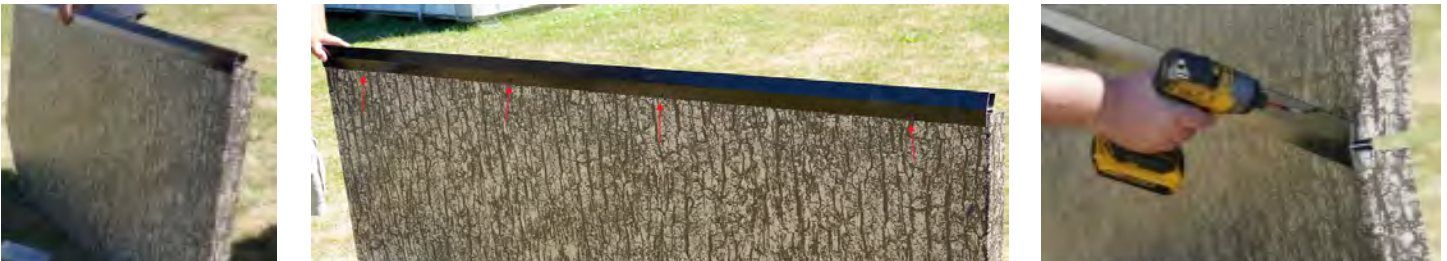

Insert one half of the roof into the extrusion.

Using (4) of the 3/4" pan head screws, attach the extrusion to the roof panel in the following order: Place one screw 5" in from each end of the extrusion. Add the remaining two evenly between each end screw. Repeat procedure for the 2nd roof panel.

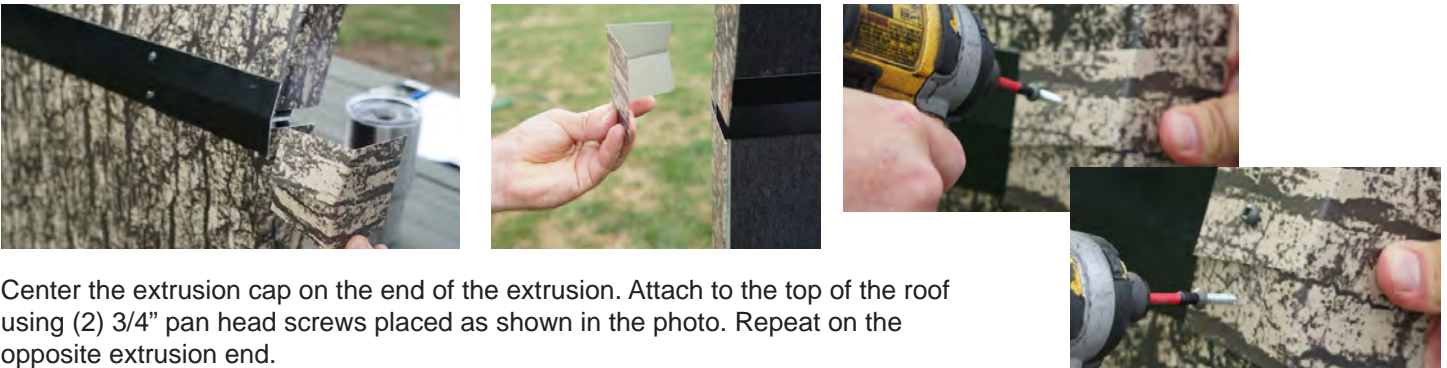

Center the extrusion cap on the end of the extrusion. Attach to the top of the roof using (2) 3/4" pan head screws placed as shown in the photo. Repeat on the opposite extrusion end.

Caulk the top of the roof along the extrusion and including the top side of the extrusion cap. *Note: Do not caulk the portion of the extrusion cap on the roof hem at this time.* Run your finger down the caulk bead to seal the seam.

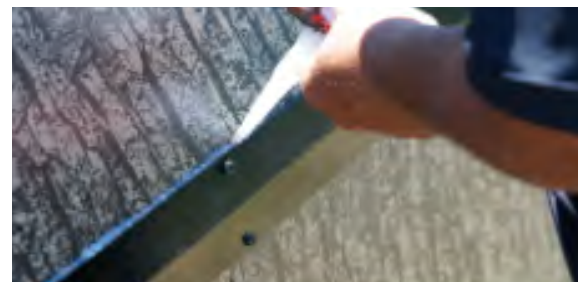

# 8

## Attach the Roof - Requires two people and the use of a step stool or ladder



Lift the roof over the blind and gently lower onto the blind walls.

Starting at the left back panel and working 1/2" up from the bottom edge of the roof, use 3/4" pan head screws to attach roof to each corner in a clockwise fashion.

Once corners are secured, screw down the center of the roof over the side panels and work out in either direction adding screws every 6".

On the front panel add two screws to the extrusion cap, then add two screws evenly spaced between the extrusion cap and the left corner. Repeat to the right of the extrusion cap. Follow the same steps for the back panel.



# 9

## INSTALL GUN WINDOW (Set of 2)

*Note: For Efficiency, each operation should be performed for all 4 windows at the same time vs. completing one window and moving on to the next*

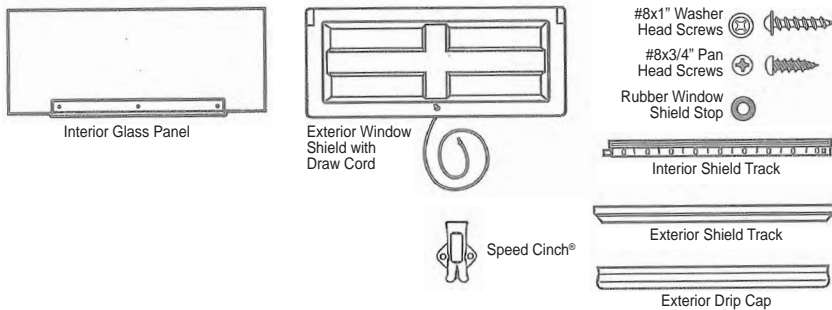

### Tools Needed:

Cordless Drill, SQ2 Square Drive Bit, Tape Measure, T25 Star Bit, and Permanent Marker.

### Screws & hardware included per window:

- [8] #8 x 1" Washer Head Screws
- [15] #8 x 3/4" Pan Head Screws
- Use 5 screws per exterior shield track.
- Use 5 screws per drip cap, evenly spaced.
- [1] Rubber Window Shield Stop
- [1] Interior Glass Panel
- [1] Window Shield with Draw Cord
- [1] Drip Cap
- [2] Exterior Shield Tracks
- [2] Interior Shield Tracks
- [1] Speed Cinch® with pre-installed anchors and screws
- [4] Wood shims

### STEP 1. INSTALL THE EXTERIOR SHIELD TRACKS

On each opening of the vertical sides, measure over 1-3/4" at the top and bottom corner and mark with a permanent marker.



### STEP 2.

Using the marks as a guide, position the first exterior shield track on one side of the window opening. Position 3/4" above the opening or even with J channel. Use 1 pan head screw to hold the exterior track in place. Repeat step 2 on the opposite side.



### STEP 3.

Make sure each track is aligned at the top and bottom of the window opening. Use a total of 5 pan head screws to fasten each track in place. *Note: Before fully securing the track to the opposite side, test with the shield to ensure shield moves easily without slack.* Remove shield and fasten balance of screws.



## INSTALL GUN WINDOW (Set of 2)

(Continued)

### STEP 4. ATTACH THE SPEED CINCH®

On the interior and using pre-drilled holes under each window, position the bracket over the holes, and place the tube in a vertical position. The notch should be at the bottom. Attach the Speed Cinch® into holes by hand or gently tap with a hammer. Set drill to the lowest torque setting and secure with pre-assembled screws until anchors expand.



### STEP 5. INSTALL THE EXTERIOR SHIELD

Drop the exterior shield into place behind the exterior shield tracks. The cord hole should be on the bottom of the shield.



### STEP 6.

Run the cord through the speed cinch tube. Then thread the cord through the rubber shield stop. Now tie a knot at the end of the cord. You may need to adjust the knot to make sure the shield is at or just below the window.



### STEP 7. INSTALL THE EXTERIOR DRIP CAP

It is critical to place the Drip Cap on top of the Shield Track as seen in the image. Place screws at each end and fill in evenly with remaining 3 pan head screws.



### STEP 8. ADDING WOOD SHIMS TO THE INTERIOR

Mark 7" down from the top of the window opening on each vertical side. Add a bead of caulk in a zig zag pattern and align top of shim with the 7" mark and flush with the vertical window edge. Tack into place with small nail or 5/16" staple to secure in place while performing the next step.



### STEP 9. INSTALL THE INTERIOR GLASS AND TRACK

Slide the plastic glass tracks onto each side of glass panel.

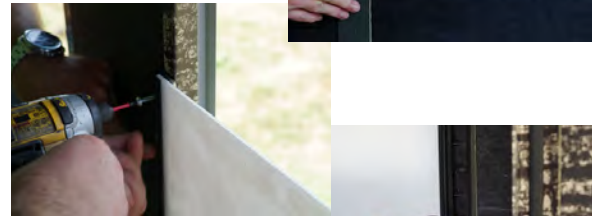

### STEP 10.

Hold the glass and tracks over the window opening, making sure it is even on both sides. Align top of track frame and glass with top of wood shim, centering side to side.

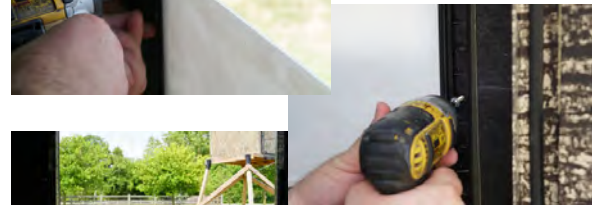

### STEP 11.

Using washer head screws, secure one track on the right side of the window (top and bottom). On the left side of the window, place 1 washer head screw in the top hole of the opposite track. Lower the glass to make sure it is level and will slide smoothly. Secure balance of screws, top, bottom, and middle.



### STEP 12.

Caulk around each window: upper horizontal and verticals.



# 10

## Secure the Carpeted OSB Floor to the Interior Floor Frame



Attach with (3) screws per side ensuring to catch the floor frame below the OSB for a secure fit.  
*Hint: Angle the screws at the Door panel 45 degrees.*

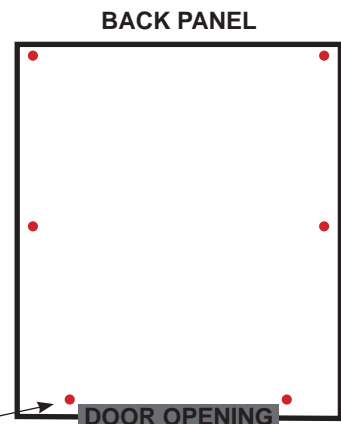

Screw locations in red

# 11

## Install Upper Shelf, Corner Shelf and Weapon Holder (MM46BGK only)

*Note: Interior panels are pre-drilled for the upper shelf and weapon holder.*



### Upper Shelf

Install (2) shelf brackets with pre-assembled anchors and screws into the holes in the back wall panel.

*Note: If you can't easily push in by hand then gently tap with a hammer.*

**Using the lowest setting on your drill, slowly drill in the screw until bracket is secure to the wall. Note: If you overtighten, the anchor will snap or blow out so please use care when installing the brackets.**

Position the long shelf over the brackets and secure as follows:

Outer most bracket holes - use 3/4" pan head screws.

Inner most bracket holes - use 1-1/2" brown screws.



### Corner Shelf with pre-attached floating bracket

Run a bead of clear silicone in a zig zag pattern along the metal edge that gets attached to the wall.



Place shelf along the back left corner so the bottom edge is approximately 14.5" above the floor. *Note: the floating bracket should be placed against the left side panel.*

Secure with (6) 3/4" pan head screws into the side and back panels. *Note: Floating bracket does not get secured to the shelf on the side panel.*

### Weapon Holder

Locate the predrilled holes in either side panel and insert the weapon holder with pre-installed anchors and screws.

**Using the lowest setting on your drill, slowly drill in the screws until it is secure to the wall. Note: If you overtighten, the anchor will snap or blow out so please use care when installing the weapon holder.**

**12****Attach the Door Handle** (Use the handle hardware polybag)

Insert the outside door handle through the pre-drilled hole in the door.

*Note: Handle should be perpendicular to the door.*

Attach with (2) 3/4" pan head screws included in the bag.

Insert interior handle onto stem in parallel position and tighten with a 1/8" allen wrench.

Close door and test the door for tightness. Adjust by moving the position of the interior handle on the stem.

*Note: Ensure the door is snug within the door opening to avoid rain from entering.*

**13****Caulk the Outside of the Blind**

Using the Clear caulk, apply to the following areas:

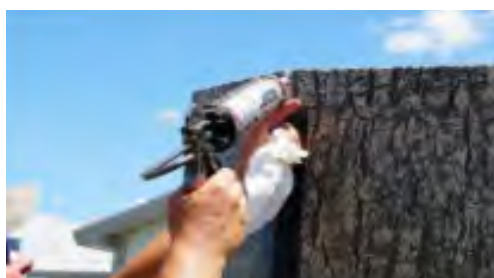

Vertical seams on the roof hem. *Hint: apply caulk and then wipe from bottom to top to be sure to seal the upper edge of the vertical seam opening.* Roof extrusion cover cap-caulk the vertical seams of the cover cap.

**14****Caulk the Interior of the Blind** (use black caulk)

Run a bead of black caulk around the upper interior perimeter where the roof meets the walls. Smooth with finger to seal the seam. Allow the caulk to dry based upon manufacturer's recommendation on tube.

## *Congratulations!*

You have completed the assembly of your Shadow Hunter kit blind. We wish you many years of enjoyment and success while hunting in the ultimate comfort of your new blind. Always remember to hunt safely and ethically.

### **NOTICE**

It is important that you follow the manufacturer's instructions and recommendations step by step. Failure to do so can affect the performance and life expectancy of the blind. The blind has been designed to give you years of performance, comfort and enjoyment. However if you do not follow the instructions exactly and in their entirety, if you modify any steps, or alter or omit any components you are creating unwanted risk for damage and therefore voiding the integrity of this product.



6714 Pointe Inverness Way, Suite 200  
Fort Wayne, IN 46804

[www.shadowhunterblinds.com](http://www.shadowhunterblinds.com)  
Customer Service: 888-446-4868