

EARNSHAW



MAINSRING

LONDON

INSTRUCTION
MANUAL



Vol.1.10 EN

MAINSRING

LONDON

**ASTRONOMY
OBSERVATORY
DUAL SLOT WINDER**

The enclosed device has been carefully manufactured and engineered to deliver a unique experience, to help deliver kinetic energy to your automatic timepiece.

With different settings, this dual watch winder will move your timepiece just the right amount and prevent it from stopping due to a lack of sufficient charge. This means your watch is ready to go as soon as it's on your wrist.

Designed to mimic the multiple axis rotations of a gyroscope, the winder is also a spectacle of movement and will serve as many hours of visual delight in operation, as it protects and preserves the life of your automatic mechanically powered timepiece.

For more details on operating this watch winder please refer to the enclosed booklet or visit :

IM.MAINSRING.STORE

WHAT'S INSIDE

Your Watch Winder comes packed with the following:

1. Double Watch Winder
2. Watch Pillow x 2pcs
3. USB Cable
4. Multi-Adapter

3 USB Cable



4 Multi-Adapter

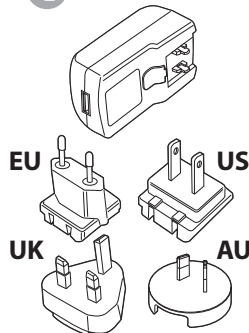

2

Watch Pillow



1 Double Watch Winder

INSTRUCTIONS

1. Carefully lift the glass protector bell off the base.
2. Place your watch on the enclosed watch pillow that will attach to the winder.

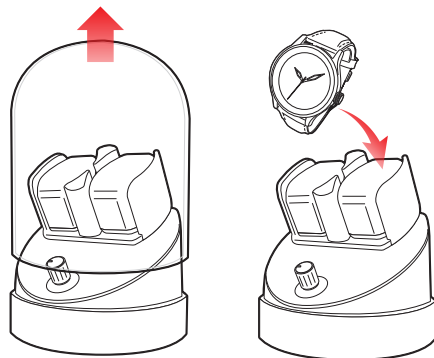

NOTE:

- * Please do not directly turn the turntable with hand at any time.
- * Please use power adapter after taking out the battery from battery case.
- * Please cut off power and stop the turntable before putting in or taking out the watches.
- * Please pull out power socket or take out battery if watch winder is not used for a long time.
- * Please do not place the product under sunshine or at wet places.

3. Connect the enclosed power adapter to the socket behind the device.

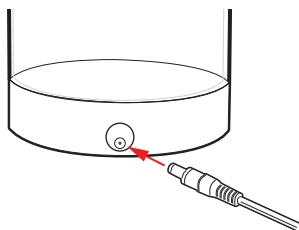

4. Plug the power adapter into a wall socket.

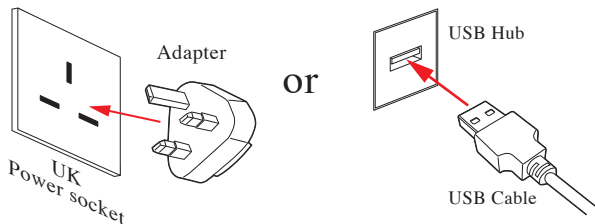

5. Power ON / OFF button.

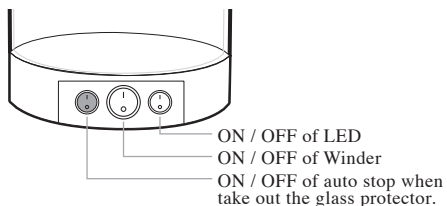

OPERATION MODES

Besides on and off, the Watch Winder has 4 different mode settings for your selection:

Mode 1:

2 minutes turning clockwise, rest 6 minutes, 8 minutes per cycle.

Mode 2:

2 minutes turning counter-clockwise, rest 6 minutes, 8 minutes per cycle.

Mode 3:

2 minutes turning clockwise, rest 6 minutes, 2 minutes turning counter-clockwise, rest 6 minutes, 16 minutes per cycle.

Mode 4:

5 minutes clockwise, 5 minutes counter-clockwise, recycle in 3 hours, rest 9 hours. 12 hours per cycle.

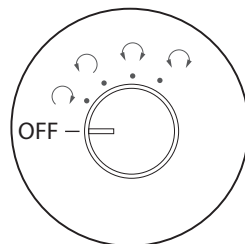

CARE AND MAINTENANCE

1. Please do not place your watch winder in direct sunlight or other heat sources such as radiators, electric heaters or stoves.
2. Your watch winder should be kept away from water and liquids.
3. Avoid placing your winder next to areas of excessive sand, dust or other objects that may vibrate, as this may also impact the functioning of your winder.
4. Please store your watch winder at room temperature.
5. When the watch winder is on, make sure there is nothing stopping or blocking it from turning.
6. Unplug your watch winder if not being used for a prolonged period of time.
7. Watch winders are not toys. We recommend that you store your winder carefully out of reach of children.
8. Your watch winder does not require any special maintenance. We recommend cleaning it regularly with a soft, damp cloth, then wiping it dry.



RECYCLING

Your watch winder, together with new or used batteries, must not be disposed of as household waste. These elements must be taken to a waste collection point that recycles electrical devices and batteries.

By ensuring these products are disposed of properly you can help prevent potentially harmful effects, both to the environment and human health. Recycling helps conserve natural resources. For further information on recycling this product please contact your local authority, waste collection site, or place of purchase.