

**KDE DIRECT 82XX SERIES COMPONENTS**  
**KDE8218XF-120 (HE)**



**KDE M10 PROPELLER ADAPTER ASSEMBLY**  
**102XX/82XX/72XX SERIES**  
**23MM EDITION, RH THREAD**

SOCKET HEAD CAP SCREWS  
M4 X 0.7 X 12MM (4)  
ALLOY-STEEL BLACK OXIDE, C12.9  
  
BLACK M10 ALLOY STEEL  
NYLON-INSERT LOCKNUT (1)



**KDE M8 PROPELLER ADAPTER ASSEMBLY**  
**82XX/72XX SERIES**  
**23MM EDITION, RH THREAD**

SOCKET HEAD CAP SCREWS  
M4 X 0.7 X 12MM (4)  
ALLOY-STEEL BLACK OXIDE, C12.9  
  
BLACK M8 ALLOY STEEL  
NYLON-INSERT LOCKNUT (1)



**KDE M10 PROPELLER SHAFT COVER ASSEMBLY**  
**102XX/82XX/72XX SERIES**  
**20MM EDITION, M3**

SOCKET HEAD CAP SCREWS  
M3 X 0.5 X 14MM (4)  
ALLOY-STEEL BLACK OXIDE, C12.9



**MOUNTING HARDWARE**

FLAT HEAD PHILLIPS MACHINE SCREWS  
M6 X 1.0 X 10MM (4)  
ALLOY-STEEL BLACK OXIDE, C12.9  
  
FLAT HEAD PHILLIPS MACHINE SCREWS  
M5 X 0.8 X 8MM (4)  
ALLOY-STEEL BLACK OXIDE, C12.9

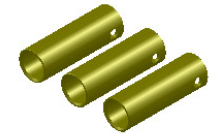

**4.0MM BULLET CONNECTORS**  
**24K, FEMALE SET (3)**

UNLESS OTHERWISE SPECIFIED:  
1. ALL DIMENSIONS APPLY BEFORE PLATING OR COATING.  
2. REMOVE ALL BURRS, BREAK SHARP EDGES .020 IN MAX.



TOLERANCES:  
X ± 0.040"  
XX ± 0.020"  
XXX ± 0.010"  
XXXX ± 0.005"  
ANGULAR ± 1°

DESIGNED KDE DIRECT  
DRAWN KDE DIRECT  
DATE XX/XX/XXXX

TITLE KDE DIRECT 82XX COMPONENTS

SIZE PART NO. C KDE82XX SERIES

REV. A

DO NOT SCALE DRAWING

SCALE: 4:1 SHEET 1 OF 1