

KDE DIRECT 72XX SERIES COMPONENTS

KDE7215XF-135

KDE7208XF-110 (HE)

KDE7208XF-135 (HE)



**KDE M8 PROPELLER ADAPTER ASSEMBLY
72XX SERIES
23MM EDITION, RH THREAD**

SOCKET HEAD CAP SCREWS
M4 X 0.7 X 12MM (4)
ALLOY-STEEL BLACK OXIDE, C12.9

BLACK M8 ALLOY STEEL
NYLON-INSERT LOCKNUT (1)

**KDE M8 PROPELLER ADAPTER ASSEMBLY
72XX SERIES
23MM EDITION, LH THREAD**

SOCKET HEAD CAP SCREWS
M4 X 0.7 X 12MM (4)
ALLOY-STEEL BLACK OXIDE, C12.9

BLACK M8 ALLOY STEEL
NYLON-INSERT LOCKNUT (1)

**KDE M10 PROPELLER SHAFT COVER ASSEMBLY
102XX/82XX/72XX SERIES
20MM EDITION, M3**

SOCKET HEAD CAP SCREWS
M3 X 0.5 X 14MM (4)
ALLOY-STEEL BLACK OXIDE, C12.9

MOUNTING HARDWARE

FLAT HEAD PHILLIPS MACHINE SCREWS
M5 X 0.8 X 8MM (4)
ALLOY-STEEL BLACK OXIDE, C12.9

FLAT HEAD PHILLIPS MACHINE SCREWS
M4 X 0.7 X 8MM (4)
ALLOY-STEEL BLACK OXIDE, C12.9

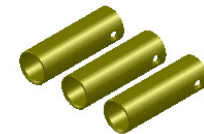

**4.0MM BULLET CONNECTORS
24K, FEMALE SET (3)**

UNLESS OTHERWISE SPECIFIED:
1. ALL DIMENSIONS APPLY BEFORE PLATING OR COATING.
2. REMOVE ALL BURRS, BREAK SHARP EDGES .020 IN MAX.

IMPERIAL

THIRD ANGLE PROJECTION



TOLERANCES:
X ± 0.040"
XX ± 0.020"
XXX ± 0.010"
XXXX ± 0.005"
ANGULAR ± 1°

DESIGNED	KDE DIRECT
DRAWN	KDE DIRECT
DATE	XX/XX/XXXX

TITLE: KDE DIRECT 72XX COMPONENTS

SIZE PART NO. **C KDE72XX SERIES**

REV. **A**

DO NOT SCALE DRAWING

SCALE: 4:1 SHEET 1 OF 1