

Safety Instructions

The following instructions are given to ensure your safety and prevent the loss of property. Read them thoroughly and ensure the product is correctly used.

Warning Indicates that violation of the instruction may cause death or serious human injury.

Caution Indicates that violation of the instruction may cause human injury or damage of property.

Product



Adjust the angle of a camera and check the recorded video after mounting the product: change of the mounting may change the angle of the camera.
If the product is mounted on any unsuitable place, recording may fail to run properly.



This product records driving video using a camera. The quality of video may be degraded in extreme situations, such as when the brightness changes rapidly, when entering or exiting a tunnel, or when the backlight is too strong, for example at noon, or when there is no light source, for example at midnight.



Do not use an excessive tint on the front window through solar control films that disturb clear video recording.
Some solar control films may cause the white-balance used in video recording to change.



When a product has been damaged or lost due to a big accident or a break in the power supply to the product, an accident video may not be recorded.



For the best video quality, keep the front window of your vehicle clean before commencing recording.



Foreign material (e.g., fingerprints) that stains on the black box lens may result in a negative impact on the recorded video. Keep the lens clean.

Product



The best operation temperature is 0~45°C.
Please keep the temperature in summer or winter to prevent any problem.



If the product is used or kept under 0°C or over 45°C, malfunction or failure of the product may occur.
Please pay attention to the temperature of the place where the product is stored.



Please ensure the product is kept out of direct sunlight and do not leave the product in the sealed vehicle.
It may cause failure of the product.



Do not use the product in a place where the temperature and/or humidity is too high.
If the product is made wet by rain or a beverage-spill, causing irreversible damage, the user is liable for any damage caused.

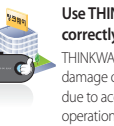

Use THINKWARE-sold articles correctly.
THINKWARE is not liable for any product damage or personal injuries that occur due to accidents or the incorrect use or operation of this product

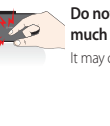

Do not press the buttons with too much pressure.
It may cause failure of the product.



Do not clean the product using chemicals or detergent.
Just softly clean it with a cloth.



Keep the product out of reach from children or pets for their safety.
Otherwise, they may be seriously wounded.

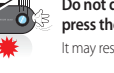

Do not drop the product nor disassemble without any direction of THINKWARE. Do not press the Reset button with anything sharp.
It may result damage or failure of the product.

Product



Do not touch the cigar jack cable power cable with wet hands.
This may result in electrical shock.



Insert the cigar jack cable until it is stable.
Unstable connection may result in fire.



Do not use any damaged cigar jack cable.
This may result in fire or electric shock.



Do not bend, pull, or press the cigar jack cable with an excessive power or anything heavy.
This may result in fire or electric shock.



Do not place the product or the cigar jack power cable near to the heat apparatus.
This may result in fire or electric shock.

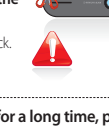

Do not remodel or cut the cigar jack cable.
This may result in damage to the product or vehicle. The user is liable for any damage caused to the product or vehicle by the failure to observe the above warning.

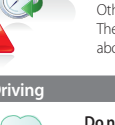

If the product is not be used for a long time, please detach the cigar jack cable from the product.
Otherwise, the vehicle battery may be discharged or fire may occur. The user is liable for any damage caused to the product or vehicle by the failure to observe the above warning.

Driving

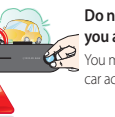

Do not operate the product while you are driving.
You may be distracted, resulting in a car accident.



Do not install the product in a location that hinders your driving or road-visibility.
This may result in an accident.

Components

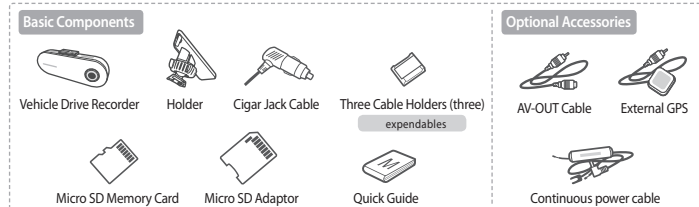

Part Names

The images presented here may be different from the product. (For the purpose of the improvement of the performance of quality of the product, the parts may be changed without any prior notice.)

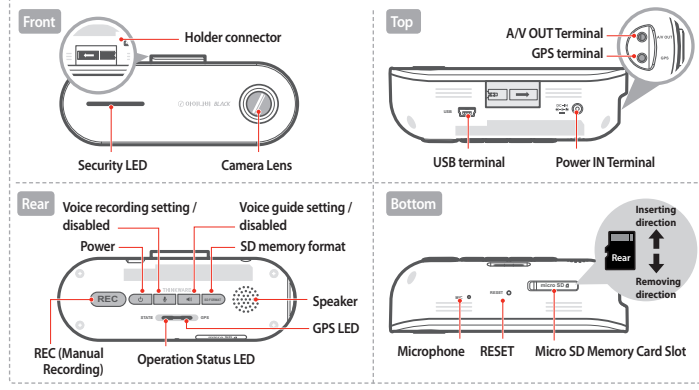

How to Install the Product

1. By adjusting the grooves on the holder-connector, connect it the black box.
Slide the holder onto the wider groove of the black box's holder connector (A) and push it to (B) until it 'clicks' and firmly fits in.

2. Remove a film from the double-sided tape and attach one side to the holder. Attach the holder to a location that does not hinder your driving or outside visibility.
We recommend that you install the black box behind the rearview mirror. Select a location that allows for easy button control. Wipe all foreign material and moisture from the surface to which the double-sided tape will be attached using a soft and dry cloth.

Checking camera recording direction

1. Using [Black Box Live View] through interworking with iNAVI navigation
2. Checking the recorded video through the PC Viewer

3. Adjust the body to a proper angle and fix it by tightening the screw of the holder.
If you do not tighten the screw of the holder, the video may not be recorded properly due to the rocking of the body or other causes

4. Remove the camera lens protection file.
If the film is not removed, the quality of recorded video will be degraded. Be careful not to stain the lens with fingerprints.

5. Connect the power cable (cigar jack cable) and organize the cable using the cable holders.
Please, install it apart from navigation more than 20cm. (Receiving rate may be down in some of places where DMB and GPS sensitivity is low.)

- For the best video quality, keep the front window of your vehicle clean before starting recording.
- Foreign material (e.g., fingerprints) that stains the black box lens may result in a negative impact on the recorded video. Keep the lens clean.

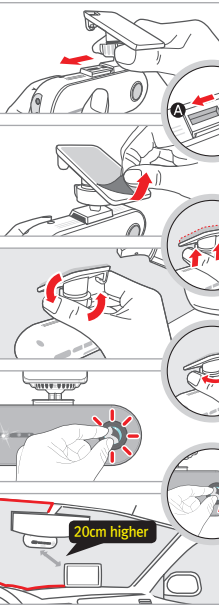

Recording while Driving

Continuous Recording

All videos are recorded in interval of one-minute and saved in the Continuous Recording Folder

Starts the continuous recording



Event Recording

When the impact of which strength exceeds the user-specified strength, the black box records scenes for 20 seconds; from 10 seconds before the event (impact) has occurred to 10 seconds after that and automatically saves the video in the Event Recording Folder.

(Ring) the buzzer sounds



Setting Parking Mode

Auto parking mode (default setting)

When the vehicle power is turned off, the mode is automatically changed to the Parking Mode with voice guidance.

Manual Parking Mode

Press the REC (REC) button (for more than 3 seconds) to change to the Parking Mode with voice guidance.

- You need the PC Viewer and Live View configuration. (The default setting is the Auto Parking Mode)
- To change to Auto Parking mode is available, you should use our retail continuous power cable. (If the cable is not our retail continuous power cable, the product may malfunction.)
- It takes about 30 seconds to switch to the Auto Parking Mode, however, the mode may not be switched to the Auto Parking Mode to prevent battery discharge.

Recording while parking

When any motion or impact or motion is detected within the recording scope of the black box, the operation status LED (LED) lights on in red.

Event detection recording

Event detection recording: Records scenes for 20 seconds, from 10 seconds before the event has been detected to 10 seconds after and saves in the Event recording folder.

Motion detection recording

Records scenes for 20 seconds, from 10 seconds before the motion has been detected to 10 seconds after and saves in the Motion Recording Folder.



The product quality assurance shall be in accordance with the product warranty. The purchaser shall keep the purchase date for future evidence of purchase and future reference, since the warranty period is calculated based on the purchase date.

For details on the warranty, see "Consumer Damage Compensation Rule".

All replaced products shall be new products or products having similar functions.

THINKWARE is not liable for the repair, replacement, or refund of any product until the customer returns the defected product to THINKWARE. This warranty shall not be re-issued. Please keep this warranty. (The serial number is not re-issued.)

The product that THINKWARE has not authorized cannot be supported with any kind of THINKWARE services (beware of imitations.)

In the case of malfunction originated in normal operating conditions by product's performance or functions within the term of components possession	Consumer Damage Type		Under Warranty	After Warranty	
			A/S	A/S	
	In the case of essential repair being required within 10 days after the purchase		The product is exchanged with new one or the price is refunded.	N/A	
	In the case of essential repair being required within 1 month after the purchase		The product is exchanged with new one.		
	In the case of essential repair of the exchanged product being required within 1 month after the exchange		The product is exchanged with new one or the price is refunded.		
	When exchange is unavailable		The price is refunded		
	When repair is available	When any defect occurs	Free repair	Charged repair or charged product change	
		In the case of malfunction originated up to 3 times by same defect	The product is exchanged with new one or the price is refunded		
		In the case of malfunction originated more than 4 times by same defect			

Light on

When the recording file is created based on the recording start time, up to 100 recording files can be created in one date/time-based folder. If the file size exceeds the micro SD card capacity, the oldest file or folder is deleted sequentially and creates new date/time folder and recording file.



-

► The product shall not be used for purposes other than its intended purpose, nor shall be arbitrarily changed. Under the Privacy Act and other relevant laws, the user shall hold the sole responsibility for recording other person's voice using this recording function.

- When an upgrade file exists in the micro SD card, an upgrade can be carried out.
 - After completing the upgrade, the program automatically restarts.

- 1 A vehicle cigar jack cable is provided along with our black box as a default component. A continuous power cable (optional) is up to the user.
- 2 We recommend you to let a specialist install and mount our INAVI black box at our official INAVI retail shop or agency.
(See the INAVI home page for the official retail shops and agencies.)
- 3 If you need to mount or remove your black box, you can get our help at our official INAVI retail shop only when you have installed it at the official INAVI retail shop. We do not provide any support for installation or mounting of the black box.

- 1 Insert the micro SD memory card into the micro SD card reader by placing it in with the top of the card upwards and connect to the PC.















































































































- [Recommended Specifications for PC Viewer]**
Operating System (OS) Windows XP (32-bit), Windows Vista (32-bit), Window 7 (32/64-bit) Pentium 4 / 2.8GHz or higher / RAM 1G or higher Disk Space of HDD 4GB / DirectX 9.0 or higher Microsoft Internet Explorer version 7.0 or higher

- 3 Open a Drive (▲)**
- Select the removable storage device of the micro SD card connected to the PC and select OK.

-

4 The recording folders and files saved in the selected drive are listed up in the File List. In the File List, select a desired file, and then double-click it on the list or click the Play icon to play the file.

do our best for customer satisfaction with the direct-operated service center.

- | | |
|------------------------|---|
| Gangnam Center | # 311 and 312 (Floor 3), Ga-dong Keumkwan, Seoul Auto Gallery, 217, Yangjae-Dong, Seocho-gu, Seoul, Korea |
| Gangbook Center | A-2, Gwangjang Floor, New Building ETLAND, 16-9, Hangangno 3-ga, Yongsan-gu, Seoul, Korea |
| Gangdong Center | 546-4, Sales Building 5th Floor, Techno Mart, Guui 3-dong, Gwangjin-gu, Seoul, Korea |
| Gwangju Center | 987-1, 3rd Floor, Pungam Building, Pungam-dong, Seo-gu, Gwangju, Korea |
| Daegu Center | 753-1, 2nd Floor, Hwanggeum 1-dong, Suseong-gu, Daegu, Korea |
| Daejeon Center | 10-11, 2nd Floor, Doowon Building, Yongjeon-dong, Dong-gu, Daejeon, Korea |
| Busan Center | 686-4, 2nd Floor, Soojeong Building, Yeonsan 1-dong, Yeonje-gu, Busan, Korea |
| Suwon Center | F-245, 980-3, Digital Empire B/D, Yeongtong 2-dong, Yeongtong-gu, Suwon-si, Gyeonggi-do, Korea |
| Incheon Center | #404 5th Floor, Bucheon Terminal sopooong, Sang 2-dong, Wonmi-gu, Bucheon-si, Gyeonggi-do, Korea |

- **Customer Center (1577-4242)**
 - Business Hour - Weekdays: 9 a.m.~ 6 p.m.
 - Holidays and Weekends (Saturday and Sunday)
- **Service center**
 - Business Hour - Weekdays: 9 a.m.~ 6 p.m./ Saturday: 9 a.m.~ 1 p.m.
 - Holidays - Holidays and Sunday, 1st and 3rd Sunday each month
- **A/S - customer visiting or parcel service**

- ※ The business hour of Gangdong Center is Weekday (10 a.m. ~7 p.m.) and Saturday (10 a.m.~2 p.m.). The holidays are same with others.

This product is the vehicle drive recorder (VDR) that records the driving video of a car.

- ▶ According to the driving conditions, vehicle type, and navigation environments, some functions may not be supported. Functional support related to firmware updates for more reliable and advanced quality may vary by product. In addition, please use this apparatus as a reference to check the driving video since the video recording function may not work in some environments or conditions.
- ▶ This product does not guarantee that it records all videos at accident and an accident, that is caused by impact not big enough to trigger the impact sensor (G-SENSOR) may not be identified as event video and consequently be not recorded.

This Quick Guide provides the most basic description to use our Black Clair2. For more detailed description, download and refer to the User Manual from iNAVI Homepage (www.inavi.com).

Register Your Device Now!  <http://www.inavi.com/>

To register your device, go to www.inavi.com.

Find the serial number required for registering your product at the sticker on the rear of the product or the Product Warranty of the Quick Guide and then register your product on iNAVI Homepage. Only registered users have access to a full range of customer support and after-sale service sales support. (Any user who has not registered his/her product must have the product warranty with the purchase date to access any type of support from iNAVI.)