



AgraStrip® Pro Allergen Quick Guide

AgraStrip® Pro Allergen LFD Kits include:

- 15 AgraStrip® Pro lateral flow devices
- 1 bottle of ready-to-use extraction buffer
- 15 extraction tubes and caps
- 15 incubation vials
- 15 swabs with break-off tips
- 1 rack for incubation vials

Test procedures for:

- Raw materials/processed food
- Rinse waters
- Swab samples

Available kits:

• AgraStrip® Pro Almond	10007055	• AgraStrip® Pro Lupin	10007064
• AgraStrip® Pro β-Lactoglobulin	10007056	• AgraStrip® Pro Macademia	10007065
• AgraStrip® Pro Brazil nut	10007057	• AgraStrip® Pro Milk	10007066
• AgraStrip® Pro Casein	10007058	• AgraStrip® Mustard	10007067
• AgraStrip® Pro Cashew/Pistachio	10007059	• AgraStrip® Pro Peanut	10007068
• AgraStrip® Pro Coconut	10007060	• AgraStrip® Pro Sesame	10007069
• AgraStrip® Pro Crustacea	10007061	• AgraStrip® Pro Soy	10007070
• AgraStrip® Pro Gluten*	10007062	• AgraStrip® Pro Walnut	10007071
• AgraStrip® Pro Hazelnut	10007063	• AgraStrip® Pro Whole Egg	10007072



Also Available:

- AgraQuant® Allergen ELISA Test kits
- AgraQuant® Plus Allergen ELISA Test kits

* AgraStrip® Pro Gluten requires an additional dilution step prior to the transfer of the extract into the incubation vial (step 3). Please, refer to the product manual.



AgraStrip® Pro Allergen Quick Guide

Procedure for liquid and solid samples



1 Add **0.2 mL** liquid sample (or rinse water), or weigh in **0.2 g** of homogenised sample into the extraction tube. Fill with **extraction buffer** to the level shown in the picture.

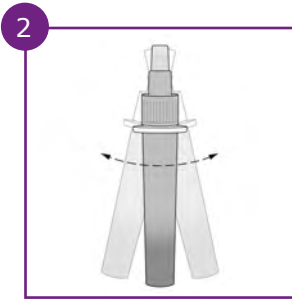

2 Close the tube with the cap and vigorously shake by hand for **1 minute**. You can squeeze the tube to help suspend the sample.

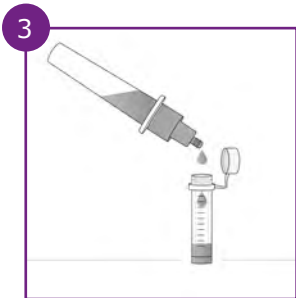

3 Remove the smaller cap to open the dropper tip and transfer **6 drops (200 µL)** into an incubation vial. Close the lid of the vial.

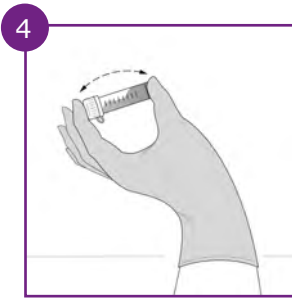

4 Shake the incubation vial vigorously by hand for **15 seconds**. Make sure that the liquid comes into contact with the lid of the vial.

Procedure for environmental swabs

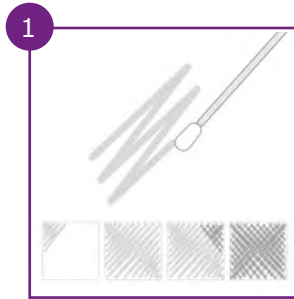

1 Fill one extraction tube with extraction buffer up to the neck of the tube (see step 1 for solid/liquid samples). Wet a swab by dipping it into the buffer. Wipe an area of 5 x 5 cm using side-to-side movements, rotating the swab tip as you go.

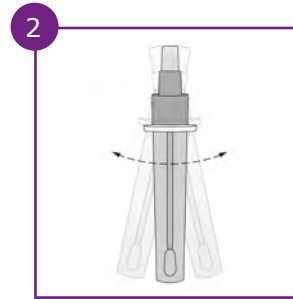

2 Place the swab into the extraction tube and carefully break off the end at the pre-scored point. Close the tube with a cap and shake vigorously for **1 minute**.

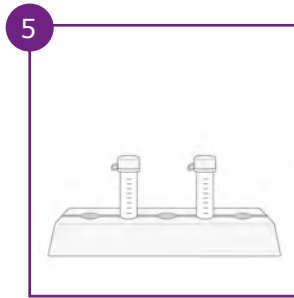

5 Tap the base of the vial onto a surface to ensure that no liquid is remaining in the lid. Let it incubate on the rack at room temperature for **5 minutes**.

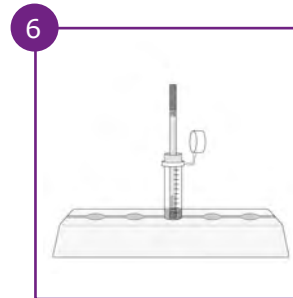

6 Place one test strip vertically (arrows pointing downwards) into the incubation vial. Incubate for **5 minutes**. **Read the result immediately**.

Result Interpretation

Negative Result:

Only the control band (C) appears in the results area of the test strip

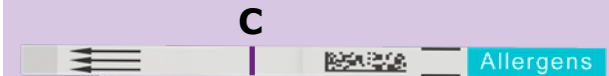

Positive Result:

The control band (C) and the test band (T) appear in the results area of the test strip. The sample could contain the target allergen in a concentration higher than the cut-off value and further investigations should be performed (e.g. using AgraQuant® Allergen ELISA kits).

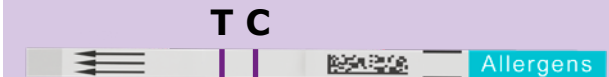

Invalid Result:

No control band appears. Regardless of whether the test line appears, please repeat the test with a fresh strip.

* Cut-off values must be validated for each matrix.

For more information, please contact us on **02 9882 3666** or at scientific.enquiries@amsl.com.au

amslscientific.com.au