

Mecca Bathroom Accessories

Versions:202311

Finish



Chrome



Gun Metal



Brushed Bronze



Brushed Nickel



Matte Black



Brushed Gold



Matte White

Mecca Bathroom Accessories

ROBE HOOK

NR1982CH / NR1982MB / NR1982BN
NR1982GM / NR1982BG / NR1982BZ
NR1982MW

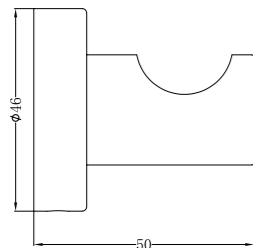

TOILET ROLL HOLDER

NR1986CH / NR1986MB / NR1986BN
NR1986GM / NR1986BG / NR1986BZ
NR1986MW

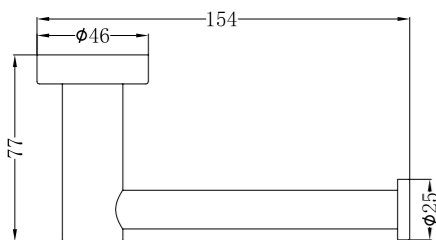

HAND TOWEL RAIL

NR1980aCH / NR1980aMB / NR1980aBN
NR1980aGM / NR1980aBG / NR1980aBZ
NR1980aMW

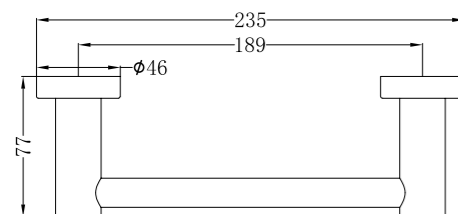

HAND TOWEL RING

NR1980CH / NR1980MB / NR1980BN
NR1980GM / NR1980BG / NR1980BZ
NR1980MW

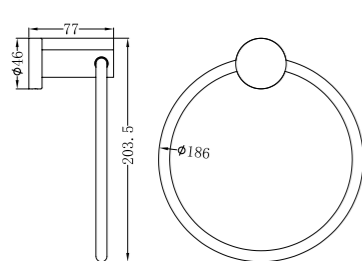

METAL SHOWER SHELF

NR1987aCH / NR1987aMB / NR1987aBN
NR1987aGM / NR1987aBG / NR1987aBZ
NR1987aMW

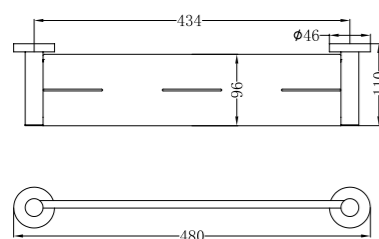

SINGLE TOWEL RAIL 600MM

NR1924CH / NR1924MB / NR1924BN
NR1924GM / NR1924BG / NR1924BZ
NR1924MW

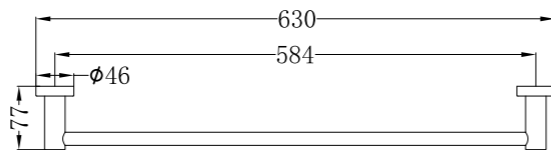

DOUBLE TOWEL RAIL 600MM

NR1924dCH / NR1924dMB / NR1924dBN
NR1924dGM / NR1924dBG / NR1924dBZ
NR1924dMW

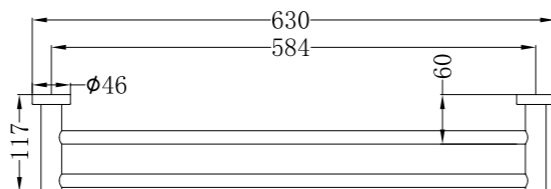

SINGLE TOWEL RAIL 800MM

NR1930CH / NR1930MB / NR1930BN
NR1930GM / NR1930BG / NR1930BZ
NR1930MW

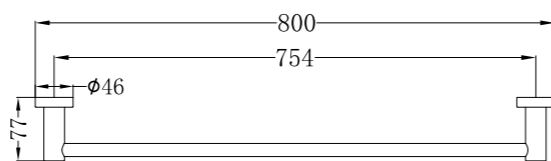

DOUBLE TOWEL RAIL 800MM

NR1930dCH / NR1930dMB / NR1930dBN
NR1930dGM / NR1930dBG / NR1930dBZ
NR1930dMW

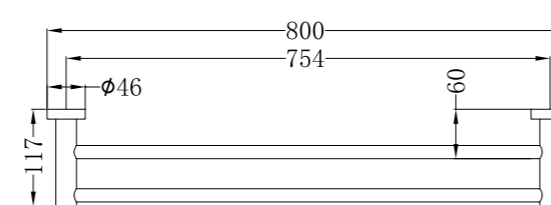

TOWEL RACK

NR1989CH / NR1989MB / NR1989BN
NR1989GM / NR1989BG / NR1989BZ
NR1989MW

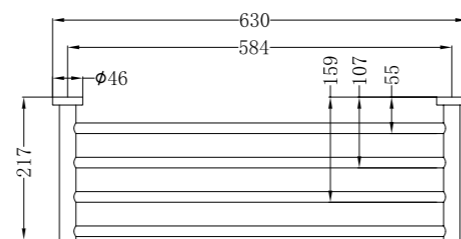

TOILET BRUSH HOLDER

NR1988CH / NR1988MB / NR1988BN / NR1988GM
NR1988BG / NR1988BZ / NR1988MW

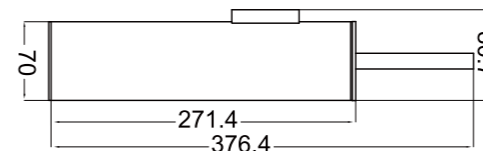

ROBE HOOK II

NR1982aCH / NR1982aMB / NR1982aBN / NR1982aGM
NR1982aBG / NR1982aBZ / NR1982aMW

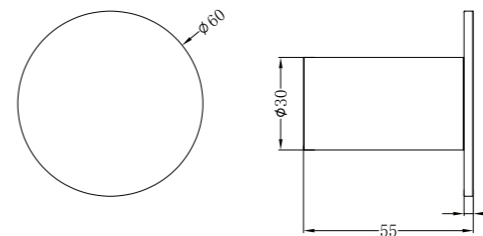

DOUBLE TOILET ROLL HOLDER

NR1986dCH / NR1986dMB / NR1986dBN
NR1986dGM / NR1986dBG / NR1986dBZ
NR1986dMW

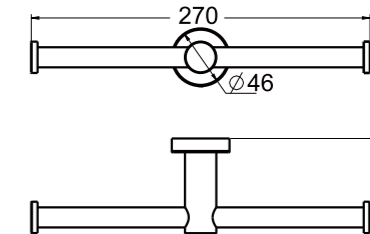

SOAP BOTTLE HOLDER

NR1985CH / NR1985MB / NR1985BN
NR1985GM / NR1985BG / NR1985BZ
NR1985MW

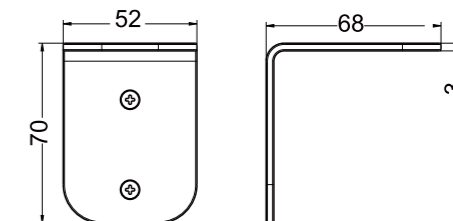

Installation Instruction

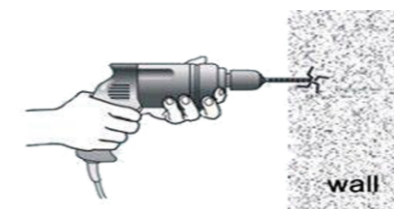

1. Put the fixing blocks (piece) over on the right place on the wall, and stay level, use marking pen through the holes of fixing block to mark out fixing spots on the wall. Then drill holes by electric hand drill with 6mm drilling bit on the spots.

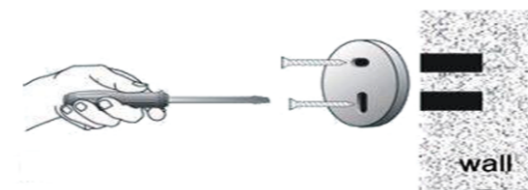

3. Put fixing block cover on the holes and fix firmly by expansion screws.

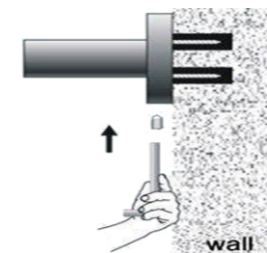

5. Screw grub screws into the base, make it against to the fixing block tight and firm.

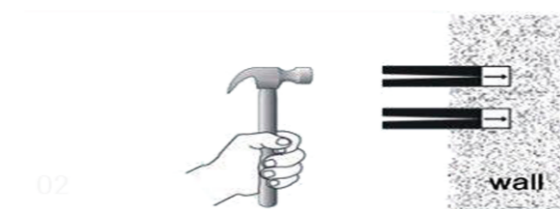

2. Put the expansion plugs into the wall by hammer.

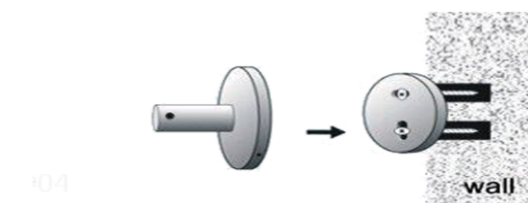

4. Put the base of bathroom accessory cover on the fixing blocks.

Nero

info@nerotapware.com.au
nerotapware.com.au

11-13 Buontempo Road
Carrum Downs Vic 3201

