

Oliveri®

## FILTER CHANGE INSTRUCTIONS

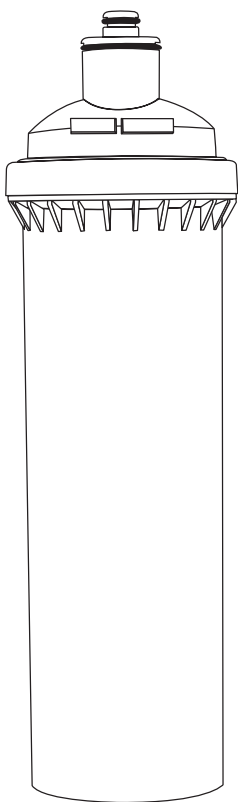

INLINE SYSTEM

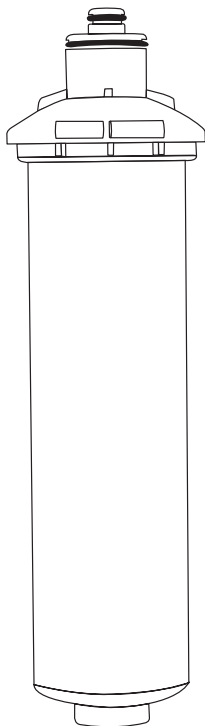

SATELLITE SYSTEM

Oliveri®

[oliveri.com.au](http://oliveri.com.au)

# FILTER CHANGE INSTRUCTIONS

## Cartridge Removal

- 1 It is advisable to turn the cold water off at the mains and at the undersink isolation valve.

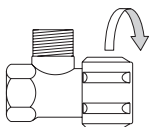

- 2 Turn ON tap to release pressure from Filter System.

3

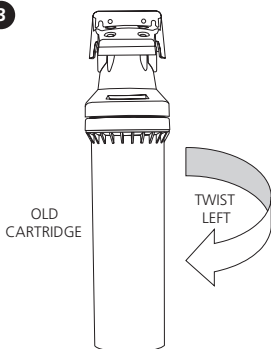

4

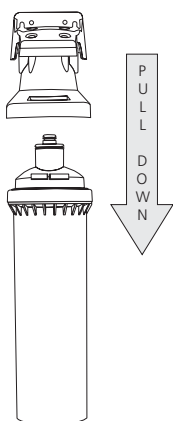

- 5 Dispose of used filter cartridge thoughtfully

## Cartridge Replacement

1

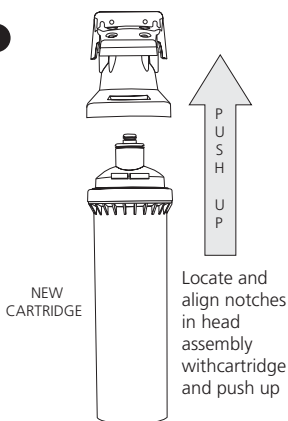

2

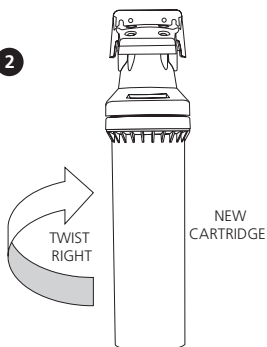

- 3 Turn ON water supply at mains and isolation valve.

- 4 Leave tap ON. Let water run for **2-3 minutes** to purge air from Filter System.



- 5 Turn tap OFF and check for leaks

- 6 Discard old alarm monitor and activate new alarm monitor (see inside monitor for instructions)

**NOTE** – Flushing the filter cartridge is important to remove air from the system and any loose carbon powder. At first the water may appear cloudy due to compressed trapped air in the filter and hoses. However the cloudiness will disappear over time and with use.