

Note 1: Please read Instructions **CAREFULLY** before assembly.

Note 2: Retain this manual for future reference.

Note 3: IF ANY, additional pieces such as Kit/Bracket check further instructions

Note 4: SOME PARTS COME WITH **PRE-INSTALLED,** OPEN-LOOSEN-TIGHTEND FOR **FINAL ASSEMBLY**

Note 5: If you have any questions or concerns you may contact our customer service department.

info@roofrackrail.com

Text/Whatsapp

+1 470-970-0596



ROOF RAIL Instructions

PLUS

S E R I E S



BRACK

1 You'll have a total of four pieces of foot to insert to each end of the roof side rails.

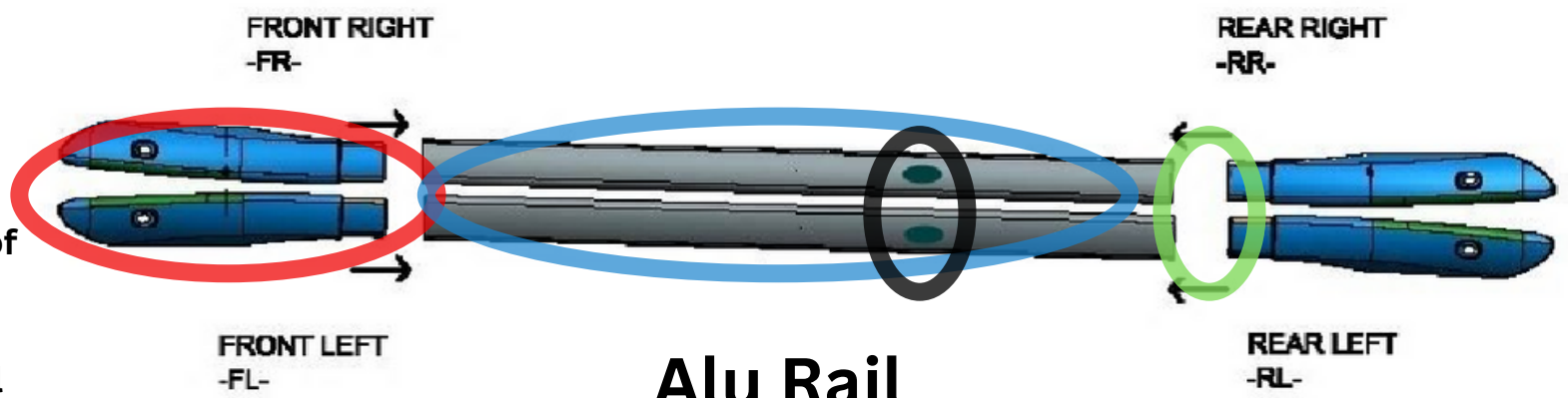

2 You'll have a total of two aluminum roof side rail pieces.

3 Please insert each foot to the end of the side rails as it is shown above

4 Middle foot comes as assembled so you will not need any actions in this step

5 If it comes as **assembled** you will start from this step

Foot



Foot

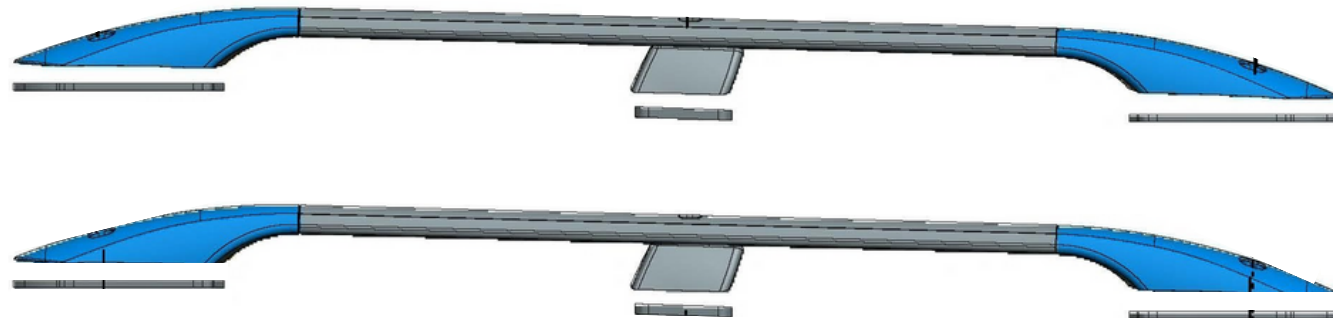

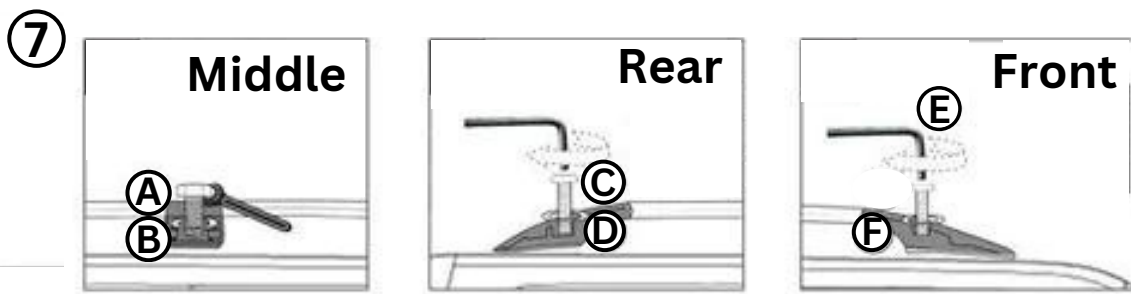
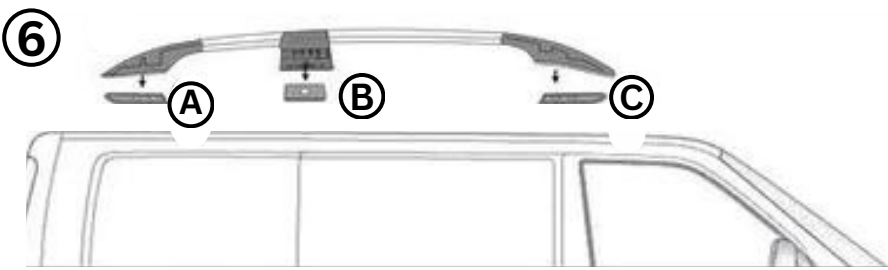

(A) **(B)** **(C)** Install the connecting components at each connection point.

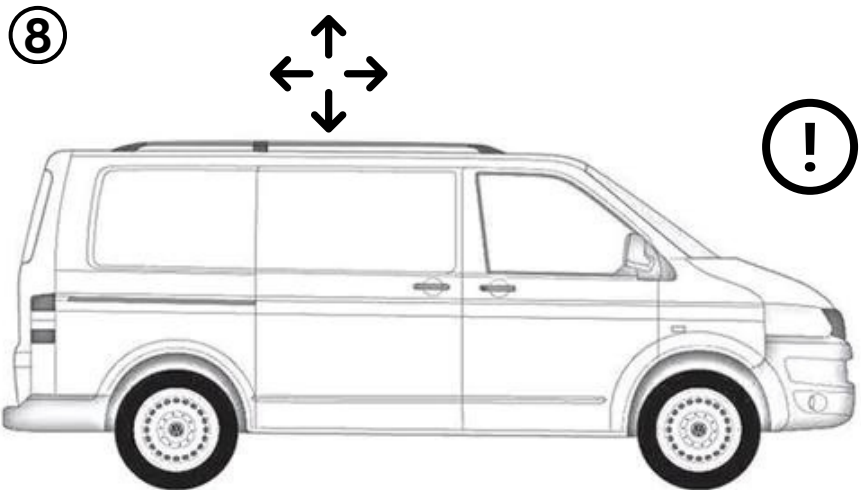

(A) Please verify that the side roof rail is both steady and firmly in place.

(B) To confirm its stability, gently wiggle the side rail from both sides.

Once the connection parts are in place, proceed to fasten each section of the foot securely.

- (A)** To tighten up the rail, please screw in the bolts/nuts securely using the allen wrench tool.
- (B)** Connection Point
- (C)** To tighten up the rail, please screw in the bolts/nuts securely using the allen wrench tool.
- (D)** Connection Point
- (E)** To tighten up the rail, please screw in the bolts/nuts securely using the allen wrench tool.

(F) Connection Point

