



# User Manual

18V CORDLESS STRING TRIMMER

BBT-YOM02



+1 833 635 0955 [support@babytechnical.com](mailto:support@babytechnical.com)

 Read all safety rules and instructions carefully before operating this tool.

# CONTENTS

Contents .....	2
Symbols .....	3
Safety warnings .....	4-8
Machine information .....	8
Assembly .....	9-12
Operation .....	12-14
Maintenance .....	14
Warranty .....	15

# SYMBOLS



Please read all of the safety and operating instructions carefully before using this Cordless Drill. Please pay particular attention to all sections of this User Guide that carry warning symbols and notices.

	Observe caution and safety notes!		Dispose of packaging and appliance in an environmentally friendly way!
	Caution - electric shock! Danger to life!		Attention! The blade continues to turn after releasing the switch
$n_0$	No-load speed		The cutting diameter is 260 mm
$V \sim$	AC Voltage		Guaranteed sound power level 96dB
	Wear hearing protection, dust protection mask, protective glasses and protective gloves, heavy footwear		Charge and store only at temperatures between 3° C and 40° C. Do not throw it into the water. Charge the battery fully before storage
	Keep children away from electrical power tools!		Protect the battery from temperatures above 50 ° C
	Check that the device, mains lead and plug are in good condition!		Protect the battery from water and moisture
	Safety class II		Protect the battery from heat and fire

# SAFETY WARNINGS

## GENERAL POWER TOOL SAFETY WARNINGS



**WARNING!** Read all safety warnings and all instructions. Failure to follow the warning and instructions may result in electric shock, fire or serious injury.

Save all warnings and instructions for future reference.

The term “power tool” in the warnings refers to your mains-operated (corded) power tool or battery-operated (cordless) power tool.

### 1) Work area safety

- Keep the work area clean and well lit. Cluttered or dark areas invite accidents.
- Do not operate power tools in explosive atmospheres, such as in the presence of flammable liquids, gases or dust. Power tools create sparks which may ignite the dust or fumes.
- Keep children and bystanders away while operating a power tool. Distractions can cause you to lose control.

### 2) Electrical safety

- Power tool plugs must match the outlet. Never modify the plug in any way. Do not use any adapter plugs with earthed (grounded) power tools. Unmodified plugs and matching outlets will reduce the risk of electric shock.
- Avoid body contact with earthed or grounded surfaces, such as pipes, radiators, ranges and refrigerators. There is an increased risk of electric shock if your body is earthed or grounded.
- Do not expose power tools to rain or wet conditions. Water entering a power tool will increase the risk of electric shock.
- Do not abuse the cord. Never use the cord for carrying, pulling or unplugging the power tool. Keep cord away from heat, oil, sharp edges or moving parts. Damaged or entangled cords increase the risk of electric shock.
- When operating a power tool outdoors, use an extension cord suitable for outdoor use. Use of a cord suitable for outdoor use reduces the risk of electric shock.
- If operating a power tool in a damp location is unavoidable, use a residual current device (RCD) protected supply. The use of an RCD reduces the risk of electric shock.

### 3) Personal safety

- Stay alert, watch what you are doing and use common sense when operating a power tool. Do not use a power tool while you are tired or under the influence of drugs, alcohol or medication. A moment of inattention while operating power tools may result in serious personal injury.
- Use personal protective equipment. Always wear eye protection. Protective equipment such as dust mask, non-skid safety shoes, hard hat, or hearing protection used for appropriate conditions will reduce personal injuries.
- Prevent unintentional starting. Ensure the switch is in the off-position before connecting to power source or battery pack, picking up or carrying the tool. Carrying power tools with your finger on the switch or energizing power tools that have the switch on invites accidents.
- Remove any adjusting key or wrench before turning the power tool on. A wrench or a key left attached to a rotating part of the power tool may result in personal injury.
- Do not overreach. Keep proper footing and balance at all times. This enables better control of the power tool in unexpected situations.
- Dress properly. Do not wear loose clothing or jewelry. Keep your hair, clothing and gloves away from moving parts. Loose clothes, The jewelry or long hair can be caught in moving parts.
- If devices are provided for the connection of dust extraction and collection facilities, ensure these are connected and properly used. The use of dust-collection can reduce dust, related hazards.

### 4) Power tool use and care

- Do not force the power tool. Use the correct power tool for your application. The correct power tool will do the job better and safer at the rate for which it was designed.
- Do not use the power tool if the switch does not turn it on and off. Any power tool that cannot be controlled with the switch is dangerous and must be repaired.
- Disconnect the plug from the power source and/or the battery pack from the power tool before making any adjustments, changing accessories, or storing power tools. Such preventive safety measures reduce the risk of starting the power tool accidentally.
- Store idle power tools out of the reach of children and do not allow persons unfamiliar with the power tool or these instructions to operate the power tool. Power tools are dangerous in the hands of untrained users.
- Maintain power tools. Check for misalignment or binding of moving parts, breakage of parts and any other condition that may affect the power tool's operation. If damaged, have the power tool repaired before use. Many accidents are caused by poorly maintained power tools.
- Keep cutting tools sharp and clean. Properly maintained cutting tools with sharp cutting edges are less likely to bind and are easier to control.
- The use of the power tool, accessories and tool bits, etc. in accordance with these instructions, taking into account the working conditions and the work to be performed. Use of the power tool for operations different from those intended could result in a hazardous situation.

## 5) Battery tool use and care

- Recharge only with the charger specified by the manufacturer. A charger that is suitable for one type of battery pack may create a risk of fire when used with another battery pack.
- Only use power tools with specifically designated battery packs. Use of any other battery packs may create a risk of injury and fire.
- When the battery pack is not in use, keep it away from other metal objects, like paper clips, coins, keys, nails, screws or other small metal objects that can make a connection from one terminal to another. Shorting the battery terminals together may cause burns or a fire.
- Under abusive conditions, liquid may be ejected from the battery; avoid contact. If contact accidentally occurs, flush with water. If liquid contacts eyes, additionally seek medical help. Liquid ejected from the battery may cause irritation or burns.
- Do not use a battery pack or tool that is damaged or modified. Damaged or modified batteries may exhibit unpredictable behaviour resulting in fire, explosion or risk of injury.
- Do not expose a battery pack or tool to fire or excessive temperature. Exposure to fire or temperature above 130 °C may cause explosion. NOTE The temperature „130 °C“ can be replaced by the temperature „265 °F“.
- Follow all charging instructions and do not charge the battery pack or tool outside the temperature range specified in the instructions. Charging improperly or at temperatures outside the specified range may damage the battery and increase the risk of fire.

## 6) Service

- Have your power tool serviced by a qualified repair person using only identical replacement parts. This will ensure that the safety of the power tool is maintained.
- Never service damaged battery packs. Service of battery packs should only be performed by the manufacturer or authorized service providers.

## SAFETY WARNINGS FOR STRING TRIMMER OPERATIONS



Read all safety warnings and all instructions. Failure to follow the warnings and instructions may result in electric shock, fire or serious injury.



**WARNING!**

- Improper handling of the string trimmer can lead to injury.
- Check the string trimmer before use for any damage.

- Never use the string trimmer with damaged or missing protective cover. Note that after you switch off the string trimmer, the cutting head and blades continue rotating for a few seconds. After a few seconds, wait until the cutter stops completely before you transport, maintain or store the string trimmer.
- Keep all parts of the body away from the cutter blades. Do not remove cut material or hold material to be cut when blades are moving. Make sure the switch is off when clearing jammed material. A moment of inattention while operating the string trimmer may result in serious personal injury.
- Carry the string trimmer by the handles, with the blades stopped. Proper handling of the string trimmer will reduce possible personal injury from the cutter blades.
- Hold the string trimmer by insulated gripping surfaces only, because the cutter blade may contact hidden wiring. Cutter blades contacting a "live" wire may make exposed metal parts of the power tool "live" and could give the operator an electric shock.

#### NOTE! - Risk of damage!

- Do not expose to rain. Do not cut wet grass.
- Improper handling of the string trimmer can lead to damage to the string trimmer.
- Do not attempt to cut hard objects.
- Use the edging guide as well as the blade guard to avoid unnecessary wear on the blades and tool.

## BATTERY PACK AND CHARGER SAFETY INSTRUCTIONS



If under extreme conditions any electrolyte should escape from the battery, it's essential to avoid contact with skin. If electrolyte does come into contact with your skin, rinse it off with water. In the event of electrolyte contact with your eyes, it's essential to consult a doctor.

- Before the use of the charger and the battery pack, read the instruction manual for it carefully.
- During the charging process, the current used should correspond to the current of the battery charger.
- Never let moisture, rain or splashed water reach the charging location. The ambient temperature must not be less than 0°C nor exceed 40°C when charging. Do not use or store drill or batteries in temperatures in excess of 49°C.
- Battery packs which are defective or damaged, or can no longer be re-charged, must be disposed of as hazardous waste. Hand them over at a special collection point. Never harm our environment. Do not throw unusable battery packs away into the domestic waste, into fire or into water.
- If the electrical cable is damaged, it may only be replaced by the supplier or by his repair workshop. Have repairs carried out only by an authorized specialist only.
- Use only battery packs that have been produced by the original manufacturer. Use only the charger supplied with your drill.

- Always keep the surface of the charger free from dust and dirt.
- Insert the battery pack into the charger. Follow the guidelines provided concerning polarity.
- Always remove the battery pack before working on the drill.
- When the battery pack is outside the drill, cover the contacts to avoid short circuits (e.g. from tools or metal surfaces)
- Do not throw battery packs into water or fire, risk of explosion!
- Protect the battery pack from impacts, and don't attempt to open it.
- Never discharge the battery pack completely, and recharge occasionally if not used for a prolonged period.

It is recommended that the charger is always supplied via a residual current device with a rated current of 30mA or less.



Wear hearing protection while operating the power tool.



Wear eye protection while operating the power tool.



Use a dust mask or respirator for applications that generate dust.



Wear foot protection while operating the power tool.

## MACHINE INFORMATION

### Technical Specifications

Type designation	18V CORDLESS STRING TRIMMER
Rated voltage	18Vdc
Battery capacity	Li-on 3000mAh
No-load speed	8500rpm
Telescopic handle	0.93m - 1.16m adjustable
Cutting width	260mm



# ASSEMBLY

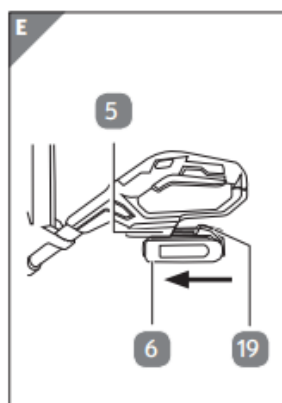
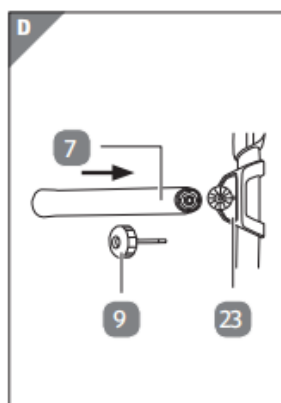
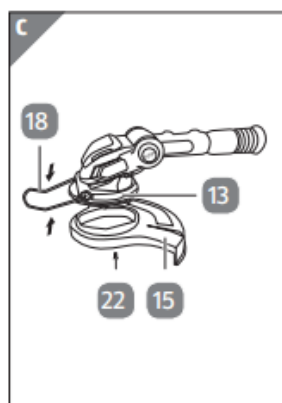
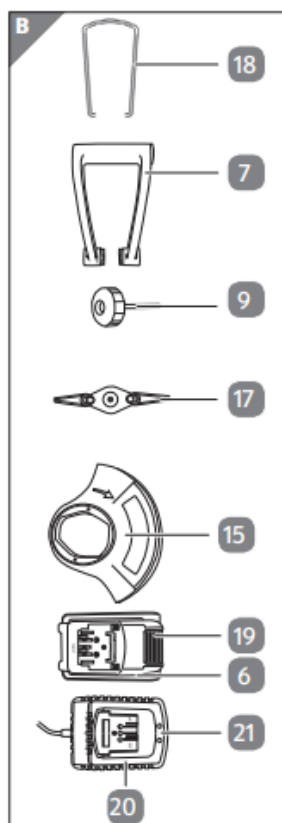
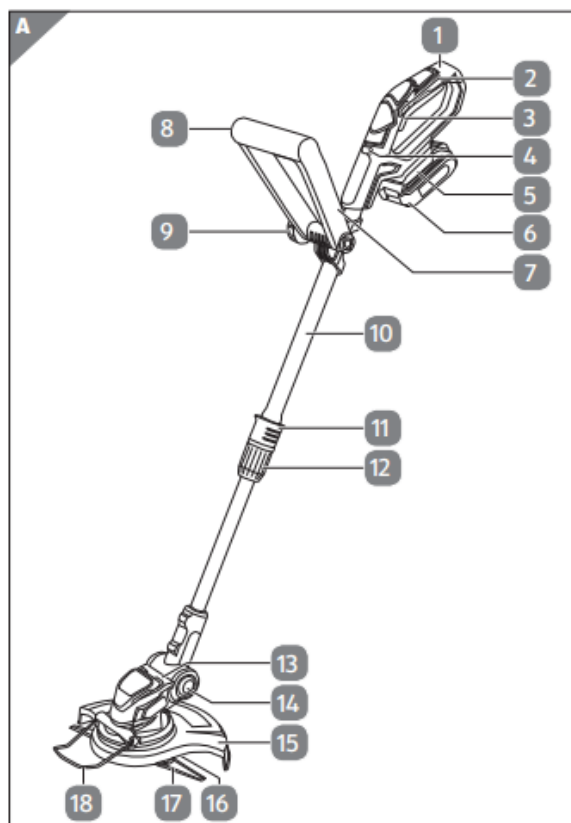

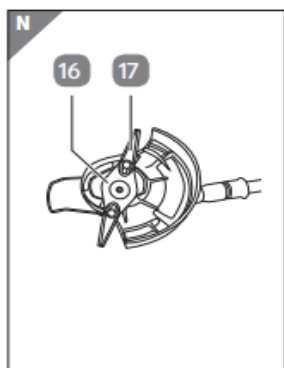
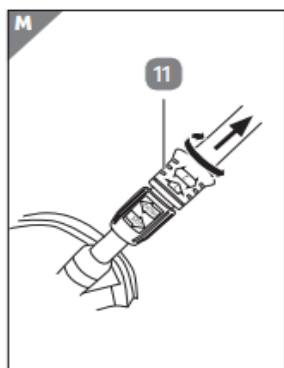
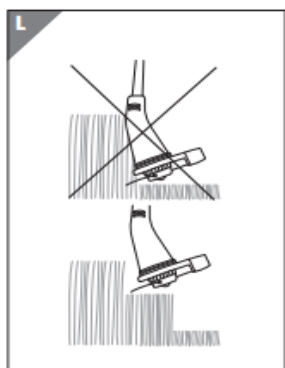
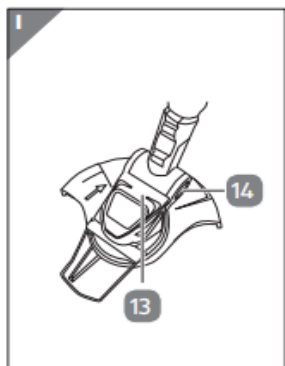
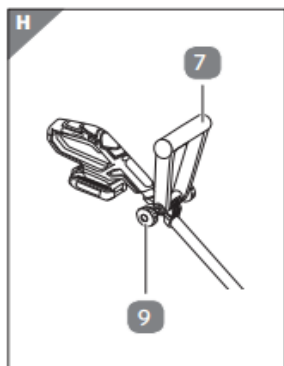
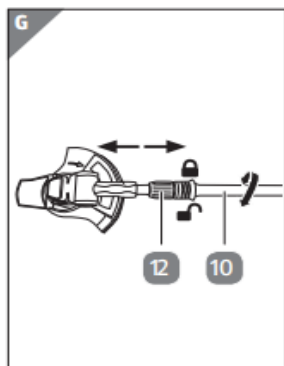
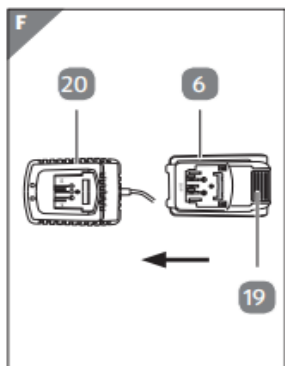

- |                            |                       |                             |
|----------------------------|-----------------------|-----------------------------|
| 1. Hand Grip               | 9. Handle Clamp Screw | 17. Blade (20pcs supplied)  |
| 2. Switch Lock             | 10. Telescopic Shaft  | 18. Edging Guide            |
| 3. ON/OFF Switch           | 11. Head Swivel Lock  | 19. Battery Release Button  |
| 4. Battery level indicator | 12. Shaft Lock Sleeve | 20. Charger                 |
| 5. Battery Holder          | 13. Motor Housing     | 21. Charge Indicator Lights |
| 6. Battery Pack            | 14. Head Angle Lock   | 22. Screws 2pc              |
| 7. Front Handle            | 15. Blade Guard       | 23. Front Handle Bracket    |
| 8. Blade Storage           | 16. Cutting Head      |                             |

- Remove the string trimmer from the packaging and layout on a flat and stable surface.
- Check whether all parts are present (see Fig. A & B).
- Check whether any individual parts are damaged. If so, do not use the string trimmer. Contact the address given on the back of this Manual. If possible, keep the original packaging of the string trimmer for storage and for future reference.

#### Mount the Blade Guard and Edging Guide:

Place the Blade Guard 15 on the underside on the Motor Housing 13 and screw in place with 2 Screws 22 (see Fig. C). Tighten these screws fully.  
Insert the Edge Guide 18 into the holes provided in the Guard (see Fig. C).

#### Mount the Front Handle:

Place the Front Handle 7 on the Front Handle Bracket 23. The teeth of the Bracket and the Handle must mesh (see Fig. D). Insert the Handle Clamp Screw 9 through the hole in the Bracket and Handle and tighten it fully by hand. Confirm that the Handle is firmly seated.

#### Adjust the height of the Cutting Head

To get an optimal working position, adjust the height of the Cutter Head 17 by shortening or lengthening the Telescopic Shaft 10.

- Place the String Trimmer on the floor or workbench.
- Release the Shaft Lock Sleeve 12 (see Fig. G).
- Slide the Telescopic Shaft to the desired length.
- Tighten the Shaft Lock Sleeve.

#### Insert and remove the Battery:

- To insert the Battery Pack 6, press the Battery Release Button 19 and slide it into the Battery Holder 5 on the handle 1 (see Fig. E). It will clip into place.
- To remove the Battery Pack, press the Release Button and pull it out of the Battery Holder.

#### Li-on Battery Pack:

##### Note:

- The battery is shipped partially charged and must be fully charged before first use.
- The battery reaches its maximum capacity only after approximately 5 discharge/charge cycles.
- Charge batteries regularly. Batteries also discharge slowly when they are not used.
- The battery warms up slightly during charging. This is normal.
- Never discharge the battery completely. This can lead to a defect of the battery.
- The battery charge level is shown by the Charge Indicator Lights 21.

#### Charge the Battery:

Charge the Battery Pack 6 in good time, to increase the service life. Recharge when you find that the performance of the String trimmer subsides.

To charge the battery, proceed as follows:

- Insert the mains plug of the Charger 20 into the power outlet socket.
- Press the Battery Release Button 19 and pull the battery out of the Battery Holder 5.
- Slide the battery into the Charger's battery holder until it audibly clicks into place (see Fig. F).
- The Charge Indicator 21 lights up red at the beginning. The charge indicator lights up green when the battery is fully charged.
- Let the battery cool down to room temperature if it has warmed up during charging.
- Unplug the Charger, then press the Battery Release Button and remove the Battery from the Charger.

## OPERATION

#### General Warnings:

- Never allow children or people unfamiliar with these instructions to operate the trimmer.
- Keep the area clear of all bystanders, children and pets while using the trimmer. Stop the trimmer immediately if anyone enters the area within a 10m radius of the trimmer when in operation.

- Never operate the trimmer when you are tired, ill, or under the influence of alcohol, drugs or medicine.
- Use the trimmer for cutting grass and light weeds only. Do not use it for any other purpose.
- Keep in mind that the user is responsible for accidents or hazards occurring to other people or their property.

### Preparation:

- Always wear protective non-slip footwear and long trousers. Wear eye protection!
- Before use, check that there are no damaged parts. A defective switch, or any other part that is damaged, should be properly repaired or replaced by an authorized service facility.
- Consider the environment in which you are working. Walk the work area before starting, to ensure it is clear of wires, sticks, stones and debris.
- Make sure the head attachment and handles are properly installed and securely fastened.
- Make sure all guards, deflectors and handles are properly and securely attached.

### Operation:

- Do not use the trimmer in bad weather, especially if there is a risk of lightning.
- Use the trimmer in daylight, or in good artificial light.
- Do not use on wet grass.
- Take care to keep proper footing and balance at all times - do not walk backward when using the trimmer.
- Walk, never run.
- Keep the cutting head below waist level at all times - do not cut overhead.
- Do not cut on surfaces other than grass on earth.
- Never operate the trimmer with damaged guards or without guards in place.
- Never fit metal replacement cutting blades. Use only genuine original equipment SnapFresh cutting blades.
- Keep hands and feet away from the cutting blades at all times, and especially when switching on the trimmer.
- Always pick up or carry the trimmer by the handles only.
- Beware of objects that may be thrown by the cutting blades. They will leave the trimmer at high speed.
- Switch off and remove the battery before:
  - servicing, leaving the trimmer unattended, cleaning your trimmer, changing cutter blades, adjusting guards, checking for any damage after hitting an object, checking for any damage if the trimmer starts to vibrate abnormally and when performing normal maintenance.
  - Remove the battery when storing trimmer.
- Always ensure that ventilation openings are kept clear of debris

## Replacement of cutting blades:

The cutting blades are attached to the cutter head by placing the large keyhole molded into each blade over the pins on the bottom of the cutter head. Pull the blades outwards to snap the smaller portion of the keyhole tightly onto the pin.

To remove a blade, push in towards the center of the cutting head until the large hole is centered on the pin and slide off.

Spare blades can be carried in the handgrip of the front handle. Twist the end cap out to access the blades.

## MAINTENANCE

Attention! Always remove the battery before carrying out any work on the machine.

To clean the tool, use a dry or moist, but not wet, towel. Many cleaning agents contain chemical substances which may cause damage to the plastic parts of the tool. Do not use any strong or flammable cleaners such as petrol, paint thinner, turpentine or similar cleaning agents. Always keep air ventilation holes free of dust deposits to prevent overheating. Wear a dust mask and use a soft brush to clean the ventilation holes.

Servicing this tool must be done by a qualified person only. Service or maintenance performed by unqualified personnel could result in a risk of injury.

If the tool does not work properly, return the tool to a service facility for repair.

If the electrical cable is damaged, it may only be replaced by the supplier or by his repair workshop.

### Battery disposal:



This symbol indicates that the batteries supplied with this product must not be treated as general household waste. To remove them safely, you must bring them to your retailer or discard them in special containers provided for the community. At the end of the device's life, remember to remove the batteries.

## WARRANTY

Babytec Technology Co., Ltd® warrants this product against defects in materials and/or workmanship under normal use for a period of ONE (1) YEAR from the date of purchase by the original purchaser ('Warranty Period').

The following circumstances are excluded from this guarantee:

- Repairs and or alterations have been made or attempted to the machine by unauthorized service centers;
- Normal wear and tear;
- The tool has been abused, misused or improperly maintained;
- Non-original spare parts have been used.

If a defect arises and a valid claim is received within the Warranty Period, at its option, Babytec will either 1) repair the defect at no charge, using new or refurbished replacement parts, or 2) replace the product with a new product that is at least functionally equivalent to the original product, or provide a store credit in the amount of the purchase price of the original product. A replacement product or part, including a part installed in accordance with instructions product. by Babytec, assumes the remaining warranty of the original product. When a product or part is exchanged, any replacement item becomes your property and the replaced item becomes Babytec's property. When a store credit is given, the original product must be returned to Babytec and becomes Babytec's property.

To obtain warranty service, e-mail Babytec Limited Warranty Service at [support@babytechnical.com](mailto:support@babytechnical.com). Please be prepared to describe the product that needs service and the nature of the problem.

 +1 833 635 0955

