

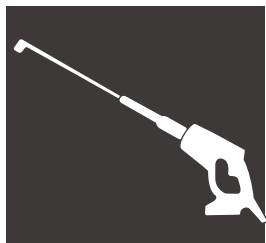

User Manual

CORDLESS PRESSURE WASHER PW350



 www.snapfreshtools.com  afterservice@snapfreshpro.com

 Read all safety rules and instructions carefully before operating this tool.



CONTENTS

Contents	2
Symbols	3
Safety warnings	4-6
Machine information	7-8
General description.....	9-12
General notes on safety	13-14
Start-up	14
Connecting the water supply	15-16
Battery	17-18
Cleaning and maintenance	18
Troubleshooting	19
Storage	19
Waste disposal and environmental protection guarantee	20
Guarantee	20
Exploded drawing	21
Warranty	22

SYMBOLS



The following symbols are used in the user manual or on the product:

	Attention! Warning symbols with information on damage and injury prevention.
	Hazard symbol with information on the prevention of personal injury caused by electric shock.
	The device is not suitable for connecting to a drinking water supply system.
	Instruction symbols with information on preventing damage.
	Help symbols with information on improving tool handling.
	Electric appliances should not be disposed of in the domestic garbage.
	Read the user manual.
	Before beginning work, familiarise yourself thoroughly with all the operating elements, particularly with how they function and operate. Ask a specialist if necessary. Please read and comply with the instruction manual for the device!
	Noise level specification in Spray lance nozzle settings.

SAFETY WARNINGS

GENERAL POWER TOOL SAFETY WARNINGS



WARNING! Read all safety warnings and all instructions. Failure to follow the warnings and instructions may result in electric shock, fire or serious injury.

Save all warnings and instructions for future reference.

The term "power tool" in the warnings refers to your mains-operated (corded) power tool or battery-operated (cordless) power tool.

1) Work area safety

- **Keep the work area clean and well lit.** Cluttered or dark areas invite accidents.
- **Do not operate power tools in explosive atmospheres, such as in the presence of flammable liquids, gases or dust.** Power tools create sparks which may ignite the dust or fumes.
- **Keep children and bystanders away while operating a power tool.** Distractions can cause you to lose control.

2) Electrical safety

- **Power tool plugs must match the outlet.** Never modify the plug in any way. Do not use any adapter plugs with earthed (grounded) power tools. Unmodified plugs and matching outlets will reduce the risk of electric shock.
- **Avoid body contact with earthed or grounded surfaces, such as pipes, radiators, ranges and refrigerators.** There is an increased risk of electric shock if your body is earthed or grounded.
- **Do not expose power tools to rain or wet conditions.** Water entering a power tool will increase the risk of electric shock.
- **Do not abuse the cord.** Never use the cord for carrying, pulling or unplugging the power tool. Keep cord away from heat, oil, sharp edges or moving parts. Damaged or entangled cords increase the risk of electric shock.
- **When operating a power tool outdoors, use an extension cord suitable for outdoor use.** Use of a cord suitable for outdoor use reduces the risk of electric shock.
- **If operating a power tool in a damp location is unavoidable, use a residual current device (RCD) protected supply.** The use of an RCD reduces the risk of electric shock.

3) Personal safety

- **Stay alert, watch what you are doing and use common sense when operating a power tool. Do not use a power tool while you are tired or under the influence of drugs, alcohol or medication.** A moment of inattention while operating power tools may result in serious personal injury.
- **Use personal protective equipment. Always wear eye protection.** Protective equipment such as dust mask, non-skid safety shoes, hard hat, or hearing protection used for appropriate conditions will reduce personal injuries.
- **Prevent unintentional starting. Ensure the switch is in the off-position before connecting to power source or battery pack, picking up or carrying the tool.** Carrying power tools with your finger on the switch or energizing power tools that have the switch on invites accidents.
- **Remove any adjusting key or wrench before turning the power tool on.** A wrench or a key left attached to a rotating part of the power tool may result in personal injury.
- **Do not overreach. Keep proper footing and balance at all times.** This enables better control of the power tool in unexpected situations.
- **Dress properly. Do not wear loose clothing or jewelry. Keep your hair, clothing and gloves away from moving parts.** Loose clothes, The jewelry or long hair can be caught in moving parts.
- **If devices are provided for the connection of dust extraction and collection facilities, ensure these are connected and properly used.** The use of dust-collection can reduce dust, related hazards.

4) Power tool use and care

- **Do not force the power tool. Use the correct power tool for your application.** The correct power tool will do the job better and safer at the rate for which it was designed.
- **Do not use the power tool if the switch does not turn it on and off.** Any power tool that cannot be controlled with the switch is dangerous and must be repaired.
- **Disconnect the plug from the power source and/or the battery pack from the power tool before making any adjustments, changing accessories, or storing power tools.** Such preventive safety measures reduce the risk of starting the power tool accidentally.
- **Store idle power tools out of the reach of children and do not allow persons unfamiliar with the power tool or these instructions to operate the power tool.** Power tools are dangerous in the hands of untrained users.
- **Maintain power tools. Check for misalignment or binding of moving parts, breakage of parts and any other condition that may affect the power tool's operation. If damaged, have the power tool repaired before use.** Many accidents are caused by poorly maintained power tools.
- **Keep cutting tools sharp and clean.** Properly maintained cutting tools with sharp cutting edges are less likely to bind and are easier to control.
- **The use of the power tool, accessories and tool bits, etc. in accordance with these instructions, taking into account the working conditions and the work to be performed.** Use of the power tool for operations different from those intended could result in a hazardous situation.

5) Battery tool use and care

- **Recharge only with the charger specified by the manufacturer.** A charger that is suitable for one type of battery pack may create a risk of fire when used with another battery pack.
- **Only use power tools with specifically designated battery packs.** Use of any other battery packs may create a risk of injury and fire.
- **When the battery pack is not in use, keep it away from other metal objects, like paper clips, coins, keys, nails, screws or other small metal objects that can make a connection from one terminal to another.** Shorting the battery terminals together may cause burns or a fire.
- **Under abusive conditions, liquid may be ejected from the battery; avoid contact. If contact accidentally occurs, flush with water. If liquid contacts eyes, additionally seek medical help.** Liquid ejected from the battery may cause irritation or burns.
- **Do not use a battery pack or tool that is damaged or modified.** Damaged or modified batteries may exhibit unpredictable behaviour resulting in fire, explosion or risk of injury.
- **Do not expose a battery pack or tool to fire or excessive temperature.** Exposure to fire or temperature above 130 °C may cause explosion. NOTE The temperature „130 °C“ can be replaced by the temperature „265 °F“.
- **Follow all charging instructions and do not charge the battery pack or tool outside the temperature range specified in the instructions.** Charging improperly or at temperatures outside the specified range may damage the battery and increase the risk of fire.

6) Service

- **Have your power tool serviced by a qualified repair person using only identical replacement parts.** This will ensure that the safety of the power tool is maintained.
- **Never service damaged battery packs.** Service of battery packs should only be performed by the manufacturer or authorized service providers.

MACHINE INFORMATION

Technical Specifications

Model No.	PW350	
Motor voltage U	20 V	
Weight (incl. accessories/Cleaning agent	ca. 2.6 kg	
Degree of protection	PX0	
Rated pressure/Working pressure (p max.)	24.5 Bar	
Max. intake pressure (p in max)	0.5 MPa	
Max. rated flow rate	2 l/min	
Min.Suction Height	4 m	
Nozzle number	6 pcs	
Water discharge time	10 s	
Suction hose	6 m	
Cleaning agent tank volume	400 ml	
Sound pressure level	78 dB(A); K = 3 dB	
Sound power level (L)	measured	89 dB(A); K = 3 dB
	guaranteed	92 dB(A)
Vibration (a)	0. ≤ 2,5 m/s², K= 1,5 m/s²MPa	

The values for noise and vibration were determined according to EN 60335 2-54:2008+A11:2012 +A1:2015.

The stated vibration emission value was measured in accordance with a standard testing procedure and may be used to compare one power tool to another. The stated vibration emission value may also be used for a preliminary exposure assessment.

Model Number	BBT-DC40A
Battery type	Lithium-ion
Voltage	20V 
Capacity	4.0 Ah
Recommended charger	BBT-YFT20V
Weight	0.6 kg

Model Number	BBT-YFT20V
Charger input	100-120V~60Hz 65W
Charger output	21V  2.5A
Charging time 2Ah battery	60 minutes
Charging time 4Ah battery	120 minutes
Recommended batteries	BBT-DC20A, BBT-DC40A
Weight	0.36 kg

Only use the following batteries of the SnapFresh power 20V battery platform. Using any other batteries could cause serious injury or damage the tool.

BBT-DC20A 20V, 2Ah Lithium-ion

BBT-DC40A 20V, 4Ah Lithium-ion

The following charger can be used to charge these batteries.

BBT-YFT20V Quick charger

The batteries of the SnapFresh power 20V battery platform are interchangeable with all the SnapFresh power 20V battery platform tools.



WARNING!

- The vibration emission value may differ during actual use of the power tool from the stated value depending on the manner in which the power tool is used.
- Try to keep the exposure to vibrations as low as possible. Examples of measures to reduce vibration exposure are the wearing of gloves when using the tool and limiting the working hours. For this purpose all parts of the operating cycle have to be considered (for example, times when the electric tool is switched off and times when it is switched on but running without any load)

GENERAL DESCRIPTION

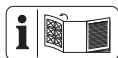

The diagram of the most important functional elements can be found on the foldout side.

1) Scope of Delivery

Carefully unpack the appliance and check that it is complete:

- Device
- Spray lance
- Suction hose
- Mesh bag
- Cleaning agent nozzle with container
- Instructions for use



Battery and charger are not included.

Dispose of the packaging material correctly.

2) Overview

- 1 Ventilation slits
- 2 Release button
- 3 Switch lever
- 4 Water connection
- 5 Guide rail
- 6 Cleaning agent container
- 7 Cleaning agent nozzle
- 8 Nozzles
- 9 Spray lance
- 10 Suction hose with quick release filter basket and quick release connector
- 11 Mesh bag
- 12 Bucket clamp
- 13 3/4" faucet connector
- 14 Rechargeable battery
- 15 Release button
- 16 Charger

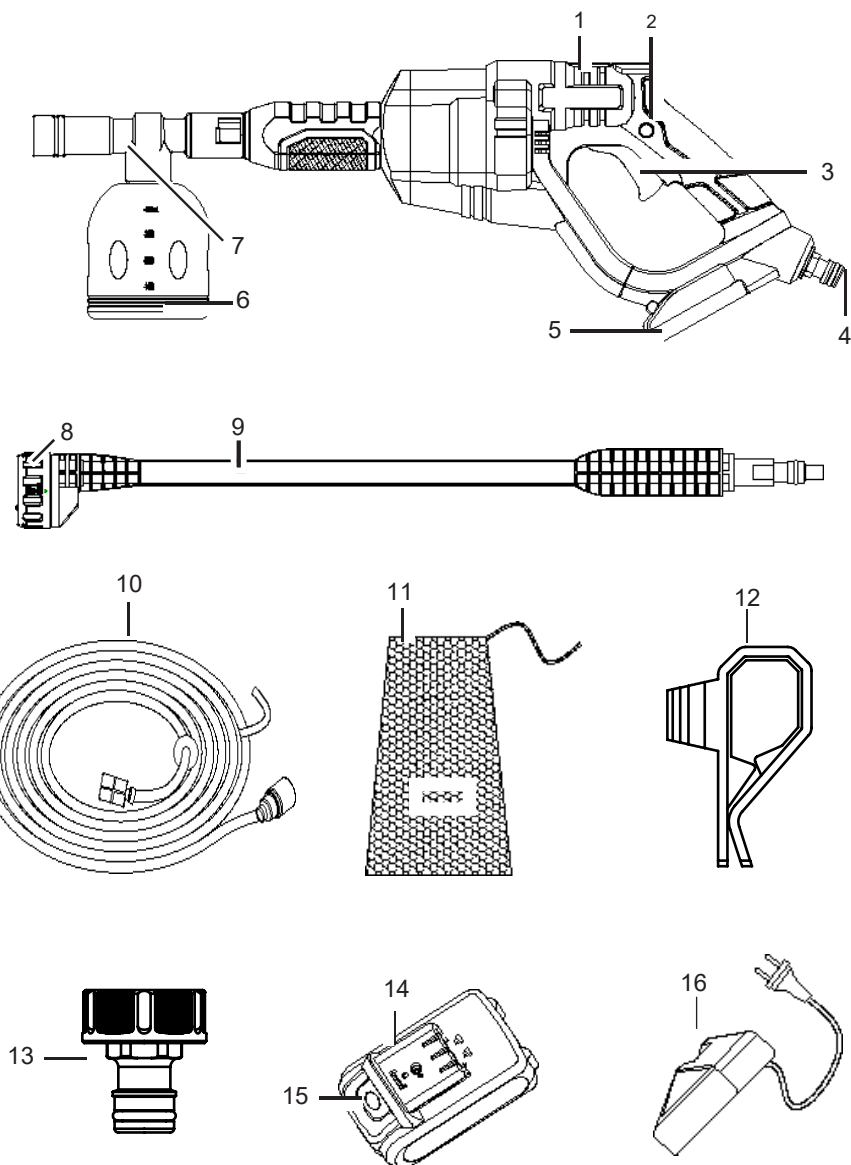

3) Functional description

The cordless pressure washer cleans and irrigates using a water jet. If necessary, it can also be operated with the addition of cleaning agents.

For the functions of the operating elements please refer to the subsequent description. Ensure that the safety instructions are always observed!

Do not expose power tools to rain or wet conditions. Water entering a power tool will increase the risk of electric shock.

Do not abuse the cord. Never use the cord for carrying, pulling or unplugging the power tool. Keep cord away from heat, oil, sharp edges or moving parts. Damaged or entangled cords increase the risk of electric shock.

When operating a power tool outdoors, use an extension cord suitable for outdoor use. Use of a cord suitable for outdoor use reduces the risk of electric shock.

If operating a power tool in a damp location is unavoidable, use a residual current device (RCD) protected supply. The use of an RCD reduces the risk of electric shock.

Personal safety

- **Stay alert, watch what you are doing and use common sense when operating a power tool.** Do not use a power tool while you are tired or under the influence of drugs, alcohol or medication. A moment of inattention while operating power tools may result in serious personal injury.
- **Use personal protective equipment. Always wear eye protection.** Protective equipment such as dust mask, non-skid safety shoes, hard hat, or hearing protection used for appropriate conditions will reduce personal injuries.
- **Prevent unintentional starting.** Ensure the switch is in the off-position before connecting to power source or battery pack, picking up or carrying the tool. Carrying power tools with your finger on the switch or energizing power tools that have the switch on invites accidents.
- **Remove any adjusting key or wrench before turning the power tool on.** A wrench or a key left attached to a rotating part of the power tool may result in personal injury.
- **Do not overreach. Keep proper footing and balance at all times.** This enables better control of the power tool in unexpected situations.
- **Dress properly. Do not wear loose clothing or jewelry.** Keep your hair, clothing and gloves away from moving parts. Loose clothes, The jewelry or long hair can be caught in moving parts.
- **If devices are provided for the connection of dust extraction and collection facilities, ensure these are connected and properly used.** The use of dust-collection can reduce dust, related hazards.

4) Power tool use and care

- **Do not force the power tool. Use the correct power tool for your application.** The correct power tool will do the job better and safer at the rate for which it was designed.
- **Do not use the power tool if the switch does not turn it on and off.** Any power tool that cannot be controlled with the switch is dangerous and must be repaired.
- **Disconnect the plug from the power source and/or the battery pack from the power tool before making any adjustments, changing accessories, or storing power tools.** Such preventive safety measures reduce the risk of starting the power tool accidentally.
- **Store idle power tools out of the reach of children and do not allow persons unfamiliar with the power tool or these instructions to operate the power tool.** Power tools are dangerous in the hands of untrained users.
- **Maintain power tools. Check for misalignment or binding of moving parts, breakage of parts and any other condition that may affect the power tool's operation. If damaged, have the power tool repaired before use.** Many accidents are caused by poorly maintained power tools.
- **Keep cutting tools sharp and clean.** Properly maintained cutting tools with sharp cutting edges are less likely to bind and are easier to control.
- **The use of the power tool, accessories and tool bits, etc. in accordance with these instructions, taking into account the working conditions and the work to be performed.** Use of the power tool for operations different from those intended could result in a hazardous situation.

GENERAL NOTES ON SAFETY

- **Machines shall not be used by children.** Children should be supervised to ensure that they do not play with the machine.
- **This machine can be used by people with reduced physical, sensory or mental capabilities** or lack of experience and knowledge if they have been given supervision or instruction concerning use of the machine in a safe way and understand the hazards involved.
- **People who are unfamiliar with the operating instructions are not permitted to use the equipment.**
- **High pressure cleaner may not be operated by non-trained persons**
- **In the case of a malfunction or defect during operation, the device must be switched off immediately and the battery removed. Then read page 11 of the operating instructions for possible fault causes or contact our service centre.**

Working with the equipment



Caution – to avoid accidents and injuries:



High-pressure washers can be dangerous if used incorrectly. The jet must not be directed at persons, animals, active electrical equipment or the device itself.

- Do not direct the jet at yourself or others in order to clean clothes and shoes.
- To protect against water or dirt splashing back, wear suitable protective clothing and safety goggles.
- Do not operate the pressure cleaner when other people are in the immediate vicinity, other than they are also wearing protective clothes.
- Do not use the equipment in the vicinity of flammable liquids or gases. Non-observance will result in a risk of fire or explosion.
- Do not spray combustible liquids. Risk of explosion.
- If you come into contact with cleaning agents, rinse with plenty of clean water. Burn hazard!
- Please be aware of the increased risk of tripping up when using your pressure washer with the suction hose.
- Do not run over, crush or kink the suction hose. There is a risk of damage and therefore a risk of injury to you.
- Do not use for cleaning windows.
- Store the equipment in a dry place and out of reach of children.



CAUTION - To avoid damage to the equipment and any possible person injury resulting from this:

- Do not work with damaged or incomplete equipment, or with equipment that has been converted without the approval of the manufacturer. Before initial operation, have a specialist check that the required electrical protection measures are in place.
- Protect the pressure cleaner from frost and dry running.
- High-pressure hoses, fittings and couplings are important for machine safety. Use only highpressure hoses, fittings and couplings recommended by the manufacturer.
- Use only original accessories and do not carry out conversion work on the equipment.
- Please read the notes in the operating instructions on the topic of "maintenance and cleaning". Any measures above and beyond these, particularly opening the equipment, are to be carried out by an authorised electrician.

Electrical safety



CAUTION - to avoid accidents and injuries from electric shocks:

- Before each use, check the equipment for damage.
- Wear sturdy footwear to protect against electric shock.

START-UP



In keeping with current regulations a pressure cleaner must never be operated off the drinking water mains supply without a controllable backflow preventer. A suitable backflow preventer in conformity with EN 12729 type BA must be used.

Water that has passed through a backflow preventer is classified as undrinkable. A backflow preventer is available in specialist shops.

A system separator (check valve) prevents the backflow of water and detergent into the drinking water pipeline.

- Employ an ordinary garden hose for the water intake and ensure sufficient length.
- Use the device on a domestic water connection with maximum pressure of 5 bar.
- You can also use the device independently of the water pipe (for example, with a rain barrel) through the integrated water suction function. This function must only be used with a suction hose with a filter basket.

CONNECTING THE WATER SUPPLY

Connecting to the domestic water connection

- 1) Connect the supply hose to the water supply. Bleed the hose by allowing water to flow bubble-free out of the other end of the supply hose. Close the tap.
- 2) Connect the hose coupling of the supply hose to the water connection (4) on the device.

Suctioning water

- You can also use the device independently of the water pipe (for example, with a rain barrel) through the integrated water suction function. This function must only be used with a suction hose with a filter basket.
- To remove the spool, press and hold the shaft lock button, then it can be easily removed.



The device itself must not be immersed in open water sources. There is a risk of personal injury from an electric shock.



Do not draw in any water from natural accumulations. There is a risk of contamination from backwashed cleaning agent.

- 1) Connect the suction hose with filter basket to the coupling (10) on the device.
- 2) Insert the end with the filter basket into the water collector (e.g. rain barrel). Ensure there is a sufficient and reliable water supply.

Bleeding the hose

Make sure that there is no air in the suction hose. Immerse the suction hose and filter basket (10) completely into the water collector (e.g. rain barrel) to bleed it.



Dry running will damage the device

Inserting/removing the rechargeable battery

- 1) After having worked with a detergent rinse the pressure cleaner with clear water.
- 2) Release the switch lever (3).
- 3) Remove the battery from the device.
- 4) Disconnect the cordless pressure washer from the water supply.
- 5) Press the release button (2) and the switch lever (3) to release the existing pressure in the system.



Adjusting the nozzles

Integrated nozzle, six types of water for users to save about 50 yuan accessory costs

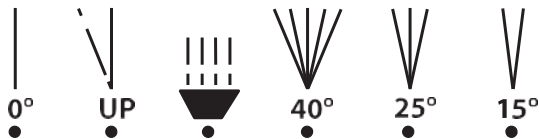

A small arrow on the top of the spray lance indicates which nozzle is currently selected.

	0°/15°/25°/40° spray angle
	Jet sprays upward
	Gentle spray for watering/ washing

Using detergents

This device has been designed to be used with a neutral, biodegradable cleaning agent. Other detergents or chemical sub- stances could impair the safety of the pres- sure cleaner and damage it. Such damage to the equipment is not covered by the guarantee.

BATTERY

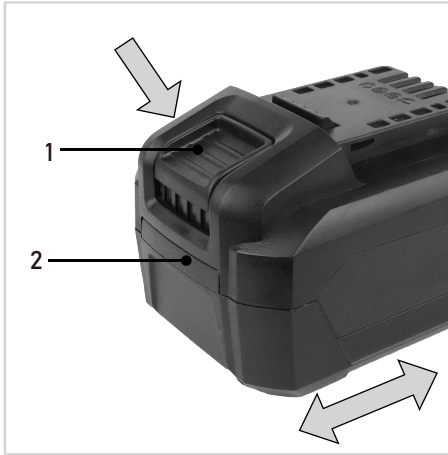

Before any work on the power tool, remove the battery.



The battery must be charged before first use.

DESCRIPTION

1. Battery
2. Battery unlock button
3. Battery LED indicators button
4. Battery LED indicators
5. Charger
6. Charger LED indicators

Checking the battery charging status

- To check the battery charge status, push the button (6) on battery shortly.
- The battery has 3 lights indicating the charge level, the more lights that burn, the more charge the battery has left.
- When the lights are not burning it means the battery is empty and must be charged immediately.

Charging the battery with the charger

- Take the battery (2) from the machine.
- Turn the battery (2) to upside down position and slide it onto the charger (8) as shown in Fig. D.
- Push the battery until it is fully pushed into the slot.
- Plug the charger plug into an electrical outlet and wait for a while. The LED indicators (10) charger (13) will lighten up and show the charger status.

The LED indicators (9) will lighten up and show the charger status.

Red LED Status	Green LED status	Charger status
Off	Off	No power
Off	On	Standby mode: -No battery is inserted or, -Battery inserted but charging has finished
On	Off	Battery charging in progress

- Fully charging the 2Ah battery may take up to 60 minutes.
- Fully charging the 4 Ah battery may up to 120 minutes.

After the battery is fully charged remove the charger plug from the outlet and remove the battery from the charger.



When the machine is not being used over a longer period of time it is best to store the battery in charged condition.

CLEANING AND MAINTENANCE



Remove the battery before carrying out any work on the device. This also includes connecting to the water supply or trying to eliminate leaks. There is a risk of electrocution or of injury from moving parts.

Cleaning



Never direct the water jet against the pressure cleaner, nor clean the pressure cleaner under flowing water. This could give rise to the danger of electric shock and damage the pressure cleaner!

Always keep the pressure cleaner clean. Do not use any detergents or solvents.

- Always keep the ventilation slots (1) clean and free.
- Clean the device with a soft brush or damp cloth.
- If the nozzles (8) on the spray lance (9) are soiled or clogged, you can remove any foreign bodies in the nozzle using a needle.
- Rinse the nozzles with water to remove the foreign body.

Maintenance

The pressure cleaner is maintenance free.

TROUBLESHOOTING

PROBLEM	POSSIBLE CAUSE	SOLUTION
Strong pressure fluctuations	Nozzles (8) dirty/ clogged	Rinse the nozzles (8) with water. If required, clean the nozzle bore hole with a needle (see "Cleaning" section).
Device does not work	Battery is flat	Charge rechargeable battery.
Leaks in the water system	Connections not correctly installed	Switch off the device and remove the battery. Reconnect the device to the water supply (see "Initial start-up")
	The trimmer line gets tangled.	Only connect the device to a domestic water connection with maximum pressure of 5 bar.

STORAGE

- **Empty the cordless pressure washer completely of water.**
Disconnect the device from the water supply. Switch on the battery pressure washer for a few seconds until no more water emerges from the spray lance (9). Turn off the device.
- **Empty the cordless pressure washer completely of water.**
Disconnect the device from the water supply. Switch on the battery pressure washer for a few seconds until no more water emerges from the spray lance (9). Turn off the device.
- **Store all spray lances (9) vertically with the connection side facing downwards.**
- **Completely empty the suction hose and filter basket (10)**
- **The cordless pressure washer and accessories are destroyed by frost if they are not completely emptied of water.**
- **Store the device and the accessories in a frost-resistant location.**

WASTE DISPOSAL AND ENVIRONMENTAL PROTECTION

Be environmentally friendly. Return the tool, accessories and packaging to a recycling centre when you have finished with them.



Electric appliances should not be disposed of in the domestic garbage.

Hand the tool in at a recycling centre. The plastics and metal parts can be separated and recycled.

GUARANTEE

Dear Customer,

This equipment is provided with a 3-year guarantee from the date of purchase.

In case of defects, you have statutory rights against the seller of the product. These statutory rights are not restricted by our guarantee presented below.

Terms of Guarantee

The term of the guarantee begins on the date of purchase. Please retain the original receipt. This document is required as proof of purchase.

If a material or manufacturing defect occurs within three years of the date of purchase of this product, we will repair or replace – at our choice – the product for you free of charge. This guarantee requires the defective equipment and proof of purchase to be presented within the three-year period with a brief written description of what constitutes the defect and when it occurred.

If the defect is covered by our guarantee, you will receive either the repaired product or a new product. No new guarantee period begins on repair or replacement of the product.

Guarantee Period and Statutory Claims for Defects

The guarantee period is not extended by the guarantee service. This also applies for replaced or repaired parts. Any damages and defects already present at the time of purchase must be reported immediately after unpacking. Repairs arising after expiry of the guarantee period are chargeable.

Guarantee Cover

The equipment has been carefully produced in accordance with strict quality guidelines and conscientiously checked prior to delivery.

The guarantee applies for all material and manufacturing defects. This guarantee does not extend to cover product parts that are subject to normal wear and may therefore be considered as wearing parts (e.g. hose) or to cover damage to breakable parts (e.g. switches).

This guarantee shall be invalid if the product has been damaged, used incorrectly or not maintained. Precise adherence to all of the instructions specified in the operating manual is required for proper use of the product. Intended uses and actions against which the operating manual advises or warns must be categorically avoided. The product is designed only for private and not commercial use. The guarantee will be invalidated in case of misuse or improper handling, use of force, or interventions not undertaken by our authorised service branch.

WARRANTY

Ningbo Winbay Technology Co.,Ltd. (Hereinafter referred to as Babytec) warrants this product against defects in materials and/or workmanship under normal use for a period of ONE (1) YEAR from the date of purchase by the original purchaser ('Warranty Period').

The following circumstances are excluded from this guarantee:

- Repairs and or alterations have been made or attempted to the machine by unauthorized service centers;
- Normal wear and tear;
- The tool has been abused, misused or improperly maintained;
- Non-original spare parts have been used.

If a defect arises and a valid claim is received within the Warranty Period, at its option, Babytec will either 1) repair the defect at no charge, using new or refurbished replacement parts, or 2) replace the product with a new product that is at least functionally equivalent to the original product, or provide a store credit in the amount of the purchase price of the original product. A replacement product or part, including a part installed in accordance with instructions product by Babytec, assumes the remaining warranty of the original product. When a product or part is exchanged, any replacement item becomes your property and the replaced item becomes Babytec's property. When a store credit is given, the original product must be returned to Babytec and becomes Babytec's property.

To obtain warranty service, e-mail Babytec Warranty Service at afterservice@snapfreshpro.com.

Please be prepared to describe the product that needs service and the nature of the problem.

To extend your warranty, please register at snapfreshpro.vip

 +1 833 635 0955

(Monday - Friday 9 a.m. - 5 p.m. EST 6 a.m. - 2 p.m. PST)